

| FHWA REGION NO. | STATE | PROJECT NO. | FISCAL YEAR | SHEET NO. | TOTAL SHEETS |
|-----------------|--------|--------------|-------------|-----------|--------------|
| 7 | KANSAS | 87 N-0303-01 | 2003 | 95 | 143 |

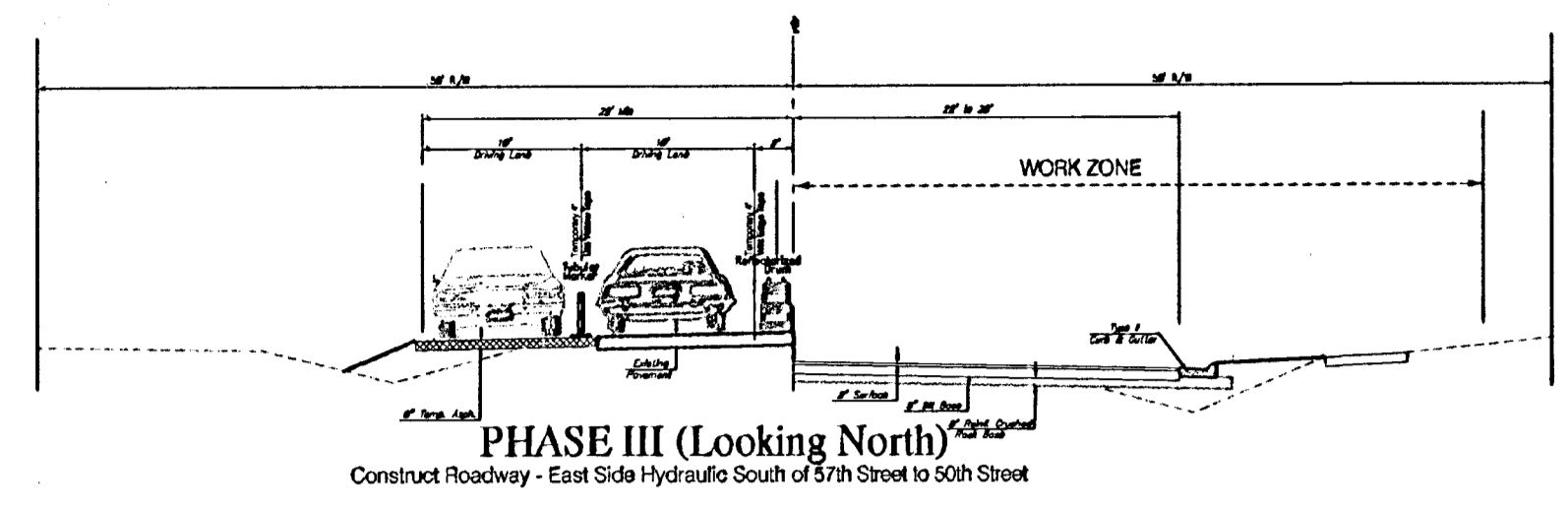

PHASE III
Continue Construction of Roadway - East Side Hydraulic, North of 57th Street to Mona Lane.
Construct Roadway - East Side Hydraulic, Mona Lane to 50th Street.
Construct Roadway - West Side Hydraulic, 50th Street to Center of 47th Street.
Maintain 2-Way Traffic on Temp. Pvmnt. and West Side Exstg. Pvmnt., South of 57th Street to 50th Street. Maintain 2-Way Traffic on Temp. Pvmnt. and East Side Exstg. Pvmnt., 50th Street to North of 47th Street. Contractor may Flag at Individual Locations during working hours.

Contractor shall maintain two way traffic the full length of the project at all times except for localized flagging at individual locations during working hours. Flagging operations to conform to the latest addition of the MUTCD.

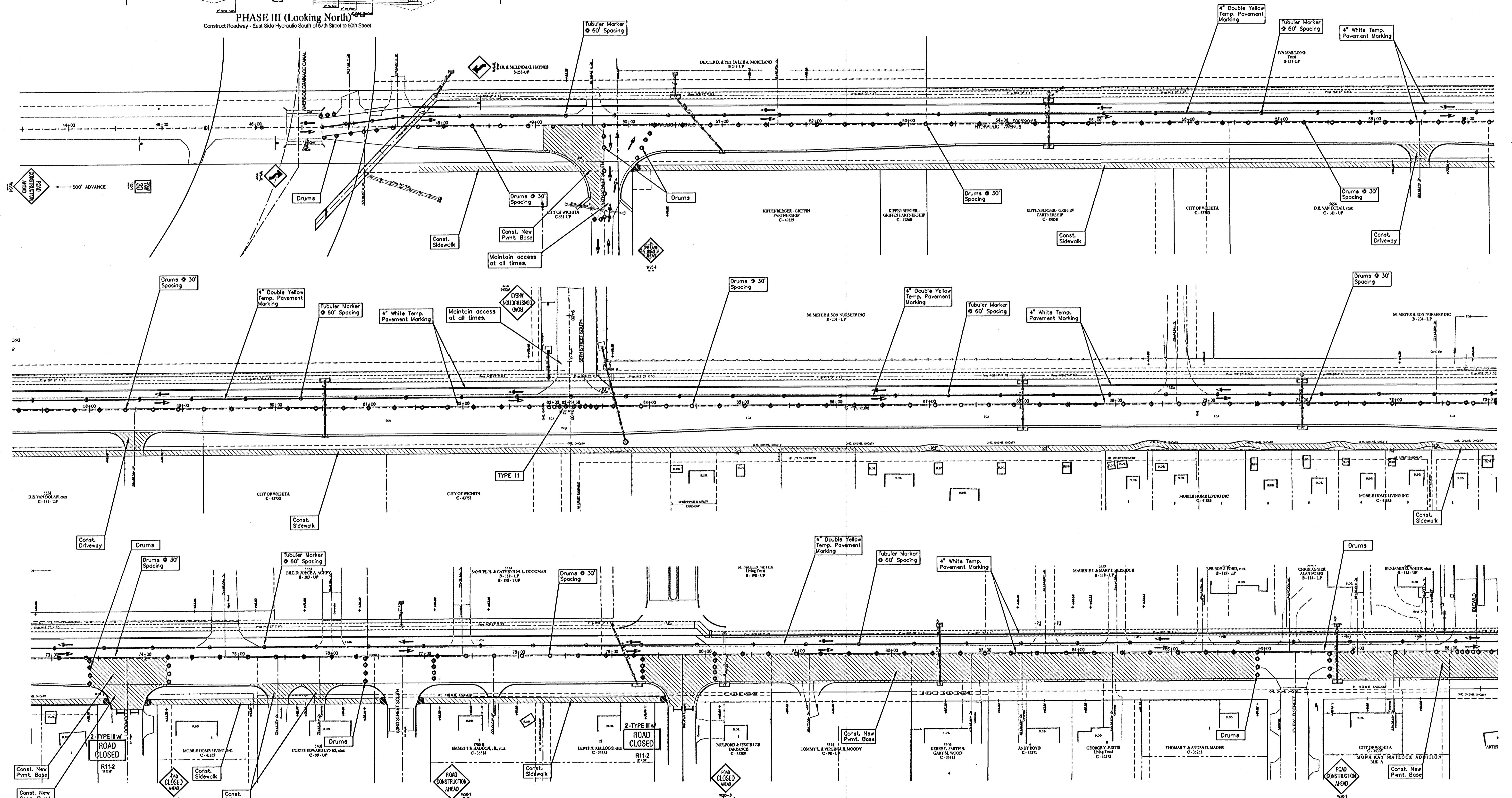
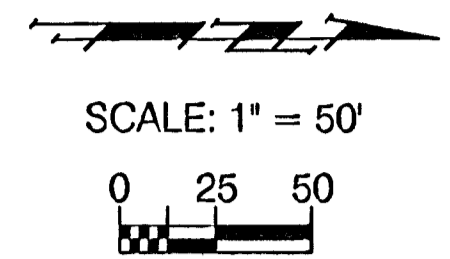

Contractor shall maintain access to all businesses and residences during construction.

Contractor shall maintain all drainage ways during construction.

| | | |
|-----------------------------|------------------------|--|
| PROJECT NUMBER 472 83902 | SHEET NAME Conseq07 | ENGINEERING DIRECTORY FAEngHydraulic.phs2Conseq |
| DESIGN Azire | DRAWN Staff | APPROVED JFB |
| DATE March 04 | SCALE 1"=50' | BAUGHMAN NO 99-09-E451 |

STREET & SWS IMPROVEMENTS
Construction Sequencing Plan Phs III
HYDRAULIC AVE PAVING - SOUTH OF 57th STREET SOUTH TO 47th STREET SOUTH

BAUGHMAN COMPANY, P.A.
ENGINEERING, SURVEYING, & PLANNING
318-282-7271 • 315 ELLIS • WICHITA, KANSAS 67211

SHEET 95 OF 143