

Scale: 1"=60'

EARTH WORK TOTALS		
	C.Y. Excavation	C.Y. Fill
Mass Grading	37,685	46,723
Pond	38,582	221
Total	76,267	46,944

Earthwork quantities do not include correction factors and are for reference only. All cost associated with mass grading shall be included in the bid item "Mass Grading".

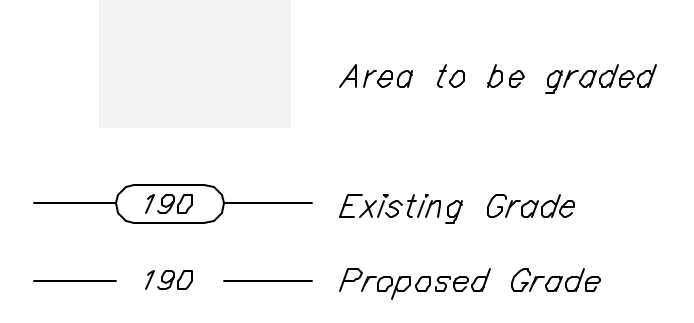

- NOTES:**
- Any excess excavation shall be stored as indicated by Engineer, out of easements and R/W. Area will be staked by Engineer. Additional area will be staked out if needed.
 - All of Reserve "E" above the static water surface shall be seeded and mulched as follows: (Permanent Seeding)
 SEED -- Kansas Premium Fescue Blend; 8#/1000 Sq. Ft.
 FERTILIZER -- 12-24-12 Ratio at 350 Lbs./Ac.
 MULCH -- 2 Tons Prairie Hay / Acre
 All other disturbed areas not in street R/W are to be seeded and mulched as follows: (Temporary seeding)
 SEED -- Rye grass (PLS)--5#/1000 Sq. Ft. and
 MULCH -- 2 Tons Prairie Hay / Acre
 - Contractor to strip top 3" of soil before mass grading and stockpile. Top soil stockpile to be redistributed over entire disturbed area excluding street right-of-way and ponds to achieve planned grade.
 - Compaction of 95% shall be obtained under proposed pavement and 90% compaction in all other fill areas.
 - It shall be the Contractor's responsibility to protect the sanitary sewer and water distribution system during mass grading. Any damage done to these systems by Contractor or subcontractor shall be repaired at no additional cost to the project.
 - Remove trees and fence ONLY if approved by engineer as necessary for grading.

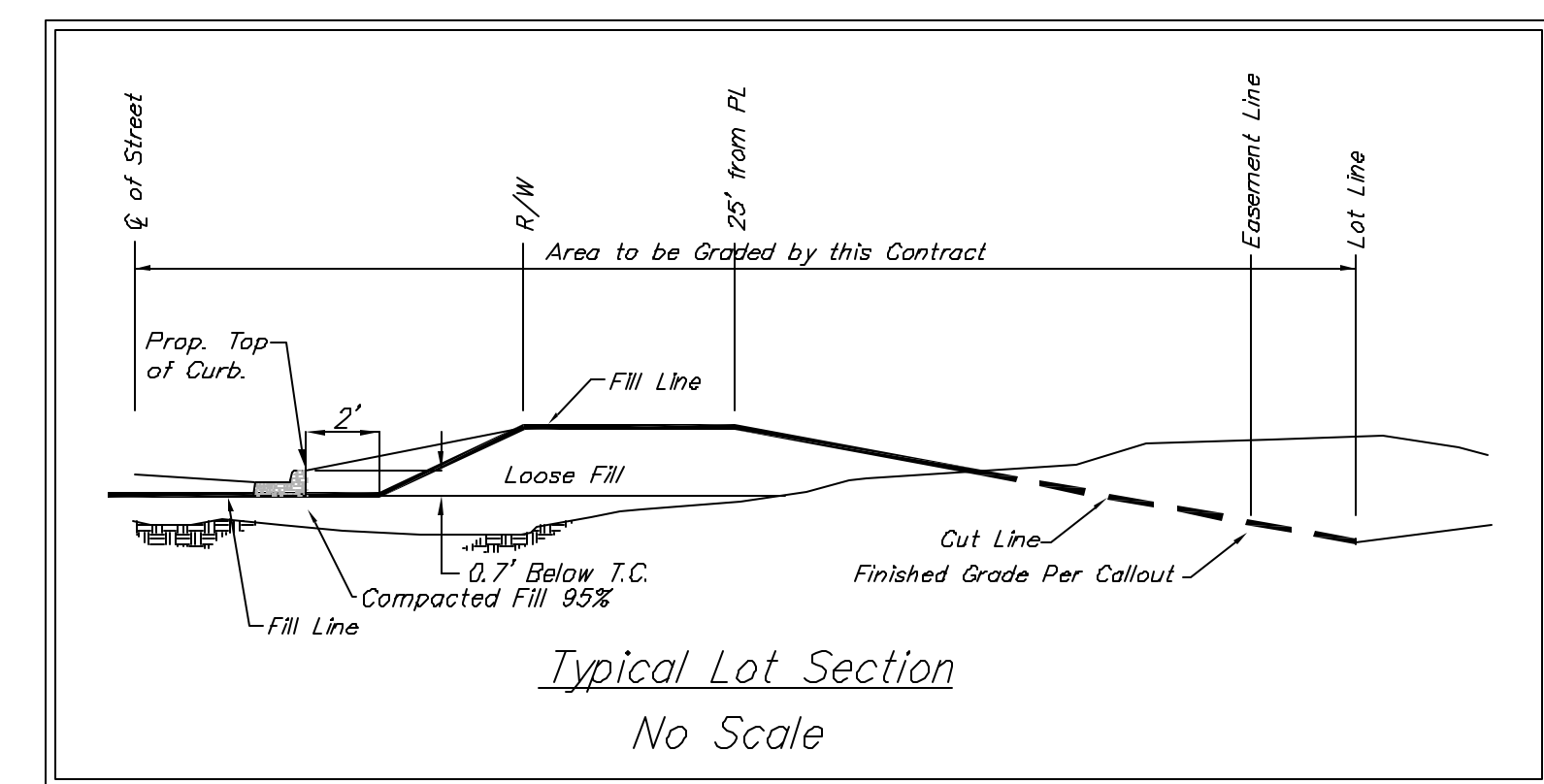

SHADOW WOODS ADDITION - PHASE I & II
MASS GRADING PLAN
 WICHITA, KANSAS

BAUGHMAN COMPANY P.A.
 ENGINEERING, SURVEYING, & PLANNING
 316-262-7271 • 315 ELLIS • WICHITA, KANSAS 67211

DESIGN	DRAWN	APPROVED	DATE	SCALE	SHEET 3 OF 13
NBW	TMS		5/14/03	Noted	

