

REEDS COVE ADDITION

REEDS COVE SECOND ADDITION

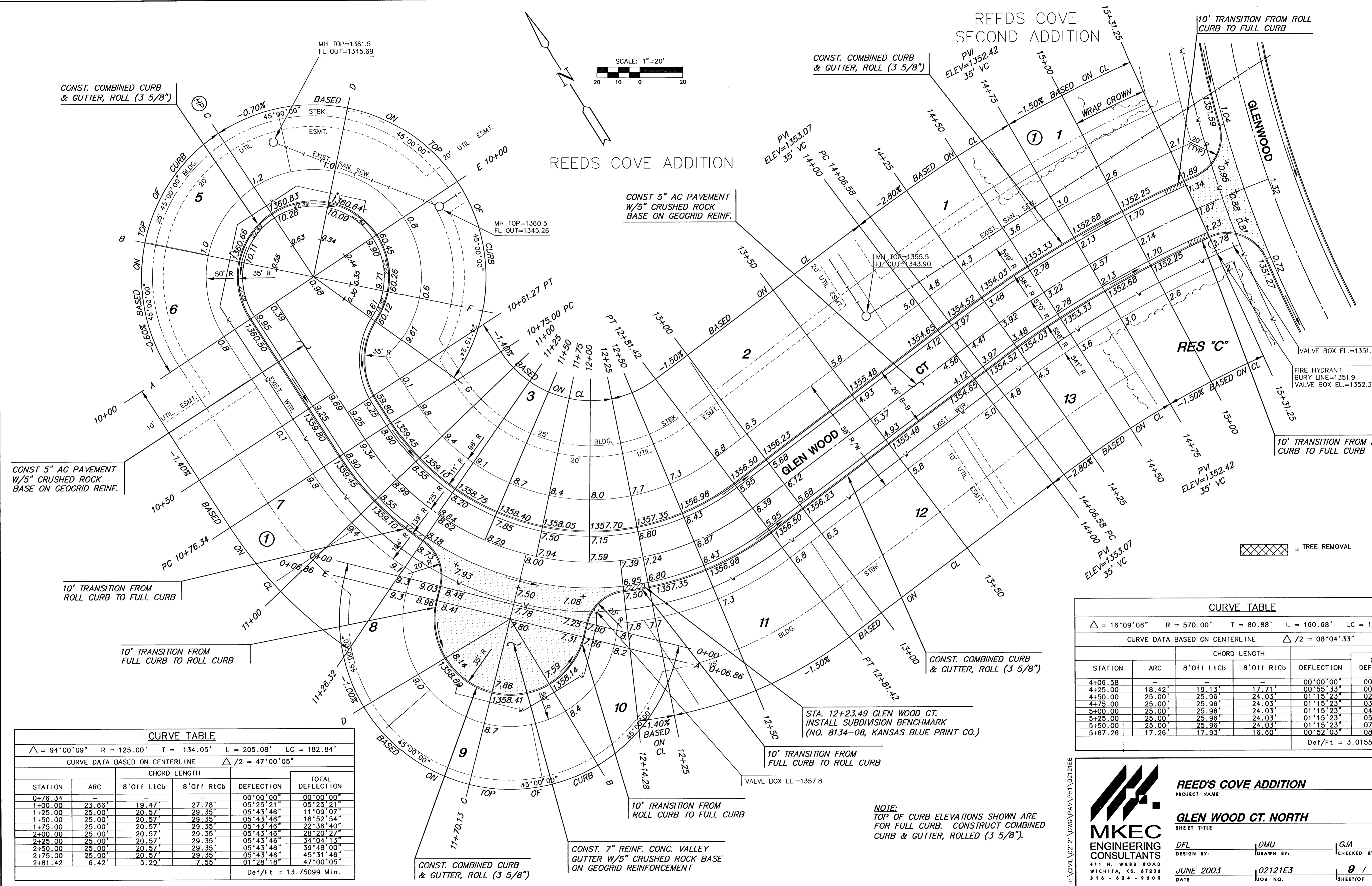

CURVE TABLE

$\Delta = 94^{\circ}00'09''$ R = 125.00' T = 134.05' L = 205.08' LC = 182.84'

CURVE DATA BASED ON CENTERLINE $\Delta/2 = 47^{\circ}00'05''$

STATION		CHORD LENGTH		DEFLECTION		TOTAL DEFLECTION
ARC	8' Off LtCb	8' Off RtCb	DEFLECTION	DEFLECTION		
0+76.34	-	-	00°00'00"	00°00'00"		00°00'00"
1+00.00	23.66'	19.47'	05°25'21"	05°25'21"		05°25'21"
1+25.00	25.00'	20.57'	05°43'46"	11°09'07"		11°09'07"
1+50.00	25.00'	20.57'	05°43'46"	16°52'54"		16°52'54"
1+75.00	25.00'	20.57'	05°43'46"	22°36'40"		22°36'40"
2+00.00	25.00'	20.57'	05°43'46"	28°20'27"		28°20'27"
2+25.00	25.00'	20.57'	05°43'46"	34°04'13"		34°04'13"
2+50.00	25.00'	20.57'	05°43'46"	39°48'00"		39°48'00"
2+75.00	25.00'	20.57'	05°43'46"	45°31'46"		45°31'46"
2+81.42	6.42'	5.29'	01°28'18"	47°00'05"		47°00'05"

Def/Ft = 13.75099 Min.

CURVE TABLE

$\Delta = 16^{\circ}09'06''$ R = 570.00' T = 80.88' L = 160.68' LC = 160.15'

CURVE DATA BASED ON CENTERLINE $\Delta/2 = 08^{\circ}04'33''$

STATION	CHORD LENGTH		DEFLECTION	TOTAL DEFLECTION
	ARC	8' Off LtCb		
4+06.58	-	-	00°00'00"	00°00'00"
4+25.00	18.42'	19.13'	00°55'33"	00°55'33"
4+50.00	25.00'	25.96'	01°15'23"	02°10'56"
4+75.00	25.00'	25.96'	01°15'23"	03°26'20"
5+00.00	25.00'	25.96'	01°15'23"	04°41'43"
5+25.00	25.00'	25.96'	01°15'23"	05°57'06"
5+50.00	25.00'	25.96'	01°15'23"	07°12'30"
5+67.28	17.28'	17.93'	00°52'03"	08°04'33"

Def/Ft = 3.01557 Min.

REEDS COVE ADDITION
PROJECT NAME

GLEN WOOD CT. NORTH
SHEET TITLE

DESIGN BY: *DMU* DRAWN BY: *GVA* CHECKED BY: *GVA*

DATE: **JUNE 2003** JOB NO.: **02121E3** SHEET/OF: **9 / 34**

411 N. WEBB ROAD
WICHITA, KS. 67206
316 - 684 - 9600

NOTE:
TOP OF CURB ELEVATIONS SHOWN ARE FOR FULL CURB. CONSTRUCT COMBINED CURB & GUTTER, ROLLED (3 5/8").

STA. 12+23.49 GLEN WOOD CT. INSTALL SUBDIVISION BENCHMARK (NO. 8134-08, KANSAS BLUE PRINT CO.)