

BENCHMARKS:
 BM #1: COW BM at the SW corner of Pawnee Ave. and Maize Road.
 Elev. = 135.15 (City Datum)

BM #2: "□" in top of curb on the north side of Yosemite, 65' east of Maize Road.
 Elev. = 143.67 (City Datum)

BM #3: COW BM at Shefford on the south side of Pawnee Ave.
 Elev. = 145.53 (City Datum)

P.V.I.
 Elev. = 145.90
 No V.C.

Scale: 1" = 20'
 = Iron

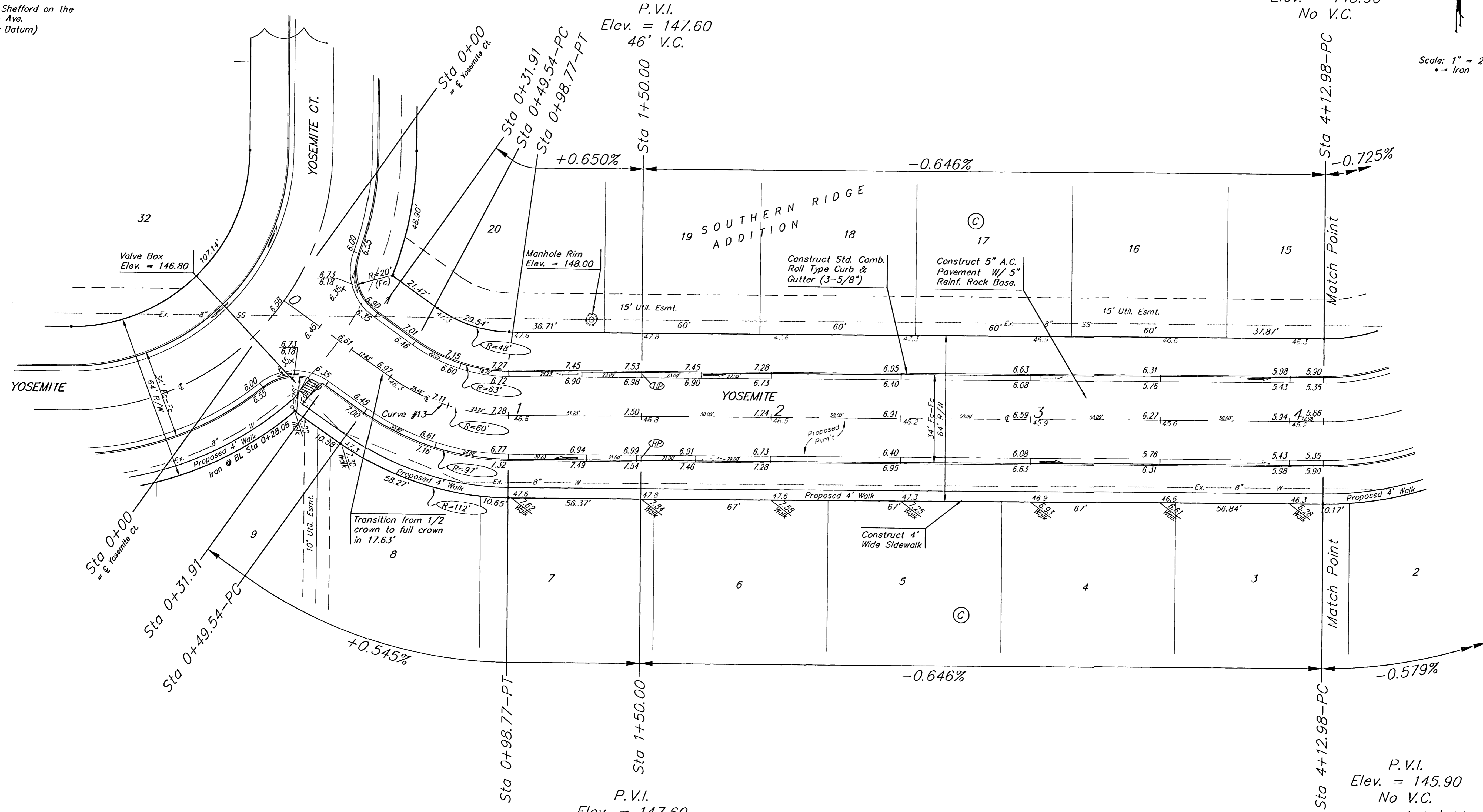

P.V.I.
 Elev. = 147.60
 46' V.C.

P.V.I.
 Elev. = 147.60
 42' V.C.

P.V.I.
 Elev. = 145.90
 No V.C.
 As Built 3/20/04

Curve #13
 Curve Data Based on Centerline
 Rad. = 80' Delta = 35° 15' 25" Tangent = 25.42'
 Arc = 49.23' L.C. = 48.45' Del/Fl. = 21.48504 Min.

Station	Arc	FACE CHORD LENGTHS		Defl.	T. Defl.
		8' Lt.	8' Rt.		
0+49.54	-	-	-	0°00'00"	0°00'00"
0+75.00	25.46'	17.43'	33.27'	9°07'01"	9°07'01"
0+98.77	23.77'	16.28'	31.08'	8°30'42"	17°37'43"

NOTE: ROLL TYPE CURB & GUTTER TO BE CONSTRUCTED ON THE PAVEMENT SHOWN ON THIS SHEET. TOP OF CURB ELEVATIONS ARE GIVEN FOR FULL HEIGHT CURB.

SOUTHERN RIDGE ADDITION
YOSEMITE
 STA 0+00 TO STA 4+12.98

BAUGHMAN COMPANY P.A.
 ENGINEERING, SURVEYING, & PLANNING

316-262-7271 • 315 ELLIS • WICHITA, KANSAS 67211

DESIGN NBW	DRAWN TMS	APPROVED	DATE 05/03	SCALE Noted	SHEET 16 OF 48
---------------	--------------	----------	---------------	----------------	-------------------------

02-11-4664