

J:\PROJECTS\2017\1601010289_SILVERDALE WATER MAIN REPLACEMENT_160289 CAD\SHS\160289 CAD\SHS\160289-WM-01.DWG
 PLOTTED: Wednesday, September 13, 2017 @ 11:25AM

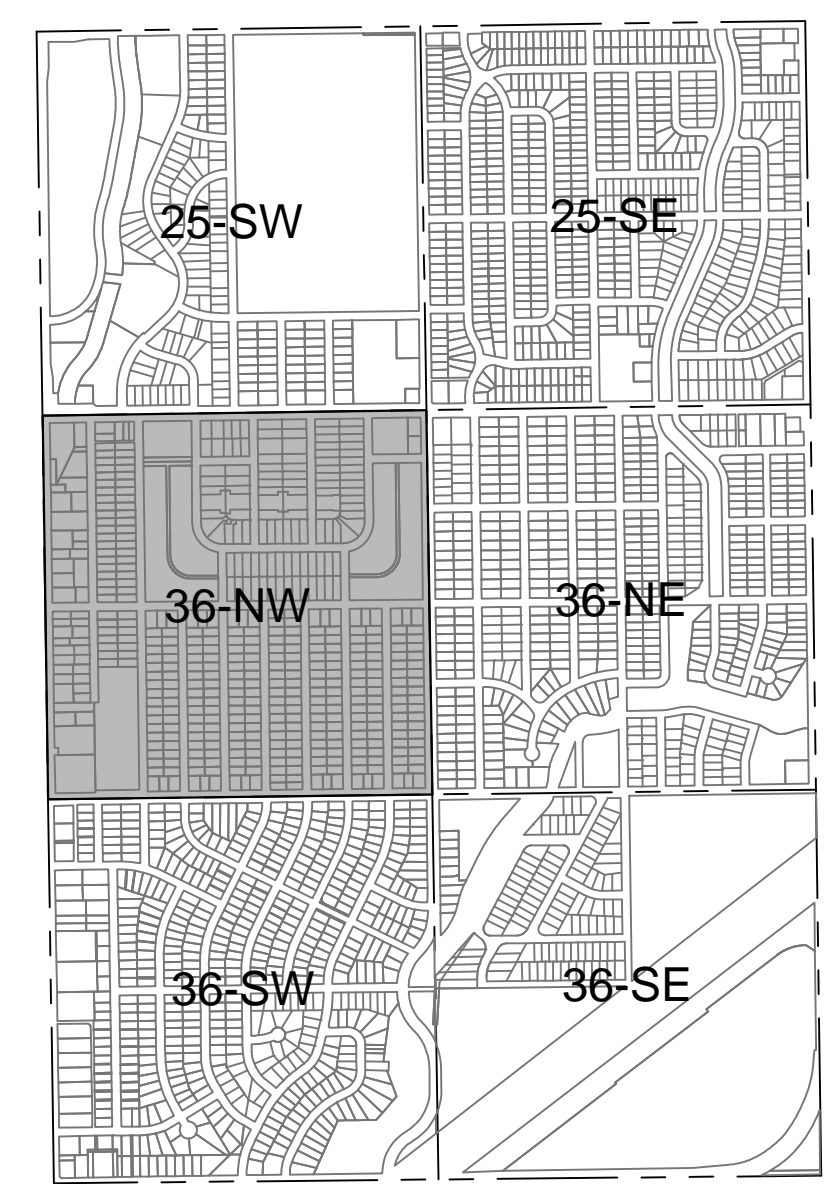

VICINITY MAP

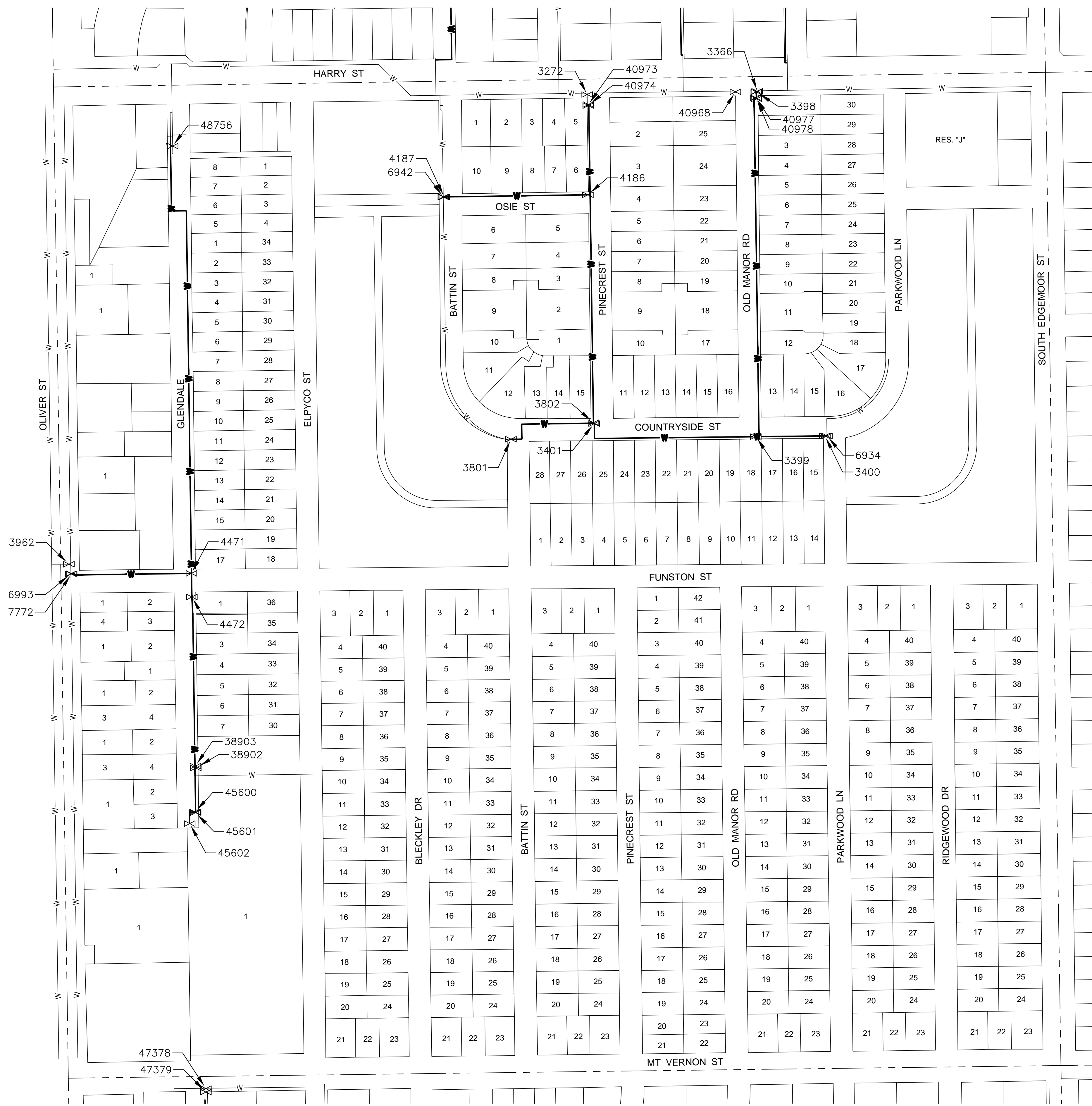
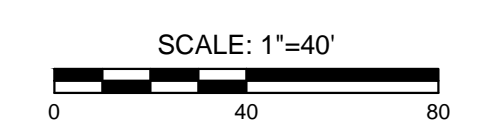
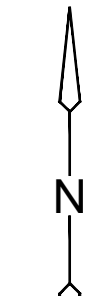

LEGEND

- XXXX = EXISTING WATER VALVE
- W- = EXISTING WATER LINE (TO REMAIN IN SERVICE)
- |— = EXISTING WATER LINE (TO BE ABANDONED)

WATER VALVES TO BE DISABLED*							
VALVE NUMBER	SIZE	DESCRIPTION	NEAREST INTERSECTION	BL STATION & OFFSET**	QUANTITY	REFER TO SHEET	
4471	2"	GATE VALVE	GLENDALE & FUNSTON	36+83, 18' RT., GLENDALE	1		
4472	2"	GATE VALVE	GLENDALE & FUNSTON	36+20, 18' RT., GLENDALE	1		
38902	2"	GATE VALVE	GLENDALE & FUNSTON	31+63, 22' RT., GLENDALE	1	17	
45600	2"	GATE VALVE	GLENDALE & FUNSTON	30+46, 18' RT., GLENDALE	1		
45601	2"	GATE VALVE	GLENDALE & FUNSTON	30+44, 20' RT., GLENDALE	1		
45602	2"	BLOWOFF	GLENDALE & FUNSTON	30+15, 4' RT., GLENDALE	1		
4186	2"	GATE VALVE	PINECREST & OSIE	13+65, 21' LT., OSIE	1	18	
4187	2"	GATE VALVE	BATTIN & OSIE	9+80, 21' LT., OSIE	1		
6942	1"	CORP STOP	BATTIN & OSIE	9+78, 21' LT., OSIE	3		
6993	1"	CORP STOP	OLIVER & FUNSTON	10+26, 23' LT., FUNSTON	2		
7772	2"	GATE VALVE	OLIVER & FUNSTON	10+28, 23' LT., FUNSTON	1		
3401	2"	GATE VALVE	COUNTRYSIDE & PINECREST	41+51.9, 23' LT., PINECREST	1	19	
3802	2"	GATE VALVE	COUNTRYSIDE & PINECREST	41+54.5, 25' LT., PINECREST	1		
40974	2"	GATE VALVE	HARRY & PINECREST	50+02, 26' LT., PINECREST	1		
3398	8"	GATE VALVE	HARRY & OLD MANOR	50+31.4, 28' RT., OLD MANOR	1	20	
3399	2"	GATE VALVE	COUNTRYSIDE & OLD MANOR	16+35, 22' RT., COUNTRYSIDE	1		
40977	2"	GATE VALVE	HARRY & OLD MANOR	50+16, 27' RT., OLD MANOR	1		
40978	2"	BLOWOFF	HARRY & OLD MANOR	50+13, 29' RT., OLD MANOR	1		
3801	2"	GATE VALVE	COUNTRYSIDE & BATTIN	26+92, 20' LT., BATTIN	1	21	
3400	2"	GATE VALVE	COUNTRYSIDE & PARKWOOD	18+19, 22' RT., COUNTRYSIDE	1		
6934	1"	CORP STOP	COUNTRYSIDE & PARKWOOD	18+24, 22' RT., COUNTRYSIDE	3		

* REFER TO PLAN SHEETS FOR DISCONNECT CALLOUTS
 ** STATIONS & OFFSETS ARE APPROXIMATE LOCATIONS



WATER MAIN REPLACEMENT PLANS FOR
SILVERDALE ADDITION PART A

©2017 MKEC Engineering All Rights Reserved
 These drawings and their contents, including, but not limited to, all concepts, designs, & ideas are the exclusive property of MKEC Engineering (MKEC), and may not be used or reproduced in any way without the express consent of MKEC.

VALVE MAP 36-NW

PROJECT NO.	448-90720	
DATE	SEPT. 2017	
SCALE	1" = 150'	
DESIGNED	DFL	
DRAWN	JWC	
CHECKED	GJA	
NO.	REVISION	DATE

SHEET NO.