

J:\PROJECTS\2017\1601010289_SILVERDALE WATER MAIN REPLACEMENT_160289 CAD\SHS\505 CIVIL\WTRPHASE 1\16289-WM-01.DWG
 PLOTTED: Wednesday, September 13, 2017 @ 11:25AM

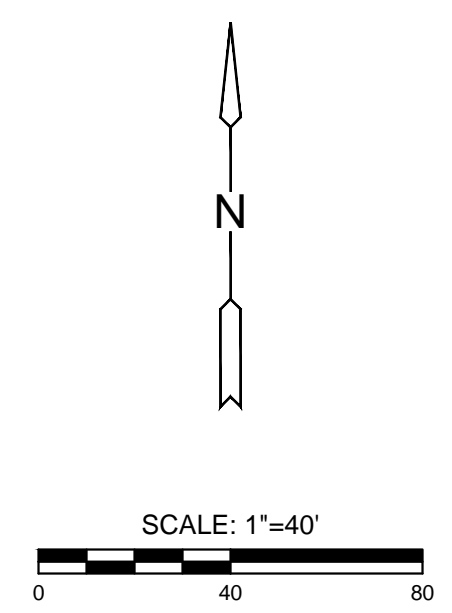

- LEGEND**
- XXXX Δ = EXISTING WATER VALVE
 - W— = EXISTING WATER LINE (TO REMAIN IN SERVICE)
 - W— = EXISTING WATER LINE (TO BE ABANDONED)

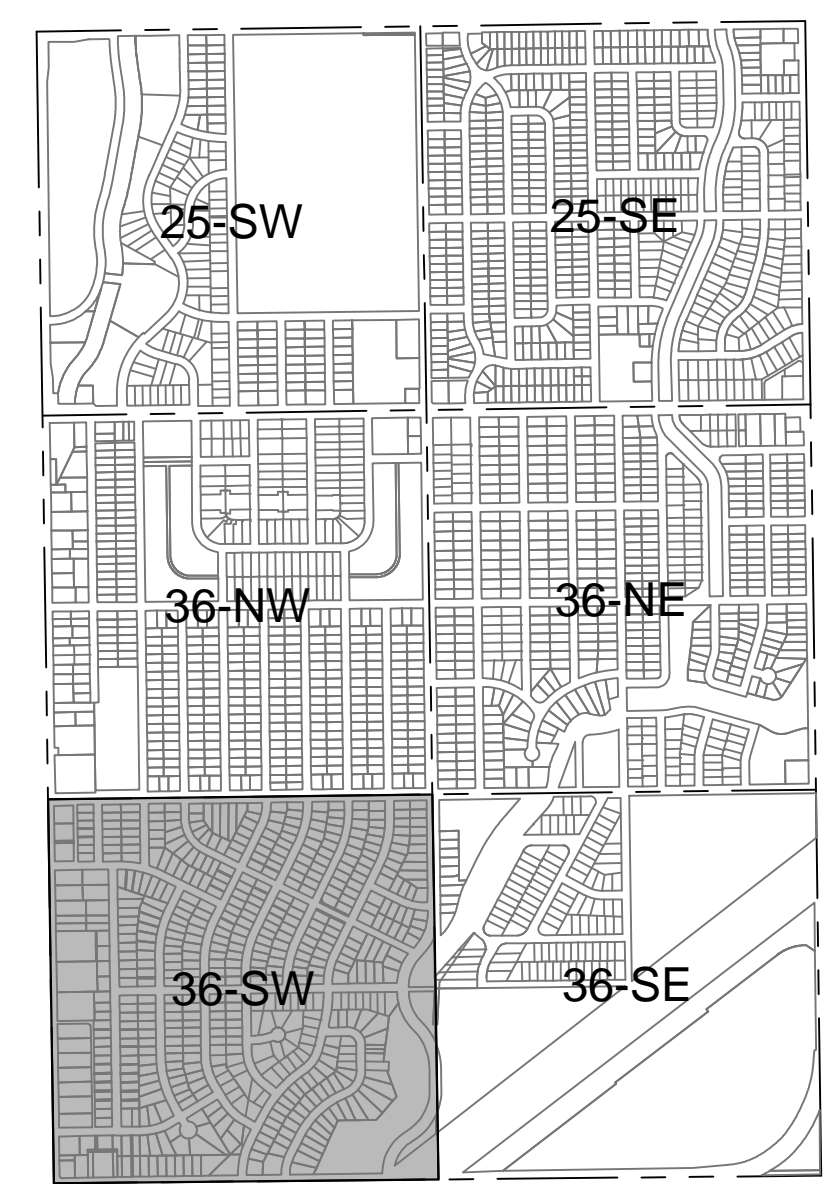

VICINITY MAP

WATER VALVES TO BE DISABLED*

VALVE NUMBER	SIZE	DESCRIPTION	NEAREST INTERSECTION	BL STATION & OFFSET*	QUANTITY	REFER TO SHEET
47378	8"	GATE VALVE	MOUNT VERNON & GLENDALE	22+92, 24' RT., GLENDALE	1	22
47379	2"	BLOWOFF	MOUNT VERNON & GLENDALE	22+83, 24' RT., GLENDALE	1	
3541	2"	GATE VALVE	LARRY & GLENDALE	18+90, 22' RT., GLENDALE	1	23
3839	2"	GATE VALVE	LARRY & GLENDALE	18+36, 19' RT., GLENDALE	1	
3468	2"	GATE VALVE	LARRY & ELPYCO	16+71, 36' LT., LARRY LANE	1	24
3787	2"	GATE VALVE	LARRY & ELPYCO	16+79, 34' LT., LARRY LANE	1	
3866	2"	GATE VALVE	LARRY & ELPYCO	19+25, 19' LT., LARRY LANE	1	25
3788	2"	GATE VALVE	LARRY & PINECREST	22+24, 20' LT., LARRY LANE	1	
6914	1"	CORP STOP	LARRY & PINECREST	22+32, 20' LT., LARRY LANE	2	26
691	1"	CORP STOP	GLENDALE & KINKAID	9+76, 21' RT., GLENDALE	3	
4501	2"	GATE VALVE	GLENDALE & KINKAID	10+38, 21' RT., GLENDALE	1	27
4502	2"	GATE VALVE	ELPYCO & KINKAID	19+20, 19' LT., ELPYCO	1	
4503	2"	GATE VALVE	ELPYCO & BLAKE	10+31, 17' LT., ELPYCO	1	28
6030	1"	CORP STOP	ELPYCO & BLAKE	10+23, 17' LT., ELPYCO	2	
5404	2"	GATE VALVE	OLD MANOR RD & OLD MANOR CT	6+29, 17' LT., OLD MANOR RD	1	29
5666	2"	GATE VALVE	KINKAID & RIDGEWOOD	24+33, 20' RT., KINKAID	1	
5303	2"	GATE VALVE	KINKAID & RIDGEWOOD	24+46, 24' RT., KINKAID	1	30
6915	1"	CORP STOP	KINKAID & RIDGEWOOD	24+41, 20' RT., KINKAID	3	
58075	1"	CORP STOP	KINKAID & RIDGEWOOD	24+41, 24' RT., KINKAID	3	31
5667	2"	GATE VALVE	KINKAID & PARKWOOD	21+38, 18' RT., KINKAID	1	
4514	2"	GATE VALVE	PARKWOOD & GRAMAR	15+99, 22' LT., PARKWOOD	1	32
58066	1" 3/4"	CORP STOP	PARKWOOD & GRAMAR	16+03, 22' LT., PARKWOOD	2 1	
5304	2"	GATE VALVE	RIDGEWOOD & BUNTING	10+25, 20' RT., BUNTING	1	31
5305	2"	GATE VALVE	BUNTING & EDGEMOOR	14+42, 20' RT., BUNTING	1	
6917	1"	CORP STOP	RIDGEWOOD & BUNTING	9+76, 20' RT., BUNTING	2	32
6918	1"	CORP STOP	BUNTING & EDGEMOOR	14+44, 20' RT., BUNTING	2	
58054	1"	CORP STOP	LARRY & ELPYCO	26+62, 23' RT., ELPYCO	3	32
-	1"	CORP STOP	LARRY & ELPYCO	26+79, 18' RT., ELPYCO	3	

* REFER TO PLAN SHEETS FOR DISCONNECT CALLOUT
 ** STATIONS & OFFSETS ARE APPROXIMATE LOCATIONS



WATER MAIN REPLACEMENT PLANS FOR
SILVERDALE ADDITION PART A

©2017 MKEC Engineering All Rights Reserved
 These drawings and their contents, including, but not limited to, all concepts, designs, & ideas are the exclusive property of MKEC Engineering (MKEC), and may not be used or reproduced in any way without the express consent of MKEC.

VALVE MAP 36-SW

PROJECT NO.	448-90720	
DATE	SEPT. 2017	
SCALE	1" = 150'	
DESIGNED	DFL	
DRAWN	JWC	
CHECKED	GJA	
NO.	REVISION	DATE