

BENCHMARKS:
 BM #1: Railroad spike in HLP
 2' West of center Sec. 11,
 T-27-S, R-2-W
 (S. Face of HLP)
 Elev. = 1367.70 NGVD29

BM #2: "□" Cut in top of
 curb adjacent to the Southwest
 Corner, Lot 11, Block B,
 Blackstone Addition
 Elev. = 1369.85 NGVD29

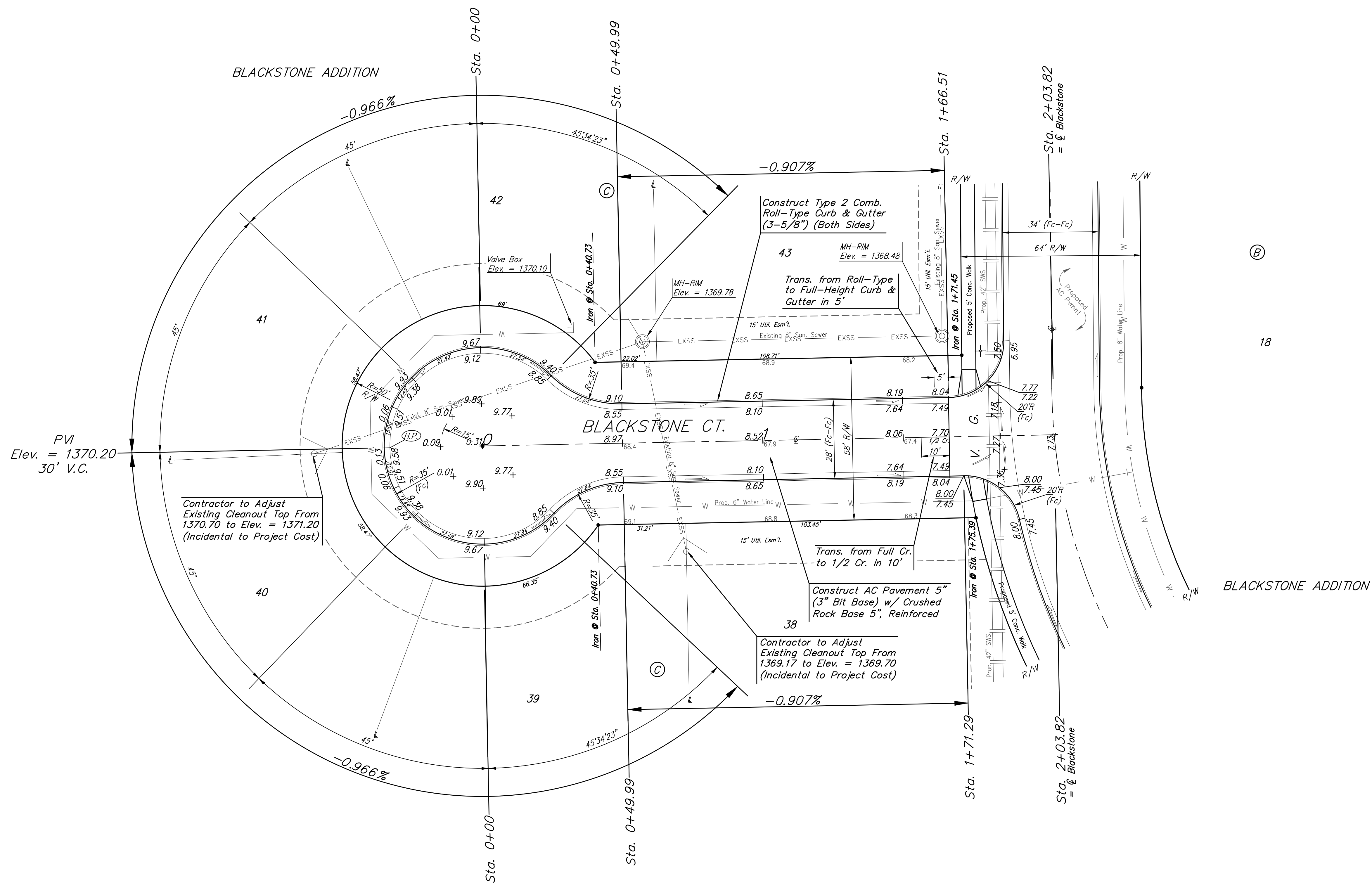
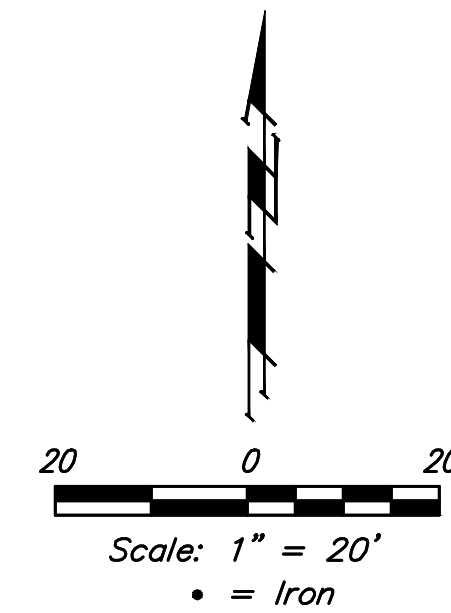

ⓑ

18

BLACKSTONE ADDITION

Roll type curb & gutter to be constructed on the pavement on this sheet. Top of curb elevation are given for full height curb.

		Blackstone Addition - Phase III	
		BLACKSTONE CT	
Lot 38 - Lot 43, Block C		Baughman Company, P.A. 315 Ellis St. Wichita, KS 67211 P 316-262-7271 F 316-262-0149 ENGINEERING SURVEYING PLANNING LANDSCAPE ARCHITECTURE	
PROJECT NUMBER 472-84399	DESIGN NBW	DRAWN JAK	DATE 8/27/18
REVISIONS:	APPROVED	SCALE Noted	SHEET 11 OF 41