

PLOTTED: Wednesday, August 22, 2018 @ 08:58AM

J:\PROJECTS\2017\1701010143_LANGE_STEEPLE_BAY_17143_CADD\SHOTS\05_CIVIL\SWS\17143-05-4207.DWG

NOTE:
CONTRACTOR TO VERIFY THE
DEPTH AND LOCATION OF EXISTING
UTILITIES PRIOR TO CONSTRUCTION.

STA. 16+97.1, SWS LINE 4=
STA. 10+00.00, SWS LINE 6=
BL. STA. 19+25.00, 29.7' LT.

STA. 21+12.2, SWS LINE 4=
BL. STA. 15+75.00, 28.7' RT.
INSTALL TYPE 1A
CURB INLET (5'X3')
INLET TOP=1279.6
PROVIDE SEDIMENT BARRIER

STA. 20+54.4, SWS LINE 4=
BL. STA. 15+75.00, 29.2' LT.
INSTALL TYPE 1A
CURB INLET (5'X4')
INLET TOP=1279.6
PROVIDE SEDIMENT BARRIER

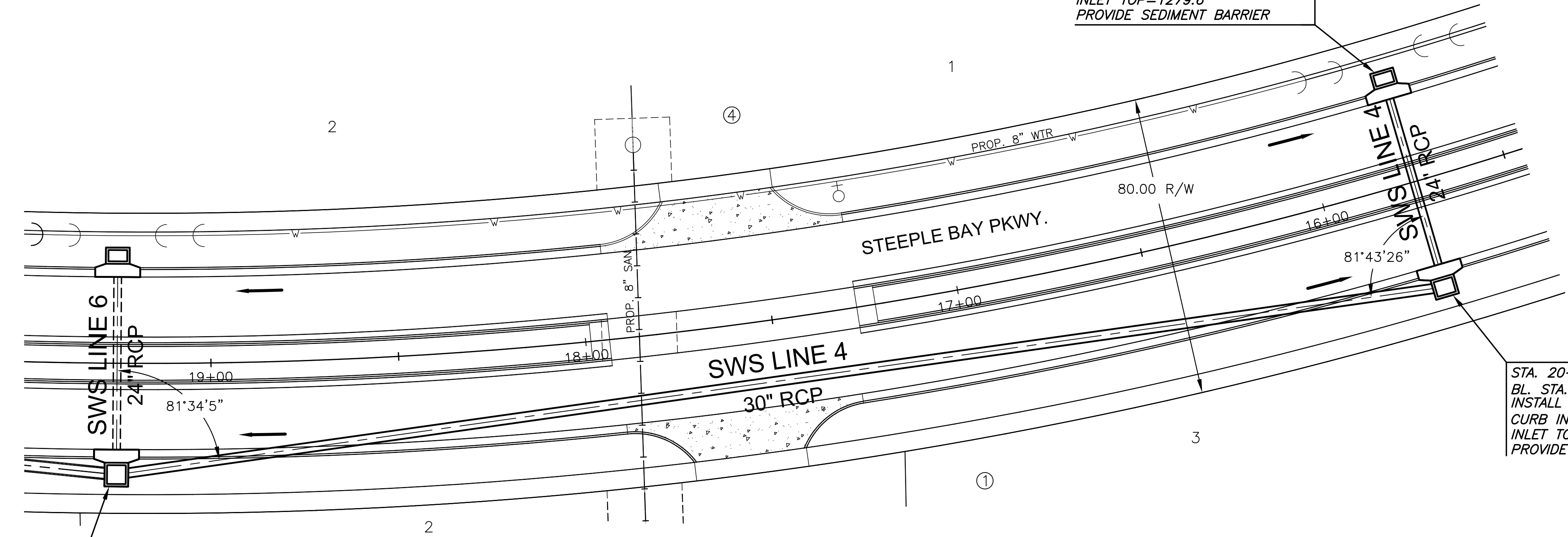

PLAN SWS LINE 4 (CONT. 2)
PROFILE SWS LINE 4 (CONT. 2)

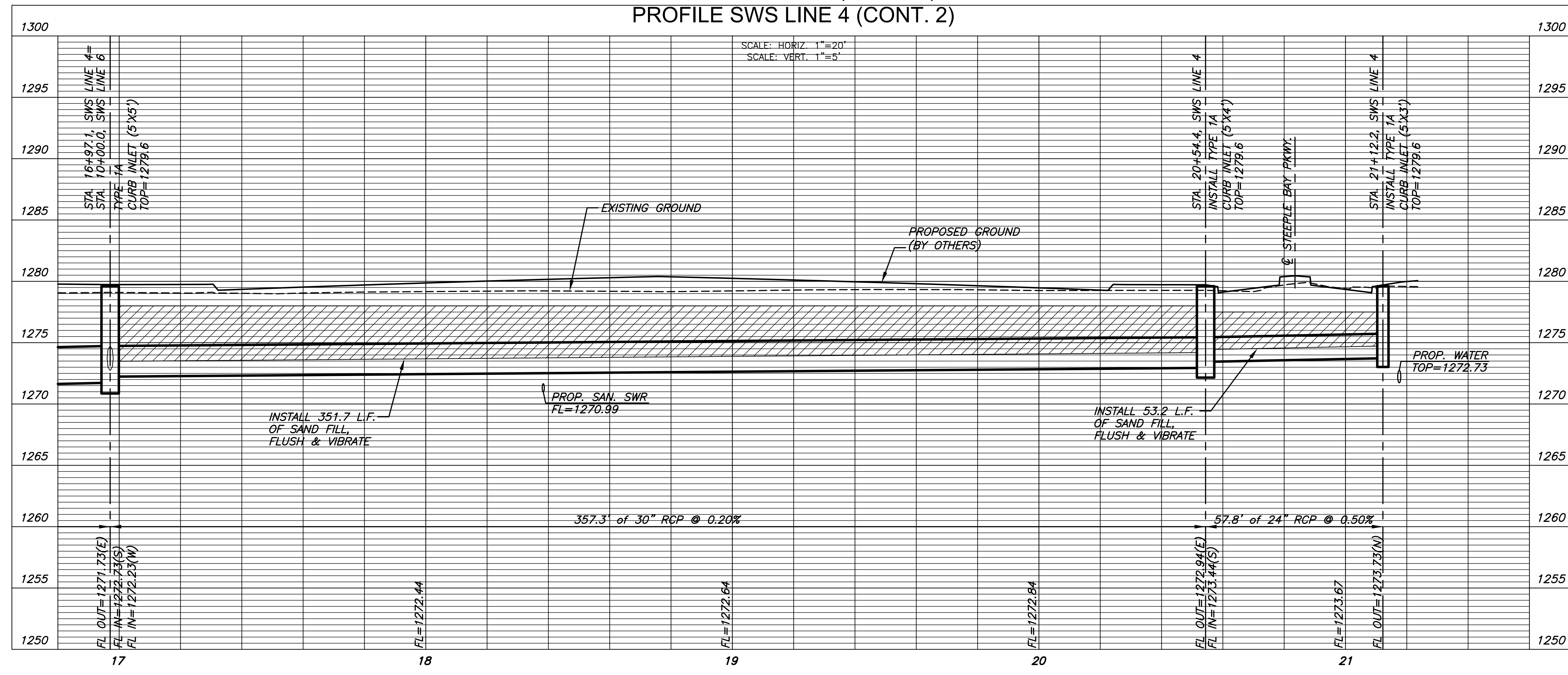

©2018
MKEC Engineering
All Rights Reserved
www.mkec.com
These drawings and their contents,
including, but not limited to, all concepts,
designs, & ideas are the exclusive
property of MKEC Engineering (MKEC),
and may not be used or reproduced in any
way without the express consent of MKEC.

SWS LINE 4 CONT.	
PROJECT NO.	468-85316
DATE	JULY 2018
SCALE	1"=20'
DESIGNED	DRAWN
SPE	MKB
CHECKED	SPE
NO.	REVISION
DATE	
SHEET NO. 13 OF 22	