

PAVING & INCIDENTAL DRAINAGE FOR
AUBURN LAKES ADDITION
PHASE 1

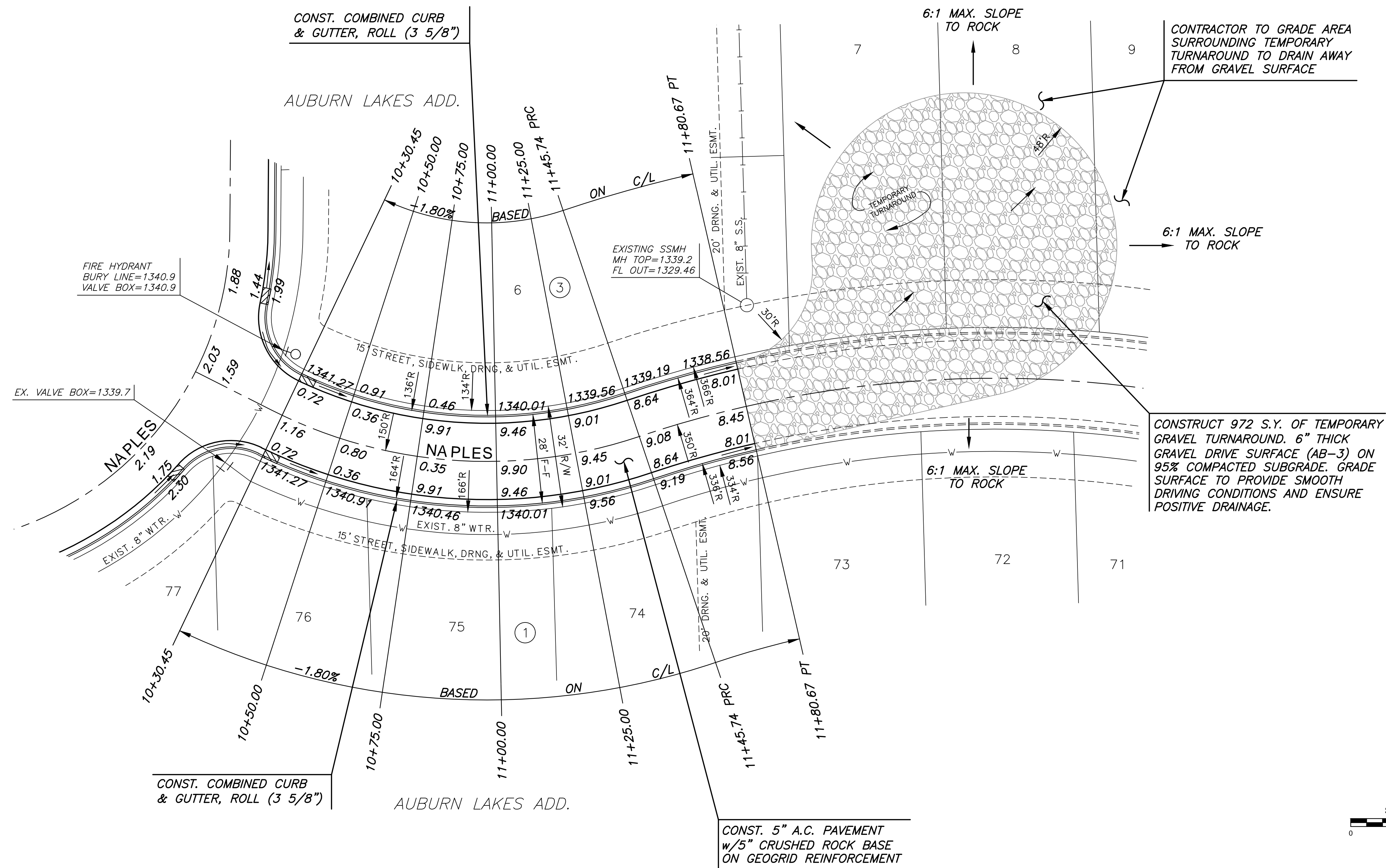

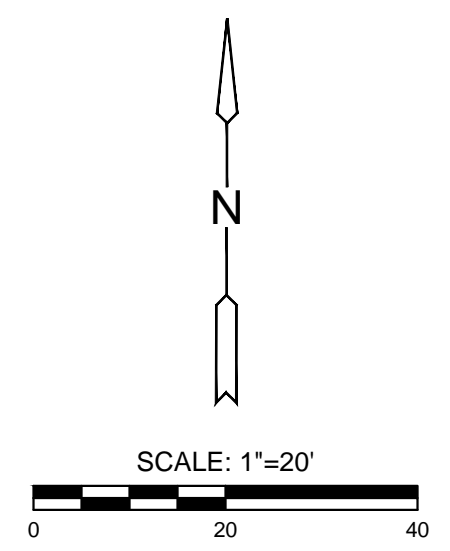

CONTRACTOR TO GRADE AREA SURROUNDING TEMPORARY TURNAROUND TO DRAIN AWAY FROM GRAVEL SURFACE

CONSTRUCT 972 S.Y. OF TEMPORARY GRAVEL TURNAROUND. 6" THICK GRAVEL DRIVE SURFACE (AB-3) ON 95% COMPACTED SUBGRADE. GRADE SURFACE TO PROVIDE SMOOTH DRIVING CONDITIONS AND ENSURE POSITIVE DRAINAGE.

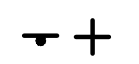

- NOTES:**
- TOP OF CURB ELEVATIONS SHOWN ARE FOR FULL CURB. CONSTRUCT CURB AND GUTTER AS NOTED.
 - PVC SLEEVES TO BE BURIED AT A DEPTH OF 2' TO TOP OF SLEEVE, MINIMUM.

- LEGEND**
-  STREET SIGN & SIGN LOCATION (SEE SIGN ASSEMBLY TABLE FOR TYPE & STATION OF SIGN)
 -  5' TRANSITION FROM FULL TO ROLL CURB

©2018 MKEC Engineering All Rights Reserved www.mkec.com
These drawings and their contents, including, but not limited to, all concepts, designs, & ideas are the exclusive property of MKEC Engineering (MKEC), and may not be used or reproduced in any way without the express consent of MKEC.

NAPLES		
PROJECT NO.	472-85327	
DATE	SEPT. 2018	
SCALE	1" = 20'	
DESIGNED	DFL	
DRAWN	JWC	
CHECKED	GJA	
NO.	REVISION	DATE
SHEET NO.		
13 OF 48		