

Pawnee Road  
Existing AC Pavement

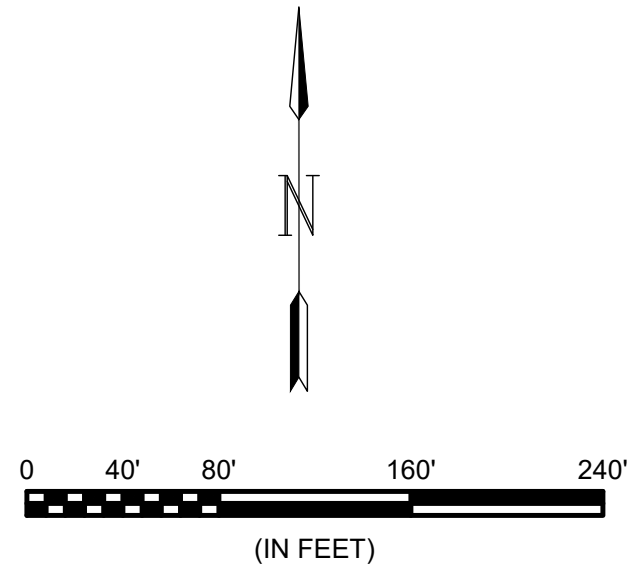
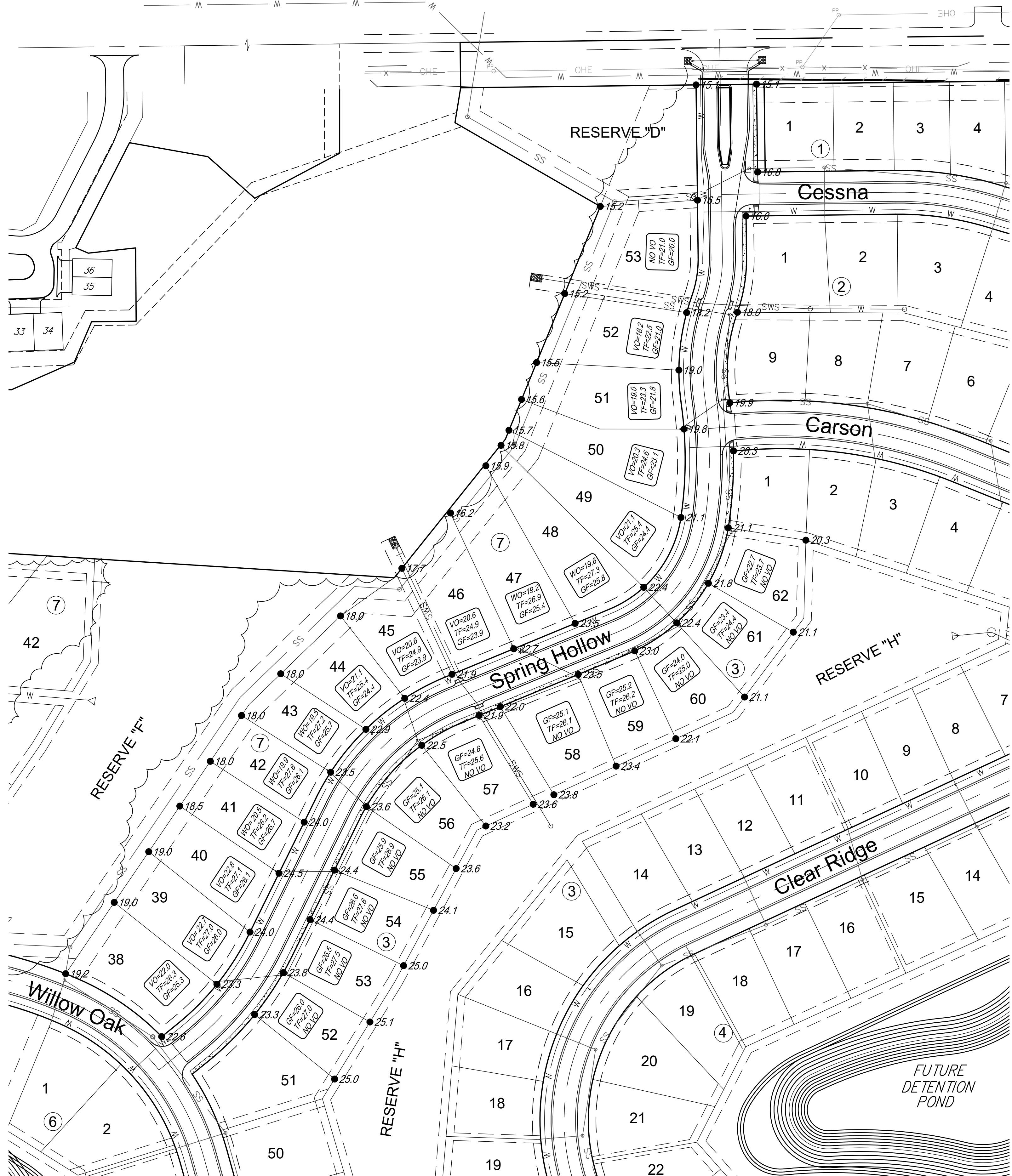

MINIMUM BUILDING PAD ELEVATION FOR LOWEST OPENING INTO STRUCTURES		
BLOCK	LOT NO.	ELEVATION (NAVD88)
7	38, 39, 40, 41, 42, 43, 44	1315.4
7	45, 46, 47, 48, 49, 50	1315.1

- NOTES:
- VIEW OUT (VO) ELEVATIONS ARE 4.3' BELOW TOP OF FOUNDATION (TF)
  - WALK OUT (WO) ELEVATIONS ARE CONSIDERED THE TOP OF BASEMENT FLOOR ELEVATION, WHICH IS 7.7' BELOW THE TOP OF FOUNDATION.
  - GARAGE FLOOR (GF) ELEVATIONS ARE FRONT OF GARAGE

**Benchmarks**

*BENCHMARK: CHISELED SQUARE ON THE TOP OF CURB ON THE SOUTH END OF THE MEDIAN OF IRONSTONE, 55' N. OF THE CENTERLINE OF PAWNEE AVENUE, SIERRA HILLS 2ND ADDITION, ELEVATION = 1320.03 (NAVD88, G12A)*

*ON-SITE BENCHMARK: SRB BRASS DISC 340' W. & 50' S. OF THE CENTERLINE INTERSECTION PAWNEE AVENUE & 143RD STREET EAST, ELEVATION = 1315.65 (NAVD88, G12A)*

File: L:\2017\17264889 - Clear Ridge Phase 1\Drawings\C3D\Paving + Storm\20 - Four-Corner Grading Plan.dwg Last Save: 10/10/2018 3:24 PM Last saved by: MTDolechek  
 Last plotted by: Dolechek, Mark T. Plot Date: 10/11/2018 9:31 AM Plotter used: None

© 2017 GARVER, LLC  
 THIS DOCUMENT, ALONG WITH THE IDEAS AND DESIGNS CONVEYED HEREIN, SHALL BE CONSIDERED INSTRUMENTS OF PROFESSIONAL SERVICE AND ARE PROPERTY OF GARVER, LLC. ANY USE, REPRODUCTION, OR DISTRIBUTION OF THIS DOCUMENT, ALONG WITH THE IDEAS AND DESIGN CONTAINED HEREIN, IS PROHIBITED UNLESS AUTHORIZED IN WRITING BY GARVER, LLC OR EXPLICITLY ALLOWED IN THE GOVERNING PROFESSIONAL SERVICES AGREEMENT FOR THIS WORK.

Digitally Signed 10/11/2018

REV.	DATE	DESCRIPTION	BY

CITY OF WICHITA  
WICHITA, KS

CLEAR RIDGE ADDITION,  
PHASE 1

Four-Corner  
Grading

JOB NO.: 17264889  
 DATE: OCT 2018  
 DESIGNED BY: MTD  
 DRAWN BY: MTD/CDJ

BAR IS ONE INCH ON ORIGINAL DRAWING  
 0" = 1" IF NOT ONE INCH ON THIS SHEET, ADJUST SCALES ACCORDINGLY.

DRAWING NUMBER

SHEET NUMBER **21** OF **25**