

SURVEY DISCLAIMER:
 TOPOGRAPHIC SURVEY AND CONTOUR MAP USED IN PREPARING PLANS WAS PROVIDED BY BAUGHMAN COMPANY P.A., 315 ELLIS, WICHITA, KS (316)262-7271. ENGINEER DOES NOT GUARANTEE SURVEY ELEVATIONS FOR ACCURACY. CONTRACTOR SHALL VERIFY ELEVATIONS AND NOTIFY ENGINEER OF ANY DISCREPANCIES.

UTILITIES SHOWN REPRESENT THE BEST INFORMATION AVAILABLE FOR DESIGN. ADDITIONAL UTILITIES MAY BE PRESENT ON THIS PROJECT. THE CONTRACTOR SHALL BE RESPONSIBLE FOR DETERMINING THE EXACT LOCATION, DEPTH AND SIZE OF ALL UNDERGROUND UTILITIES PRIOR TO CONSTRUCTION. THE CONTRACTOR SHALL BE LIABLE FOR ANY DAMAGE CAUSED BY THE FAILURE TO DO SO.

DETENTION POND PLAN

RETAIL & OFFICE/WAREHOUSE BUILDINGS

Wichita, Kansas

EXISTING DRAINAGE DATA
 Area = 2.25 acres
 SCS Soil Type B
 Furrum Loam
 C(5) = 0.22
 C(100) = 0.41
 Tc = 33 min.
 S = 3.14"/hr.
 I 100 = 5.26"/hr.
 Q 5 = 1.55 cfs
 Q 100 = 4.79 cfs

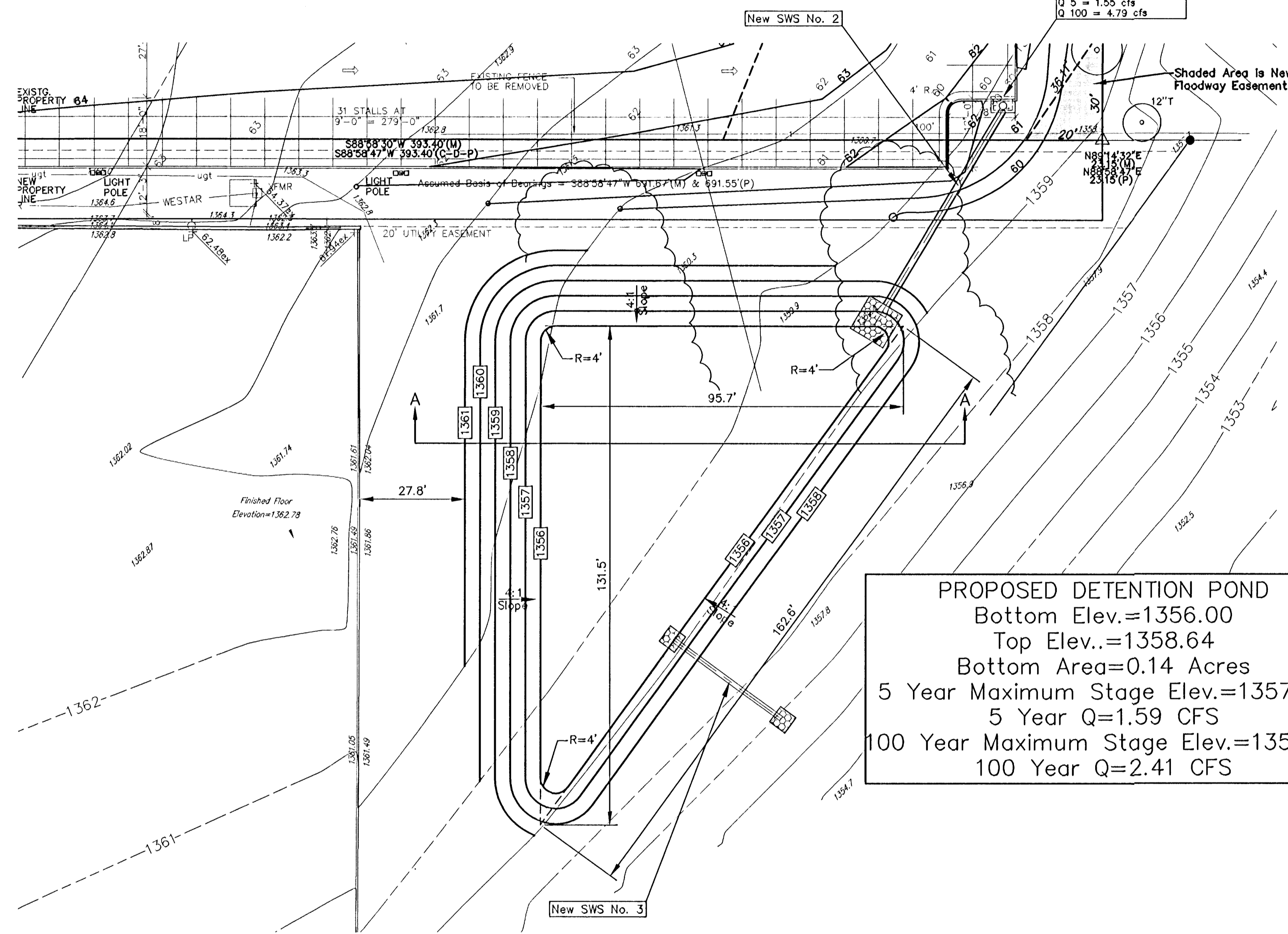

PROPOSED DETENTION POND
 Bottom Elev.=1356.00
 Top Elev.=1358.64
 Bottom Area=0.14 Acres
 5 Year Maximum Stage Elev.=1357.04
 5 Year Q=1.59 CFS
 100 Year Maximum Stage Elev.=1357.57
 100 Year Q=2.41 CFS

- UTILITY OPERATING AUTHORITIES**
- Storm Water Sewer - Steve Laskley
City of Wichita
City Hall - 455 N. Main
Wichita, KS 67202 316-268-4928
 - Water & Sanitary Sewer - Bill Perkins
Wichita Water & Sewer Department
City Hall - 455 N. Main
Wichita, KS 67202 316-268-4555
 - Agula Gas Company - Chris Briggs
1611 South Hoover
Wichita, KS 67209 316-941-1608
 - Kansas Gas Service - James Cox
1027 East 28th Street North
Wichita, KS 67218 316-832-3101
 - Water Energy - Shane Price
209 N. West
Wichita, KS 67202 316-261-6824
 - SBC - Jim Tobin
154 North Broadway, Room 210
Wichita, KS 67202 316-268-2245
- LEGEND**
- EB = Electric Box
 - FH = Fire Hydrant
 - GP = Guy Pole
 - GA = Guy Anchor
 - LP = Light Pole
 - SSM = Sanitary Sewer Manhole
 - SBC Ped = SBC Telephone Pedestal
 - WM = Water Meter
 - XPMR = Transformer
- LEGAL DESCRIPTION**
 Lot 1, Under Addition, Wichita, Sedgwick County, Kansas.

- COA = Cox Cable
- SOUTHERN STAR = Southern Star Natural Gas
- KGS = Kansas Gas Service
- WESTAR = Electric Line
- SS = Sanitary Sewer Line
- SSM = Stormwater Sewer Line
- A&T = Telephone Line
- W = Water Line
- X = Fence Line

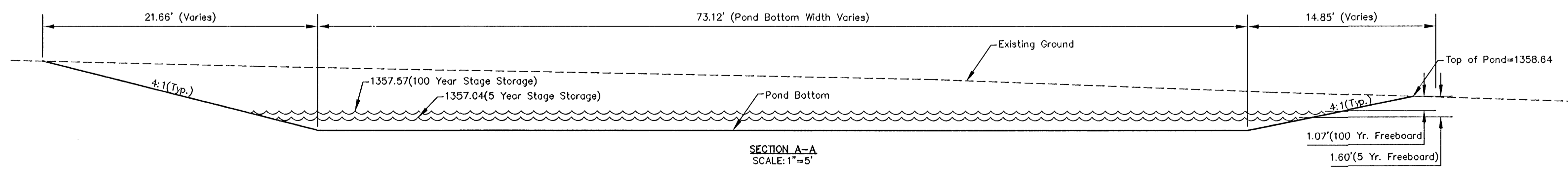

RETAIL & OFFICE/WAREHOUSE CENTER		
DETENTION POND PLAN		
3570 & 3600 N. WOODLAWN AVE., WICHITA, KS		
CED PROJ. NO.: 20061443		
CERTIFIED ENGINEERING DESIGN, P.A.		
810 WEST DOUGLAS, SUITE C		
WICHITA, KANSAS 67203		
PH.(316)262-8808 FAX.(316)262-1669		
DESIGNED: HDF	SCALE: 1"=20'	SHEET 5
DRAWN: CKW	DATE: 7/06	TOTAL 8
CHECKED: HDF	CED FILE: CED-1XXX	