

BENCHMARK:  
City of Wichita benchmark at  
the SE corner of intersection  
of 135th Street West and 13th  
Street North.  
Elev. = 167.83 (City Datum)

Scale: 1" = 20'  
• = Iron

Curve #1  
Curve Data Based on Centerline  
Rad. = 250' Delta = 36° 40' 02" Tangent = 82.84'  
Arc = 159.99' L.C. = 157.27' Def/Ft. = 6.87553 Min.

Station	Arc	FACE CHORD LENGTHS		Defl.	T. Defl.
		8' Lt.	8' Rt.		
2+49.00	-	-	-	0'00"00"	0'00"00"
2+53.36	4.36'	3.92'	4.80'	0'29"59"	0'29"59"
2+54.47	1.11'	1.00'	1.22'	0'07"37"	0'37"37"
2+75.00	20.53'	18.47'	22.58'	2'21"09"	2'58"46"
3+00.00	25.00'	22.49'	27.49'	2'51"53"	5'50"39"
3+25.00	25.00'	22.49'	27.49'	2'51"53"	8'42"32"
3+50.00	25.00'	22.49'	27.49'	2'51"54"	11'34"26"
3+75.00	25.00'	22.49'	27.49'	2'51"53"	14'26"19"
4+00.00	25.00'	22.49'	27.49'	2'51"53"	17'18"12"
4+08.99	8.99'	8.09'	9.89'	1'01"49"	18'20"01"

Curve #2  
Curve Data Based on Centerline  
Rad. = 180' Delta = 36° 40' 02" Tangent = 59.65'  
Arc = 115.19' L.C. = 113.24' Def/Ft. = 9.54958 Min.

Station	Arc	FACE CHORD LENGTHS		Defl.	T. Defl.
		8' Lt.	8' Rt.		
4+08.99	-	-	-	0'00"00"	0'00"00"
4+25.00	16.01'	18.23'	13.78'	2'32"53"	2'32"53"
4+50.00	25.00'	28.45'	21.51'	3'58"44"	6'31"38"
4+75.00	25.00'	28.45'	21.51'	3'58"44"	10'30"22"
5+00.00	25.00'	28.45'	21.51'	3'58"44"	14'29"06"
5+24.18	24.18'	27.52'	20.81'	3'50"55"	18'20"01"

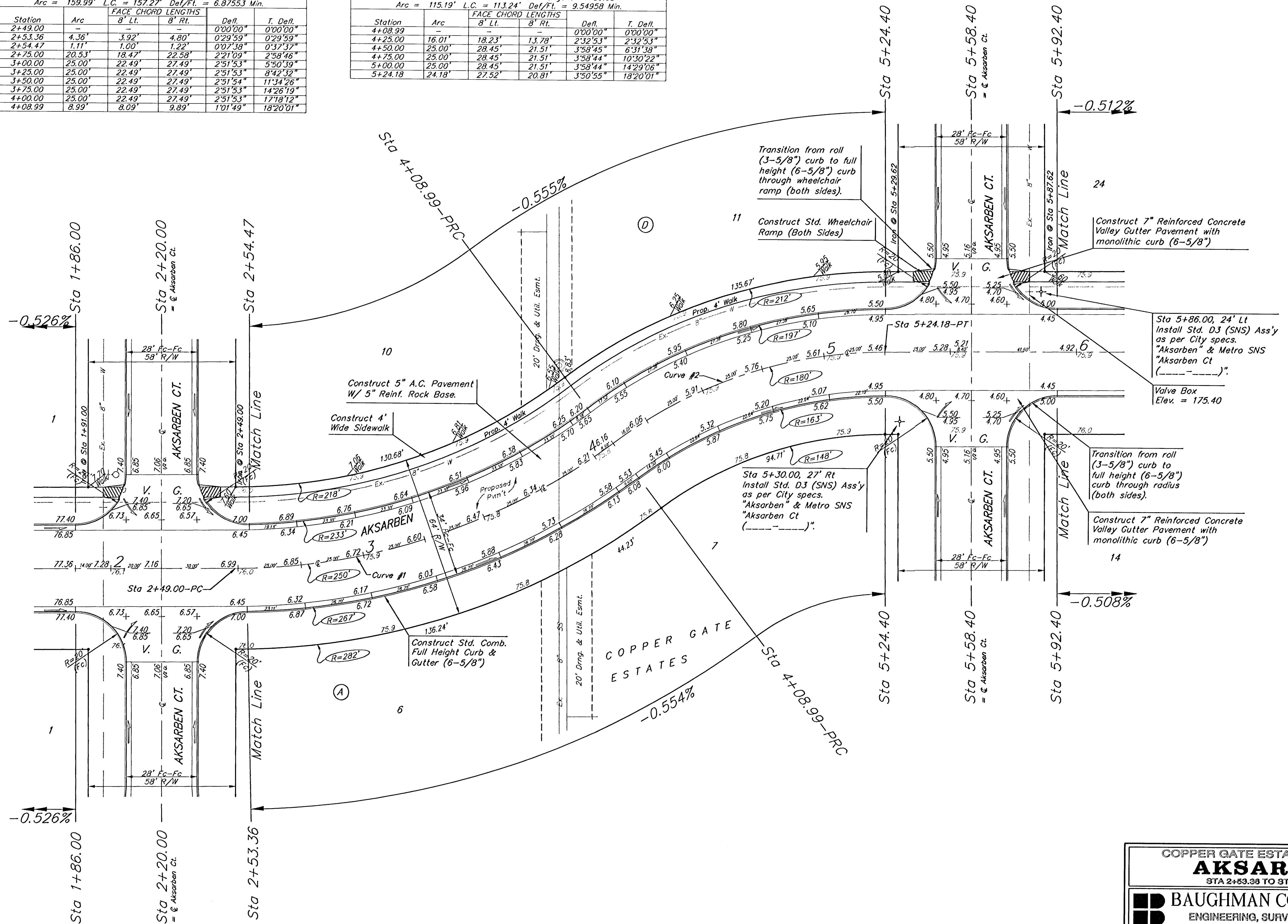

COPPER GATE ESTATES - PHASE I  
**AKSARBEN**  
STA 2+53.36 TO STA 6+92.40

**BAUGHMAN COMPANY P.A.**  
ENGINEERING, SURVEYING, & PLANNING  
318-202-7271 • 318 ELLIS • WICHITA, KANSAS 67211

PROJECT NUMBER  
**472-03689**

DESIGN: BLP    DRAWN: TMS    APPROVED: [Signature]    DATE: 4/30/03    SCALE: Noted

SHEET **7** OF **32**

CopperGate/Siv2 02-10-E432