

BM #1: Small RR spike in NW face of PP, 5.4' NW of the most westerly corner of Lot 1, Block A, Grace Park Addition.  
 Elev. = 158.64 City Datum

BM #2: "□" on top of curb SE corner of Res. "G", Cedarview Addition.  
 Elev. = 161.87 City Datum

BM #3: "□" Centerline face of Curb Inlet, South side of Lincoln and Bedford Ct. extended North.  
 Elev. = 163.78

P.V.I.  
 Elev. = 161.50  
 No V.C.

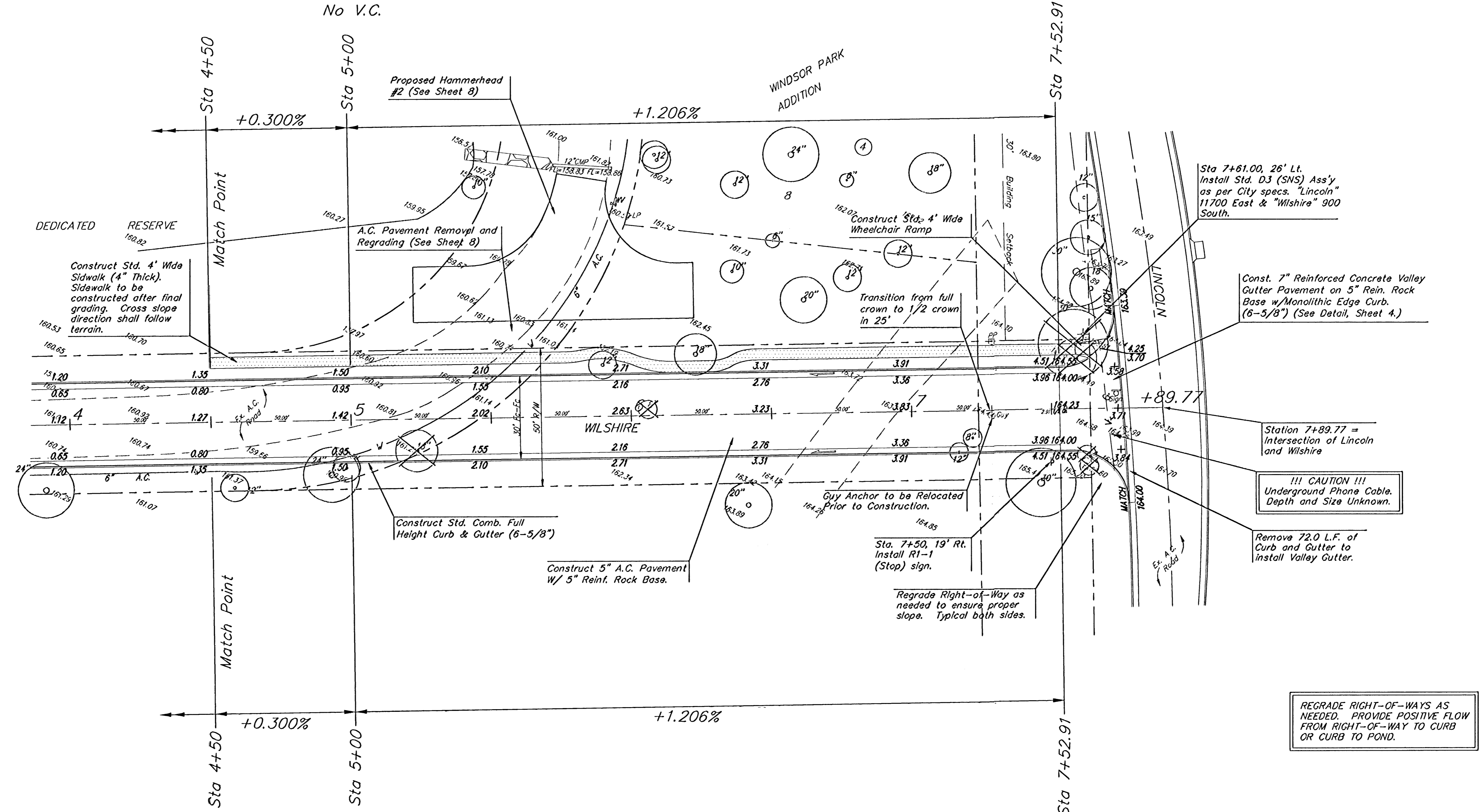

P.V.I.  
 Elev. = 161.50  
 No V.C.

Remove trees only as necessary for street construction. Cost of removal to be incidental to lump sum bid item "Site Clearing & Restoration".

GRACE PARK ADDITION				
<b>WILSHIRE</b>				
STA 4+50 TO STA 7+52.91				
BAUGHMAN COMPANY P.A.				
ENGINEERING, SURVEYING, & PLANNING				
315-282-7271 • 315 ELLIS • WICHITA, KANSAS 67211				
PROJECT NUMBER 472-83797				SHEET 6
DESIGN MWS	DRAWN MWS	APPROVED	DATE 06/03	SCALE Noted
				13