

BENCHMARKS:
 BM #1: "□" Cut on top of curb, 30'± N of the NE corner of Barton Creek, Willowbend North Estates 2nd Addition.
 Elev. = 191.31 City Datum

BM #1: "□" Cut on top of curb at the E end of the NE curb return, Castle Pines St. & Barton Creek.
 Elev. = 196.79 City Datum

Scale: 1" = 20'
 • = Iron

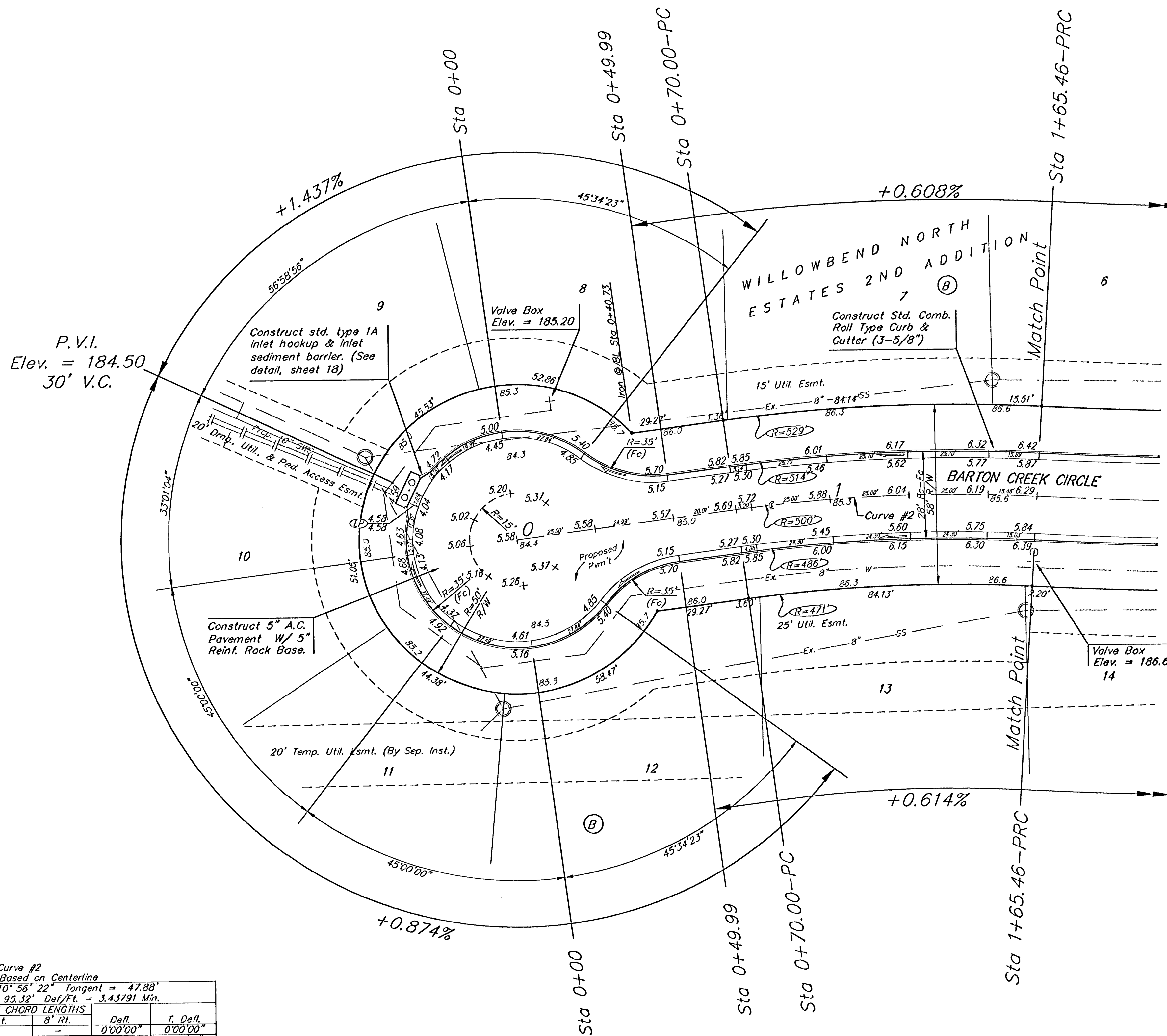

P.V.I.
 Elev. = 184.50
 30' V.C.

Curve #2
 Curve Data Based on Centerline
 Rad. = 500' Delta = 10° 56' 22" Tangent = 47.88'
 Arc = 95.46' L.C. = 95.32' Def/Ft. = 3.43791 Min.

Station	Arc	FACE CHORD LENGTHS		Def.	T. Def.
		B' Lt.	B' Rt.		
0+70.00	-	-	-	0°00'00"	0'00'00"
0+75.00	5.00'	5.22'	4.79'	0°12'11"	0'12'11"
1+00.00	25.00'	26.10'	23.90'	1°25'57"	1'43'08"
1+25.00	25.00'	26.10'	23.90'	1°25'57"	3'09'05"
1+50.00	25.00'	26.10'	23.90'	1°25'57"	4'35'02"
1+65.46	15.46'	16.14'	14.78'	0°53'09"	5'28'11"

Subdivision Bench Marks

Street & Station	Location Description	Elevation
Barton Creek Circle 1+65.46, 14.25' Rt.	Adjacent to Fire Hydrant near lot line between Lots 13 & 14, Block B.	
Barton Creek Circle 6+48.37, 14.25' Rt.	Adjacent to Fire Hydrant at S. End of E. Curb Return of Barton Creek & Barton Creek Circle.	

NOTE: ROLL TYPE CURB & GUTTER TO BE CONSTRUCTED ON THE PAVEMENT SHOWN ON THIS SHEET. TOP OF CURB ELEVATIONS ARE GIVEN FOR FULL HEIGHT CURB.

WILLOWBEND NORTH ESTATES 2ND ADDITION
BARTON CREEK CIRCLE
 STA 0+00 TO STA 1+65.46

BAUGHMAN COMPANY P.A.
 ENGINEERING, SURVEYING, & PLANNING
 318-262-7271 • 319 ELLIS • WICHITA, KANSAS 67211

PROJECT NUMBER
472-69993

DESIGN: NBW DRAWN: TMS APPROVED: DATE: 07/03 SCALE: Noted

SHEET **6** OF **27**