

TRA	CHK
JSB	DWN
SRS	DSN
05-24-18	FOR OWNER REVIEW
0	REV DATE DESCRIPTION
TIMOTHY R. AUSTIN ENGINEER KS # 11496	
200 N. EMPORIA, SUITE 100 WICHITA, KANSAS 67202 PH. (316) 440-4304 FAX (316) 440-4309 www.kawvalley.com www.kveeng.com	
KAW VALLEY ENGINEERING, INC. IS AUTHORIZED TO OFFER ENGINEERING SERVICES BY KANSAS STATE CERTIFICATE OF AUTHORIZATION # E-113. EXPIRES 12/31/18	
Southfork Lot 5 LOT 5, BLOCK 1 WICHITA, KS	
KEY MAP & GENERAL NOTES	

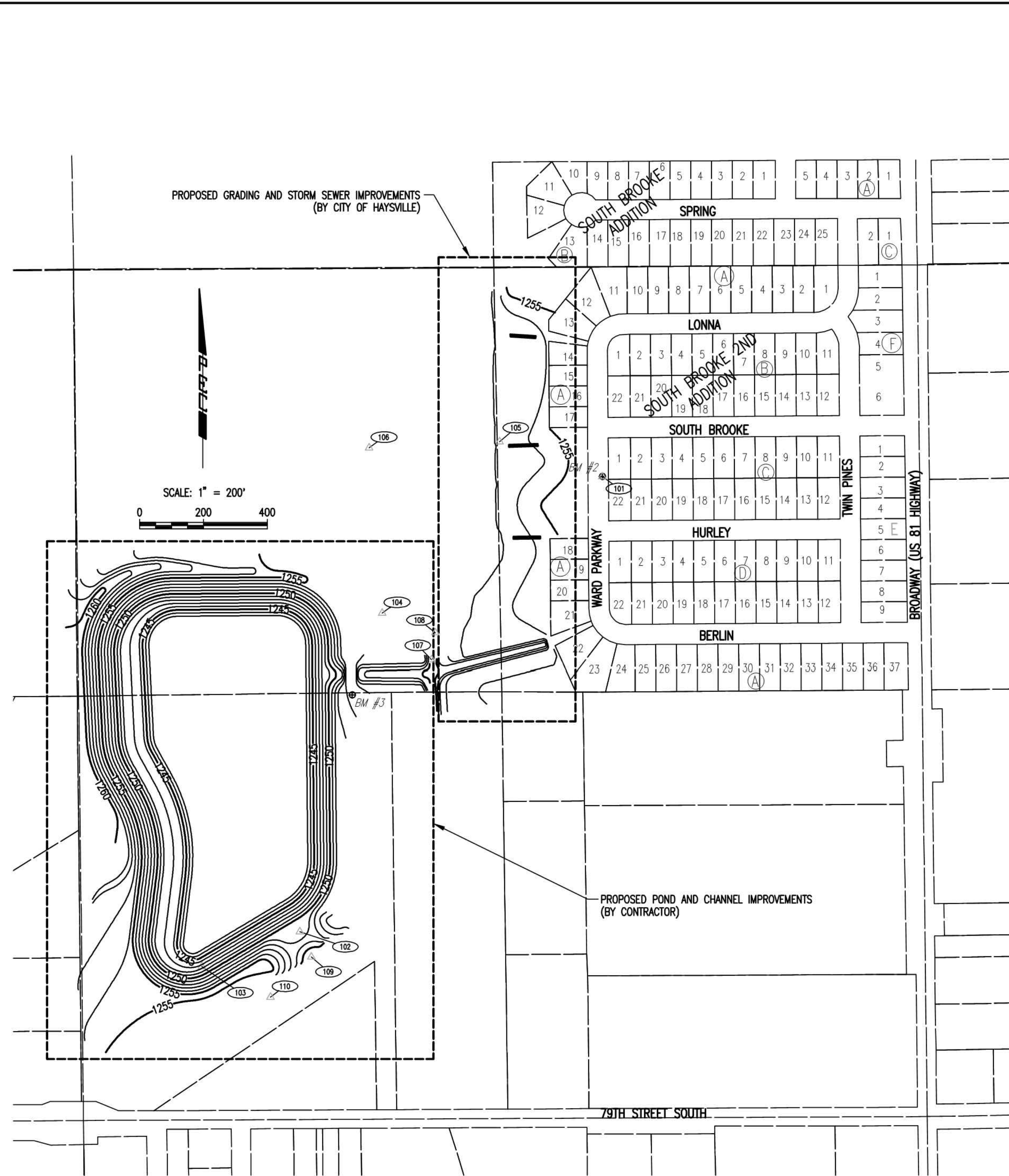

- GENERAL NOTES**
- ALL CONSTRUCTION AND MATERIALS TO COMPLY WITH CITY OF HAYSVILLE STANDARD CONSTRUCTION SPECIFICATIONS AND DETAILS.
 - ALL ELEVATIONS GIVEN IN THE PLANS ARE BASED ON NAVD 88 DATUM.
 - AT LEAST 72 HOURS PRIOR TO BEGINNING EXCAVATION (EXCLUDING WEEKENDS AND HOLIDAYS), THE CONTRACTOR SHALL CONTACT THE KANSAS ONE-CALL SYSTEM, A UTILITY LOCATION SERVICE, AT (316) 687-2470 TO REQUEST FLAGGING OF ALL BURIED CABLE AND PIPELINE WITHIN THE PROJECT AREA BY MEMBER UTILITIES.

 THE CONTRACTOR MUST NOTIFY THE FOLLOWING IN CASE OF ANY EMERGENCY:
 EMERGENCY DISPATCH 911
 BLACK HILLS ENERGY 800-694-8989
 AT&T 800-298-6313
 COX COMMUNICATIONS 800-778-9140
 WESTAR ENERGY 800-383-1183
 KANSAS GAS SERVICE 888-482-4950
 CITY OF HAYSVILLE SANITARY SEWER AND WATER DEPT. 316-529-5940

 THE CONTRACTOR SHALL ALSO CONTACT THE FOLLOWING AT LEAST 48 HOURS PRIOR TO BEGINNING CONSTRUCTION:

 CITY OF HAYSVILLE
 200 W. GRAND
 HAYSVILLE, KS 67060
 ATTN: MR. RANDAL DORNER (316) 529-5940
 - UNDERGROUND AND OVERHEAD UTILITY LINES ARE TO BE ADJUSTED AS NECESSARY BY OTHERS PRIOR TO CONSTRUCTION UNLESS THE PLANS SPECIFICALLY CALL FOR THEIR ADJUSTMENT BY THE CONTRACTOR. EXISTING UTILITIES AND THEIR LOCATIONS AS SHOWN ON THE PLANS REPRESENT THE BEST INFORMATION OBTAINABLE FOR DESIGN. LOCATION INFORMATION HAS BEEN OBTAINED FROM THE VARIOUS UTILITY COMPANIES AND IS EITHER FROM COMPANY RECORD DRAWINGS OR COMPANY PROVIDED FIELD LOCATIONS. ADDITIONAL PUBLIC OR PRIVATE UTILITIES MAY ALSO EXIST WHICH ARE NOT SHOWN ON THE PLANS. THE CONTRACTOR WILL BE REQUIRED TO WORK AROUND EXISTING UTILITIES WITHIN THE RIGHT-OF-WAY WHICH DO NOT CONFLICT WITH PROPOSED CONSTRUCTION.

 WHERE THE IMPROVEMENTS CROSS EXISTING PUBLIC OR PRIVATE UTILITIES WHICH ARE NOT TO BE ADJUSTED BY OTHERS, THE CONTRACTOR SHALL PROVIDE THE MATERIAL AND MEANS TO PROTECT AND SUPPORT SAID UTILITIES DURING CONSTRUCTION TO THE SATISFACTION OF THE ENGINEER. ANY DAMAGE TO SUCH UTILITIES SHALL BE REPAIRED IMMEDIATELY AS DIRECTED BY THE ENGINEER AND AT THE CONTRACTOR'S EXPENSE.
 - CONTRACTOR SHALL SUPPLY, INSTALL, AND MAINTAIN CONSTRUCTION TRAFFIC CONTROL AS NECESSARY TO PROTECT THE TRAVELING PUBLIC. ALL TRAFFIC CONTROL DEVICES, AND THE INSTALLATION AND USE THEREOF, SHALL CONFORM TO THE REQUIREMENTS OF THE MANUAL ON UNIFORM TRAFFIC CONTROL DEVICES (MUTCD), LATEST EDITION. ALL DEVICES SHALL BE REFLECTORIZED. CONSTRUCTION TRAFFIC CONTROL SHALL BE SUBSIDIARY TO OTHER BID ITEMS OF WORK.
 - TREES AND SHRUBS WHICH ARE IN DIRECT CONFLICT WITH PROPOSED NEW CONSTRUCTION SHALL BE REMOVED BY THE CONTRACTOR ONLY WITH THE CITY'S PRIOR APPROVAL. TREES AND SHRUBS WHICH ARE NOT IN DIRECT CONFLICT WITH PROPOSED NEW CONSTRUCTION SHALL BE SAVED AND PROTECTED FROM DAMAGE. ANY INDICATION ON THE PLANS AS TO SPARING OR REMOVING OF TREES IS FOR GENERAL GUIDANCE ONLY. COSTS FOR ALL REMOVAL OR TRIMMING NECESSARY SHALL BE SUBSIDIARY TO THE PROJECT.
 - RUBBLE FROM THE REMOVAL OF EXISTING PAVEMENT OR MISCELLANEOUS STRUCTURES, IF ANY, SHALL BE DISPOSED OF ON SITES TO BE PROVIDED BY THE CONTRACTOR AND APPROVED AS NOTED BELOW.

 ALL DISPOSAL SITES MUST BE APPROVED BY THE KANSAS DEPARTMENT OF HEALTH AND ENVIRONMENT. MATERIAL EITHER STOCKPILED OR DISPOSED OF IN A FLOOD PLAIN WOULD REQUIRE A KANSAS STATE BOARD OF AGRICULTURE PERMIT. ANY MATERIAL DUMPED IN WATERS OF THE UNITED STATES OR WETLANDS IS SUBJECT TO U.S. CORPS OF ENGINEERS PERMITTING REGULATIONS. ANY MATERIAL BURIED OR STOCKPILED BEYOND APPROVED CONSTRUCTION LIMITS WOULD REQUIRE ADDITIONAL ARCHAEOLOGICAL INVESTIGATIONS UNLESS BURIED IN A PREVIOUSLY APPROVED BORROW LOCATION.
 - THE CONTRACTOR SHALL BE RESPONSIBLE FOR PRESERVING PROPERTY IRONS. THE CONTRACTOR WILL BE REQUIRED TO RE-ESTABLISH ANY PROPERTY IRONS WHICH ARE DAMAGED OR DESTROYED BY HIS CONSTRUCTION OPERATIONS, OR WHICH ARE COVERED BY 12" OR MORE OF FILL MATERIAL BY THIS PROJECT. SUCH IRONS SHALL BE RE-ESTABLISHED BY A LICENSED LAND SURVEYOR IN ACCORDANCE WITH STATE LAWS AND AT NO ADDITIONAL COST TO THE OWNER.
 - PRIOR TO CONSTRUCTION, THE CONTRACTOR SHALL RE-ESTABLISH CONTROL POINTS AND BENCH MARKS AND VERIFY THEIR ACCURACY.
 - THE CONTRACTOR SHALL GIVE ALL OWNERS AND/OR TENANTS OF PROPERTY ADJACENT THIS PROJECT A MINIMUM OF TEN DAYS ADVANCE NOTICE PRIOR TO THE START OF CONSTRUCTION.

BENCHMARK LIST
DATUM: NAVD 88

BM #2 - CHISELED "3" ON THE TOP OF THE E CURB OF WARD PARKWAY, E OF THE CENTERLINE OF THE ENTRANCE TO THE LEFT STATION, NEAR THE SW CORNER OF LOT 1, BLOCK C, SOUTH BROOKE 2ND ADDITION. SEE SHEETS 3 AND 5.
ELEV. = 1255.32

BM #3 - TOP OF TEE POST, 4" DEEP, IN-LINE WITH THE E-W HEDGEROW THAT IS ON THE N SIDE OF THE POND, 10' E OF THE CENTERLINE OF THE DIRT ACCESS ROAD, 8.40' E TO THE 600 NAIL IN THE S SIDE OF A 30" ELM TREE, 23.80' W TO THE 600 NAIL IN N SIDE OF 12" ELM TREE, 5.3' NNE TO A SIGN POST. SEE SHEETS 4 AND 6.
ELEV. = 1254.00

- EXISTING GROUND PROVIDED BY FIELD SURVEY AND 2008 SEDGWICK COUNTY LIDAR. PRIOR TO CONSTRUCTION, CONTRACTOR SHALL VERIFY ALL EXISTING ELEVATIONS, GRADES, AND TIE IN LOCATIONS TO PROPOSED IMPROVEMENTS. ANY DISCREPANCIES SHALL BE REPORTED TO THE ENGINEER FOR RESOLUTION. UNDER NO CONDITION WILL PONDING BE ALLOWED.
- WATER FOR EARTHWORK SHALL BE SUBSIDIARY TO "UNCLASSIFIED EXCAVATION".
- EROSION CONTROL (BMP'S)

 THE CONTRACTOR SHALL INSTALL AND/OR MAINTAIN EROSION CONTROL METHODS AS SPECIFIED IN THE PLANS. THE FOLLOWING QUANTITIES ARE ESTIMATED, AND SHOULD BE CONSIDERED THE MINIMUM EFFORT REQUIRED. INSTALLATION OF THESE BMP'S DOES NOT RELIEVE THE CONTRACTOR OF THE RESPONSIBILITY OF ABATING SOIL EROSION.

 BY CONTRACTOR:
 CONSTRUCTION ENTRANCE 1 EACH
 SILT FENCE BARRIER 2,605 L.F.

 BY CITY OF HAYSVILLE:
 SILT FENCE BARRIER 1,365 L.F.

SEEDING NOTES

TEMPORARY PROJECT SEEDING: CONTRACTOR SHALL APPLY TEMPORARY SEED AND MULCH TO ALL AREAS DISTURBED BY CONSTRUCTION ACTIVITIES, EXCEPT AS NOTED BELOW OR SHOWN ON THE PLANS. SEED SHALL BE ANNUAL RYE APPLIED AT THE RATE OF 4 LBS. PER 1000 SQ. FT. TEMPORARY SEEDING AND MULCHING SHALL BE PAID FOR AT LUMP SUM BID FOR "TEMPORARY PROJECT SEEDING".

TEMPORARY SEEDING SHALL BE APPLIED WITHIN 14 DAYS AFTER THE AREA TO BE SEEDING HAS BEEN DISTURBED. TEMPORARY SEEDING MAY BE OMITTED IN AREAS WHERE PERMANENT SEEDING IS REQUIRED AND IS IN SEASON FOR IMMEDIATE PLANTING. "TEMPORARY PROJECT SEEDING" SHALL BE UNDER RUN ACCORDINGLY IF TEMPORARY SEED IS OMITTED FOR THOSE AREAS.

PERMANENT PROJECT SEEDING: CONTRACTOR SHALL APPLY SEED, FERTILIZER, AND MULCH TO ALL DISTURBED AREAS AND ADJACENT ROAD RIGHTS-OF-WAY. SEED SHALL BE GUYMON OR SUN DEVIL II BERMAJIA APPLIED AT THE RATE OF 2 LBS. PER 1000 SQ. FT. FERTILIZER SHALL BE APPLIED AT THE RATE OF 0.5 LBS. OF ACTUAL NITROGEN, 1.0 LBS. OF ACTUAL PHOSPHORUS, AND 0.5 LBS. OF ACTUAL POTASSIUM PER 1000 SQ. FT. PERMANENT SEEDING, FERTILIZING, AND MULCHING SHALL BE PAID FOR AT LUMP SUM BID FOR "PERMANENT PROJECT SEEDING".

GENERAL:
ALL MULCH SHALL BE PRAIRIE HAY APPLIED AT 90 LBS. PER 1000 SQ. FT.

CONTROL POINTS	CONTROL POINTS
PL No. 101 N: 1,636,024.4362, E: 1,649,356.0870 Equals Benchmark #2	PL No. 106 N: 1,636,114.5882, E: 1,648,627.2315 #4 Rebar
PL No. 102 N: 1,636,600.0124, E: 1,648,409.9300 #4 Rebar 1. Near SE Corner of the Pond	PL No. 107 N: 1,637,450.7054, E: 1,648,820.5408 No Ties
PL No. 103 N: 1,636,491.2885, E: 1,648,102.5741 #4 Rebar 1. S of the SW Corner of Pond	PL No. 108 N: 1,637,535.3845, E: 1,648,832.3179 No Ties
PL No. 104 N: 1,637,596.9171, E: 1,648,667.8843 #4 Rebar 1. 255' S to E-W Hedgerow 2. 254.92' N of and 94.19' E of Benchmark #3	PL No. 109 N: 1,636,520.9201, E: 1,648,446.2845 No Ties
PL No. 105 N: 1,636,133.8769, E: 1,649,033.4315 No Ties	PL No. 110 N: 1,636,395.2360, E: 1,648,317.8012 No Ties

FOR INFORMATION ONLY

No.	Revision	By	Date
CITY OF HAYSVILLE SEDGWICK COUNTY, KANSAS KEY MAP AND GENERAL NOTES 79TH STREET POND AND GRADING IMPROVEMENTS			
PROFESSIONAL ENGINEERING CONSULTANTS, P.A. 303 SOUTH TOPEKA WICHITA, KS 67202 316-262-2691 www.pec1.com			
Designed by	BMM, JAG	Job No.	13084-000-1263
Drawn by	JAN	Date	AUGUST 2014
		Sh.	2 of 9