

STREET IMPROVEMENTS WHISPERING LAKES ADDITION - PHASE 2

WOODCREEK, FROM THE EAST LINE OF LOT 42, BLOCK 2 TO THE EAST LINE OF ROSEWOOD
ROSEWOOD, FROM THE EAST LINE OF BROOKHAVEN TO THE WEST LINE OF 159TH STREET EAST
ROSEWOOD COURT, FROM THE NORTH LINE ROSEWOOD TO AND INCLUDING CUL-DE-SAC
ROSEWOOD COURT, FROM THE NORTH LINE ROSEWOOD TO AND INCLUDING CUL-DE-SAC

PROJECT NO. 472-83668
OCA # 765765

GENERAL NOTES

Utility service lines, poles, valve boxes, meters, and et cetera are to be adjusted as necessary by others prior to construction unless the plans specifically call for their adjustment by the Contractor or unless the plans specifically identify a utility to be adjusted by its owner during construction. Existing utilities and their location, as shown on the plans, represent the best information obtainable for design. The Contractor will be required to work around existing utilities within the right-of-way which do not conflict with proposed construction.

A saw cut of at least one-half the depth of existing surface courses or one-fourth the depth of existing total pavement thickness shall be provided at locations where proposed construction abuts an existing surface course or pavement for which partial removal of that surface or pavement is required, except when such saw cuts are within three (3) feet of an existing joint the limits of removal shall be extended to the existing joint. Such saw cuts will not be paid for directly and this cost shall be considered as subsidiary to the removal of the surface or pavement.

Rubble from the removal of miscellaneous structures and excess excavation which is to be wasted shall be disposed of on sites to be provided by the Contractor. These sites shall be approved by the Engineer as to suitability, appearance and site location. Locations that, in the opinion of the Engineer, will leave an unsightly appearance will not be approved.

All disposal sites must be approved by the Kansas Department of Health and Environment. Material either stockpiled or disposed of in a flood plain would require a Kansas State Board of Agriculture permit. Any material dumped in waters of the United States or wetlands is subject to U.S. Corps permitting regulations. Any material buried or stockpiled beyond approval of Engineers construction limits would require additional archeological investigations unless buried in a previously approved borrow location.

The Engineer shall take field ties to all quarter section corners. The Contractor shall set a City survey monument in the required location where such quarter section corners fall within the limits of pavement construction. Survey monuments will be furnished by the City. The Engineer will accurately locate and install the iron at the quarter section corner. This work will not be paid for directly, but shall be considered subsidiary to the other pay items of work in the contract.

Trees and shrubs in public right-of-way which are in direct conflict with proposed new construction shall be removed by the Contractor with the Engineer's approval. Trees and shrubs which are not in direct conflict with proposed new construction shall be saved and protected from damage.

The Contractor shall be responsible for preserving property irons. The Contractor will be required to re-establish any property irons which are damaged or destroyed by his construction operations. Such irons shall be re-established by a licensed land surveyor in accordance with state laws.

Contractor will be required to provide a minimum advance notice of twenty-four (24) hours to utility companies prior to starting any excavation as follows:

Kansas One-Call 687-2470

The Contractor must notify the following in case of an emergency:

Cox Communications	262-0661
Kansas Gas Service	383-8600
Westar	383-8600
Aquila Net	1-800-303-0357
SBC	1-800-286-8313
City of Wichita Water Department	262-6000
City of Wichita Sewer Maintenance	262-6000

Inlet sediment barriers shall be constructed for all inlets in this project. See detail sheet 17.

Subdivision Bench Marks shall be "Flat Survey Markers No. 8134-08 3" top diameter" provided by Kansas Blue Print Co., Inc. Bench mark installation cost to be subsidiary to curb & gutter.

PROJECT SUMMARY

PROJECT MASS GRADING INCLUDES FILL ACROSS ENTIRE STREET R/W WITHOUT ROADWAY SUBGRADE CUTS.

CUT: 19612 CUBIC YARDS
FILL: 19188 CUBIC YARDS

CROSS SECTIONS FOR THE STREET EARTHWORK TOTALS ASSUME THE R/W GRAD IS AS PER SITE EARTHWORK BEING COMPLETED AS INDICATED ON SHEETS 11 AND 12. STREET EARTHWORK BASED ON THIS:

CUT: 4228 CUBIC YARDS
FILL: 1050 CUBIC YARDS

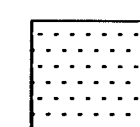
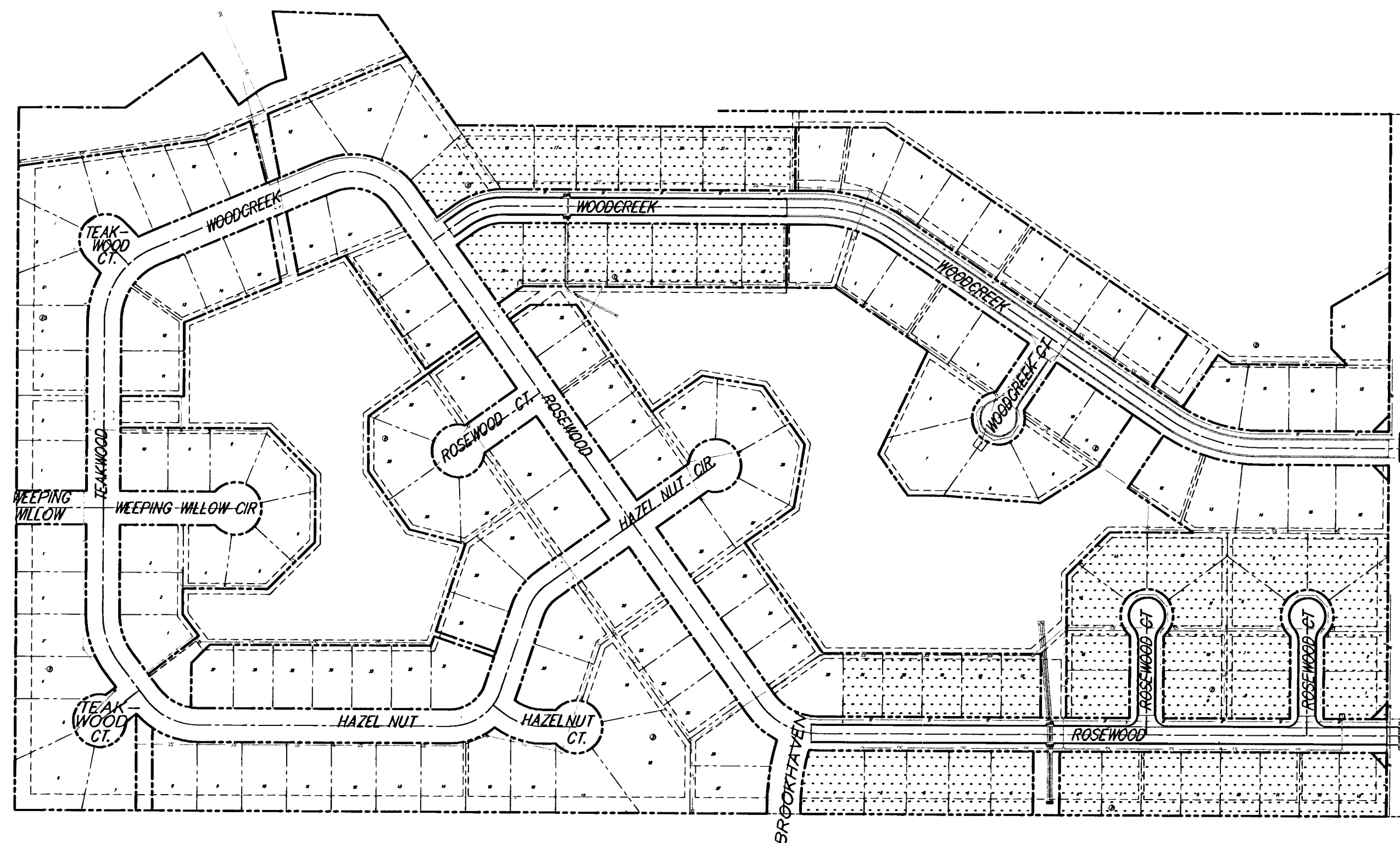

IMPROVEMENT DISTRICT

BENCH MARKS

RR SPIKE IN P.P. 47' EAST AND 853' NORTH OF THE S.E. COR. N.E. 1/4, SEC. 36-27S-2E Elev. 1287.62 (NGVD)

INDEX OF SHEETS

INDEX OF SHEETS

- | | |
|---------|-------------------------|
| 1. | Title Sheet |
| 2. | 35' Pavement Detail |
| 3. | Valley Gutter Details |
| 4. | Signing Details |
| 5.-6. | Woodcreek |
| 7.-8. | Rosewood |
| 9.-10. | Rosewood Ct |
| 11.-12. | Site Grading |
| 13. | Ditch Grading |
| 14. | Key Map |
| 15. | Type 1-A Inlet (Double) |
| 16. | Type "P" MH |
| 17. | Sediment Barrier Detail |
| 18.-19. | Storm Water Sewer |
| 20.-29. | Cross-Sections |
| 30. | Earthwork Quantities |
| 31. | Final Plat |



Scale: 1" = 200'

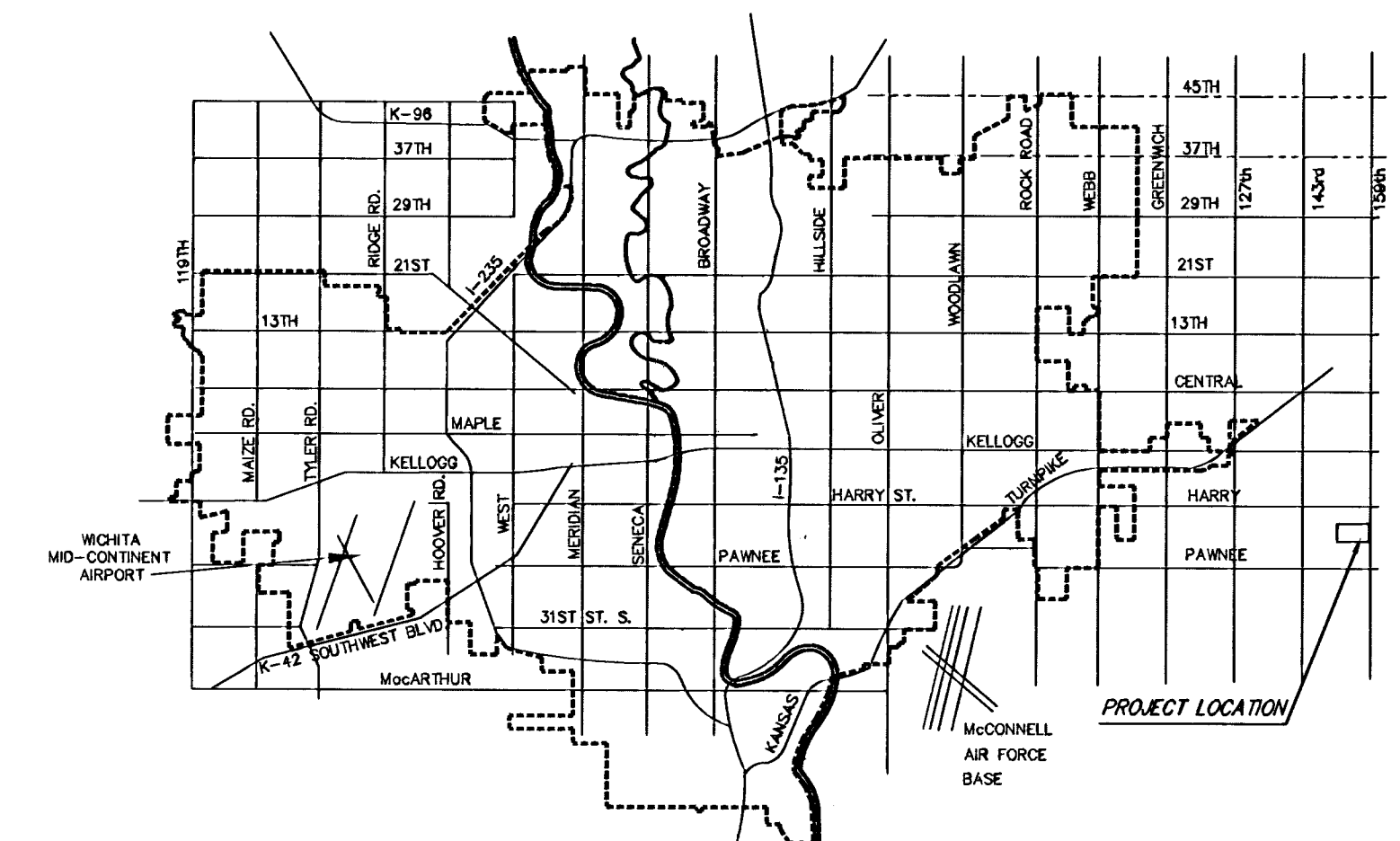

VICINITY MAP

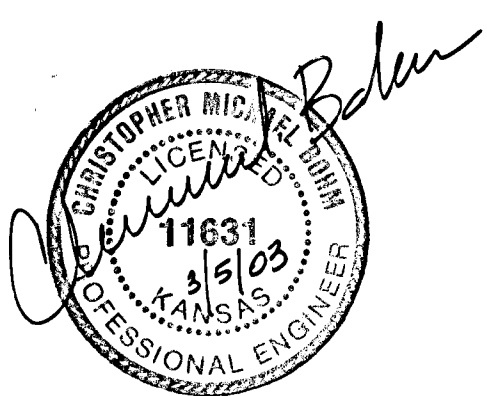

CITY OF WICHITA, KANSAS
NEIL CABLE, P.E. - CITY ENGINEER

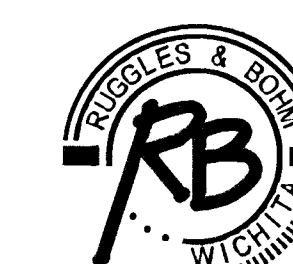

Ruggles & Bohm, P.A.

Engineering, Surveying, Land Planning

924 North Main (316) 264-8008
Wichita, Kansas 67203 (316) 264-4621 fax
www.rbkansas.com E-mail: info@rbkansas.com