

DSNR: GDD OPER: DEP SCALE: 1"=20.00
 C:\1999\99127\000\SWSLINE4 06-12-2002 09:24:43 am

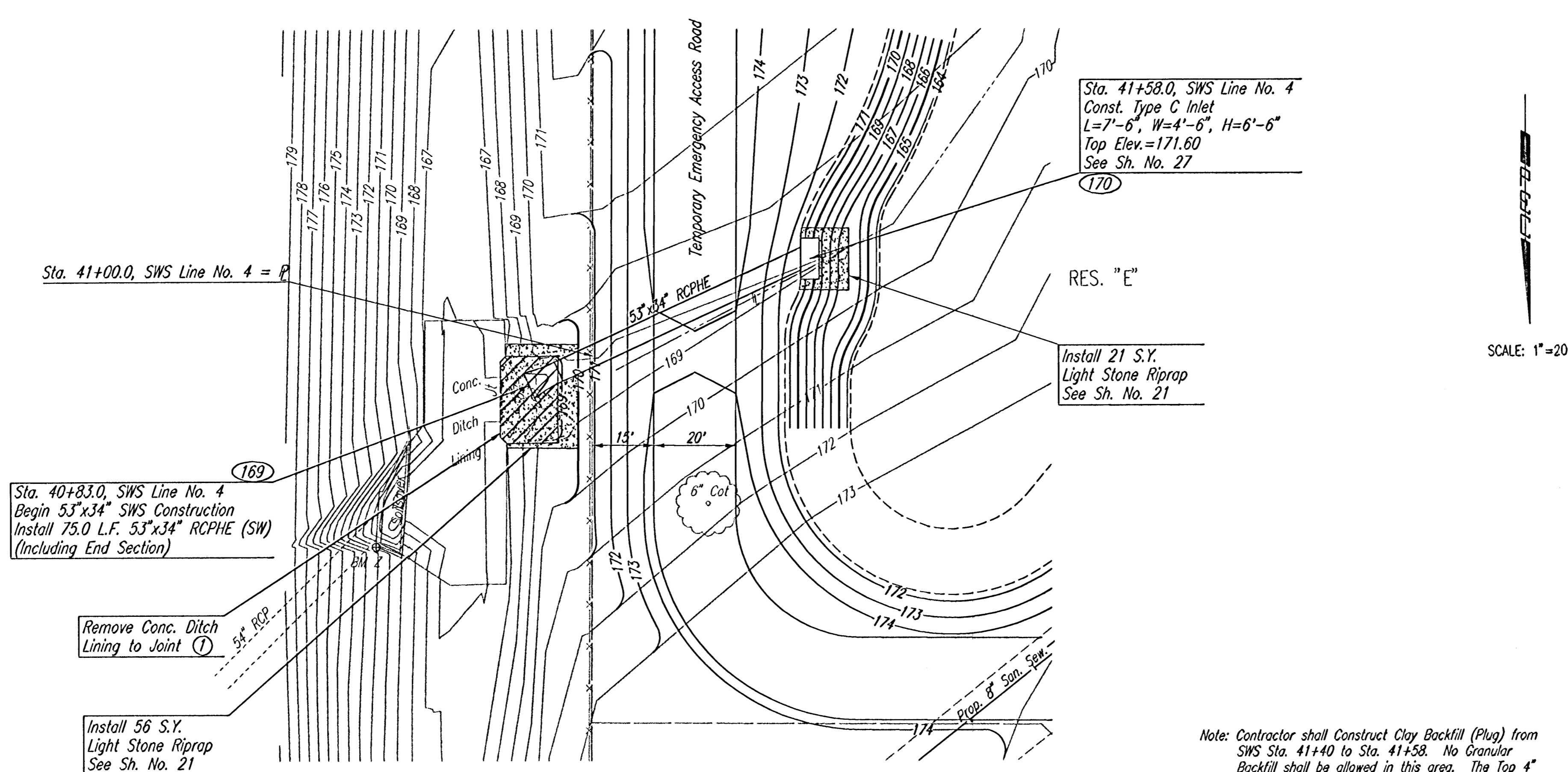

① Removal to be considered part of the bid item "Site Clearing".

Note: Contractor shall Construct Clay Backfill (Plug) from SWS Sta. 41+40 to Sta. 41+58. No Granular Backfill shall be allowed in this area. The Top 4" of fill above Static Pool may be Topsoil. This work to be subsidiary to "53'x34' RCPHE".

⑨00 COORDINATE POINT NUMBER
 SEE SH. NO. 13 FOR COORDINATES

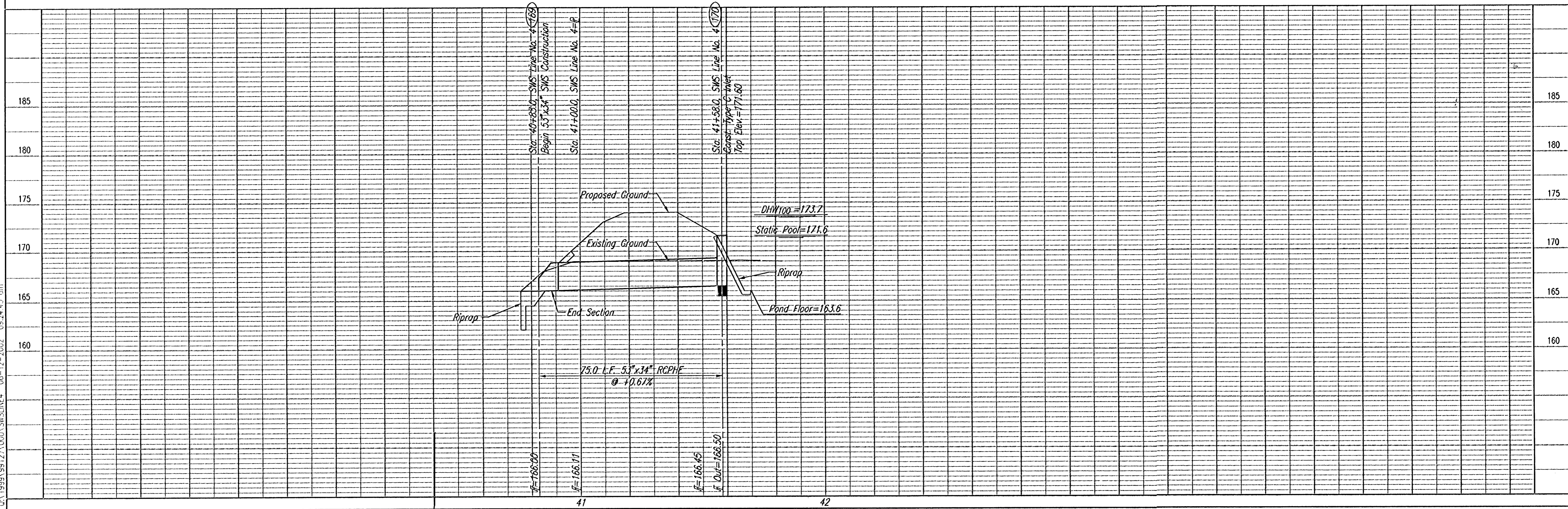

CHAPEL HILL ADDITION

SWS LINE NO. 4
 STA. 40+83.0 TO STA. 41+58.0

C.O.W. PROJ. NO. 472-76-245-83077-000-000-001

Professional Engineering Consultants, P.A.
 303 S. TOPEKA • WICHITA, KANSAS 67202
 316-262-2691 • FAX 316-262-3003

Designed by: BER, GDD
 Drawn by: SJD

Job No. 96127
 Date: JANUARY, 2001