

PHASE 2
PAVING STREETS IN
FOX RIDGE ADDITION

AN ADDITION TO THE CITY OF WICHITA
SEDGWICK COUNTY, KANSAS

PROJECT NO. 472-83786

NEIL D. CABLE, P.E. - CITY ENGINEER

OCA 765814

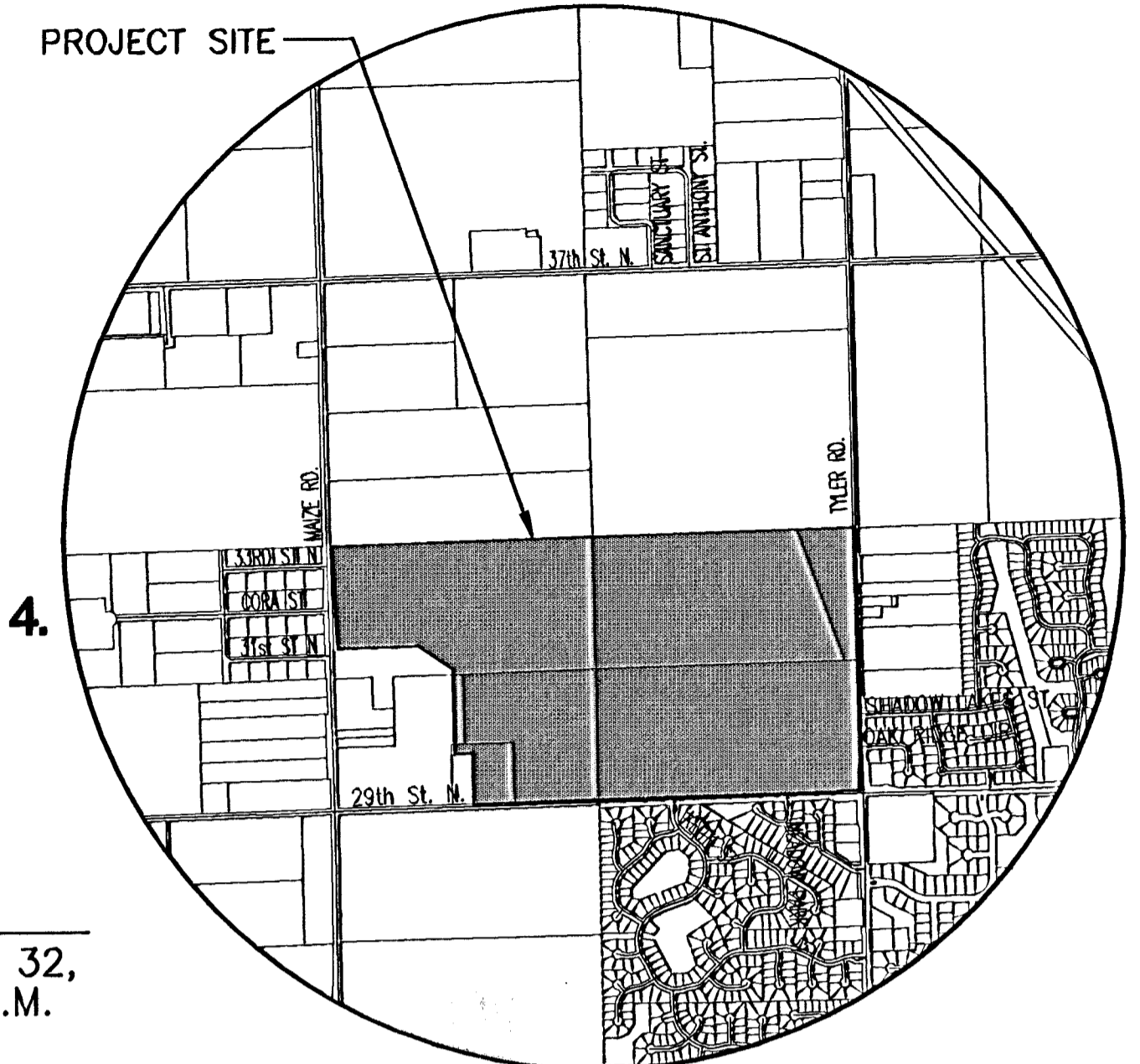

VICINITY MAP

Center, Sec. 32,
T26S, R1W, 6th P.M.
Fnd. 1/2" Bar w/
Baughman id cap

RED FOX: FROM THE SOUTH LINE OF WESTLAKES PARKWAY TO THE SOUTH LINE OF SILVER HOLLOW.
SILVER HOLLOW: FROM THE EAST LINE OF RED FOX CIRCLE TO THE EAST LINE OF LOT 106, BLOCK 4.
SILVER HOLLOW COURT: FROM THE SOUTH LINE OF SILVER HOLLOW TO AND INCLUDING THE CUL-DE-SAC SERVING LOTS 97 THROUGH 106, BLOCK 4.

GENERAL NOTES

- UNLESS SHOWN OR STATED OTHERWISE ON THESE DRAWINGS, MATERIALS AND CONSTRUCTION SHALL BE IN ACCORDANCE WITH CITY OF WICHITA CONCRETE PAVEMENT AND ASPHALTIC CONCRETE PAVEMENT SPECIFICATIONS.
- CONTRACTOR WILL BE REQUIRED TO PROVIDE A MINIMUM ADVANCE NOTICE OF FORTY-EIGHT (48) HOURS TO UTILITY COMPANIES PRIOR TO STARTING ANY EXCAVATION AS FOLLOWS:
KANSAS ONE-CALL 1-800-344-7233
OR 887-2470 (LOCAL WICHITA)
THE CONTRACTOR MUST NOTIFY THE FOLLOWING IN CASE OF AN EMERGENCY:
SBC (TELEPHONE) 800-870-8390
COX COMMUNICATIONS (CABLE) 282-0681
WESTAR (ELECTRIC) 383-8800
KANSAS GAS SERVICE (GAS) 832-3101
CITY OF WICHITA WATER & SEWER MAINT. 282-6000
AQUILA (GAS) 948-0098
- THE CONTRACTOR SHALL BE RESPONSIBLE FOR PRESERVING PROPERTY IRONS. THE CONTRACTOR WILL BE REQUIRED TO RE-ESTABLISH ANY PROPERTY IRONS WHICH ARE DAMAGED OR DESTROYED BY HIS CONSTRUCTION OPERATIONS. SUCH IRONS SHALL BE RE-ESTABLISHED BY A LICENSED LAND SURVEYOR IN ACCORDANCE WITH STATE LAWS.
- EXISTING UTILITIES AND THEIR LOCATIONS, AS SHOWN ON THE PLANS REPRESENT THE BEST INFORMATION OBTAINABLE FOR DESIGN. LOCATION INFORMATION HAS BEEN OBTAINED FROM THE VARIOUS UTILITY COMPANIES AND IS EITHER FROM COMPANY RECORD DRAWINGS OR COMPANY PROVIDED FIELD LOCATIONS. THE PLAN LOCATIONS SHOWN ARE NOT GUARANTEED. ADDITIONAL EXISTING UTILITIES MAY ALSO BE ENCOUNTERED.
- RUBBLE FROM THE REMOVAL OF MISCELLANEOUS STRUCTURES AND EXCESS EXCAVATION WHICH IS TO BE WASTED SHALL BE DISPOSED OF ON SITES TO BE PROVIDED BY THE CONTRACTOR. THESE SITES SHALL BE APPROVED BY THE ENGINEER AS TO SUITABILITY, APPEARANCE AND SITE LOCATION. LOCATIONS THAT, IN THE OPINION OF THE ENGINEER, WILL LEAVE AN UNSIGHTLY APPEARANCE WILL NOT BE APPROVED. ALL DISPOSAL SITES MUST BE APPROVED BY THE KANSAS DEPARTMENT OF HEALTH AND ENVIRONMENT. MATERIAL EITHER STOCKPILED OR DISPOSED OF IN A FLOOD PLAIN WOULD REQUIRE A KANSAS STATE BOARD OF AGRICULTURE PERMIT. ANY MATERIAL DUMPED IN WATERS OF THE UNITED STATES OR WETLANDS IS SUBJECT TO U.S. CORPS OF ENGINEERS PERMITTING REGULATIONS. ANY MATERIAL BURIED OR STOCKPILED BEYOND APPROVED CONSTRUCTION LIMITS WOULD REQUIRE ADDITIONAL ARCHAEOLOGICAL INVESTIGATIONS UNLESS BURIED IN A PREVIOUSLY APPROVED BORROW LOCATION.
- A SAW CUT OF AT LEAST ONE-HALF THE DEPTH OF THE EXISTING SURFACE COURSES OR ONE-FOURTH THE DEPTH OF THE EXISTING TOTAL PAVEMENT THICKNESS SHALL BE PROVIDED AT LOCATIONS WHERE PROPOSED CONSTRUCTION ABUTS AN EXISTING SURFACE OR PAVEMENT FOR WHICH PARTIAL REMOVAL OF THAT SURFACE OR PAVEMENT IS REQUIRED. SAW JOINT TO FACILITATE REMOVAL WITHIN THREE (3) FEET OF EXISTING JOINTS WILL NOT BE PERMITTED AND FOR SUCH INSTANCES THE LIMITS OF REMOVAL SHALL EXTEND TO THE EXISTING JOINT. SUCH SAW CUTS WILL NOT BE PAID FOR DIRECTLY AND THIS COST SHALL BE CONSIDERED AS SUBSIDIARY TO THE REMOVAL OF SURFACE OR PAVEMENT.
- CONTRACTOR SHALL SEED AND MULCH ALL DISTURBED AREAS WITH RYE GRASS AT A RATE OF 200 LBS. PER ACRE. GROUND SHALL BE PREPARED IN ACCORDANCE WITH CITY OF WICHITA SPECIFICATIONS.
- THIS PROJECT INCLUDES A CERTAIN AMOUNT OF ROLL TYPE CURB CONSTRUCTION. ROLL CURBS SHALL BE DEPRESSED THROUGH ALL DRIVEWAY OPENINGS WHEN SUCH DRIVES ARE CONSTRUCTED AS A PART OF THE PROJECT. NO MORE THAN 12 DRIVES 20 FEET IN WIDTH OR EQUIVALENT COMBINATIONS THEREOF ARE TO BE CONSTRUCTED WITH THIS PROJECT.
- ROUGH GRADING FOR THIS PROJECT HAS BEEN COMPLETED WITH THE MASS GRADING TO WITHIN 0.1'. SOME FINAL GRADING WILL BE REQUIRED PRIOR TO CONSTRUCTING THE STREETS. PAVING CONTRACTOR SHALL BE RESPONSIBLE FOR BACKFILLING BEHIND CURBS AND FINE GRADING WITHIN THE RIGHT-OF-WAY.
- AS-BUILT DRAWINGS FOR THE SITE GRADING PROJECT WILL BE PROVIDED BY MKEC PRIOR TO BEGINNING CONSTRUCTION OF THIS PROJECT.



E. 1/4 Corner, Sec. 32,
T26S, R1W, 6th P.M.
Fnd. 3/4" Pipe

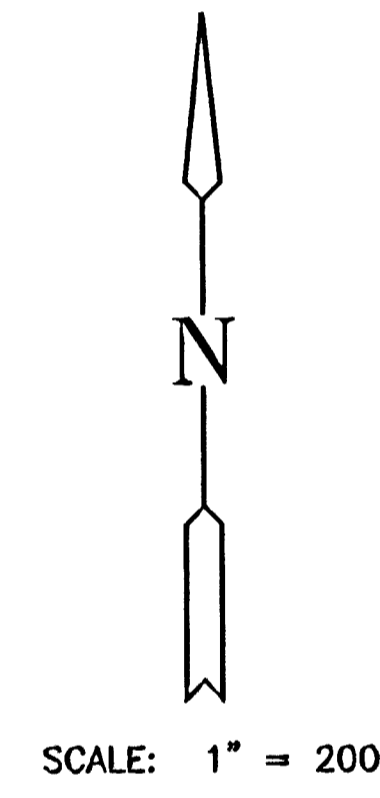

E. 1/4 Corner, Sec. 32,
T26S, R1W, 6th P.M.
Fnd. 3/4" Pipe

INDEX TO DRAWINGS

SHEET NO.	DESCRIPTION
1	TITLE SHEET
2-4	TYP. PAVING SECTIONS
5	VALLEY GUTTER DETAILS
6	WHEELCHAIR RAMP DETAILS
7	SIGNING DETAILS
8	INLET HOOKUP & UNDERDRAIN DETAIL
9-12	PAVING PLANS
13-15	EROSION DETAILS
16-23	CROSS SECTIONS
24	FINAL PLAT

BENCHMARKS

- BM#1 Square cut top curb W. end of island at Shadow Lakes, East side of Tyler Rd. Elev. = 175.81
- BM#2 RR spike in W. face of South H-pole East of Tyler Rd., 3320 N. Tyler Rd. Elev. = 175.53
- BM#3 5/8" Rebar set just West of NE Corner Lot 3, Block 5 Elev. = 167.01
- BM#4 5/8" Rebar set just West of SE Corner Lot 33, Block 5 Elev. = 165.54

LENGTH OF PROJECT	
RED FOX - 35' BK.-BK.	866 FT.
SILVER HOLLOW - 35' BK.-BK.	440 FT.
SILVER HOLLOW CT. - 29' BK.-BK.	446 FT.
EARTHWORK SUMMARY	
EXCAVATION	0 C.Y.
LOOSE FILL	0 C.Y.
COMPACTED FILL	0 C.Y.

MKEC
ENGINEERING CONSULTANTS
411 N. WEBB ROAD
WICHITA, KS. 67206
316-684-9600

FOX RIDGE ADDITION - PHASE 2
PROJECT NAME

TITLE SHEET
SHEET TITLE

DATE: **SEPTEMBER 2003**
JOB NO.: **99118ET2**

DESIGN BY: **DK** DRAWN BY: **DM/RT** CHECKED BY: **DK**

1 / 24
SHEET/OF