

BENCHMARKS:
 City of Wichita Benchmark Disk
 34.9' S. & 31.2' W. of the SW Cor.,
 NW1/4, Sec. 2, Twp. 27-S, R-1-W.
 Elev. = 1327.57 NAVD88

"X" cut in top of curb inlet face
 north side of 26th ST N,
 129' west & 21' north of the
 southwest corner of Lot 1, Block B,
 Sandcrest 4th Addn.
 Elev. = 1324.00 NAVD88

"□" cut in top of curb adjacent
 to the southwest corner of Lot 4,
 Block C, Sandcrest 3rd Addn.
 Elev. = 1328.86 NAVD88

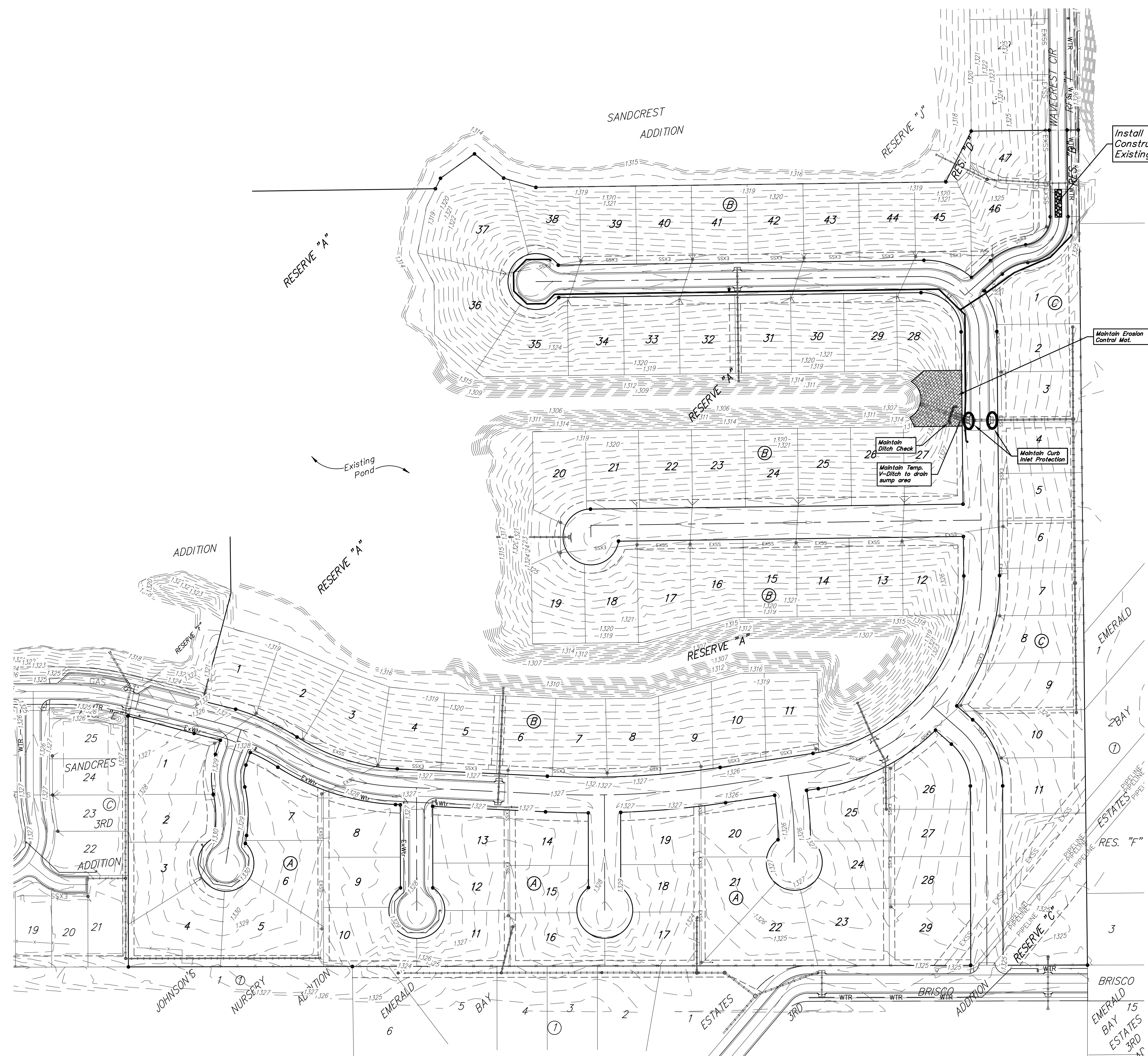
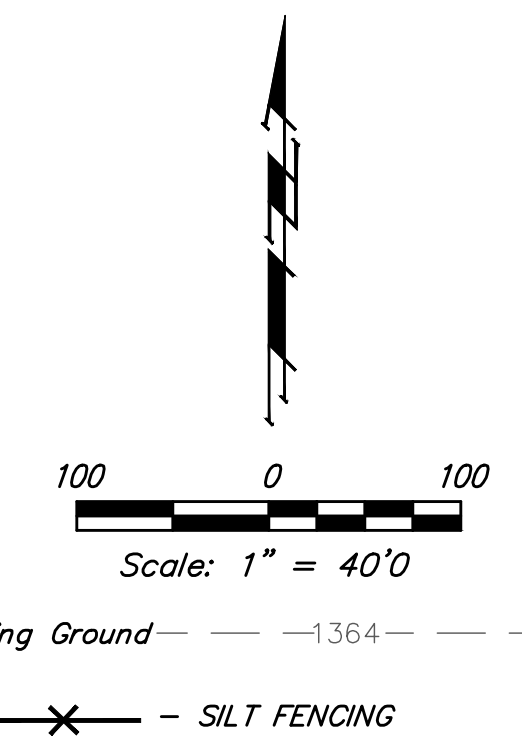

Install 50'x12' Gravel
 Construction Entrance
 Existing Paved Roadway

Maintain Erosion
 Control Mat.

Maintain Ditch Check
 Maintain Temp.
 V-Ditch to drain
 sump area

Maintain Curb
 Inlet Protection

EROSION CONTROL MEASURE	INSTALL	MAINTAIN
CONSTRUCTION ENTRANCE (EA)	1	0
SILT FENCE (LF)	0	0
MAINTAIN EROSION CONTROL BMP's (LS)	0	1

* ALL EXISTING BMP's INCLUDING CONSTRUCTION ENTRANCE, SEDIMENT BARRIERS, SILT FENCE, CUT-OFF TRENCH, AND EROSION CONTROL MAT SHALL BE MAINTAINED AND REPAIRED IF NECESSARY.

- NOTES:**
- Contractor shall make sure all erosion control is in place before project is accepted. This plan represents the minimum standard. Any additional erosion control measures shall be installed by the Contractor as needed.
 - Removal of Gravel Construction Entrance for pavement construction shall be included in bid item "Site Clearing & Restoration"
 - This Plan is Not To Be Used As A Comprehensive Grading Plan. All Spot Elevations Are Proposed & Subject To Change.
- All areas disturbed during construction shall be seeded, mulched, and fertilized as per Cover Sheet General Notes.

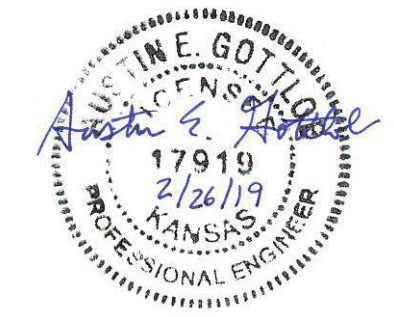

Baughman Sandcrest 4th Addition - Phase II
EROSION CONTROL
 Water Distribution System

Baughman Company, P.A. 315 Ellis St. Wichita, KS 67211 P 316-262-7271 F 316-262-0149
 ENGINEERING | SURVEYING | PLANNING | LANDSCAPE ARCHITECTURE

PROJECT NUMBER 448-90897	DESIGN AEG	DRAWN JAK
REVISIONS:	APPROVED	DATE 2/26/19
	SCALE Noted	SHEET

6 OF 13