

PROJECT NO.	472-83376	SHEET NO.	7R	TOTAL SHEETS	50
-------------	-----------	-----------	----	--------------	----

WATER VALVE BOX ELEVATIONS			
STREET	STATION	OFFSET	PROPOSED ELEVATION
CRANBROOK	40+59.49	26.0' RL	210.7
CRANBROOK	40+79.49	26.0' RL	210.6
CRANBROOK	42+95.42	26.0' RL	212.1

SCALE: 1"=20'

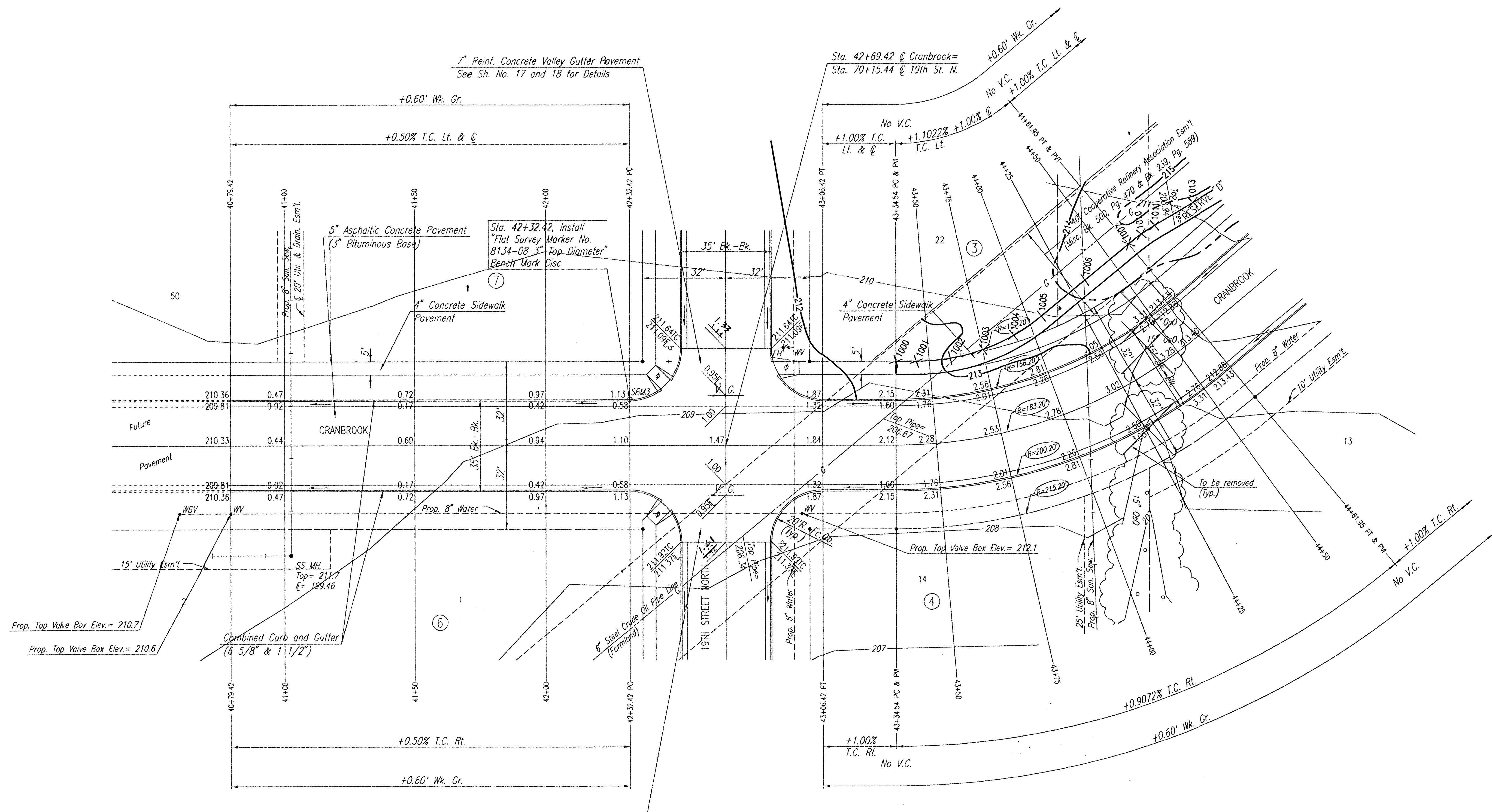

SIDEWALK COORDINATE LIST		
PT. NUMBER	NORTHING	EASTING
1000	385830.0045	2371245.4901
1001 PC	385837.8308	2371245.4041
1002	385850.6850	2371244.1508
1003 mid	385863.1336	2371240.7107
1004	385874.8075	2371235.1860
1005 PT	385885.3604	2371227.7403
1006	385901.9046	2371213.7869
1007 PC	385918.4487	2371199.8336
1010 mid	385923.3241	2371196.0536
1011 PT	385928.4937	2371192.6870
1013	385943.2831	2371183.9002
1014 PC	385958.0725	2371175.1133
1016	385971.2521	2371166.3088
1017 mid	385983.4291	2371156.1627
1019	385994.4675	2371144.7884
1167 PT	386004.2441	2371132.3128
1168 PC	386008.5424	2371126.1869
1169 mid	386019.7598	2371113.5221
1170 PT	386033.5305	2371103.6937
1171	386045.1165	2371097.2610
1172 PC	386056.7025	2371090.8282
1173	386069.0132	2371083.1930
1174 mid	386080.5299	2371074.4059
1175	386091.1454	2371064.5468
1176 PT	386100.7605	2371053.7137
1177	386114.7159	2371036.3679
1178 PC	386128.6714	2371019.0222
1179	386138.1843	2371008.2917
1180 mid	386148.6785	2370998.5186
1181	386160.0579	2370989.7924
1182 PT	386172.2186	2370982.1926
1183	386189.5832	2370972.4626
1184 PC	386206.9479	2370962.7326
1185	386220.5425	2370954.1259
1186 mid	386233.1370	2370944.1126
1187	386244.5866	2370932.8078
1188 PT	386254.7593	2370920.3417
1189 mid	386263.3366	2370911.0592
1190 PC	386273.8063	2370903.9798
1191	386286.9483	2370896.6667
1192 mid	386299.6542	2370888.6199
1193	386311.8832	2370879.8653
1194 PT	386323.5958	2370870.4310
1195 PC	386335.4761	2370864.6909
1196 mid	386349.4032	2370850.4645
1197 PT	386372.2568	2370825.4504
1198 PC	386372.8903	2370823.9594
1199	386380.1783	2370809.9832
1200 mid	386389.5718	2370797.3257
1201	386400.8376	2370786.3015
1202 PT	386413.6957	2370777.1845
1203	386425.2745	2370770.2771
1204 PC	386436.8533	2370763.3697
1205 mid	386452.7186	2370752.4668
1206 PT	386467.0569	2370739.6218
1207 PC	386472.3405	2370734.2387
1208	386483.0591	2370724.7772
1209 mid	386495.0173	2370716.9410
1210	386507.9709	2370710.8902
1211 PT	386521.6549	2370706.7484
1212	386539.7382	2370702.6598
1213	386557.8215	2370698.5712
1214	386575.9048	2370694.4827

CURVE DATA					
$\Delta=39^{\circ}50'51''$		$D=31^{\circ}16'30''$		$R=183.20'$	
$L=127.41'$		$T=66.40'$		$E=11.66'$	
CURVE DATA BASED ON $\Delta/2=19^{\circ}55'26''$					
Δ STATION	Δ ARC LENGTH	FACE CURB LENGTH LEFT CURB	FACE CURB LENGTH RIGHT CURB	CHORD LENGTH 8' OFF LEFT FACE CURB	CHORD LENGTH 8' OFF RIGHT FACE CURB
43+34.54					
43+50	15.46'	14.03'	16.89'	13.35'	17.56'
43+75	25.00'	22.68'	27.32'	21.57'	28.39'
44+00	25.00'	22.68'	27.32'	21.57'	28.39'
44+25	25.00'	22.68'	27.32'	21.57'	28.39'
44+50	25.00'	22.68'	27.32'	21.57'	28.39'
44+61.95	11.95'	10.84'	13.06'	10.32'	13.58'
TOTAL	127.41'	115.59'	139.23'		

CONST. STD. WHEELCHAIR RAMP

RECORD DRAWING

REMINGTON PLACE - PHASE 2

CRANBROOK
 STA. 40+79.42 TO STA. 44+61.95
 (REVISED WALK)
 SHEET 1 of 3

Professional Engineering Consultants, P.A.
 303 S. TOPEKA • WICHITA, KANSAS 67202
 316-262-2691 • FAX 316-262-3003

Designed by	BER	Checked by	
Drawn by	DEP	Date	DEC., 2002
		Job No.	02398

DSNR: BER OPER: ILS SCALE: 1"=20.00
 C:\2002\02398\000\CRANBROOKS1-Walk rev 11-20-2003 04:01:51 pm