

WATER VALVE BOX ELEVATIONS			
STREET	STATION	OFFSET	PROPOSED ELEVATION
CRANBROOK	56+95.90	26.8'LT.	210.9
CRANBROOK	56+96.86	31.5'RT.	210.9
CRANBROOK	56+98.86	24.3'RT.	210.9

SCALE: 1"=20'

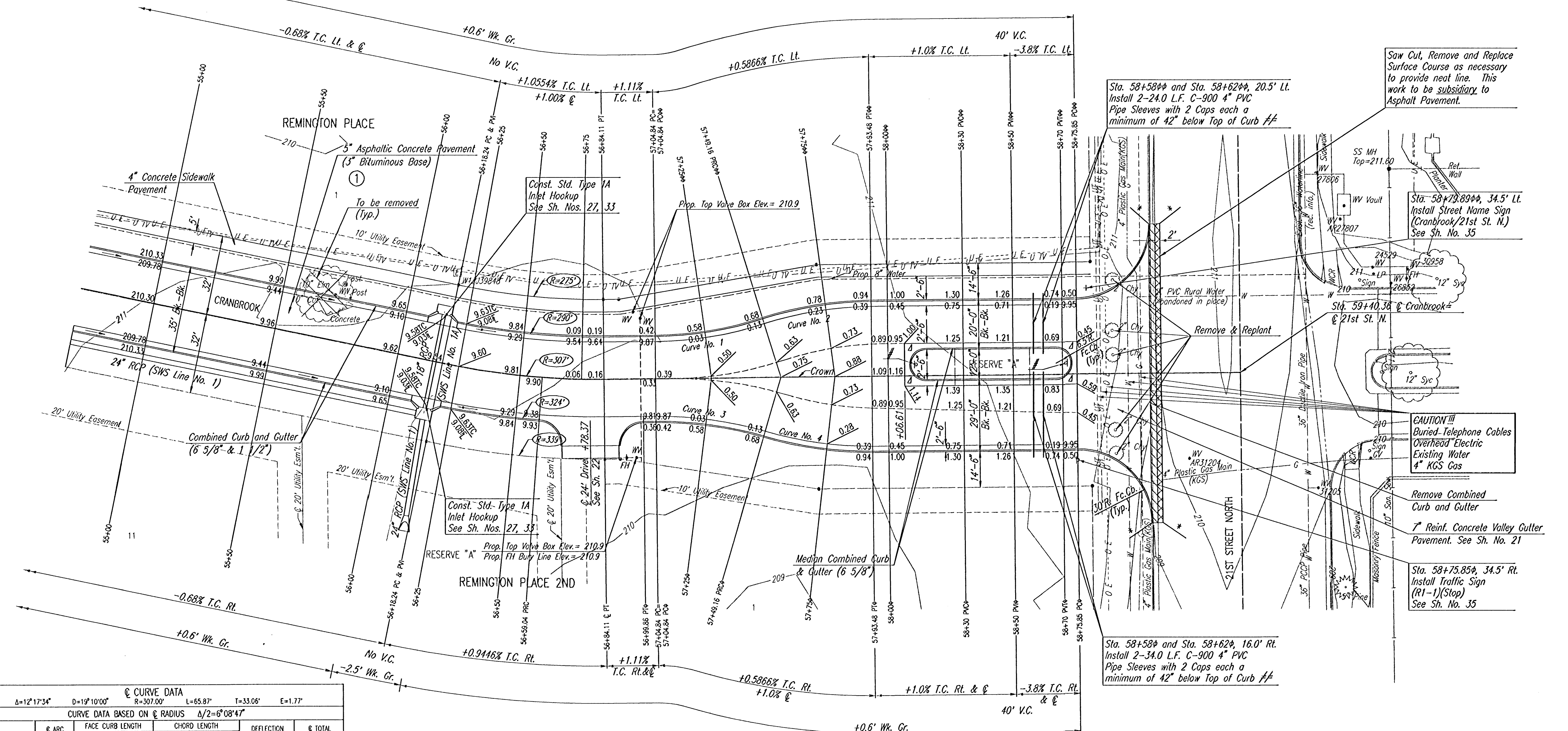

Sta. 58+58.00 and Sta. 58+62.00, 20.5' Lt.  
Install 2-24.0 L.F. C-900 4" PVC Pipe Sleeves with 2 Caps each a minimum of 42" below Top of Curb #

Saw Cut, Remove and Replace Surface Course as necessary to provide neat line. This work to be subsidiary to Asphalt Pavement.

Sta. 58+79.89, 34.5' Lt.  
Install Street Name Sign (Cranbrook/21st St. N.) See Sh. No. 35

CAUTION!!! Buried Telephone Cables Overhead Electric Existing Water 4" KGS Gas

Remove Combined Curb and Gutter  
7" Reinf. Concrete Valley Gutter Pavement. See Sh. No. 21

Sta. 58+75.85, 34.5' Rt.  
Install Traffic Sign (R1-1)(Stop) See Sh. No. 35

Sta. 58+58.00 and Sta. 58+62.00, 16.0' Rt.  
Install 2-34.0 L.F. C-900 4" PVC Pipe Sleeves with 2 Caps each a minimum of 42" below Top of Curb #

CURVE DATA						
$\Delta=12^{\circ}17'34"$		$D=19^{\circ}10'00"$		$R=307.00'$	$L=65.87'$	$T=33.06'$
$E=1.77'$						
CURVE DATA BASED ON $\Delta/2$ RADIUS $\Delta/2=6^{\circ}08'47"$						
STATION	ARC LENGTH	FACE CURB LENGTH	CHORD LENGTH	DEFLECTION ANGLE	TOTAL DEFLECTION	
		LEFT CURB	RIGHT CURB		8' OFF LEFT FACE CURB	8' OFF RIGHT FACE CURB
58+18.24				0°00'00"	0°00'00"	0°00'00"
56+25	6.76'	6.39'	7.13'	6.21'	7.31'	0°37'51"
56+50	25.00'	23.62'	26.38'	22.96'	27.03'	2°57'49"
56+70	20.00'	18.89'	21.11'	18.37'	21.62'	1°51'59"
56+75	5.00'	4.72'	5.28'	4.59'	5.41'	0°28'00"
56+84.11	9.11'	8.60'	9.61'	8.36'	9.85'	0°50'59"
TOTAL	65.87'	62.22'	69.51'	Defl./Lt.=5.598654 min.		

CURVE NOS. 1 AND 3 STAKING DATA						
CURVE DATA BASED ON RADIUS TO 8' BEHIND FACE OF CURB						
$\Delta=18^{\circ}55'47"$		$D=38^{\circ}11'50"$		$R=150.00'$	$L=44.32'$	$T=21.84'$
$E=1.65'$						
FACE CURB STATION	ARC LENGTH ALONG FACE CURB	ARC LENGTH ALONG 8' OFFSET	CHD LENGTH 8' OFF FC. OF CB.	DEFLECTION ANGLE	TOTAL DEFLECTION	REMARKS
57+04.84				0°00'00"	0°00'00"	P.C.
57+25	25.84'	27.22'	31.72'	4°52'06.2"	4°52'06.2"	
57+49.16	18.48'	19.47'	22.70'	3°31'47.2"	8°27'53.5"	P.T.
TOTAL	44.32'	46.69'	54.42'	Defl./Lt.=11.459650 min.		

CURVE NOS. 2 AND 4 STAKING DATA						
CURVE DATA BASED ON RADIUS TO 8' BEHIND FACE OF CURB						
$\Delta=18^{\circ}55'47"$		$D=38^{\circ}11'50"$		$R=150.00'$	$L=44.32'$	$T=21.84'$
$E=1.65'$						
FACE CURB STATION	ARC LENGTH ALONG FACE CURB	ARC LENGTH ALONG 8' OFFSET	CHD LENGTH 8' OFF FC. OF CB.	DEFLECTION ANGLE	TOTAL DEFLECTION	REMARKS
57+49.16				0°00'00"	0°00'00"	P.R.C.
57+75	20.16'	19.08'	15.89'	3°51'01"	3°51'01"	
57+93.48	24.16'	22.87'	19.04'	4°36'52.5"	8°27'53.5"	P.T.
TOTAL	44.32'	41.95'	34.93'	Defl./Lt.=11.459650 min.		

Curve Data Curve Nos. 1 thru 4  
(Face of Curb)  
 $\Delta=18^{\circ}55'47"$   
 $D=38^{\circ}11'50"$   
 $R=150.00'$   
 $L=44.32'$   
 $T=21.84'$   
 $E=1.65'$

- # SEE SH. NO. 35 FOR SIGNING NOTES AND DETAILS
- \* MATCH EXISTING
- Δ WIDENED GUTTER SECTION WILL NOT BE PAID FOR DIRECTLY, THIS COST SHALL BE CONSIDERED SUBSIDIARY TO "MEDIAN COMBINED CURB AND GUTTER (6 5/8)".
- ◆ LEFT FACE OF CURB STATION
- ◆ RIGHT FACE OF CURB STATION
- # EACH END OF 4" PVC PIPE SLEEVE SHALL BE MARKED WITH STEEL "I" POSTS OR 2" STEEL PIPE A MAXIMUM OF 12" ABOVE GRADE. PIPE, CAPS, PIPE INSTALLATION AND MARKERS SHALL BE SUBSIDIARY TO "COMBINED CURB AND GUTTER (6 5/8' & 1 1/2)".

## RECORD DRAWING

Remington Place - PHASE 2

CHANGE ORDER NO. 1  
**CRANBROOK**  
STA. 55+00.00 TO STA. 59+40.36

**Professional Engineering Consultants, P.A.**  
303 S. TOPEKA • WICHITA, KANSAS 67202  
316-262-2691 • FAX 316-262-3003

DSNR: SAW OPER: ILS SCALE: 1"=20.00  
 01/2002/02398/000/CHANGE ORDER/CRANBROOKS4 11-20-2003 04:35:20 pm