

WATER VALVE BOX ELEVATIONS			
STREET	STATION	OFFSET	PROPOSED ELEVATION
SHADYBROOK	70+34	21.0'LL	213.5- 214.0

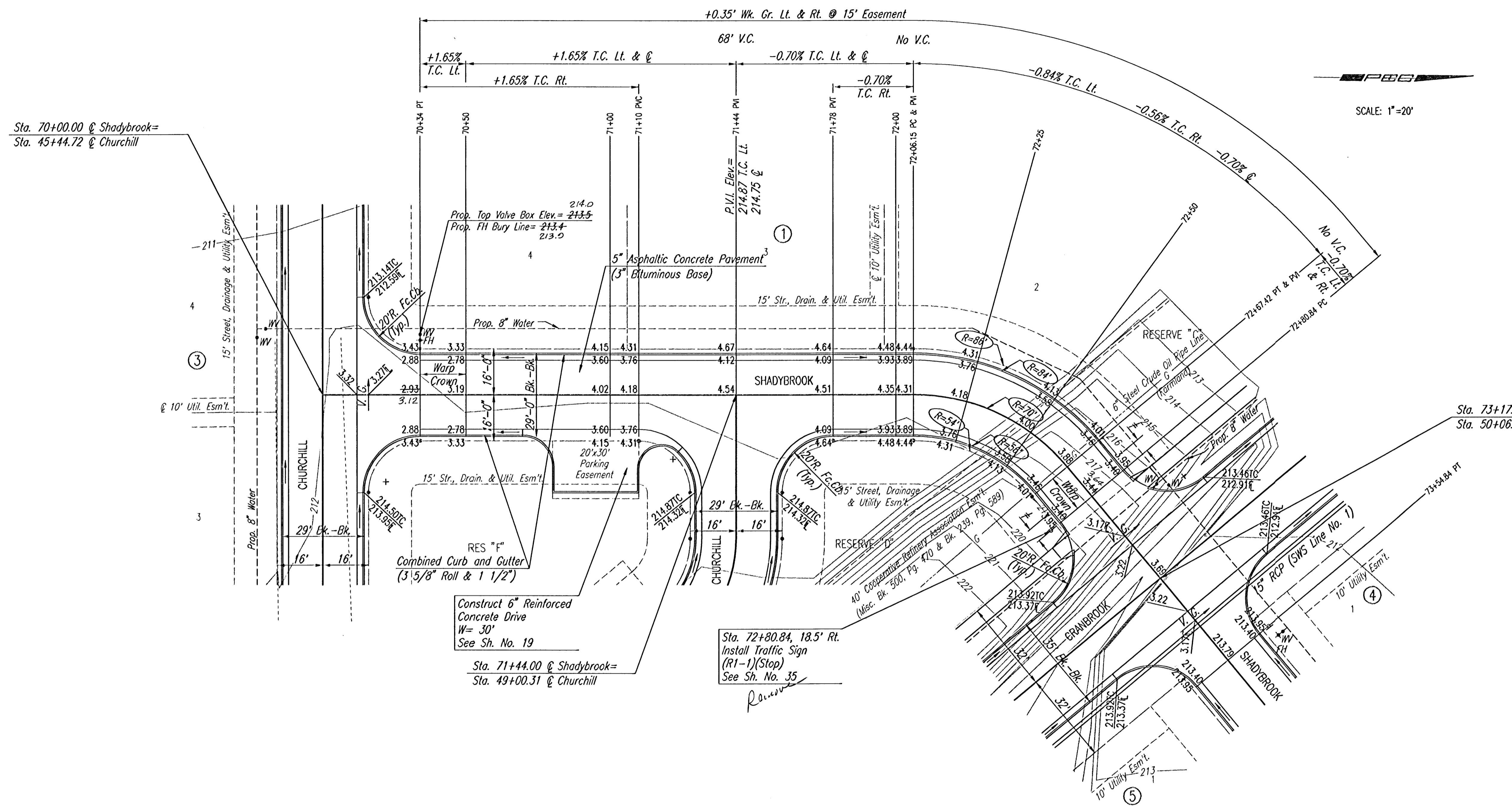

Δ=50°09'09" D=81°51'04" R=70.00' L=61.27' T=32.76' E=7.28'

CURVE DATA BASED ON Δ/2=25°04'34.5"

STATION	ARC LENGTH	FACE CURB LENGTH		CHORD LENGTH		DEFLECTION ANGLE	TOTAL DEFLECTION
		LEFT CURB	RIGHT CURB	B'OFF LEFT FACE CURB	B'OFF RIGHT FACE CURB		
72+06.15						0°00'00"	0°00'00"
72+25	18.85'	22.62'	15.08'	24.70'	12.89'	7°42'52"	7°42'52"
72+50	25.00'	30.00'	20.00'	32.68'	17.05'	10°13'53"	17°56'45"
72+67.42	17.42'	20.91'	13.94'	22.84'	11.92'	7°07'49.5"	25°04'34.5"
TOTAL	61.27'	73.53'	49.02'				

Def./tl.=24.556471 min.

NOTE: THIS STREET TO BE CONSTRUCTED WITH ROLL-TYPE CURB. TOP OF CURB ELEVATIONS GIVEN ARE FOR FULL HEIGHT CURB.

≠ 5' TRANSITION FROM COMBINED CURB AND GUTTER 3 5/8" ROLL & 1 1/2" TO COMBINED CURB AND GUTTER (6 5/8" & 1 1/2"). TO BE BID AND AID FOR AS "COMBINED CURB AND GUTTER (3 5/8" ROLL & 1 1/2)".

RECORD DRAWING
Brady & Galt 24 NOV 03
 REMINGTON PLACE - PHASE 2

SHADYBROOK
 STA. 70+00.00 TO STA. 73+54.84

Professional Engineering Consultants, P.A.
 303 S. TOPEKA • WICHITA, KANSAS 67202
 316-262-2691 • FAX 316-262-3003

Designed by	BER	Checked by	
Drawn by	DEP	Date	DEC., 2002
		Job No.	02398

DSNR: RRY OPER: DEP SCALE: 1"=20.00
 C:\2002\02398\000\SHADYBROOKS1_12-18-2002_10:30:15.am