

DSNR, S&D OPER. DEP. SCALE: 1"=20.00
 C:\2002\02398\000\SWS\LINE4g 12-03-2002 03:08:31 pm

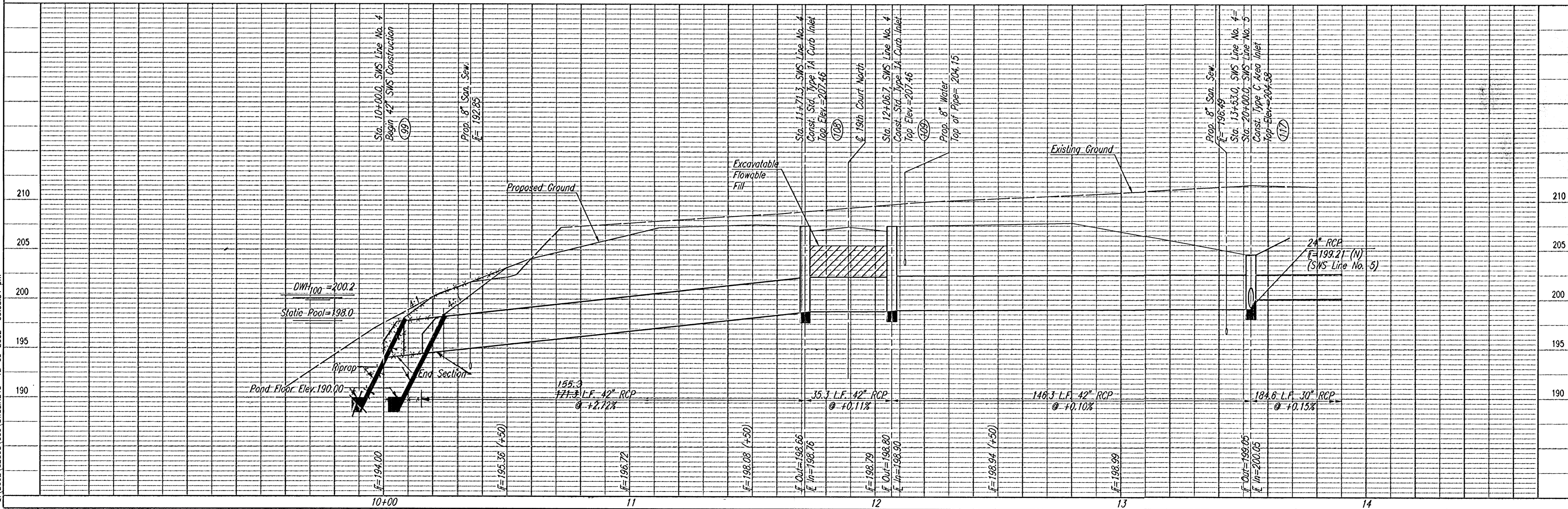

10+16.0
 Sta. ~~10+00.0~~ SWS Line No. 4=
 Begin 42" SWS Construction
 Install ~~171.3~~ 42" (E) 155.3 L.F.
 (Including End Section)
 F_{Out} = 194.00

Install 35 S.Y.
 Light Stone Riprap
 See Sheet No. 27

CAUTION !!!
 Prop. 8" San. Sew.

Install 32.3 L.F.
 Excavatible Flowable
 Fill to Elev. 205.46

Sta. 11+71.3, SWS Line No. 4=
 @ 19th Court North Sta. 53+27.0, 17.67' Lt.
 Const. Std. Type 1A Curb Inlet
 L=5'-0", W=3'-0"
 Top Elev.=207.46
 Install 35.3 L.F. 42" RCP (E)
 See Sh. Nos. 27, 33

CAUTION !!!
 Prop. 8" Waterline

109
 Sta. 12+06.7, SWS Line No. 4=
 @ 19th Court North Sta. 53+27.0, 17.67' Lt.
 Const. Std. Type 1A Curb Inlet
 L=5'-0", W=3'-0"
 Top Elev.=207.46
 Install 146.3 L.F. 42" RCP (E)
 See Sh. Nos. 27, 33

Sta. 13+53.0, SWS Line No. 4=
 Sta. 20+00.0, SWS Line No. 5
 Const. Type C Area Inlet
 L=6'-0", W=5'-0"
 Top Elev.=204.58
 Install 184.6 L.F. 30" RCP (S)
 Install 100.2 L.F. 24" RCP (N)
 See Sh. Nos. 29, 31 & 32

CAUTION !!!
 Prop. 8" San. Sew.

SCALE: 1"=20'

COORDINATE LIST		
POINT	NORTH	EAST
99	385,430.3083	2,370,558.1305
108	385,432.1759	2,370,728.1597
109	385,432.5642	2,370,763.4976
117	385,434.1721	2,370,909.8188

(117) = COORDINATE POINT NO.

RECORD DRAWING

Professional Engineering Consultants, P.A.

REVISION PAGE - PHASE 2
SWS LINE NO. 4
 STA. 10+00.00 TO STA. 13+53.00

Professional Engineering Consultants, P.A.
 303 S. TOPEKA AVE., WICHITA, KANSAS 67202
 316-262-2091 • FAX 316-262-3003
 Job No. 02388 Date DEC. 2002
 Designed by BBR SW
 Drawn by SW