

BENCHMARKS:
 BM #1: BENT 60d NAIL IN LIGHT POLE,
 55' SSW. OF THE E1/4 COR., SEC. 13,
 TWP. 26-S, R-1-W.
 ELEV. = 1336.54 NGVD29

BM #2: RAILROAD SPIKE IN E. FACE OF
 N. "H" POLE, 60'± S. OF N. LINE, S1/2,
 NE1/4, SEC. 13, TWP. 26-S, R-1-W.
 ELEV. = 1335.93 NGVD29

BM #3: "C" CUT ON TOP OF NE COR.
 OF WATER VAULT, 437'± E. & 54'± N.
 OF S1/4 COR., SEC. 13, TWP. 26-S,
 R-1-W.
 ELEV. = 1334.81 NGVD29

Construct Pond #2,
 see Detail and Pond
 Notes, sheet 10.

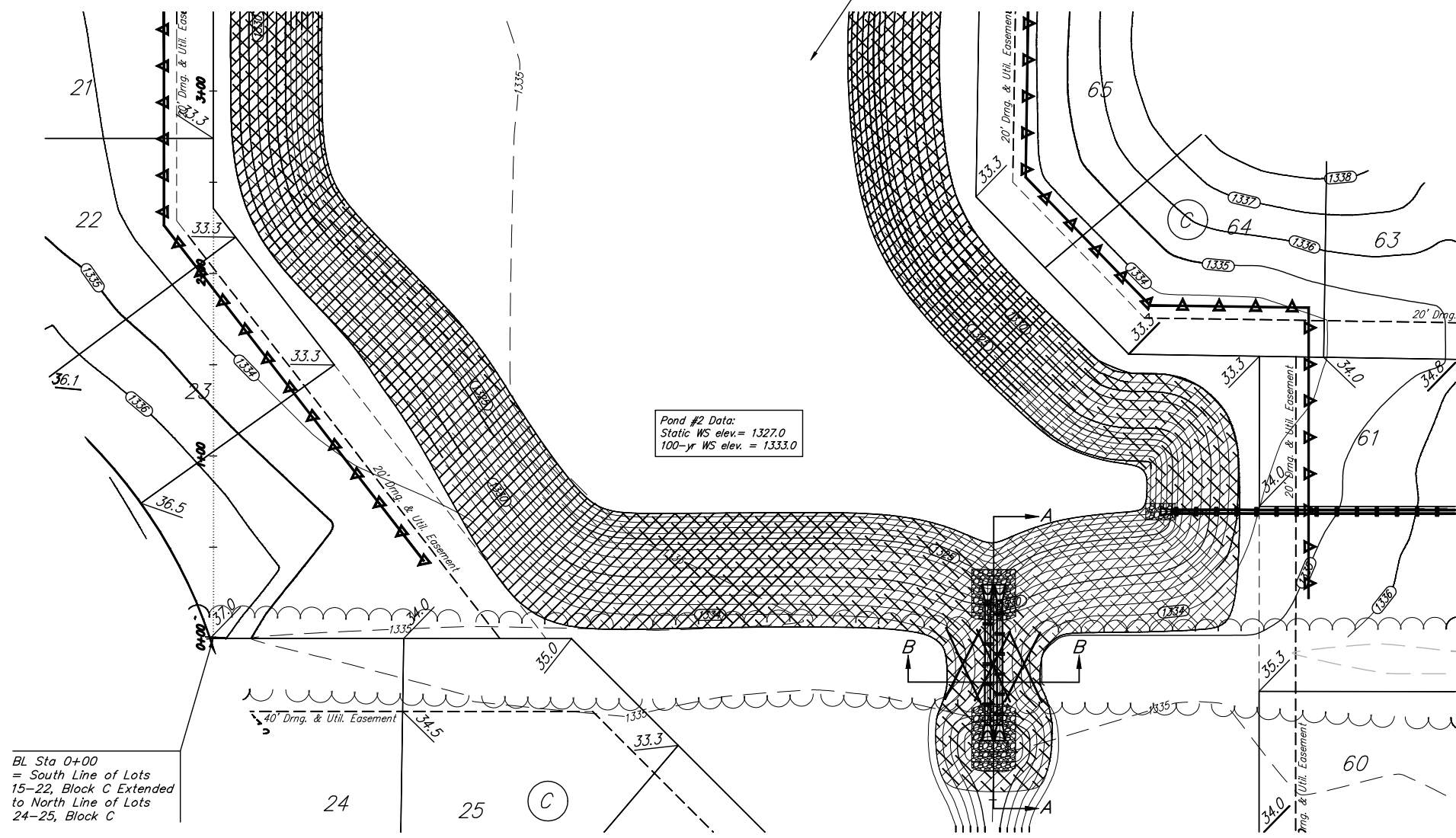

Pond #2 Data:
 Static WS elev. = 1327.0
 100-yr WS elev. = 1333.0

BL Sta 0+00
 = South Line of Lots
 15-22, Block C Extended
 to North Line of Lots
 24-25, Block C

Mass Grading and Erosion Control Plan Legend

- Proposed Storm Sewer
- Proposed Sanitary Sewer
- Proposed Grade
- Existing Grade
- Silt Fence
- Erosion Control Berm
- Straw Bale Ditch Check
- Drop Inlet Sed. Barrier
- Curb Inlet Sed. Barrier
- Remove Trees
- Erosion Control Mat

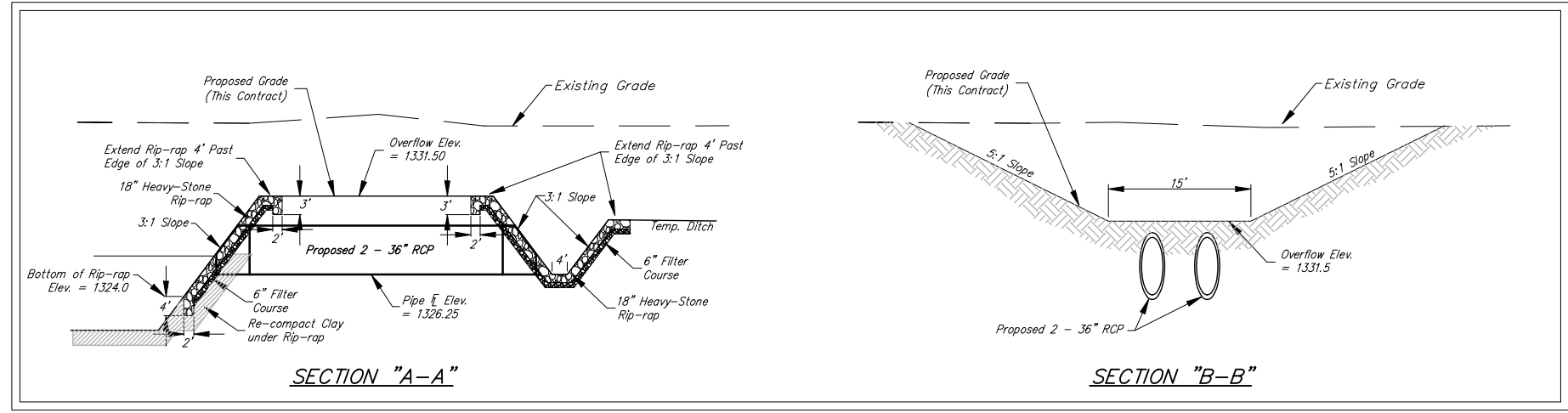

		NORTHGATE ADDITION	
Pond #2		Storm Water Drain #308	
Baughman Company, P.A. 315 8th St. W. Wabash, IL 67211 P 3162627271 F 3162620149			
ENGINEERING SURVEYING PLANNING LANDSCAPE ARCHITECTURE			
PROJECT NUMBER 468-64254	DESIGN AEG	DRAWN RDM	
REVISIONS:	APPROVED AEG	DATE 4-4-07	
	SCALE NOTED		
	SHEET		9 OF 48

Northgate\Mass Grading\MASS_PONDS.dwg