

Scale: 1"=60'

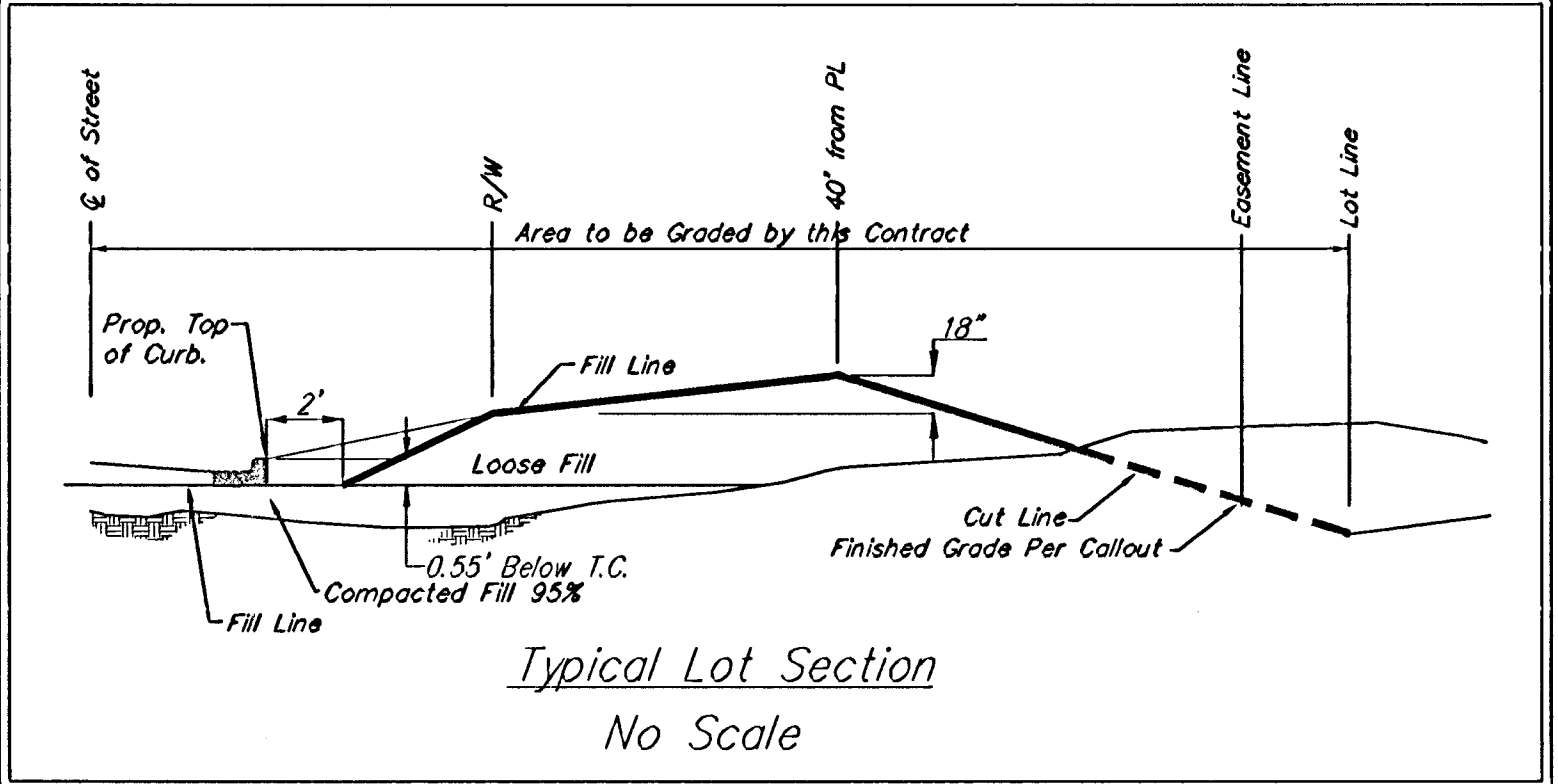

**EARTH WORK TOTALS**

	C.Y. Excavation	C.Y. Fill
Mass Grading	36,421	57,318

Contractor shall be required to stockpile 23,000 C.Y. on-site at the designated areas on the plan as determined by the ENGINEER. No more than 10,000 yards shall be stockpiled at stockpile #4. The Contractor shall be required to dispose all additional material off-site. Earthwork quantities are for reference only and do not include pond construction. All cost associated with mass grading shall be incidental to lump sum bid item "Mass Grading".

1. Contractor to strip top 3" of soil before mass grading and stockpile. Top soil stockpile to be redistributed over entire disturbed area excluding street right-of-way and ponds to achieve planned grade.
2. Compaction of 90% shall be obtained in all fill areas.
3. It shall be the Contractor's responsibility to protect the sanitary sewer and water distribution system during mass grading. Any damage done to these systems by Contractor or subcontractor shall be repaired at no additional cost to the project.
4. The Contractor is strictly prohibited to cut any timber on the following lots unless directed by the ENGINEER. (Lots 1-10, 16-19, 24, Blk. A; Lots 8, Blk. B; and Lots 1-5, Block D)

All areas disturbed during construction not under proposed pavement are to be seeded, mulched and fertilized as follows:  
**Seed:** - Rye Grass (PLS) - 3#/1000 Sq. Ft. and Kansas Premium Fescue Blend - 3#/1000 Sq. Ft.  
**Mulch:** - 2 tons prairie hay/acre.  
**Fertilizer:** - 12-24-12 ratio - 350 lbs./acre  
 Cost of seeding, fertilizing, and mulching shall be incidental to "Project Seeding".

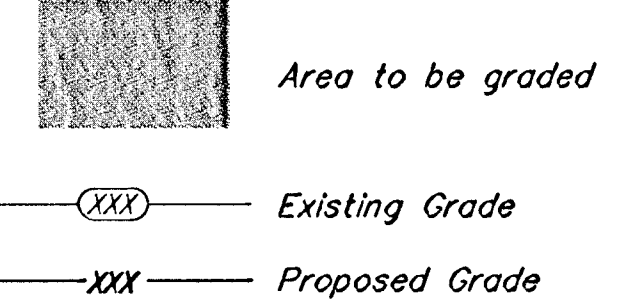

**FOSSIL RIM ESTATES**  
**MASS GRADING PLAN**  
WICHITA, KANSAS

**BAUGHMAN COMPANY P.A.**  
ENGINEERING, SURVEYING, & PLANNING  
318-262-7271 • 315 ELLIS • WICHITA, KANSAS 67211

PROJECT NUMBER <b>489-83449</b>				SHEET <b>23</b>
DESIGN NBW	DRAWN TMS	APPROVED	DATE 1/8/03	SCALE Noted



Contractor will be required to install hay bale barrier per detail, Sheet 35.

Contractor will be required to install hay bale barrier per detail, Sheet 35.

02-04-E292