

PLOTTED: Tuesday, April 23, 2019 @ 09:27AM

\\CTNAS03\VOL7\PROJECTS\2018\1801010519_COUNTRY HOLLOW 2ND CAD\SHOTS\06_CIVIL\PAV18519-06-5201.DWG

SUBDIVISION BENCH MARKS				
NO.	STREET AND STATION	FROM CL	DESCRIPTION	ELEVATIONS
1	GLEN WOOD, STA. 25+44.70	17.5' RT	TOP OF CURB AT S END OF INLET HOOKUP	

NOTE: CONTRACTOR SHALL INSTALL SUBDIVISION BENCH MARKS ("FLAT SURVEY MARKERS NO. 8134-08 3" TOP DIAMETER" PROVIDED BY KANSAS BLUE PRINT CO., INC.) COSTS TO BE CONSIDERED SUBSIDIARY TO CONSTRUCTION OF COMBINED CURB AND GUTTER.



PAVING PLANS FOR
COUNTRY HOLLOW 2ND ADDITION
PHASE 1

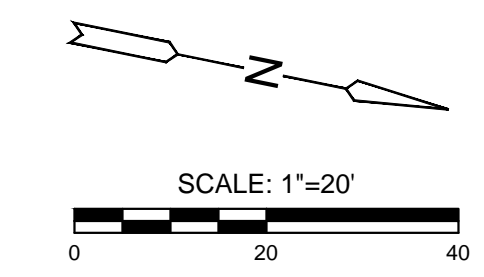
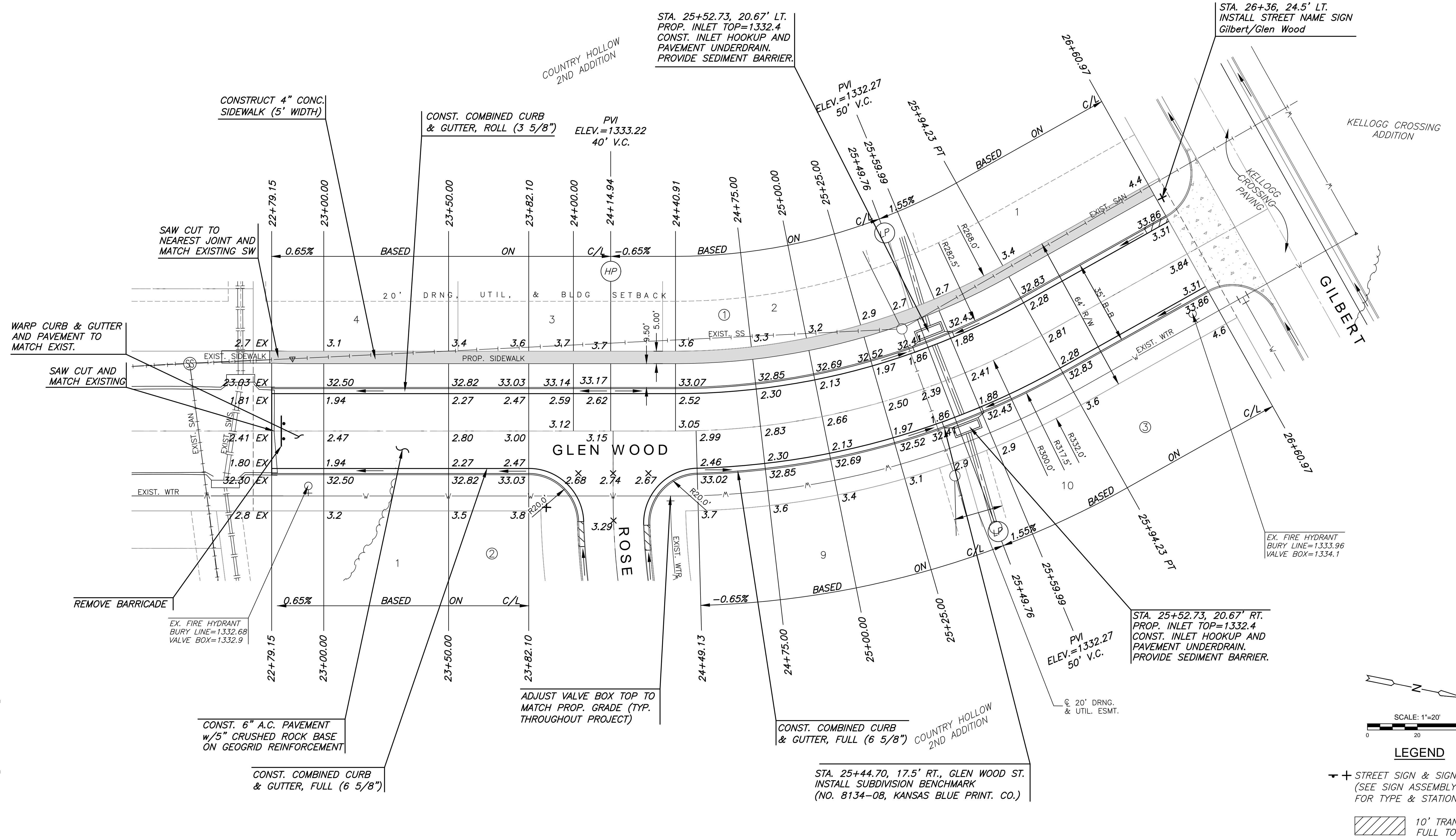

- LEGEND**
- STREET SIGN & SIGN LOCATION (SEE SIGN ASSEMBLY TABLE FOR TYPE & STATION OF SIGN)
 - 10' TRANSITION FROM FULL TO ROLL CURB

NOTE: TOP OF CURB ELEVATIONS SHOWN ARE FOR FULL CURB. CONSTRUCT CURB AND GUTTER AS NOTED.

©2019 MKEC Engineering All Rights Reserved www.mkec.com
These drawings and their contents, including, but not limited to, all concepts, designs, & ideas are the exclusive property of MKEC Engineering (MKEC), and may not be used or reproduced in any way without the express consent of MKEC.

PAVING PLAN GLEN WOOD

PROJECT NO.	472-84352
DATE	APR. 2019
SCALE	1" = 20'
DESIGNED	SLF
DRAWN	RWB
CHECKED	MAB

NO.	REVISION	DATE

SHEET NO.
05 OF 18