

PINE MEADOW ADDITION

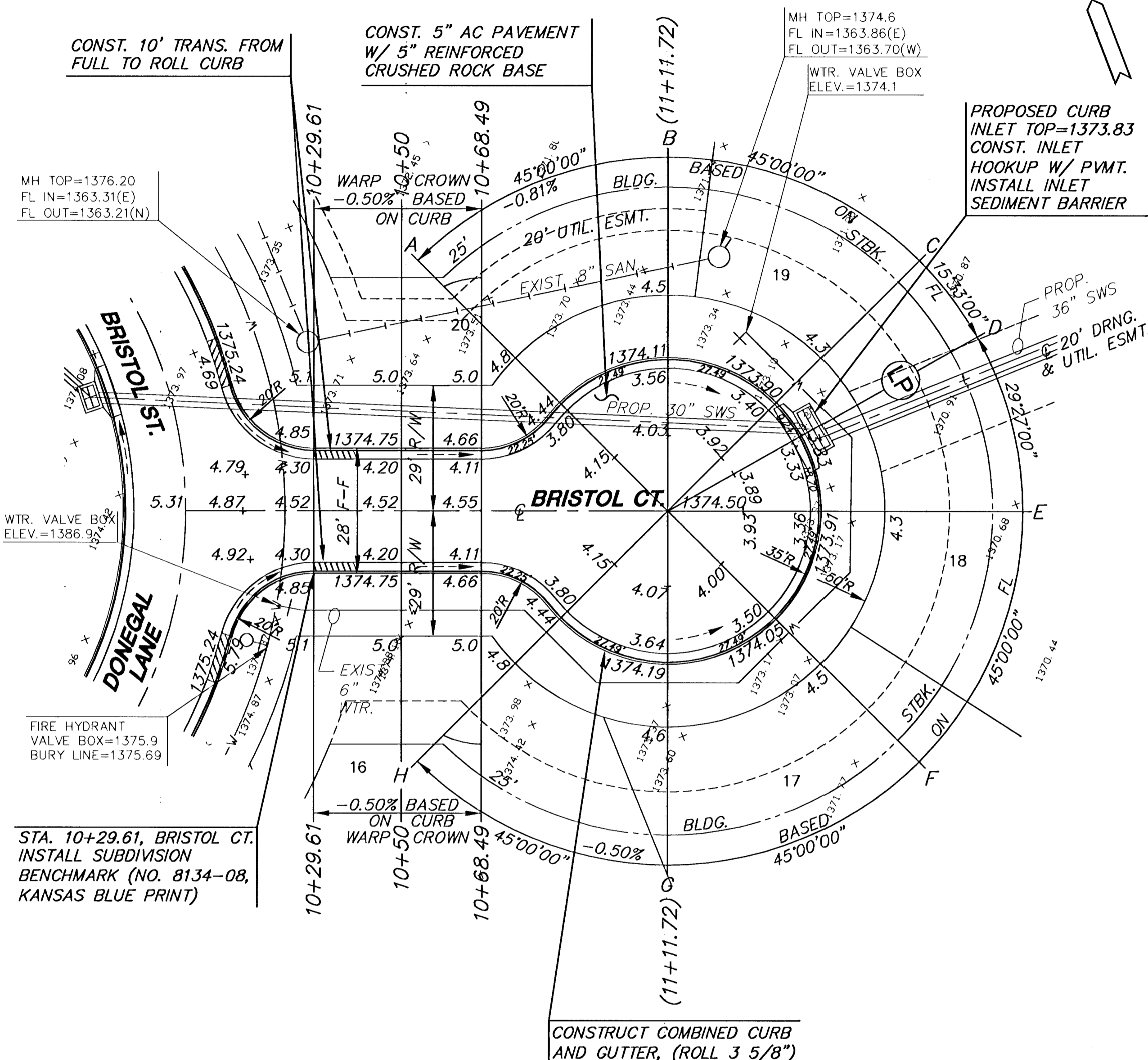
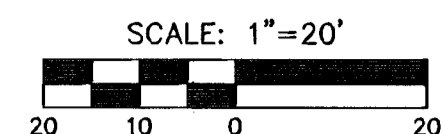

PINE MEADOW ADDITION

SUBDIVISION BENCH MARKS				
NO.	STREET AND STATION	FROM CL	DESCRIPTION	ELEVATIONS
3	BRISTOL CT., STA. 10+29.61	14.5' RT	TOP OF CURB AT END OF RETURN, BRISTOL CT.	

NOTE: CONTRACTOR SHALL INSTALL SUBDIVISION BENCH MARKS ("FLAT SURVEY MARKERS NO. 8134-08 3" TOP DIAMETER" PROVIDED BY KANSAS BLUE PRINT CO., INC.) COSTS TO BE CONSIDERED SUBSIDIARY TO CONSTRUCTION OF COMBINED CURB AND GUTTER.

PINE MEADOW ADDITION

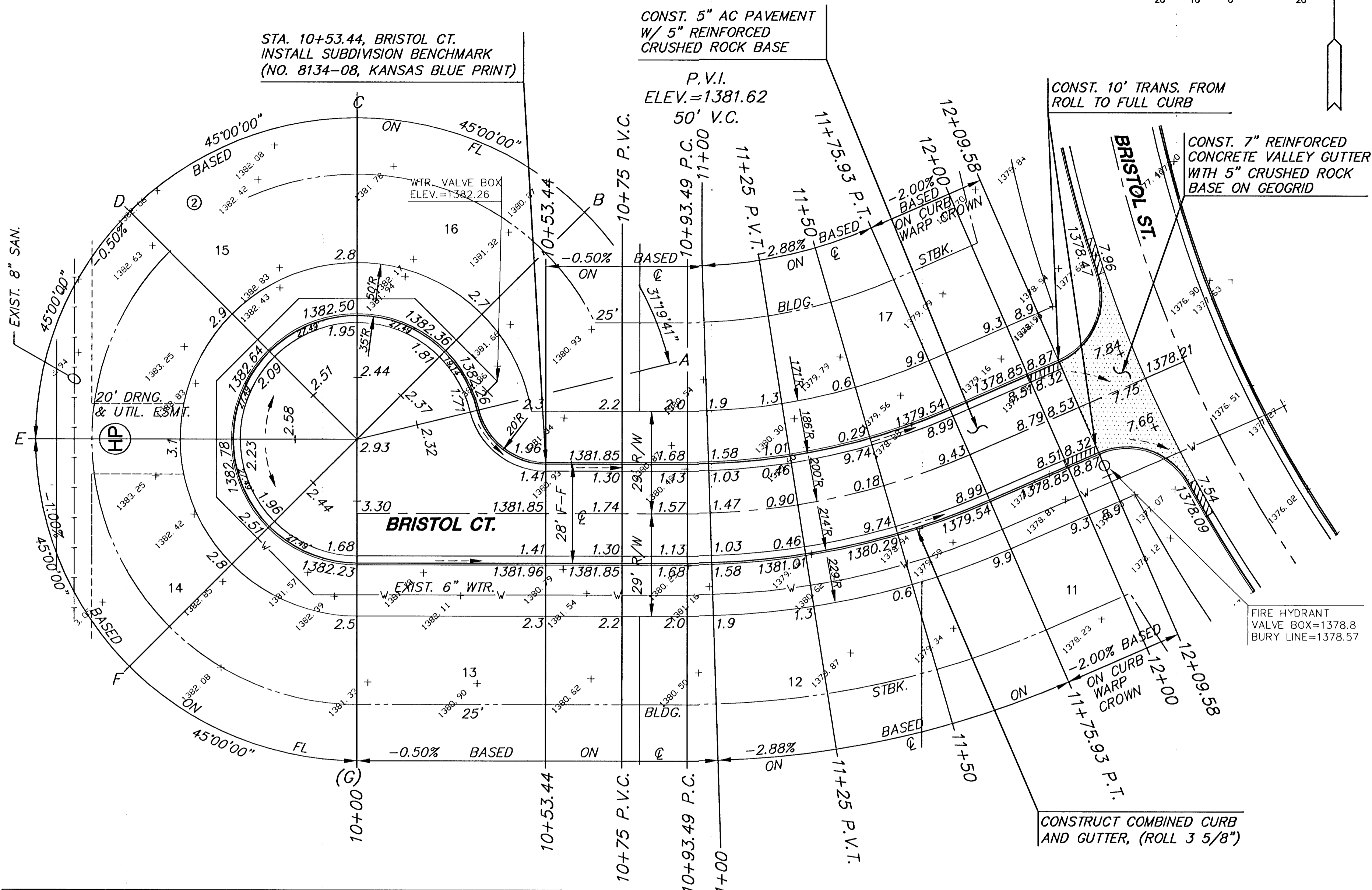
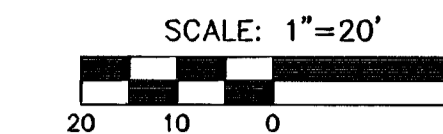

CURVE TABLE					
$\Delta = 23^{\circ}36'56''$ R = 200.00' T = 41.81' L = 82.43' LC = 81.85'					
CURVE DATA BASED ON CENTERLINE $\Delta / 2 = 11^{\circ}48'28''$					
STATION	ARC	CHORD LENGTH		DEFLECTION	TOTAL DEFLECTION
		'OFF LtCb	'OFF RtCb		
10+93.49	-	-	-	00°00'00"	00°00'00"
11+00.00	6.51'	6.97'	6.05'	00°55'57"	00°55'57"
11+25.00	25.00'	26.73'	23.23'	03°34'52"	04°30'49"
11+50.00	25.00'	26.73'	23.23'	03°34'52"	08°05'40"
11+75.00	25.00'	26.73'	23.23'	03°34'52"	11°40'32"
11+75.92	.92'	.99'	.86'	00°07'56"	11°48'28"

Def/Ft = 8.59437 Min.

SUBDIVISION BENCH MARKS				
NO.	STREET AND STATION	FROM CL	DESCRIPTION	ELEVATIONS
5	BRISTOL CT., STA. 10+53.44	14.5' LT	TOP OF CURB AT END OF RETURN, BRISTOL CT.	

NOTE: CONTRACTOR SHALL INSTALL SUBDIVISION BENCH MARKS ("FLAT SURVEY MARKERS NO. 8134-08 3" TOP DIAMETER" PROVIDED BY KANSAS BLUE PRINT CO., INC.) COSTS TO BE CONSIDERED SUBSIDIARY TO CONSTRUCTION OF COMBINED CURB AND GUTTER.

PINE MEADOW ADDITION

NOTE: TOP OF CURB ELEVATIONS SHOWN ARE FOR FULL CURB. CONSTRUCT COMBINED CURB & GUTTER, ROLLED (3 5/8").

LEGEND
 + STREET SIGN & SIGN LOCATION (SEE SIGN ASSEMBLY TABLE FOR TYPE & STATION OF SIGN)

MKEC
ENGINEERING CONSULTANTS
411 N. WEBB ROAD
WICHITA, KS. 67206
316-684-9600

PINE MEADOW ADDITION
PROJECT NAME

PAVING PLANS - BRISTOL COURT
SHEET TITLE

DESIGN BY: BSH	DRAWN BY: JAS	CHECKED BY: ASH
DATE: JULY 2003	JOB NO.: 01077	SHEET OF: 9 / 30