

Sta. 0+79.61 Line 5  
Center 30" Conc. Hdwl.  
w/Neenah R-5050-SF30  
Flap Gate or Approved Equal  
FL = 1346.00  
N 7898.610, E 8913.850  
4 SY Light Stone Rip Rap

Sta. 6+44.03 Line 5  
Constr. 2'x4' Drop Inlet  
Top Elev.=1351.7  
N 8109.881, E 9314.612

Sta. 3+20.90 Line 5  
Sta. 0+00.00 Line 6  
Const. Std. Type "P" MH w/  
2'x 2' Drop Inlet Top  
Top Elev. = 1351.7  
N 7898.127, E 9146.672

Sta. 3+84.76 Line 5  
Const. Std. Type P MH w/  
2'x 2' Drop Inlet Top  
Top Elev.=1352.3  
N 7897.994, E 9210.536

Sta. 5+24.10 Line 5  
Const. Std. Type P MH w/  
2'x 2' Drop Inlet Top  
Top Elev.=1352.3  
N 7989.949, E 9315.219

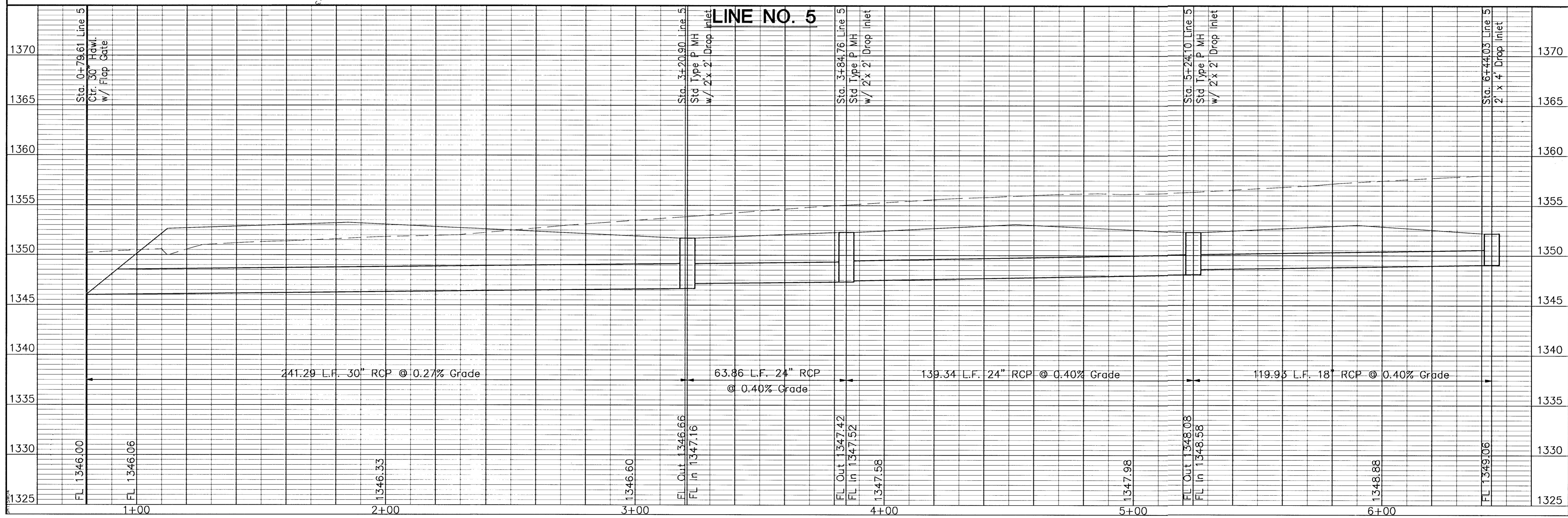

**FINAL**

Designed By: J. Ubert / B. Kulla  
 Drawn By: B. Kulla  
 POC Job No.: 1748A  
 Date: May 2003

**POE & ASSOCIATES OF KANSAS, INC.**  
 CONSULTING ENGINEERS  
 5940 E. Central, Suite 200 • Wichita, KS 67208-4292  
 Phone 316/686-4114 • FAX 316/686-4444

**CITY OF WICHITA, KANSAS**  
 NEIL D. CABLE, P.E. - CITY ENGINEER  
 C.O.W. Project # 472-63867 O.C.A. # 765782

FALCON FALLS - PHASE 1  
 STREET IMPROVEMENTS  
 LINE NUMBER 5

No.	Date	By	Approved	Revision
1				
2				
3				
4				

18 of 88

G:\APPS\DCAP\1748\BASE.dwg Wed Jun 18 11:19:41 2003