

SIGNING QUANTITIES THIS PROJECT				
TYPE	SIGN FACE DESCRIPTION	SIZE	INSTALL	RELOCATE
OM-1		18" x 18"	2	

FOR INFORMATION ONLY

STRIPING QUANTITIES THIS PROJECT			
ITEMS	UNITS	TOTAL	
PLASTIC MARKING TAPE (4" YELLOW)	LF	60	

FOR INFORMATION ONLY

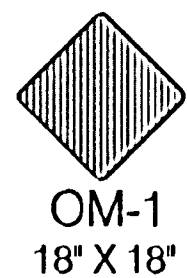

GENERAL NOTES - SIGNING

- NOTE:** References below to "standard specifications" denote "Standard Specifications for State Road and Bridge Construction, Edition 1990" by the Kansas Department of Transportation.
1. Post Anchors. Posts shall be anchored with a yielding base post support as detailed.
 2. Posts for Traffic Control Signs. Posts shall conform to the requirements of subsection 1620 of the standard specifications except that all posts shall weigh 3 lbs./foot minimum.
 3. Posts for Street Name Signs (SNS): Posts shall be 9 feet long, constructed from 2 3/8" O.D. galvanized steel pipe weighing a minimum of 3 lbs./ft. Posts shall be positioned so that the bottom blade is 7 feet above grade.
 4. Sign Blanks for Traffic Control Signs. Sign blanks shall be fabricated from 0.080" aluminum alloy 6063-T6 conforming to the requirements of subsection 1628 of the standard specifications.
 5. Mounting Brackets for Signs: Die-cast aluminum brackets shall be Aluminum Alloy 360 having a tensile strength of 44,000 psi. The brackets shall be smoothly finished free of pits, burrs, and flaws. Each bracket shall be tapped and drilled for 5/16" zinc-plated allen-type set screws have self-locking saw-tooth ends.
 6. Fasteners. All steel fasteners for traffic control signs shall be galvanized and shall conform to the requirements of Subsection 1614 of the standard specifications.
 7. Reflective Sheeting. Reflective sheeting shall be Type II - High performance class HA in accordance with subsection 2201 of the standard specifications.
 8. Details. Regulatory and warning signs shall conform to the details in "Standard Highway Signs", FHWA 1979.
 9. New traffic control and street name signs. New traffic control and street name signs shall be measured and paid for at the lump sum price for signing. The payment as set forth above shall be considered full compensation for all excavation, backfilling, posts, anchors, fasteners, materials, labor, tools, and incidentals necessary to complete this work.

- Remove sprinkler heads, bricks and brick edge restraint in Median (In non-Destructive way to items). Contact Kerry Greenstreet with Park Department @ 337-9225 for location to deliver sprinkler heads, extra bricks and brick edge restraint.
- Install 2 - 4" PVC Sleeves (108' Long, each). Contractor to re-connect Sprinkler System with appropriate pvc pipe and wiring through sleeves. Incidental to "Site Clearing & Restoration".
- Sta. 1+24.0 Begin Construction of Concrete/Brick Median Nose.
- Sta. 1+23.0 Install per City Specs: OM-1 (Yellow)
- Sta. 0+97.67, CP
- Sta. 1+30.0 Begin Construction of 7" A.C. Pavement w/ 8" Reinf. Rock Base. End Construction of Concrete/Brick Median Nose.
- Remove 104 lf Median Curb and Gutter (Both Sides) and dirt/rubble from Median and Dispose of Property.
- Sta. 2+22.0 End Construction of 7" A.C. Pavement w/ 8" Reinf. Rock Base. Begin Construction of Concrete/Brick Median Nose.
- Construct 7" A.C. Pavement w/ 8" Reinf. Rock Base, per Detail, this sheet.
- Construct Concrete/Brick Median Nose per details, this sheet. (Both Sides)
- Sta. 2+28.0 End Construction of Concrete/Brick Median Nose.
- Sta. 2+29.0 Install per City Specs: OM-1 (Yellow)

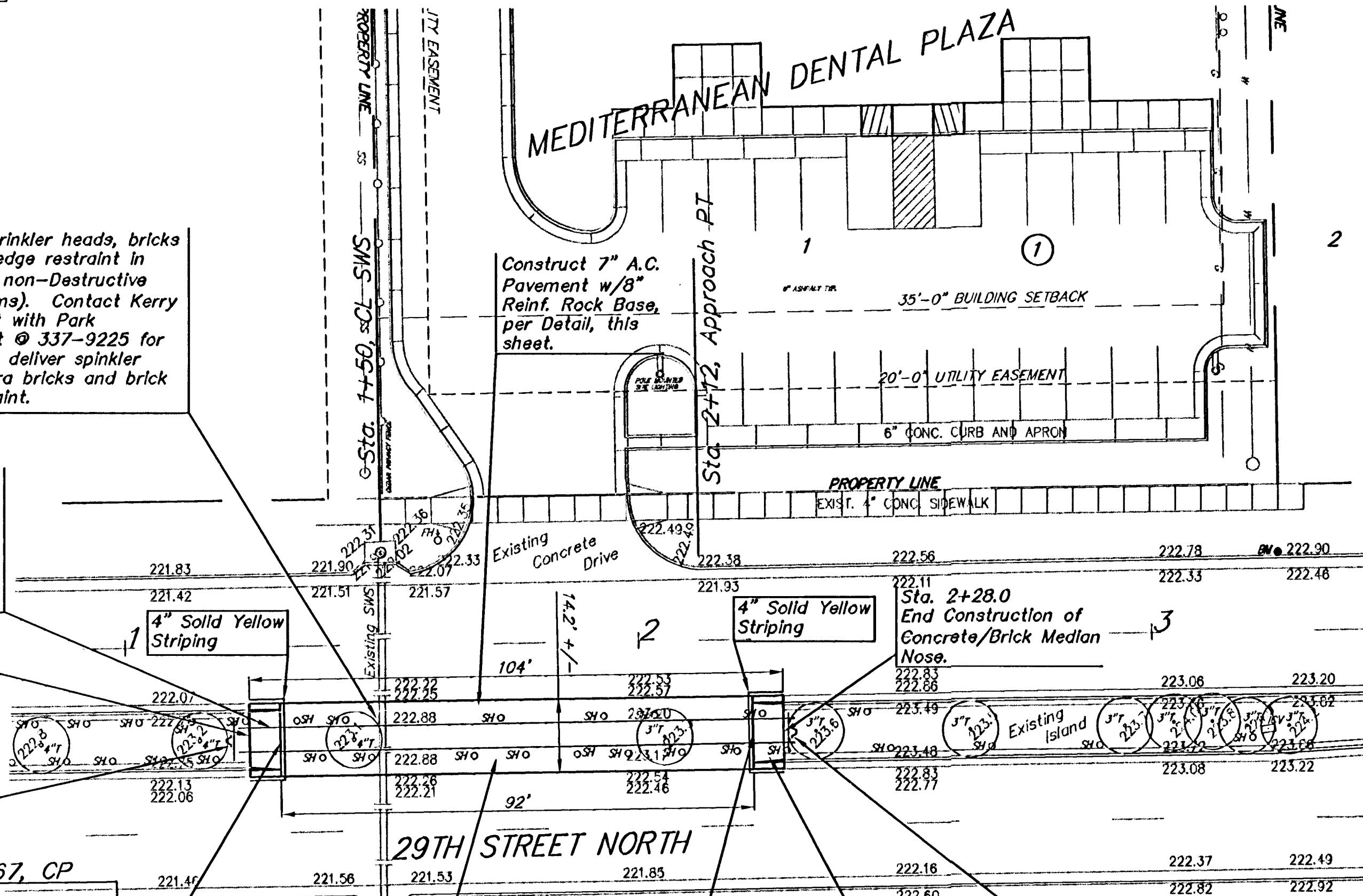

- Benchmarks:**
- BM #1: "□" Top of Curb at East Line of Lot 1, Block 1, Mediterranean Dental Plaza Elev. = 222.95 (City Datum)
 - BM #2: "□" West End of Headwall of RCB, Northeast Corner of Webb Road and K-96 Highway, Fox Pointe 2nd Addition Elev. = 222.08 (City Datum)

Scale: 1" = 20'
• = Iron

NOTE: Trees (Approx. 2) in Median Pavement Section that is to be removed are to be removed and disposed of Property.

		Mediterranean Dental Plaza Turn Lane Street Improvements	
<small>Baughman Company, P.A. 315 Ellis St. Wichita, KS 67211 P 316-263-7771 F 316-263-0149 ENGINEERING SURVEYING PLANNING LANDSCAPE ARCHITECTURE</small>			
PROJECT NUMBER 171 PPP	DESIGN MWS	DRAWN MWS	
REVISIONS	APPROVED	DATE 05/06	
	SCALE Noted		
	SHEET	2 OF 2	
<small>Baughman & Company Ltd.</small>		<small>06-05-E544</small>	