

J:\PROJECTS\2016\1601010151\_Mt. VERNON AND HILLSIDE\_160151\_CADD\SHOTS\05\_CIVIL\PAV\161514E07.DWG  
 PLOTTED: Tuesday, April 16, 2018 @ 03:57PM

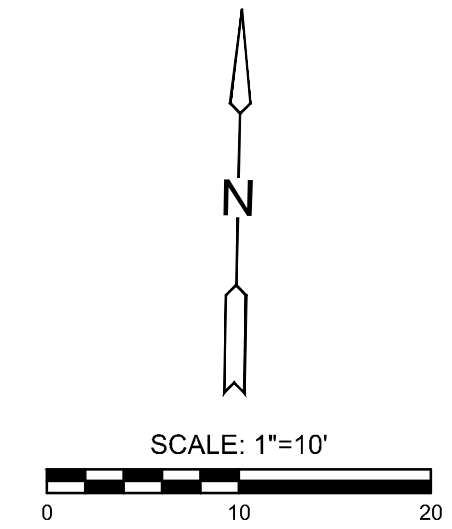
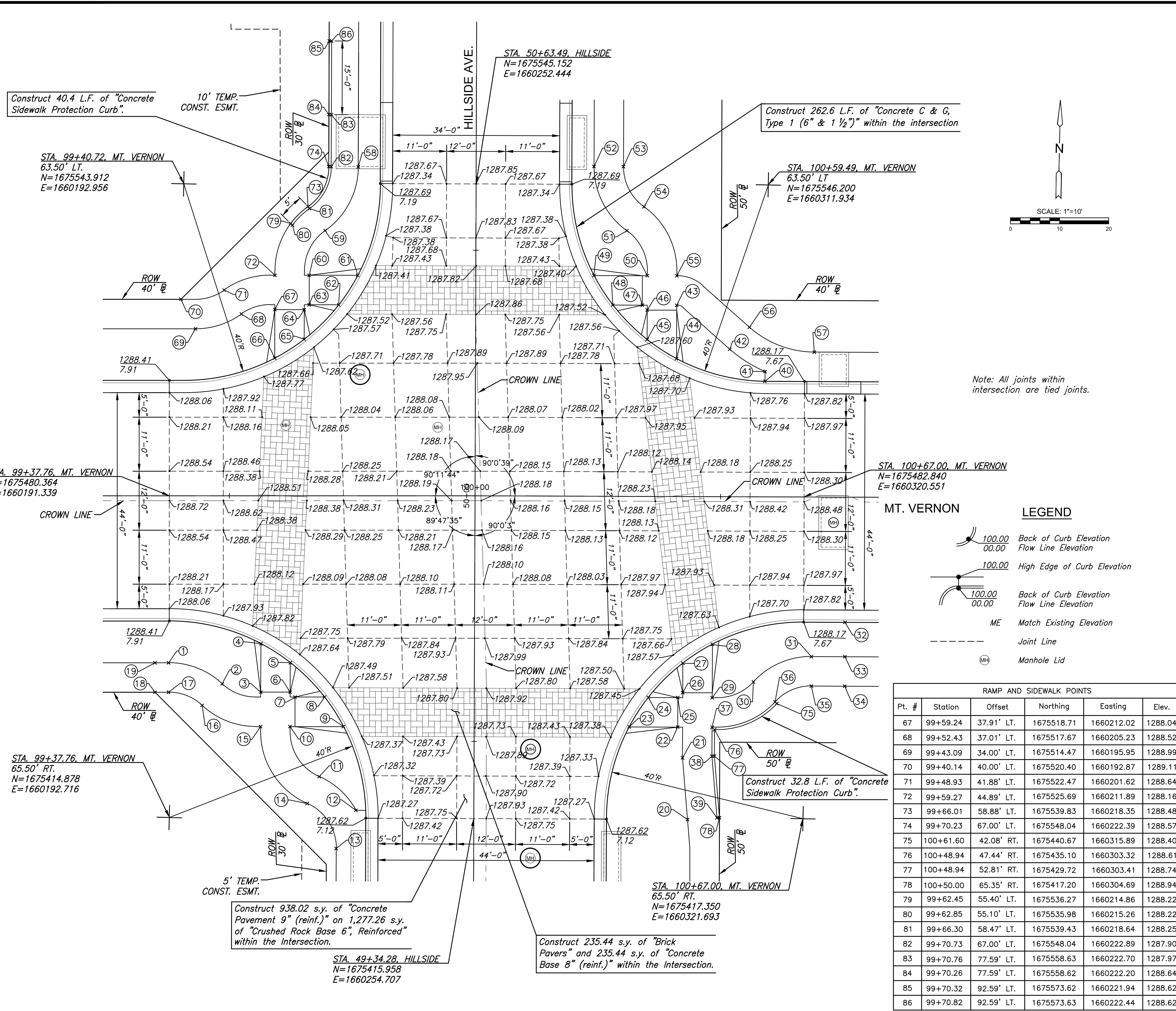

Note: All joints within intersection are tied joints.

**LEGEND**

- 100.00 Back of Curb Elevation
- 00.00 Flow Line Elevation
- 100.00 High Edge of Curb Elevation
- 100.00 Match Existing Elevation
- ME Joint Line
- MH Manhole Lid

RAMP AND SIDEWALK POINTS					
Pt. #	Station	Offset	Northing	Easting	Elev.
67	99+59.24	37.91' LT.	1675518.71	1660212.02	1288.04
68	99+52.43	37.01' LT.	1675517.67	1660205.23	1288.52
69	99+43.09	34.00' LT.	1675514.47	1660195.95	1288.99
70	99+40.14	40.00' LT.	1675520.40	1660192.87	1289.11
71	99+48.93	41.88' LT.	1675522.47	1660201.62	1288.64
72	99+59.27	44.89' LT.	1675525.69	1660211.89	1288.16
73	99+66.01	58.88' LT.	1675539.83	1660218.35	1288.48
74	99+70.23	67.00' LT.	1675548.04	1660222.39	1288.57
75	100+61.60	42.08' RT.	1675440.67	1660315.89	1288.40
76	100+48.94	47.44' RT.	1675435.10	1660303.32	1288.61
77	100+48.94	52.81' RT.	1675429.72	1660304.41	1288.74
78	100+50.00	65.35' RT.	1675417.20	1660304.69	1288.94
79	99+62.45	55.40' LT.	1675536.27	1660214.86	1288.22
80	99+62.85	55.10' LT.	1675535.98	1660215.26	1288.22
81	99+66.30	58.47' LT.	1675539.43	1660218.64	1288.25
82	99+70.73	67.00' LT.	1675548.04	1660222.89	1287.90
83	99+70.76	77.59' LT.	1675558.63	1660222.70	1287.97
84	99+70.26	77.59' LT.	1675558.62	1660222.20	1288.64
85	99+70.32	92.59' LT.	1675573.62	1660221.94	1288.62
86	99+70.82	92.59' LT.	1675573.63	1660222.44	1288.62

RAMP AND SIDEWALK POINTS					
Pt. #	Station	Offset	Northing	Easting	Elev.
1	99+37.62	34.00' RT.	1675446.37	1660191.91	1288.99
2	99+48.53	38.30' RT.	1675442.30	1660202.91	1288.50
3	99+56.37	39.96' RT.	1675440.80	1660210.78	1288.01
4	99+56.41	30.11' RT.	1675450.65	1660210.61	1287.68
5	99+62.39	33.98' RT.	1675446.91	1660216.68	1287.56
6	99+62.37	39.98' RT.	1675440.91	1660216.78	1287.89
7	99+63.37	40.98' RT.	1675439.93	1660217.80	1287.89
8	99+69.37	40.98' RT.	1675440.05	1660223.80	1287.39
9	99+73.22	46.98' RT.	1675434.14	1660227.78	1287.33
10	99+62.35	46.98' RT.	1675433.91	1660216.91	1288.01
11	99+68.27	57.17' RT.	1675423.85	1660223.04	1287.88
12	99+75.74	64.03' RT.	1675417.15	1660230.65	1287.67
13	99+71.74	71.82' RT.	1675409.28	1660226.82	1287.76
14	99+65.82	62.65' RT.	1675418.32	1660220.71	1288.00
15	99+56.35	46.98' RT.	1675433.78	1660210.91	1288.13
16	99+44.44	42.69' RT.	1675437.83	1660198.91	1288.62
17	99+37.62	40.00' RT.	1675440.37	1660192.03	1288.11
18	99+34.86	40.00' RT.	1675440.31	1660189.27	1289.26
19	99+34.86	34.00' RT.	1675446.31	1660189.15	1289.14
20	100+43.50	65.76' RT.	1675416.68	1660298.20	1288.82
21	100+42.44	53.09' RT.	1675429.21	1660296.92	1288.12
22	100+41.44	46.94' RT.	1675435.47	1660295.81	1287.82
23	100+31.57	46.94' RT.	1675435.29	1660285.95	1287.32
24	100+35.44	40.94' RT.	1675441.36	1660289.71	1287.36
25	100+41.44	40.94' RT.	1675441.46	1660295.71	1287.94
26	100+42.44	39.94' RT.	1675442.48	1660296.69	1287.94
27	100+42.44	33.94' RT.	1675448.48	1660296.58	1287.48
28	100+48.44	30.07' RT.	1675452.45	1660302.51	1287.52
29	100+48.44	40.94' RT.	1675441.59	1660302.70	1288.06
30	100+56.81	37.69' RT.	1675444.98	1660311.02	1288.43
31	100+68.61	32.50' RT.	1675450.37	1660322.73	1288.81
32	100+75.42	25.50' RT.	1675457.49	1660329.42	1288.20
33	100+75.42	32.50' RT.	1675450.49	1660329.54	1289.19
34	100+75.42	38.50' RT.	1675444.49	1660329.64	1289.31
35	100+68.61	38.50' RT.	1675444.37	1660322.83	1288.86
36	100+61.23	41.74' RT.	1675441.00	1660315.51	1288.40
37	100+48.44	46.94' RT.	1675435.59	1660302.81	1287.94
38	100+48.44	52.83' RT.	1675429.68	1660302.91	1288.24
39	100+49.50	65.38' RT.	1675417.16	1660304.19	1288.94
40	100+58.94	23.50' LT.	1675506.20	1660312.09	1288.12
41	100+58.97	25.50' LT.	1675508.20	1660312.08	1288.16
42	100+51.76	30.02' LT.	1675512.59	1660304.79	1288.10
43	100+40.92	38.93' LT.	1675521.31	1660293.80	1288.04
44	100+40.93	28.07' LT.	1675510.45	1660293.99	1287.57
45	100+34.92	31.93' LT.	1675514.21	1660287.92	1287.52
46	100+34.92	37.93' LT.	1675520.21	1660287.82	1287.92
47	100+33.92	38.93' LT.	1675521.19	1660286.80	1287.92
48	100+27.92	38.93' LT.	1675521.08	1660280.80	1287.42
49	100+24.06	44.93' LT.	1675527.02	1660276.84	1287.35
50	100+34.92	44.93' LT.	1675527.20	1660287.70	1288.04
51	100+30.72	54.08' LT.	1675536.28	1660283.33	1288.19
52	100+23.99	67.11' LT.	1675549.20	1660276.38	1288.34
53	100+29.99	67.12' LT.	1675549.30	1660282.38	1288.46
54	100+34.19	58.97' LT.	1675541.23	1660286.72	1288.31
55	100+40.92	44.93' LT.	1675527.31	1660293.69	1288.16
56	100+55.73	34.51' LT.	1675517.15	1660308.69	1288.22
57	100+68.98	29.50' LT.	1675512.37	1660322.02	1288.28
58	99+76.23	66.98' LT.	1675548.14	1660228.39	1288.16
59	99+69.49	53.99' LT.	1675535.01	1660221.92	1287.79
60	99+66.25	44.89' LT.	1675525.84	1660218.87	1288.04
61	99+76.12	44.89' LT.	1675526.05	1660228.74	1287.35
62	99+72.25	38.89' LT.	1675519.97	1660225.00	1287.42
63	99+66.25	38.89' LT.	1675519.84	1660219.00	1287.92
64	99+65.24	37.89' LT.	1675518.82	1660218.02	1287.92
65	99+65.22	31.89' LT.	1675512.82	1660218.12	1287.53
66	99+59.21	28.03' LT.	1675508.84	1660212.19	1287.63



STREET IMPROVEMENTS FOR  
**MT. VERNON & HILLSIDE INTERSECTION**  
 PAVING PLANS

©2019 MKEC Engineering All Rights Reserved  
 These drawings and their contents, including, but not limited to, all concepts, designs, & ideas are the exclusive property of MKEC Engineering (MKEC), and may not be used or reproduced in any way without the express consent of MKEC.

**INTERSECTION PLAN**

PROJECT NO.	472-85286	
DATE	DATE	
SCALE	1"=10'	
DESIGNED	DRAWN	CHECKED
DMU	WNJ	JRA
NO.	REVISION	DATE
SHEET NO.		
22 OF 101		