

WATER SERVICE SUMMARY

BL STATION	LT./RT.	SERVICE (LONG OR SHORT)	ADDRESS	AS BUILT
100+82	LT.	SHORT	858 S. HILLSIDE	
101+09	RT.	LONG	902 S. HILLSIDE	
102+45	LT.	SHORT	847 S. HOLYOKE	
103+99	RT.	LONG	900 S. HOLYOKE	
104+04	LT.	SHORT	848 S. HOLYOKE	
104+56	LT.	SHORT	3306 E. LINCOLN	

WHERE PAVEMENT REMOVAL CROSSES FOR BOTH SANITARY SEWER AND WATER MAIN IT SHALL BE QUANTIFIED W/ SANITARY SEWER. IT IS THE CONTRACTORS RESPONSIBILITY TO PROVIDE TEMPORARY PAVEMENT PATCHING IF NECESSARY. PAYMENT WILL ONLY BE MADE FOR ONE REMOVAL & REPLACEMENT.

NOTES:
 1. Where proposed water line crosses existing water line, contractor to pothole existing water line to ensure no conflicts prior to construction. Contractor to ensure 3.5' minimum bury depth is maintained on all new water lines.

- 8" CONCRETE PAVEMENT REMOVE & REPLACE W/ MONOLITHIC CURB
- SIDEWALK REMOVE & REPLACE
- 6" CONCRETE DRIVEWAY REMOVE & REPLACE

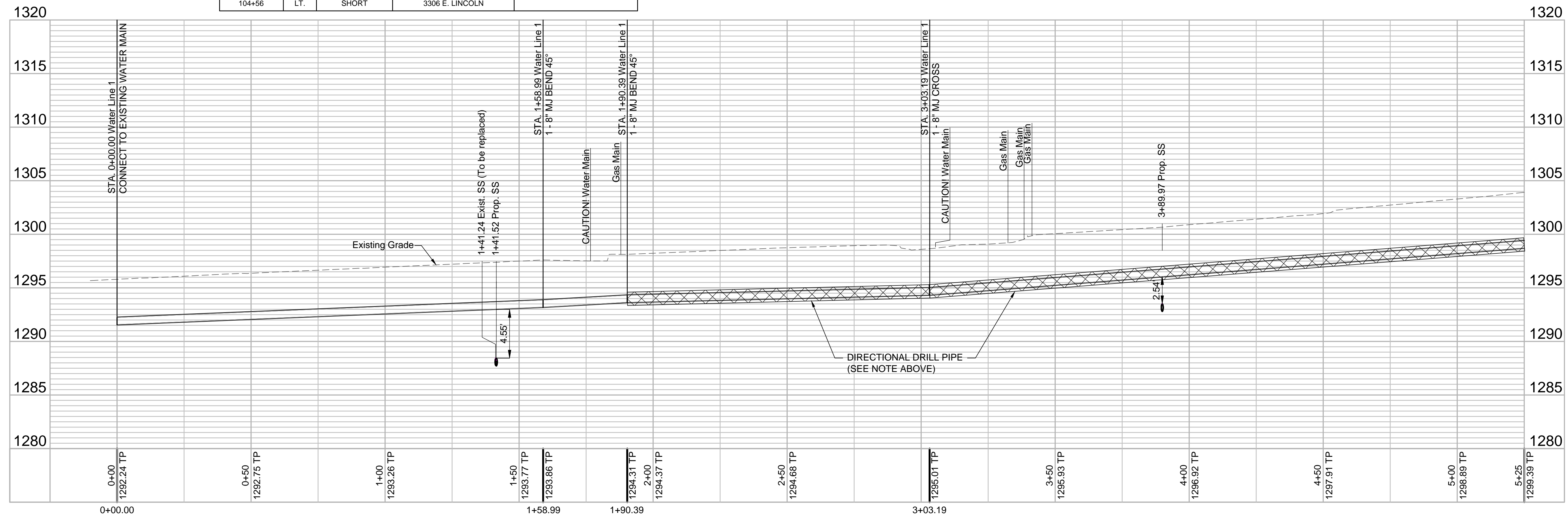

File: L:\2018\18267014 - Lincoln Street Water and SS WichitaDrawings\C3D\Water Line 1-1.dwg, Last Save: 4/11/2019 8:38 AM, Last saved by: MTDolechek
 Last plotted by: Dolechek, Mark T., Plot Style: ..., Plot Date: 4/11/2019 9:01 AM, Plotter Used: None

REV.	DATE	DESCRIPTION	BY
1	4-10-19	Added address & owner info	MTD

CITY OF WICHITA
 WICHITA, KANSAS
 LINCOLN STREET
 WATER AND
 SANITARY SEWER

Water Line 1
 (1 of 3)

JOB NO.: 18267014
 DATE: JAN. 2019
 DESIGNED BY: MTD
 DRAWN BY: DRS

BAR IS ONE INCH ON ORIGINAL DRAWING
 IF NOT ONE INCH ON THIS SHEET, ADJUST SCALES ACCORDINGLY.

DRAWING NUMBER

SHEET NUMBER **11** OF **22**