

REED'S COVE ADDITION

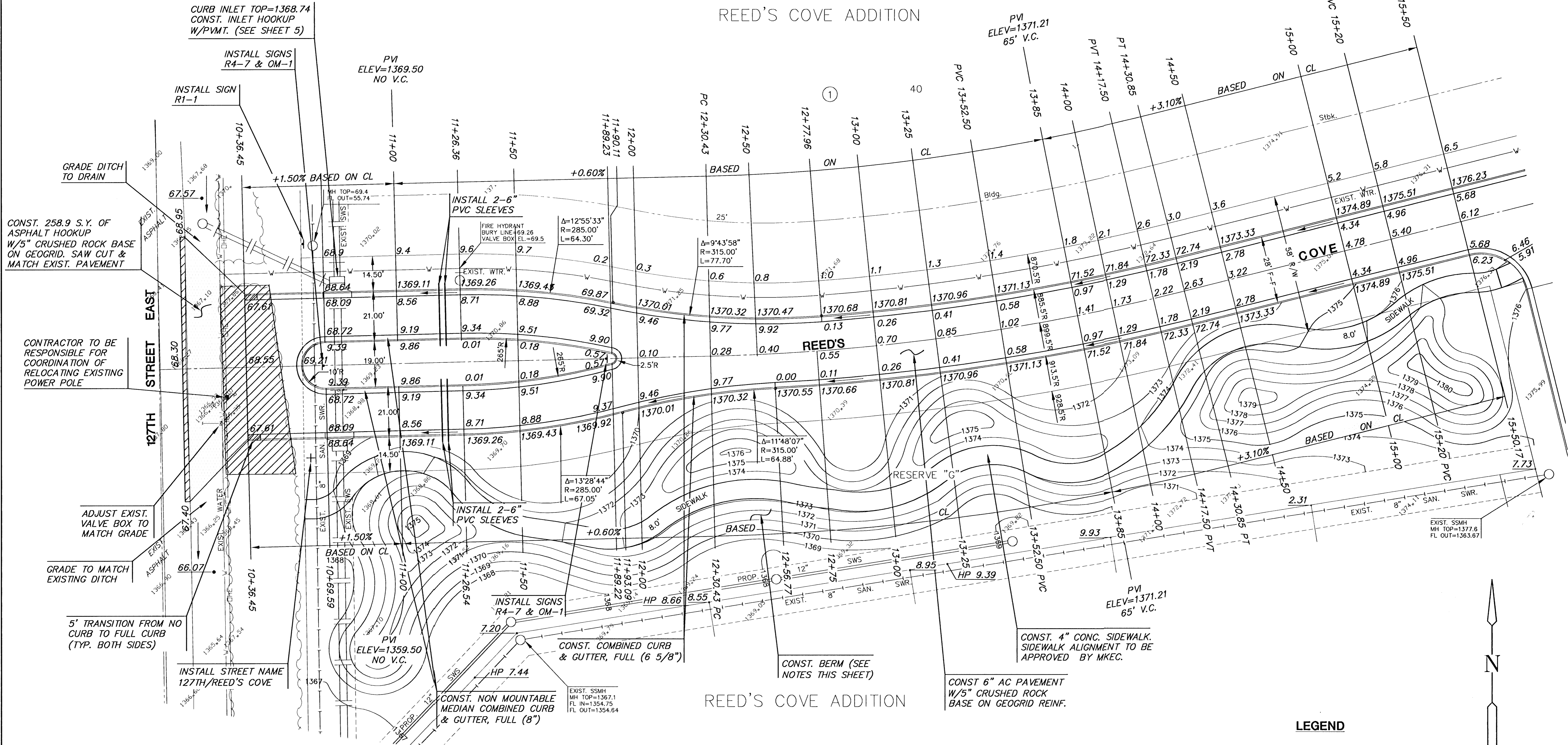

**BERM GRADING NOTES:**

1. THIS IS DESIGN GRADING. ALL GRADES SHALL BE CONTOURED SMOOTHLY WITH GENTLE ROUNDING/SHAPING OF ALL AFFECTED LAND SURFACES. ABRUPT TRANSITIONS OF SLOPES WHERE PROPOSED GRADES MEET EXISTING ARE NOT ACCEPTABLE. SURVEY STAKES ARE FOR GENERAL GRADING PURPOSES ONLY. NOT ALL SLOPES ARE CONSTANT AND THEREFORE THE PLAN ON THIS SHEET SHALL BE REFERRED TO FOR FINAL GRADING. THE GRADING SHALL BE APPROVED BY THE OWNER AND/OR THE ENGINEER PRIOR TO THE ADDITION OF THE 12" TOPSOIL LAYER.
2. A 12" LAYER OF TOPSOIL SHALL BE STRIPPED IN ALL AREAS OF CUT AND FILL AND REPLACED AT A 12" THICKNESS ON PROPOSED GRADING AREAS. NOTE: THE FINISHED GRADE INDICATES THE SURFACE ELEVATION AFTER THE LAYER OF TOPSOIL HAS BEEN PLACED.
3. WHERE OFFSITE TOPSOIL IS NEEDED, IT SHALL BE FERTILE NATURAL TOPSOIL, TYPICAL OF THE LOCALITY, OBTAINED FROM WELL DRAINED AREAS. STOCKPILED TOPSOIL MAY BE USED. IT SHALL BE WITHOUT ADMIXTURE OF SUBSOIL OR SLAG AND SHALL BE FREE OF STONES, LUMPS, STICKS, PLANTS OR THEIR ROOTS, TOXIC SUBSTANCES OR OTHER EXTRANEIOUS MATTER THAT MAY BE HARMFUL TO PLANT GROWTH OR WOULD INTERFERE WITH FUTURE MAINTENANCE. TOPSOIL pH RANGE SHALL BE 5.5 TO 7.0. TOPSOIL SHALL BE APPROVED BY THE LANDSCAPE ARCHITECT PRIOR TO PLACEMENT.
4. APPROXIMATELY 7000 CUBIC YARDS OF FILL HAVE BEEN PLACED IN RESERVE "G". CONTRACTOR TO SHAPE BERM AS INDICATED ON PLANS. COST SUBSIDIARY TO BID ITEM "BERM GRADING".

REED'S COVE ADDITION

CURVE TABLE						
$\Delta = 12'45'32''$ R = 900.00' T = 100.62' L = 200.42' LC = 200.00'						
CURVE DATA BASED ON CENTERLINE $\Delta / 2 = 06'22'46''$						
STATION	ARC	CHORD LENGTH		DEFLECTION	TOTAL DEFLECTION	
		8' Off LtCb	8' Off RtCb			
12+30.43	-	-	-	00°00'00"	00°00'00"	
12+50.00	19.57'	19.09'	20.05'	00°37'23"	00°37'23"	
12+75.00	25.00'	24.39'	25.61'	00°47'45"	01°25'07"	
13+00.00	25.00'	24.39'	25.61'	00°47'45"	02°12'52"	
13+25.00	25.00'	24.39'	25.61'	00°47'45"	03°00'37"	
13+50.00	25.00'	24.39'	25.61'	00°47'45"	03°48'22"	
13+75.00	25.00'	24.39'	25.61'	00°47'45"	04°36'07"	
14+00.00	25.00'	24.39'	25.61'	00°47'45"	05°23'51"	
14+25.00	25.00'	24.39'	25.61'	00°47'45"	06°11'36"	
14+30.85	5.85'	5.70'	5.99'	00°11'10"	06°22'46"	

Def/Ft = 1.90986 Min.

**LEGEND**

STREET SIGN & SIGN LOCATION (SEE SIGN ASSEMBLY TABLE FOR TYPE & STATION OF SIGN)

TREE REMOVAL

SCALE: 1"=20'

**MKEC**  
ENGINEERING CONSULTANTS  
411 N. WEBB ROAD  
WICHITA, KS. 67206  
316 - 684 - 9600

**REED'S COVE ADDITION - ENTRY PHASE**  
PROJECT NAME

**REED'S COVE**  
SHEET TITLE

DESIGN BY: **DFL** DRAWN BY: **KKL/DMU** CHECKED BY: **DRK**

DATE: **JULY 2003** JOB NO.: **02121E1** SHEET OF: **7 / 18**