

VICINITY MAP

20" Water Main Extension to serve VILLAGE CHARTERS 3RD ADDITION CITY OF WICHITA, KANSAS

Gary Janzen, P.E. City Engineer

SHEET INDEX

1	Title Sheet
2	Notepage
3-4	Water Line 1 Plan/Profile
5-7	Standard Water Details
8	Erosion Control Plan
9-13	Erosion Control Details

Project Number
448-2019-005421

OCA Number
636506

July 2019

BENCHMARKS

BM #1 - Chiseled "X" on Top of the Curb on the West Side of the Median on Ridge Road North of the Entrance/Exit Ramps on K-96.
Elev. = 1336.16 (NAVD 88)

BM #2 - Chiseled "+" in the Flowline of the Curb on the West Side of the Median on Ridge Road South of the K-96 Bridge.
Elev. = 1335.04 (NAVD 88)

CONTROL POINTS

- CP 100 - Chiseled "+" in Flowline of Median Curb
West Quarter Corner, Sec. 27, Twp 27S, R 1W
B.L. Sta. 50+00.00
N-1712008.957
E-1622686.711
- CP 101 - #4 Rebar with Yellow Cap
B.L. Sta. 40+90.47, 65.85' Lt.
N-1711097.954
E-1622646.055
- CP 102 - #4 Rebar with Yellow Cap
B.L. Sta. 46+75.56, 83.01' Rt.
N-1711686.935
E-1622778.671

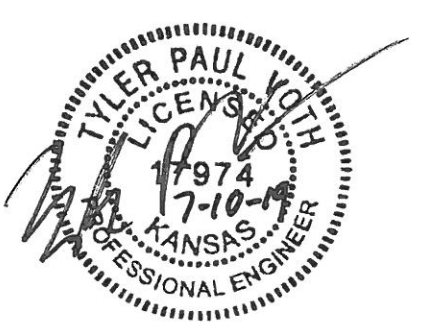
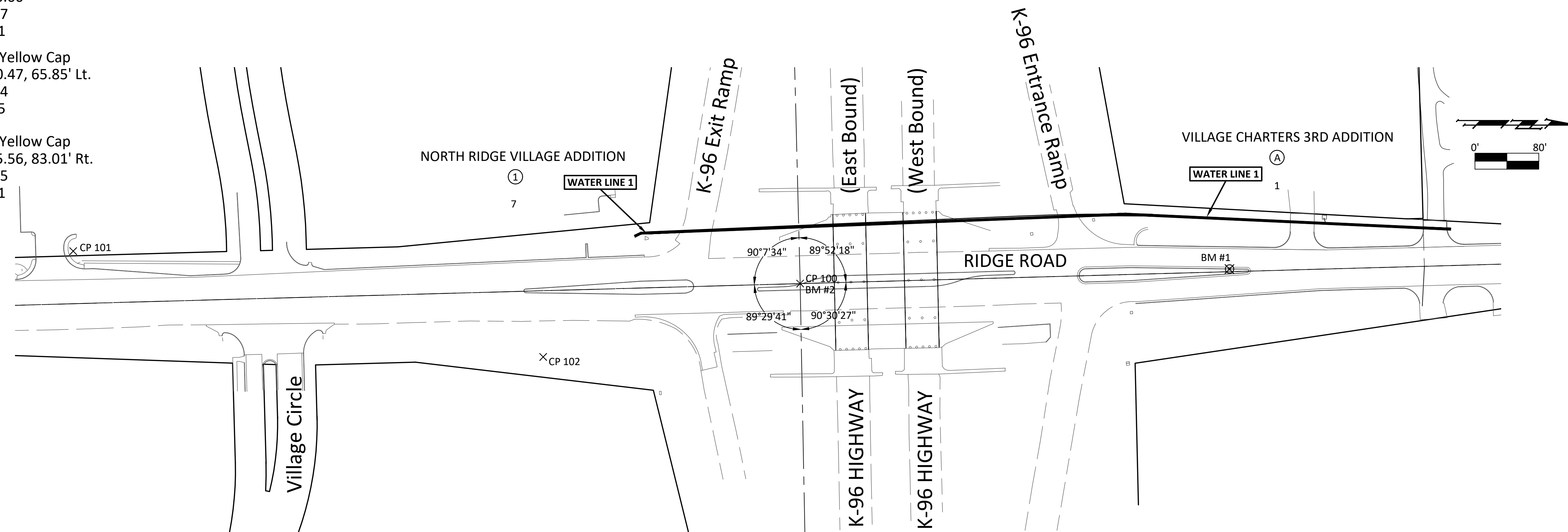

BAUGHMAN 315 ELLIS | WICHITA, KS 67211
[P] 316-262-7271
[BaughmanCo.com]