

N 1667561.63 E 1653541.90
 STA. 0+00.00, LINE 22 =
 STA. 0+79.59 GIDLEY, 19.00' LT.
 CONNECT TO EXIST. 8" MAIN
 * 1-8" TAPPING VALVE
 * 1-8"X8" TAPPING SLEEVE
 ** 1-6" VALVE BOX ASS'Y.
 VALVE BOX ELEV. 1276.80
 *SUPPLIED AND INSTALLED BY
 CITY OF WICHITA WATER DEPT.
 ** SUPPLIED BY C.O.W.
 INSTALLED BY CONTRACTOR

N 1667561.97 E 1653564.19
 STA. 0+22.30, LINE 22 =
 STA. 1+01.89 GIDLEY, 19.00' LT.
 1-8" MJ BEND 45° (VERT.)

2.60 L.F. 8" DICT
 SEE DISCONNECT #7,
 SHEET NO. 47

N 1667562.01 E 1653566.79
 STA. 0+24.90, LINE 22 =
 STA. 1+04.49 GIDLEY, 19.00' LT.
 1-8" MJ BEND 45° (VERT.)

N 1667561.72 E 1653548.19
 STA. 0+06.30, LINE 22 =
 STA. 0+85.89 GIDLEY, 19.00' LT.
 1-8" MJ BEND 45° (VERT.)

WATER METER SUMMARY				
BL Station	Lt./Rt.	Service (Long or Short)	Address	As Built
1+73	Rt.	Long	1301 E. GIDLEY	
1+77	Lt.	Short	1302 E. GIDLEY	
2+25	Rt.	Long	1307 E. GIDLEY	
2+46	Lt.	Short	1308 E. GIDLEY	
2+92	Rt.	Long	1315 E. GIDLEY	

WATER METER SUMMARY				
BL Station	Lt./Rt.	Service (Long or Short)	Address	As Built
3+12	Lt.	Short	1314 E. GIDLEY	
3+58	Rt.	Long	1319 E. GIDLEY	
3+76	Lt.	Short	1320 E. GIDLEY	
4+19	Rt.	Long	1325 E. GIDLEY	

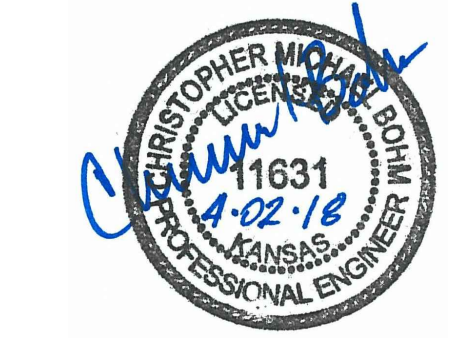

Existing Pavement, Curb and Gutter to be Removed and Replaced as necessary for construction. No additional pay shall be made for this work. *Subsidiary* to other pay items.

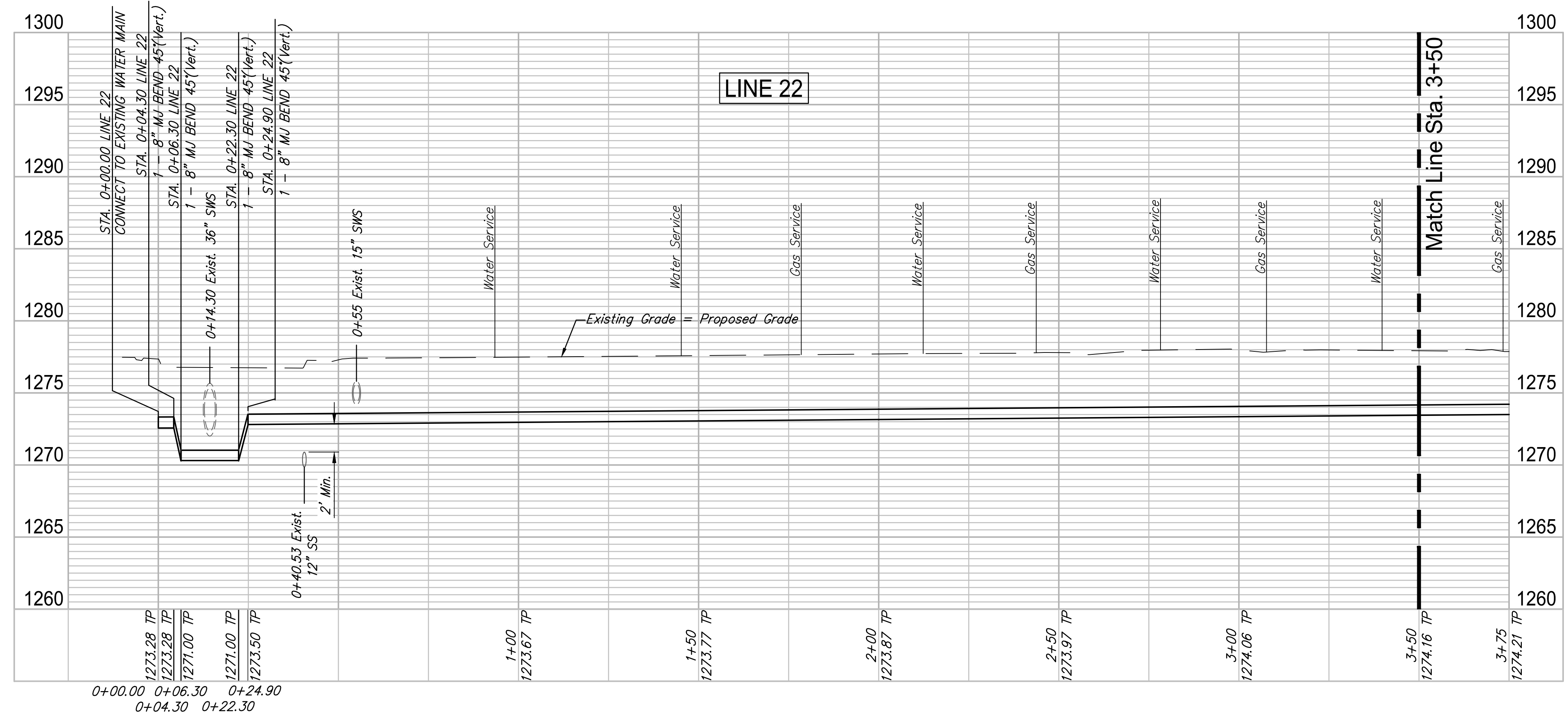

PROJECT NUMBER: 448-30721
 DESIGN: CMB / RA
 DRAWING FILE: LINE 22 - Gidley
 REVIEW: 5-24-2017
 DATE: 4/2/2018
 DRAWN: DRS / RA
ROSE MARIE WATER - Part B
Gidley - Line 22 (1 of 2)
 Wichita, Kansas
 SHEET NO. 15 OF 53
 © Copyright 2018, Garver

F:\Projects\Projects 4700-4799\4701W (Rose Marie waterline replacement)\LINE 22 - Gidley.dwg