

F:\Projects\Projects 4700-4799\4701W (Rose Marie waterline replacement)\LINE 23 - 31st St. S.dwg

WATER METER SUMMARY				
BL Station	Lt./Rt.	Service (Long or Short)	Address	As Built
1+78	Lt.	Long	1302 E. 31ST	
1+82	Rt.	Short	1301 E. 31ST	
2+23	Lt.	Long	1308 E. 31ST	
2+31	Rt.	Short	1307 E. 31ST	
2+89	Lt.	Long	1314 E. 31ST	
2+89	Rt.	Short	1315 E. 31ST	
3+57	Lt.	Long	1320 E. 31ST	
3+60	Rt.	Short	1321 E. 31ST	
4+08	Rt.	Short	1327 E. 31ST	
4+18	Lt.	Long	1326 E. 31ST	

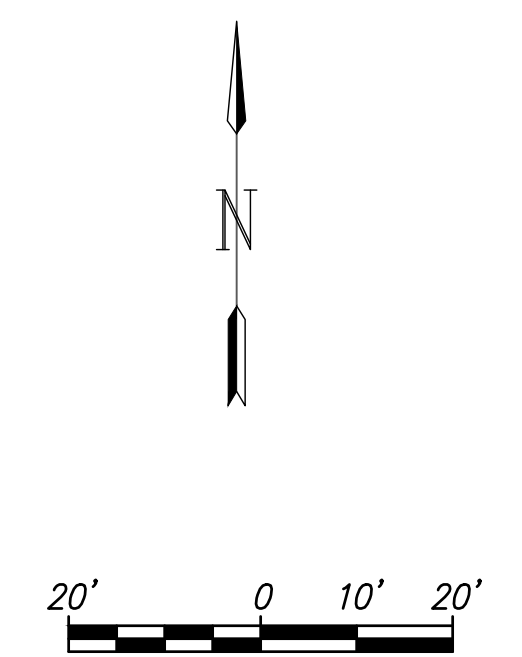

Existing Pavement, Curb and Gutter to be Removed and Replaced as necessary for construction. No additional pay shall be made for this work, Subsidiary to other pay items.

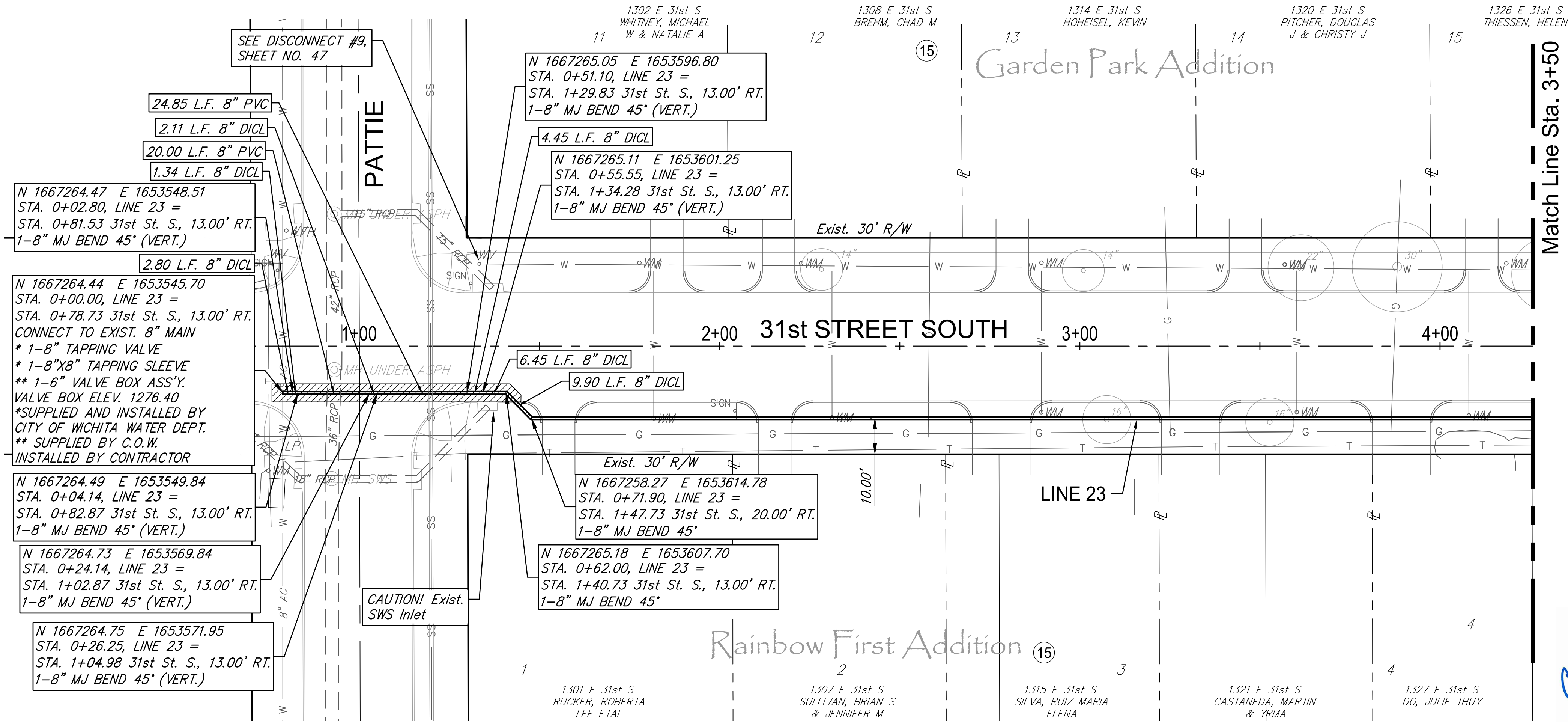
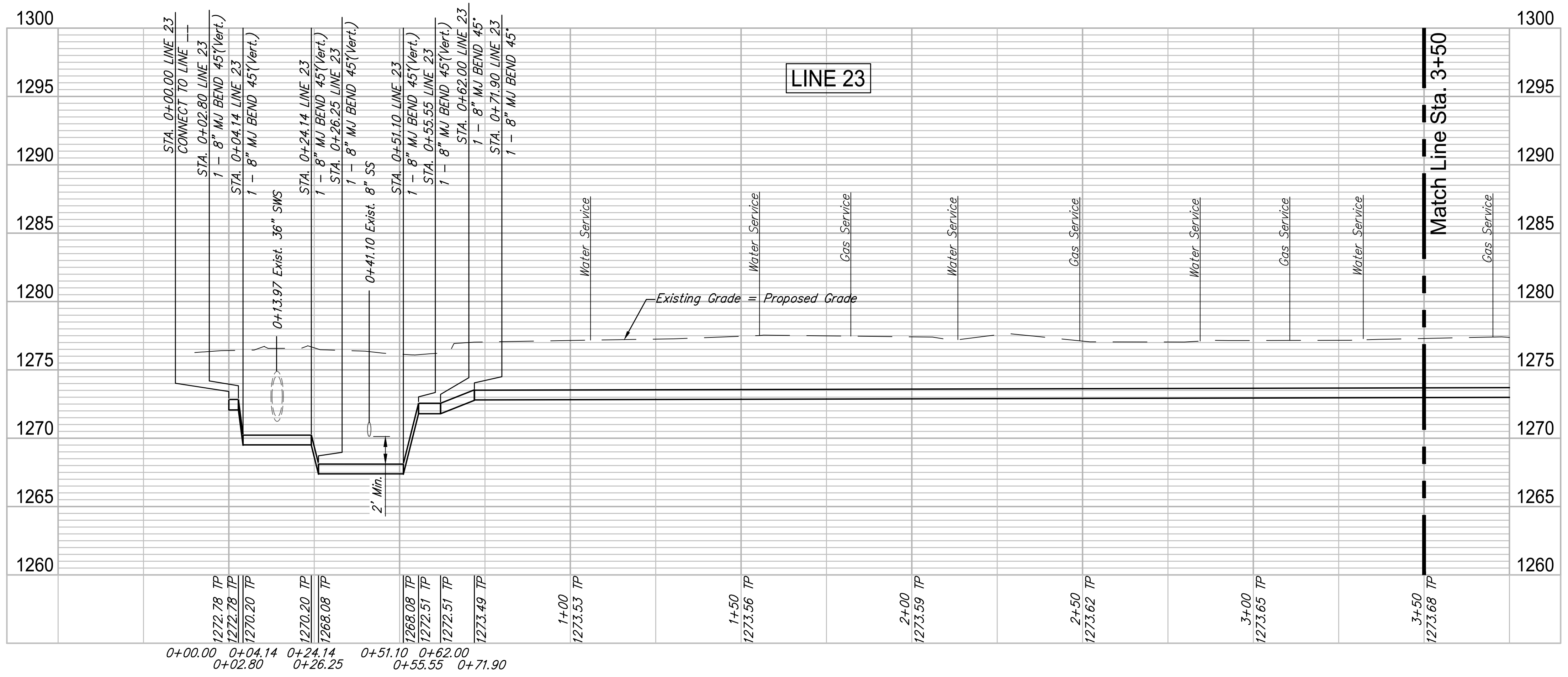

REVIEW: 5-24-2017 DATE: 4/2/2018

DESIGN: CMB / RA DRAWN: DRS / RA

PROJECT NUMBER: 448-30721 DRAWING FILE: LINE 23 - 31st St. S

ROSE MARIE WATER - Part B
31st Street S. - Line 23 (1 of 2)
Wichita, Kansas

GARVER
16284701
17 OF 53

© Copyright 2018, Garver