

SEE DISCONNECT #10, SHEET NO. 47

N 1667266.11 E 1654269.58
 STA. 7+26.74, LINE 23 =
 STA. 8+02.57 31st St. S., 20.00' RT.
 CONNECT TO EXIST. 8" MAIN
 * 1-8" TAPPING VALVE
 * 1-8"X8" TAPPING SLEEVE
 ** 1-6" VALVE BOX ASS'Y.
 VALVE BOX ELEV. 1277.40
 * SUPPLIED AND INSTALLED BY
 CITY OF WICHITA WATER DEPT.
 ** SUPPLIED BY C.O.W.
 INSTALLED BY CONTRACTOR

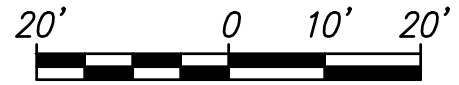

Existing Pavement, Curb and Gutter to be Removed and Replaced as necessary for construction. No additional pay shall be made for this work, Subsidiary to other pay items.

WATER METER SUMMARY				
BL Station	Lt./Rt.	Service (Long or Short)	Address	As Built
4+68	Rt.	Short	1333 E. 31ST	
4+84	Lt.	Long	1402 E. 31ST	
5+35	Rt.	Short	1401 E. 31ST	
5+48	Lt.	Long	1408 E. 31ST	
5+95	Rt.	Short	1407 E. 31ST	
6+13	Lt.	Long	1414 E. 31ST	

WATER METER SUMMARY				
BL Station	Lt./Rt.	Service (Long or Short)	Address	As Built
6+54	Rt.	Short	1411 E. 31ST	
6+78	Lt.	Long	1420 E. 31ST	
7+16	Rt.	Short	1415 E. 31ST	
7+46	Lt.	Long	1426 E. 31ST	
7+74	Rt.	Short	1421 E. 31ST	

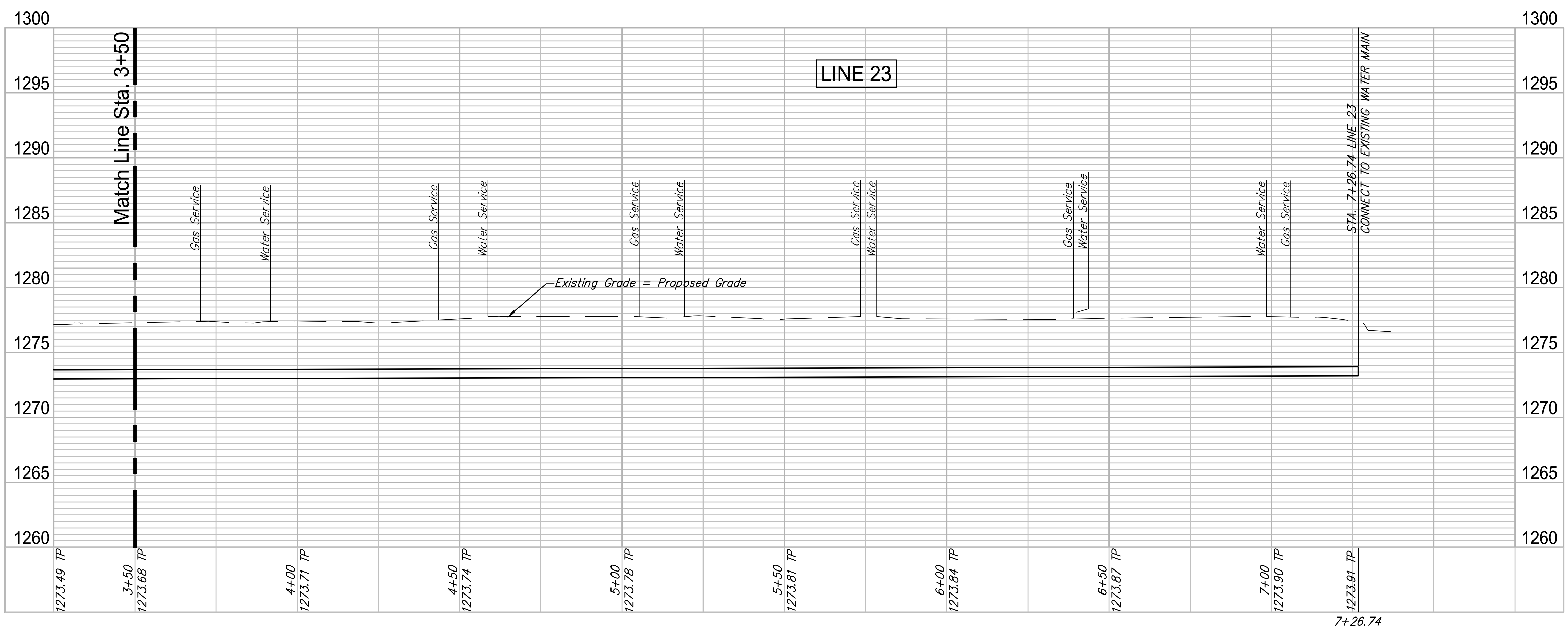

7+26.74

PROJECT NUMBER: 448-30721
 DESIGN: CMB / RA
 DRAWING FILE: LINE 23 - 31st St. S.
 REVIEW: 5-24-2017
 DATE: 4/20/18
 DESIGNER: DRS / RA
ROSE MARIE WATER - Part B
31st Street S. - Line 23 (2 of 2)
 Wichita, Kansas
 SHEET: 18 OF 53
 © Copyright 2018, Garver

F:\Projects\Projects 4700-4799\4701W (Rose Marie waterline replacement)\LINE 23 - 31st St. S.dwg