

**GREENWOOD N. of LUTHER
DISCONNECT #1**

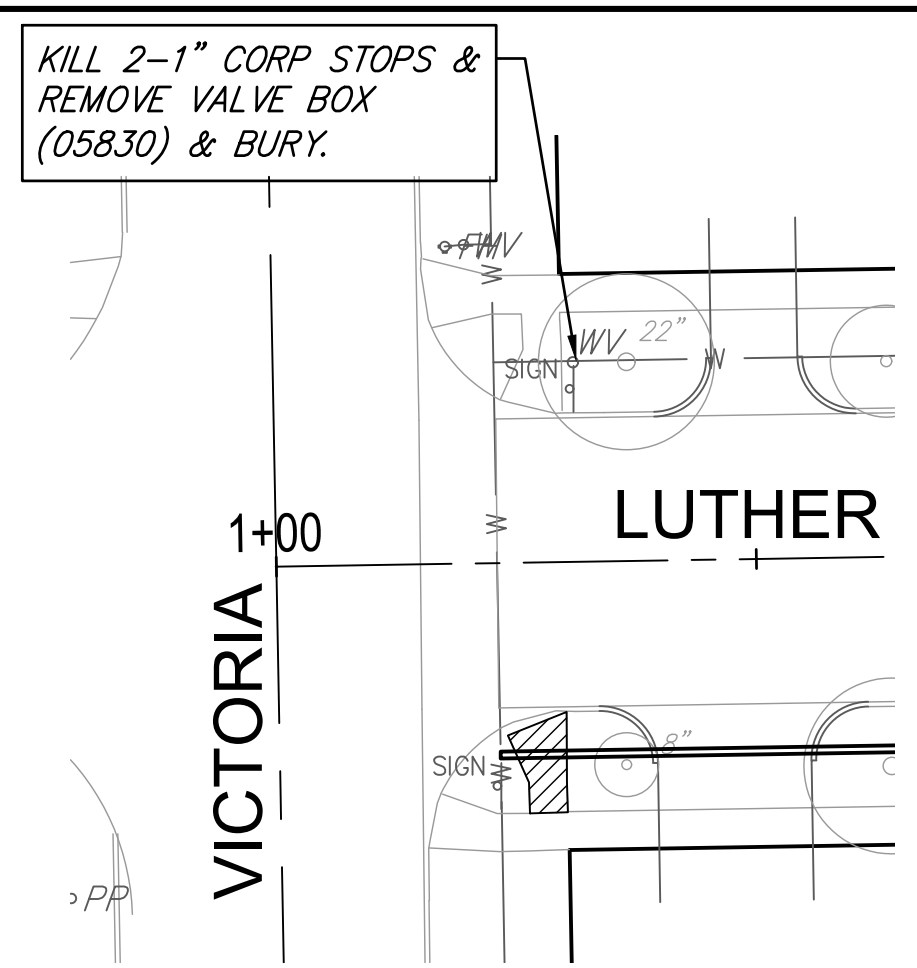

**LUTHER & VICTORIA
DISCONNECT #2**

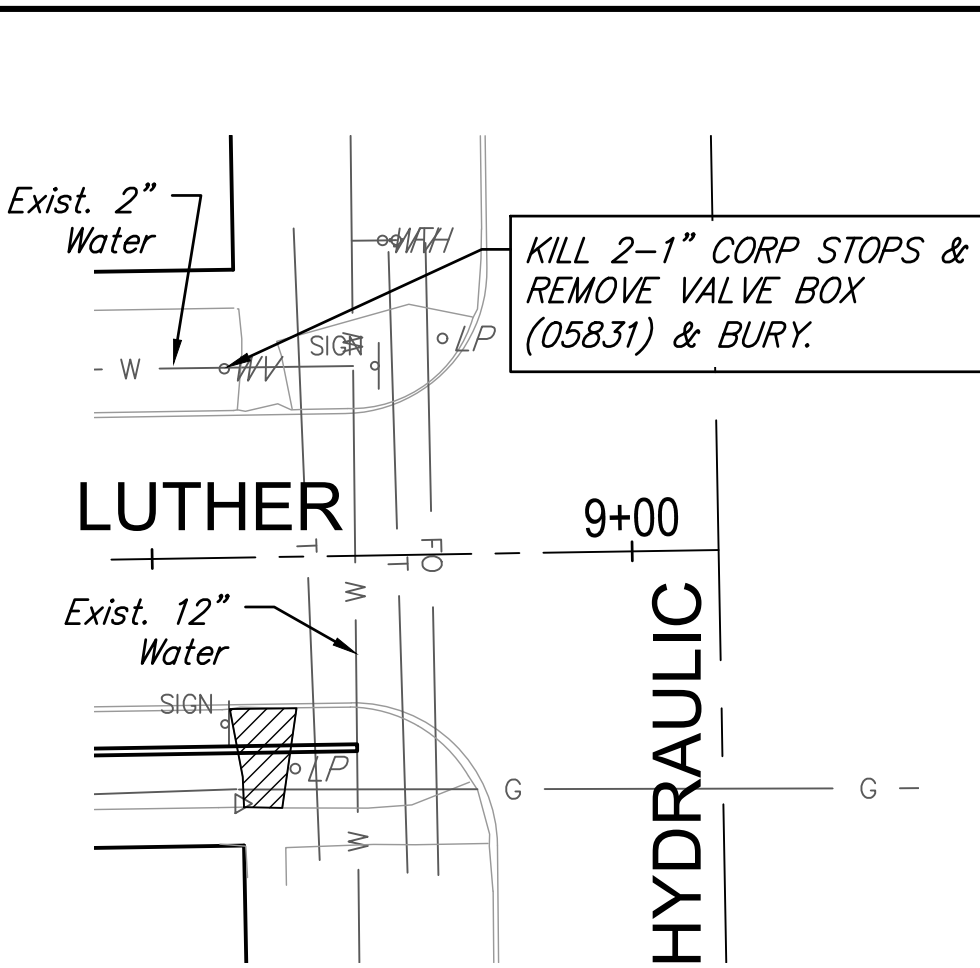

**LUTHER & VICTORIA
DISCONNECT #3**

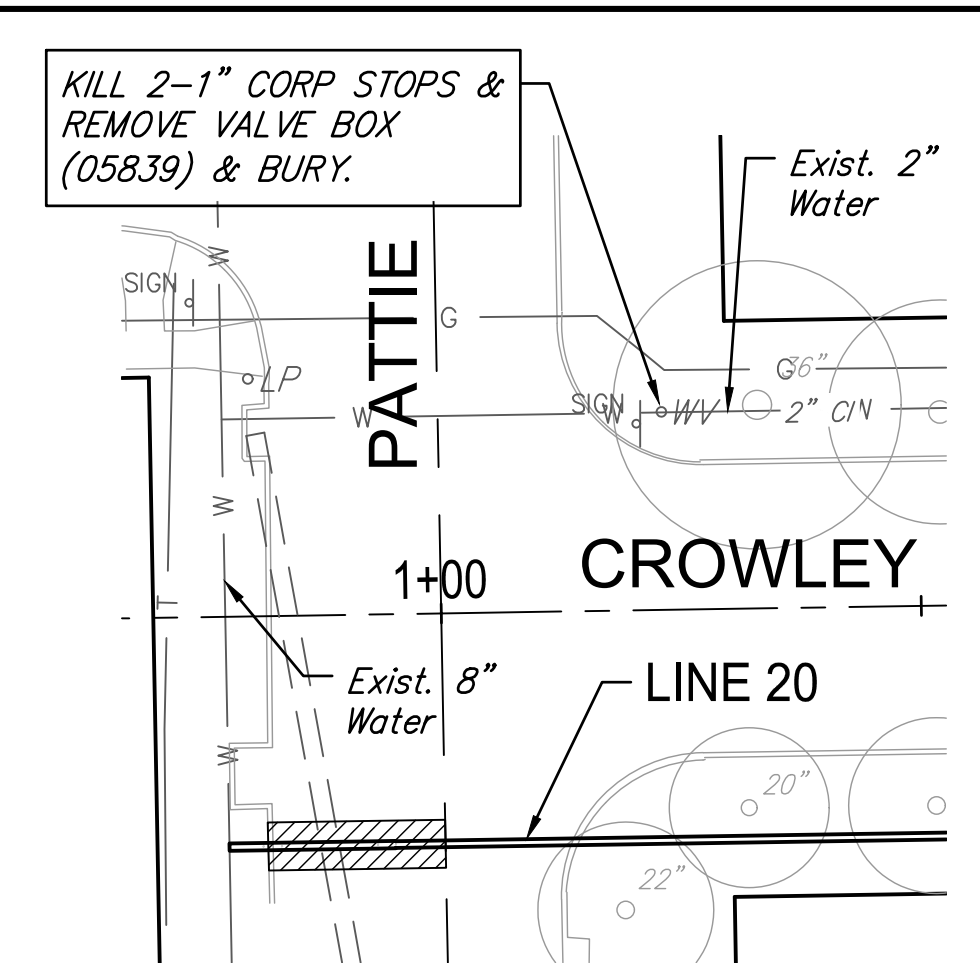

**CROWLEY & PATTIE
DISCONNECT #4**

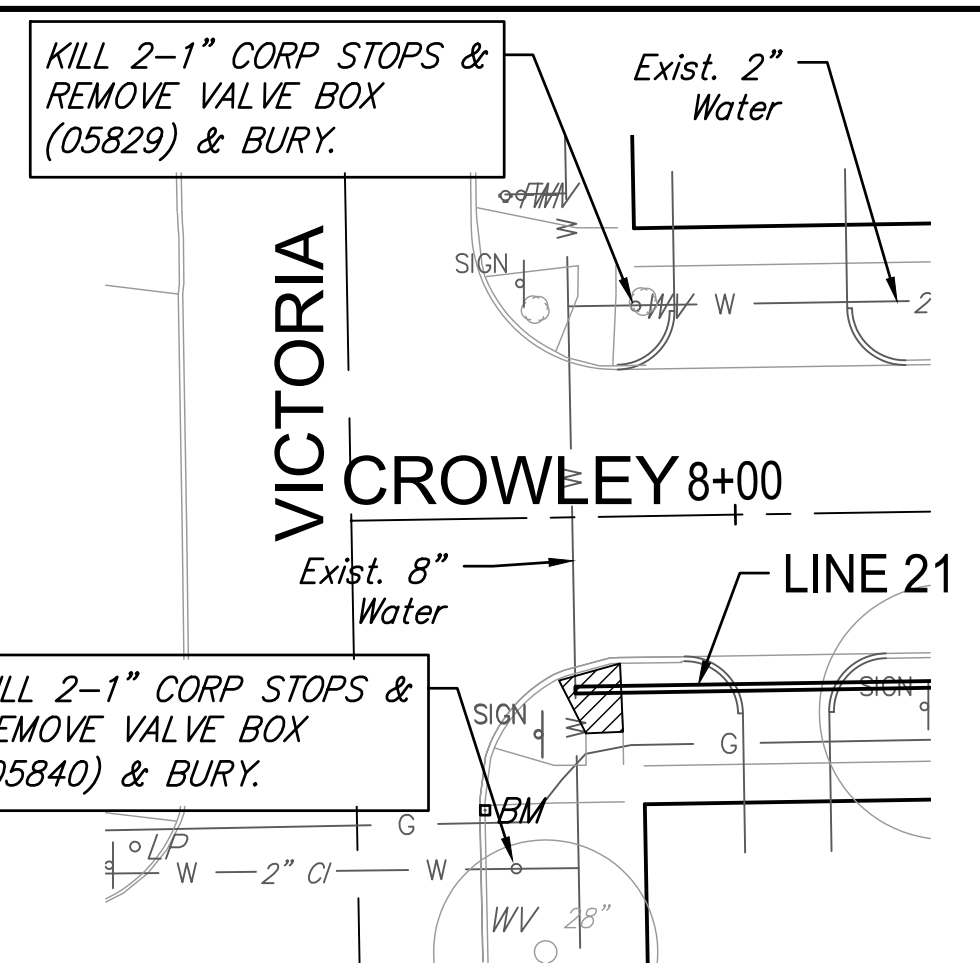

**CROWLEY & VICTORIA
DISCONNECT #5**

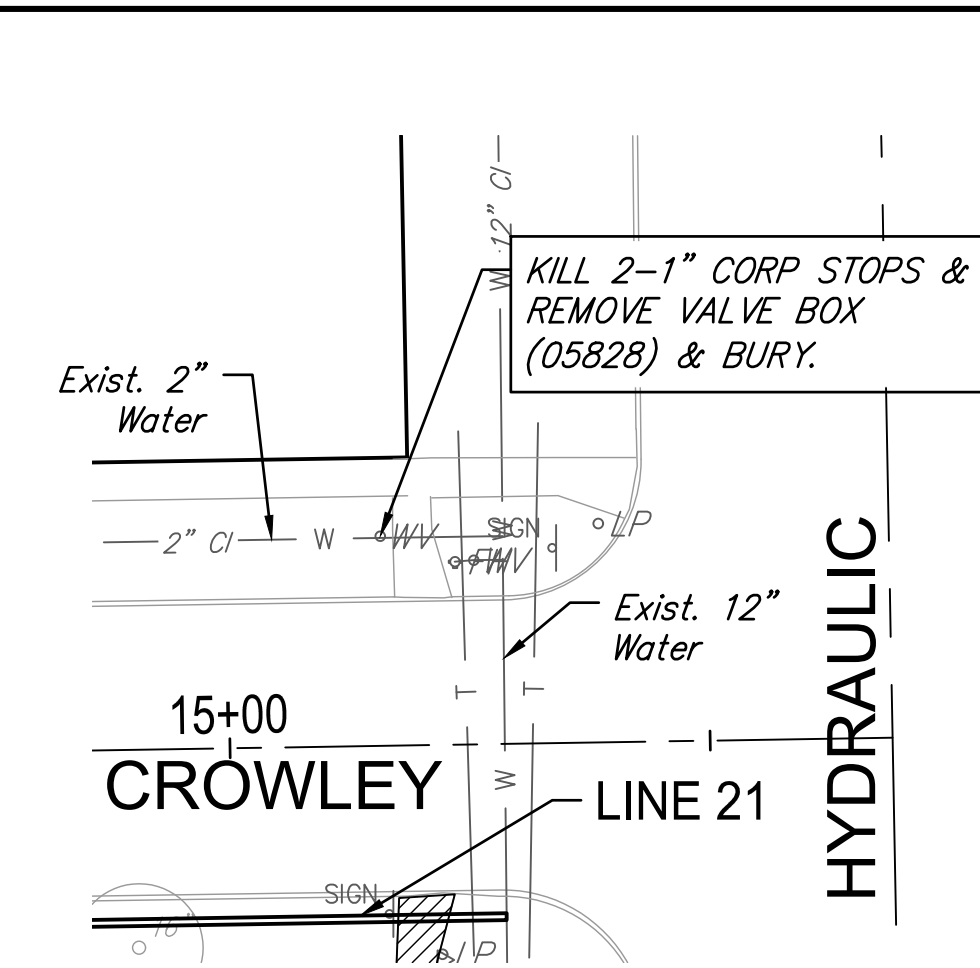

**CROWLEY & HYDRAULIC
DISCONNECT #6**

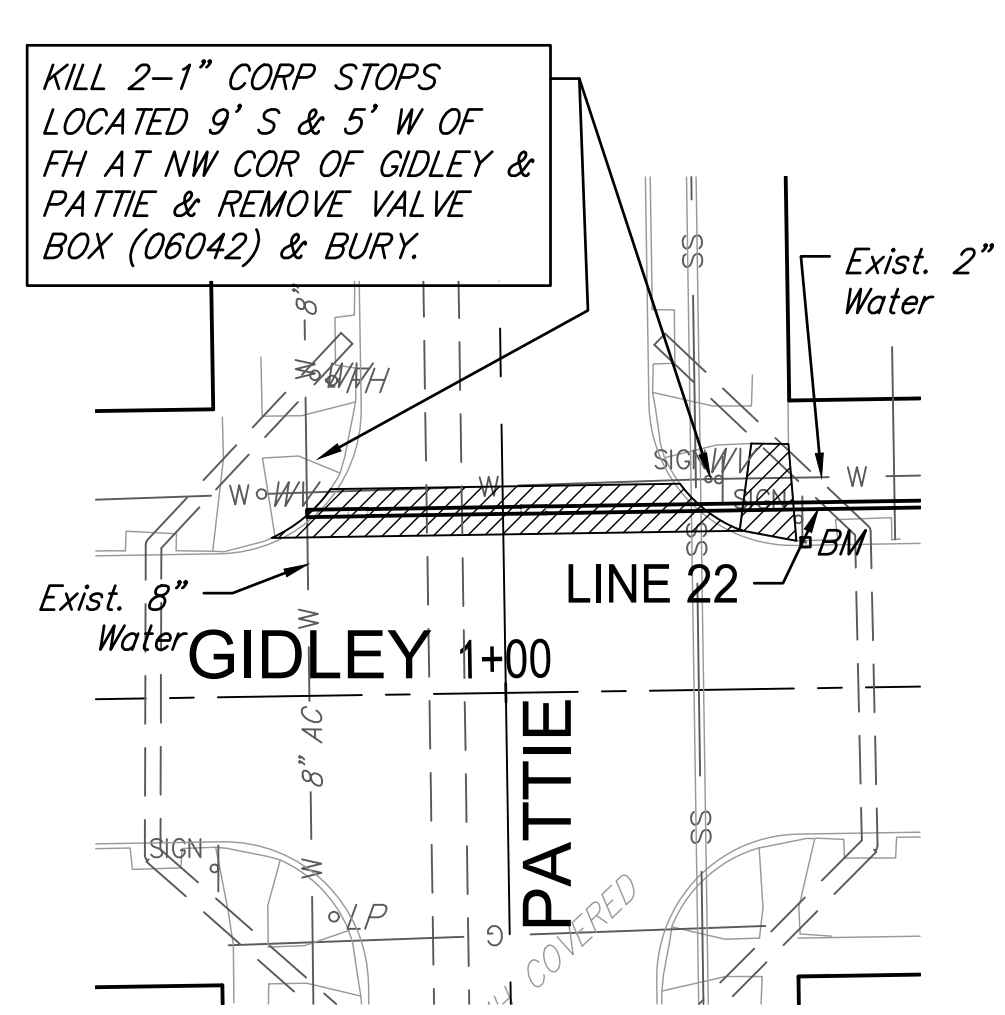

**GIDLEY & PATTIE
DISCONNECT #7**

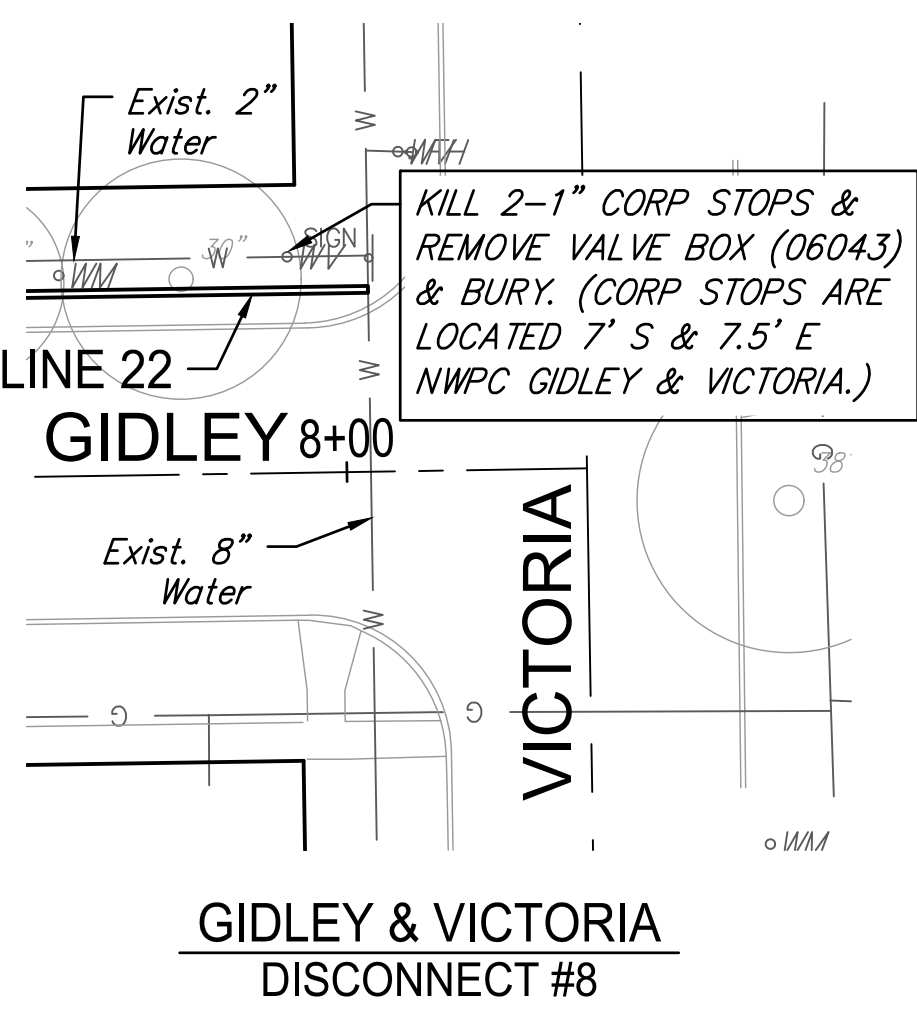

**GIDLEY & VICTORIA
DISCONNECT #8**

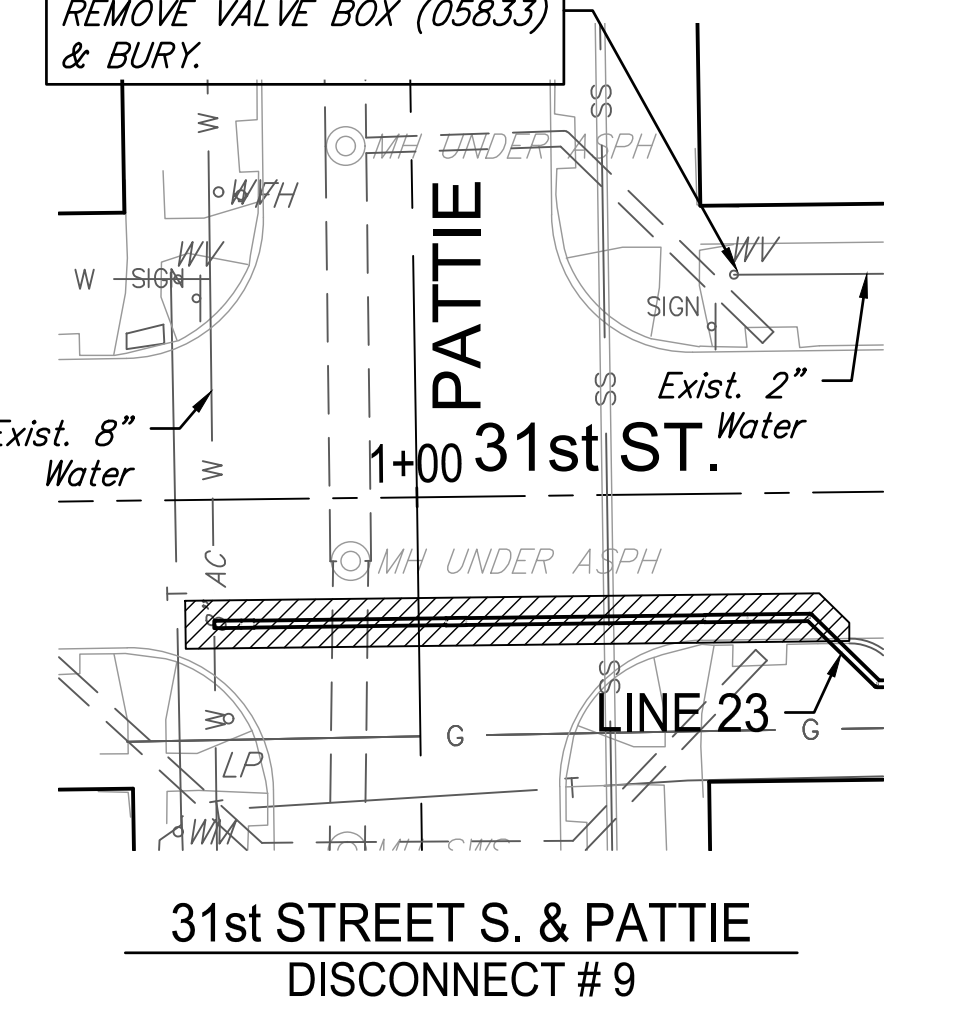

**31st STREET S. & PATTIE
DISCONNECT #9**

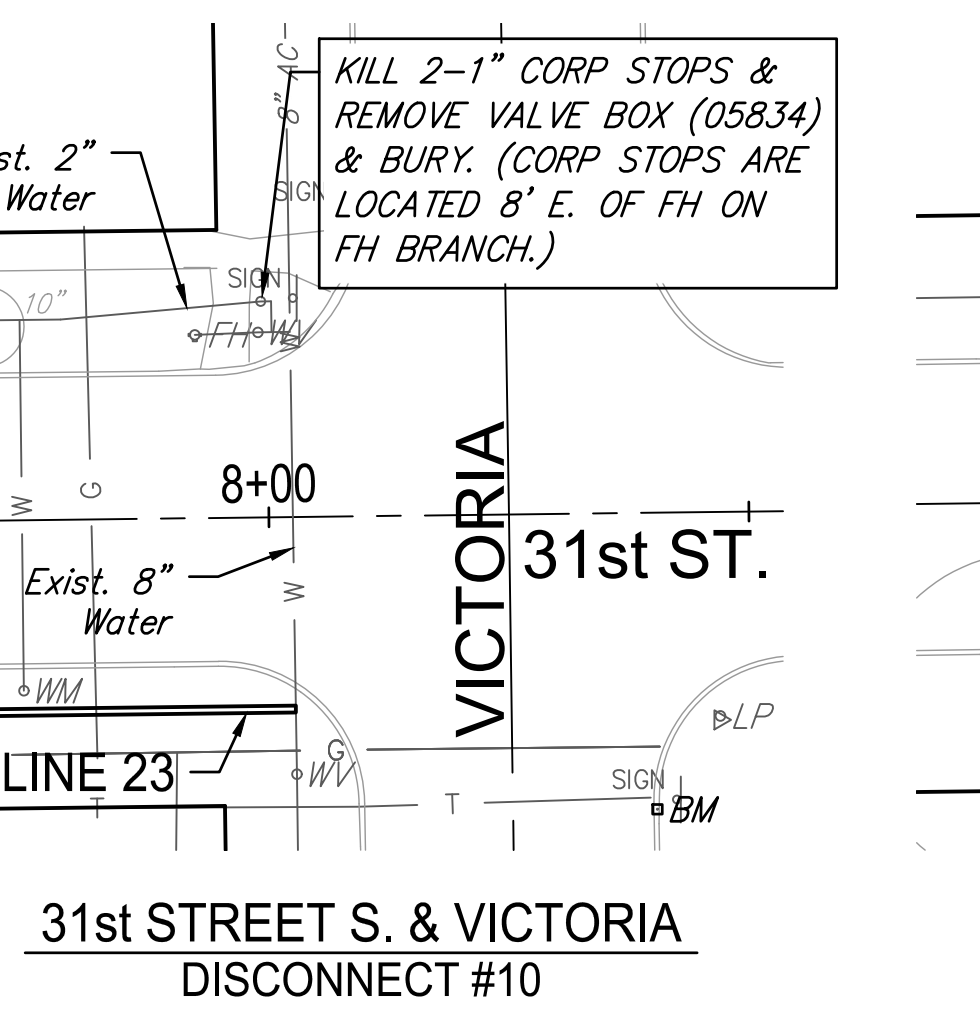

**31st STREET S. & VICTORIA
DISCONNECT #10**

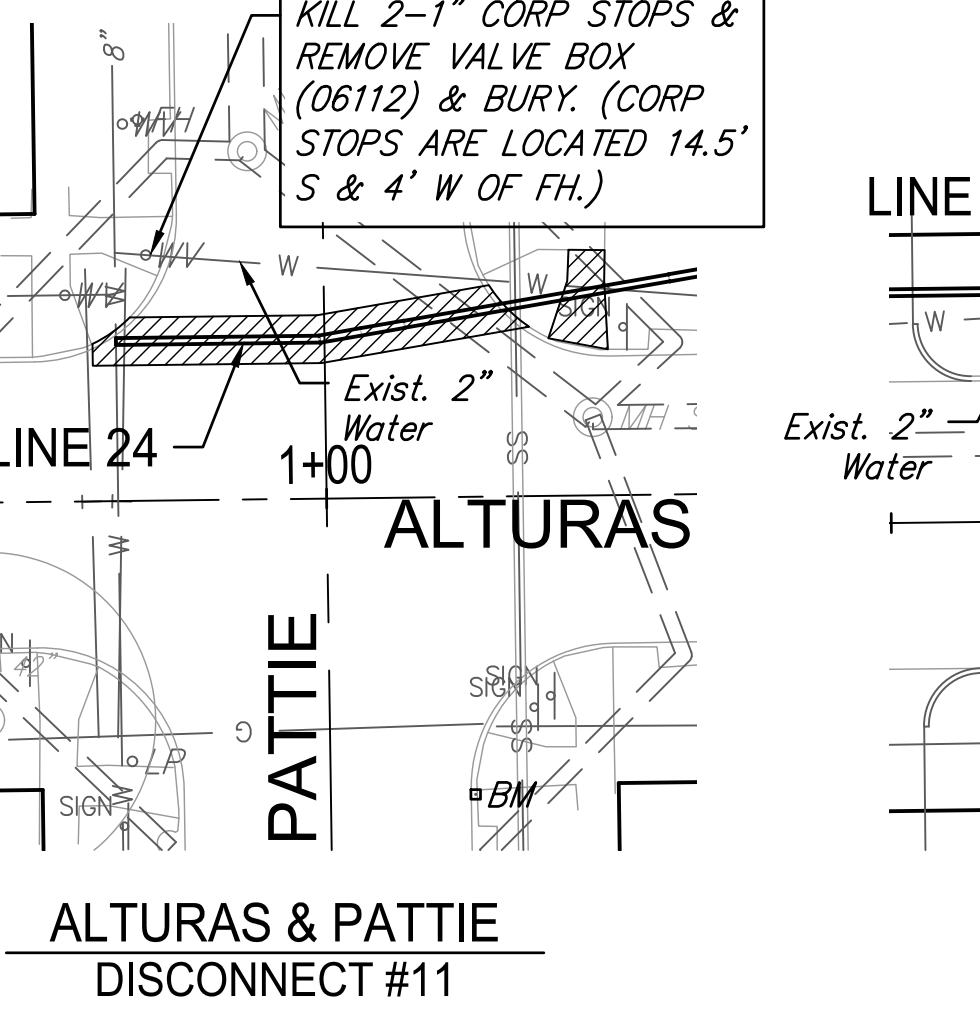

**ALTURAS & PATTIE
DISCONNECT #11**

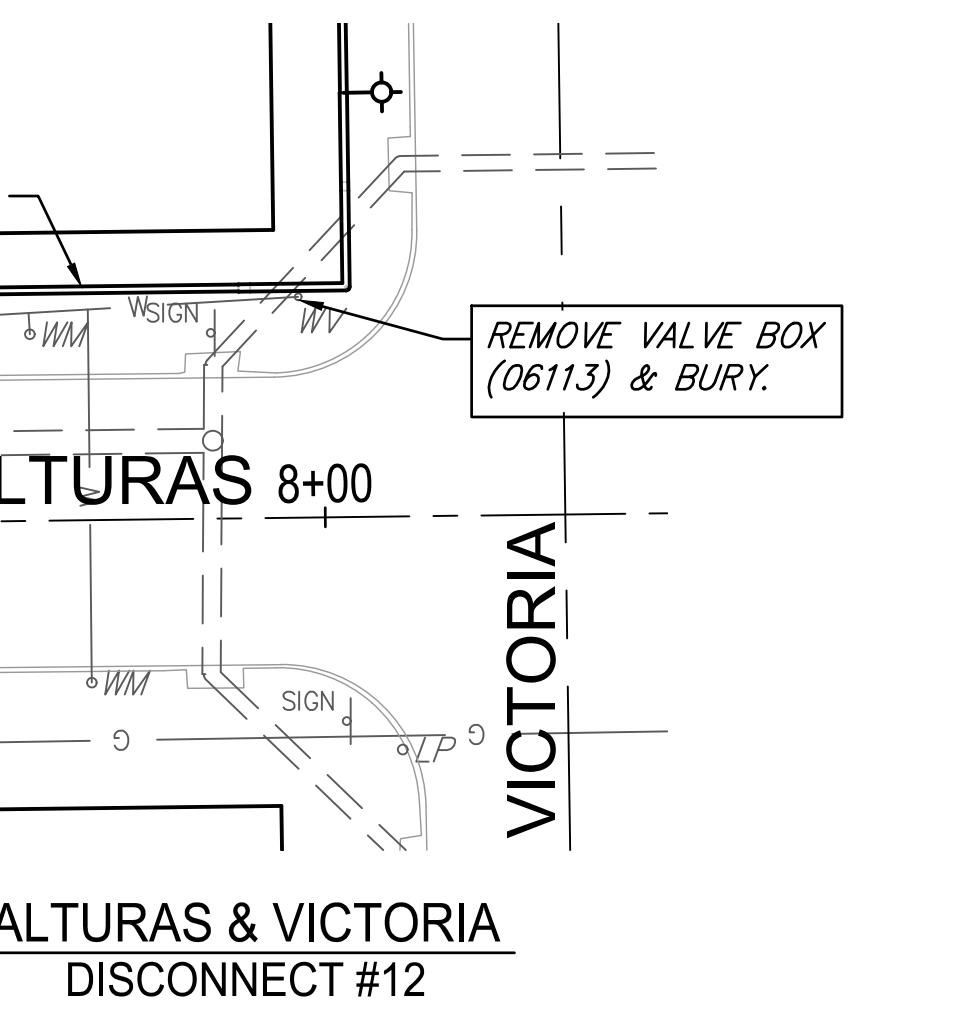

**ALTURAS & VICTORIA
DISCONNECT #12**

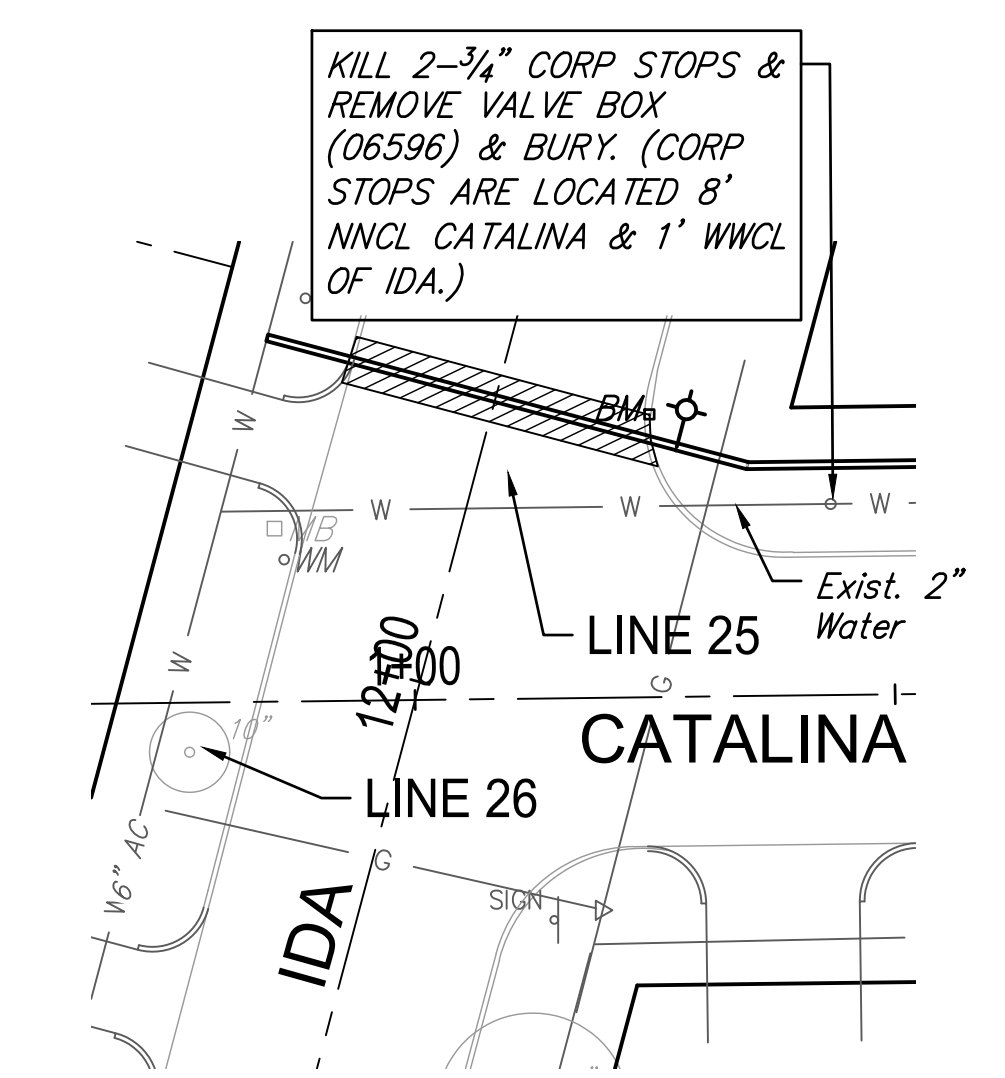

**CATALINA & IDA
DISCONNECT #13**

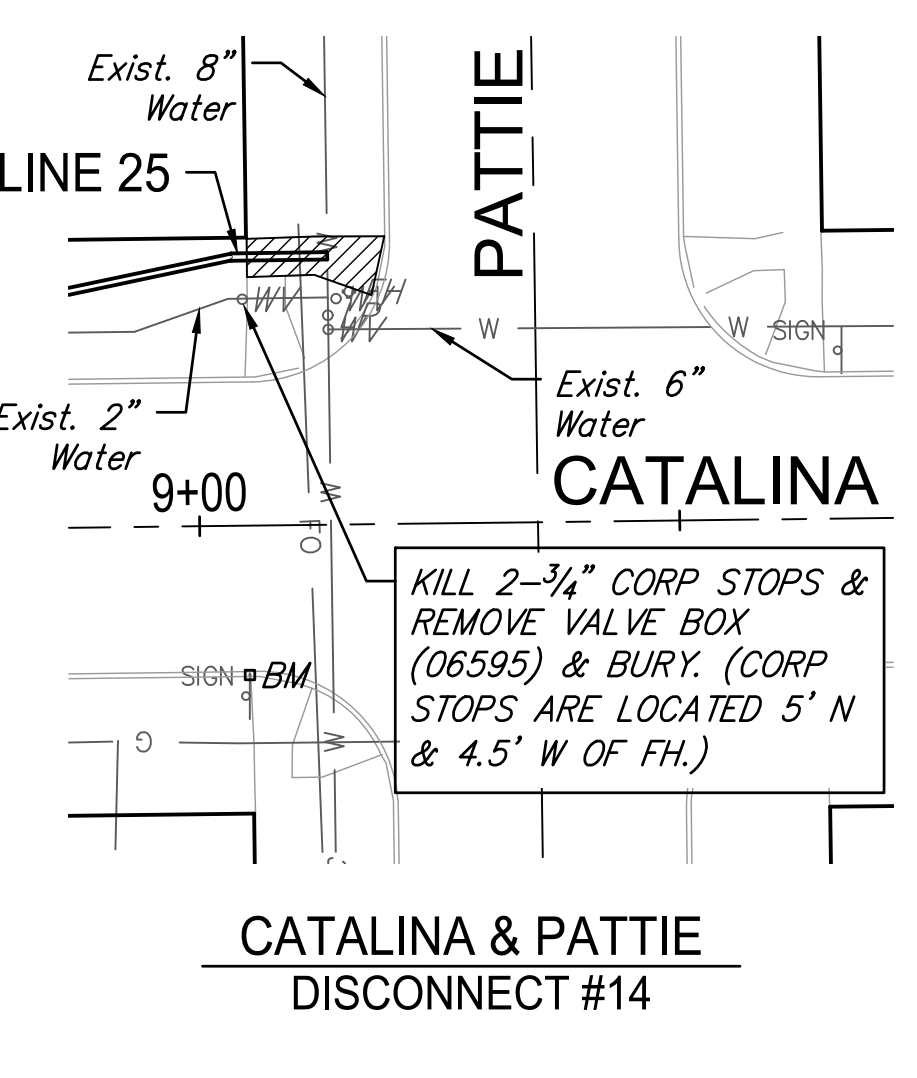

**CATALINA & PATTIE
DISCONNECT #14**

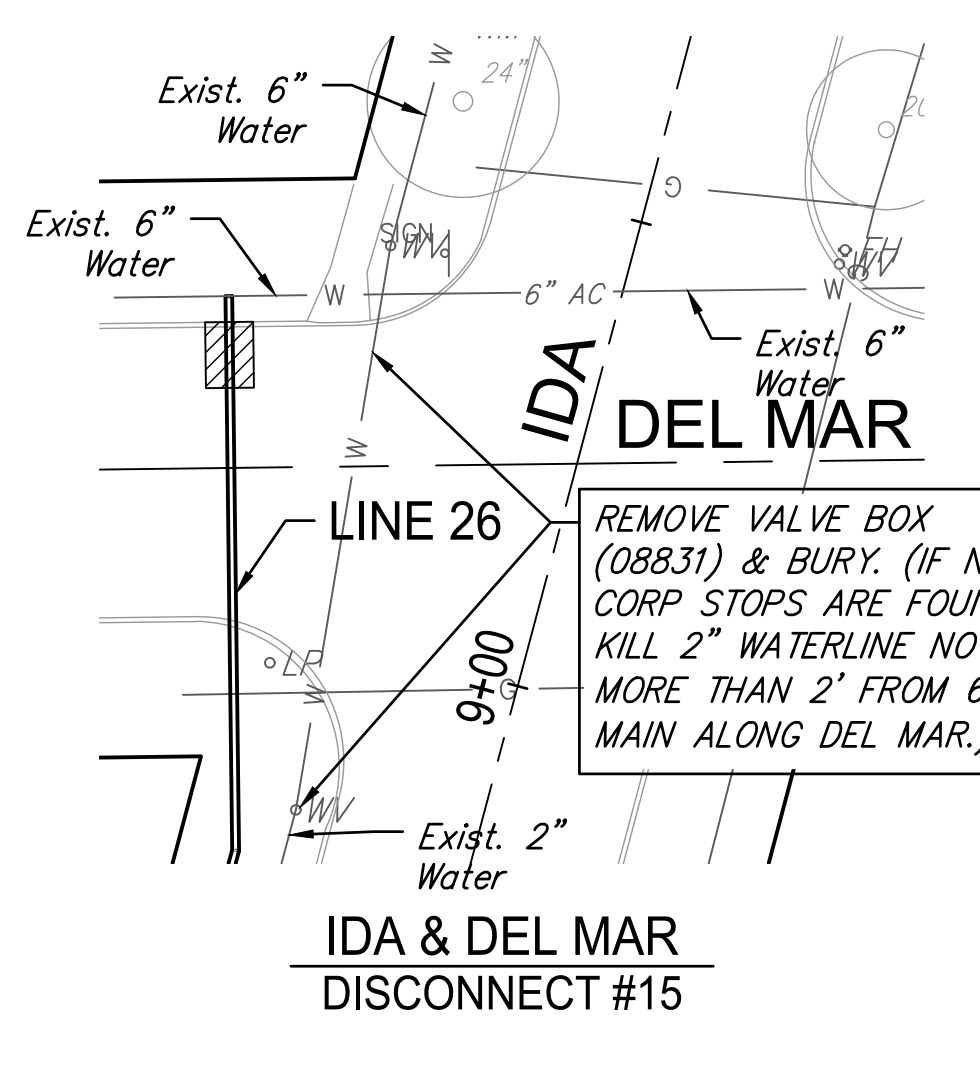

**IDA & DEL MAR
DISCONNECT #15**

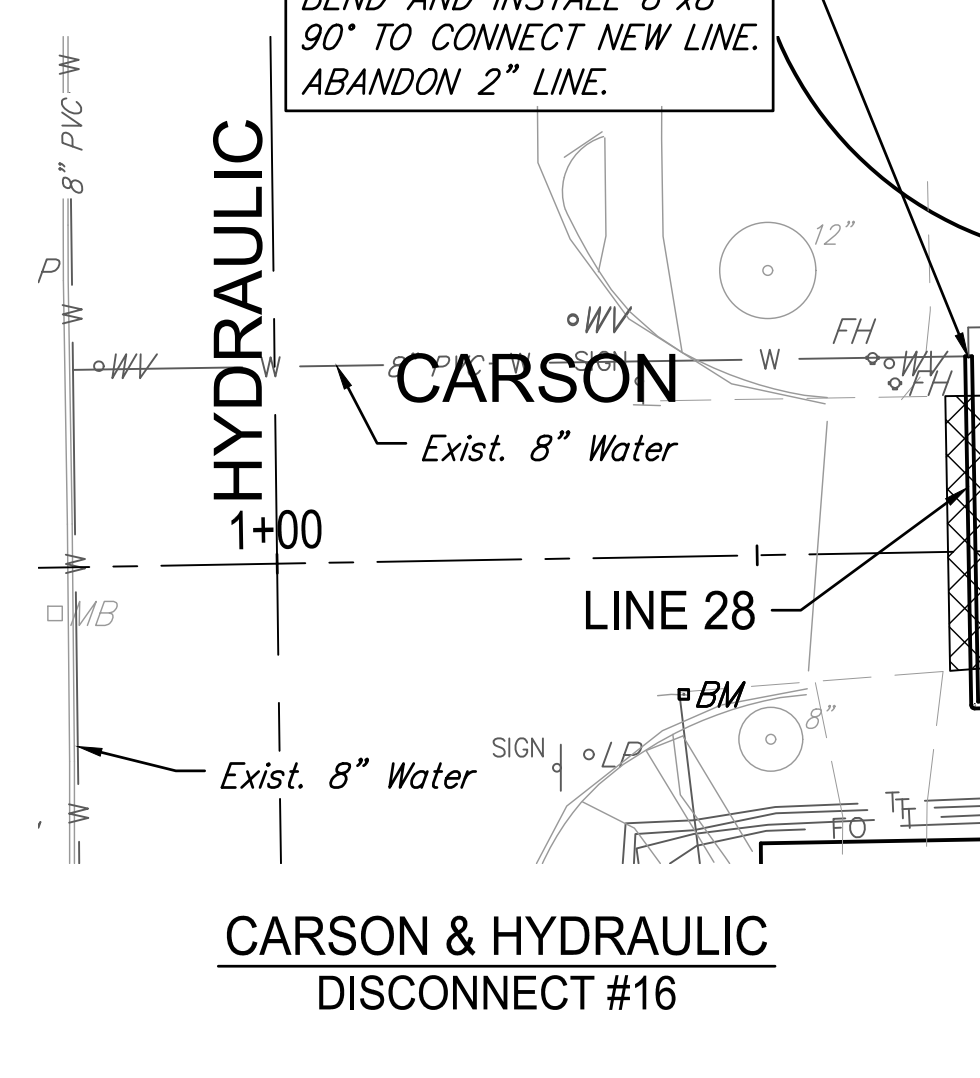

**CARSON & HYDRAULIC
DISCONNECT #16**

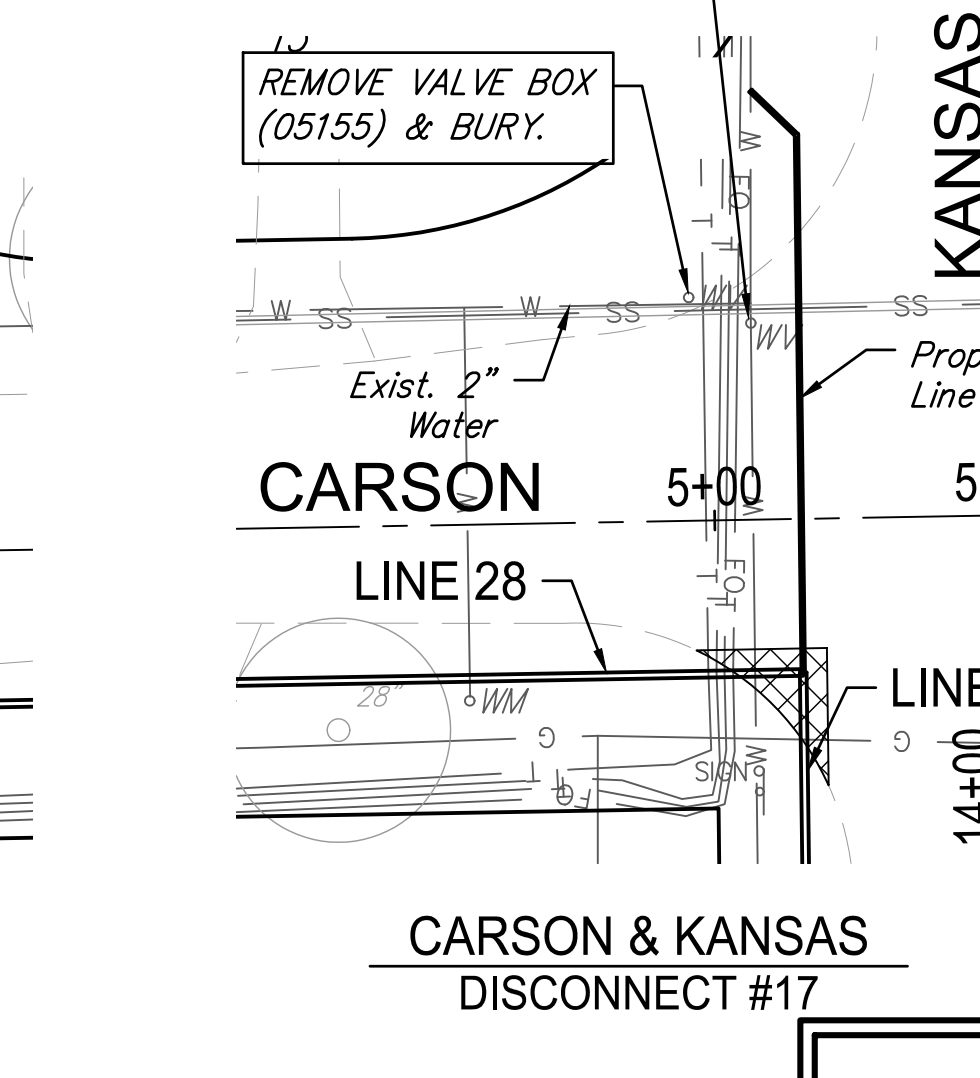

**CARSON & KANSAS
DISCONNECT #17**

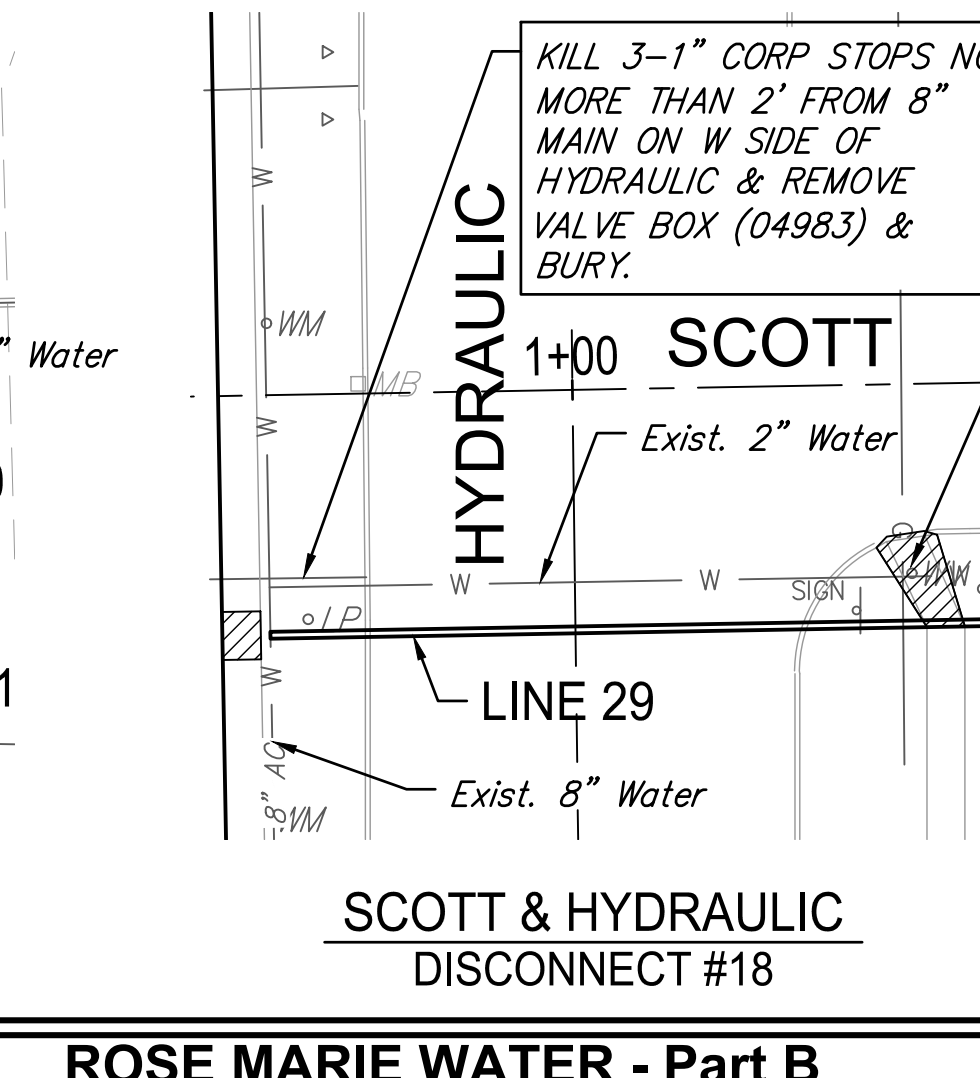

**SCOTT & HYDRAULIC
DISCONNECT #18**

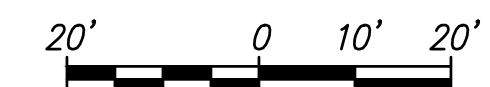

Existing Pavement, Curb and Gutter to be Removed and Replaced as necessary for construction. No additional pay shall be made for this work, *Subsidiary* to other pay items.

ROSE MARIE WATER - Part B
Part B Water Line Disconnects 1

	GARVER 924 N. MAIN WICHITA, KS 67203 316-264-8008 WWW.GARVERUSA.COM	DATE 4/2/2018 DESIGN CMB / RA DRAWN DRS / RA REVIEW 5-24-2017 SHEET
	PROJECT NUMBER 448-90721	GARVER JOB NO. 16264701
DRAWING FILE 4701W Disconnects Part B [Part B Water Line Disconnects 1]		OF 53

F:\Projects\Projects 4700-4799\4701W (Rose Marie waterline replacement)\4701W Disconnects Part B.dwg