

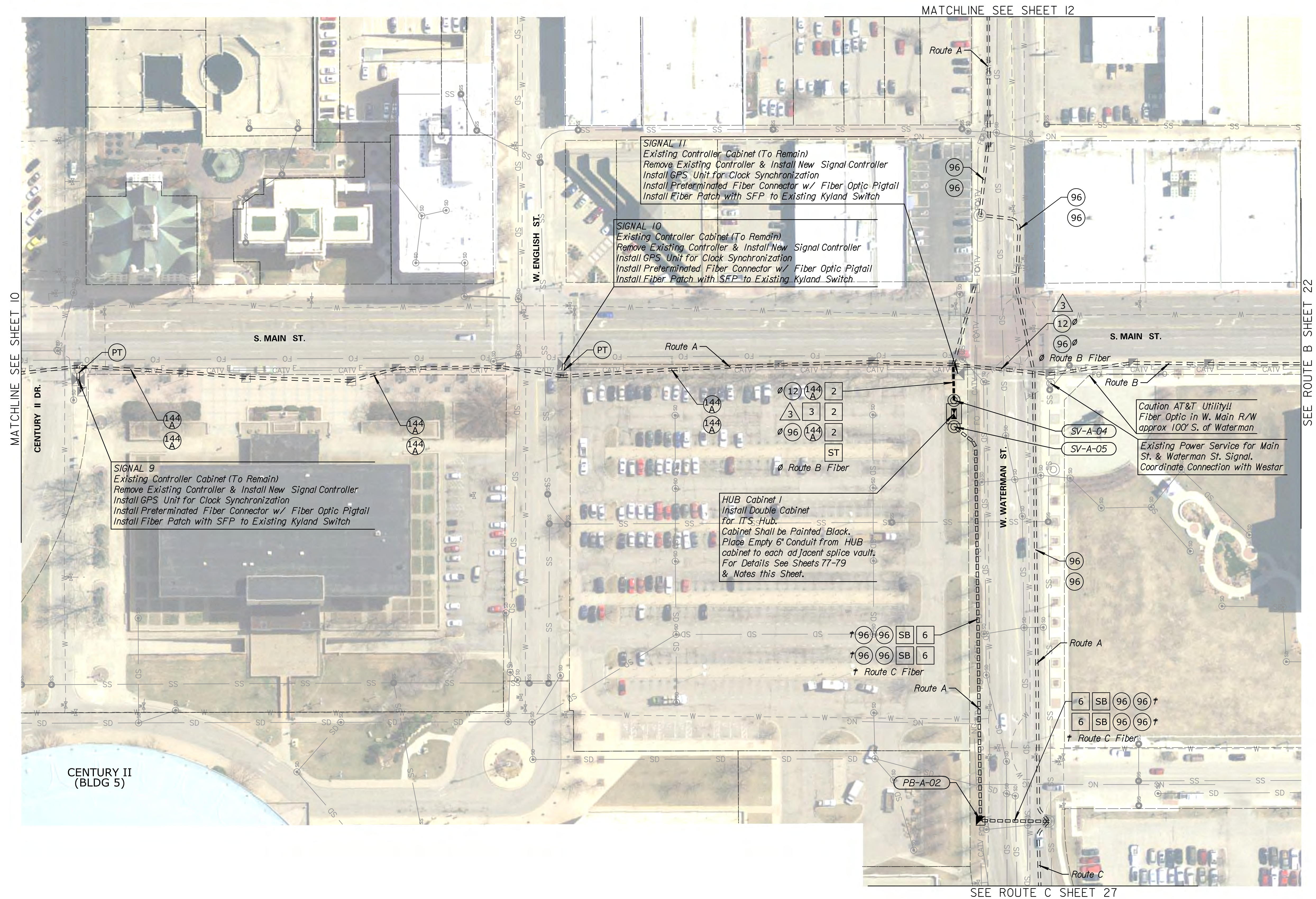

STATE	PROJECT NO.	YEAR	SHEET NO.	TOTAL SHEETS
KANSAS	87 N-0684-01	2019	II	109

DATE	BY

Drawn By : Road  
 File : c:\transystems\pw\_local\transcorp-pw\ccbank\id0643930\C-FBR-M0A-104.dgn  
 Plotted : 7/23/2019



**NOTES:**  
 DEVICE & CONDUIT SYMBOLOGY ON PLAN SHEET IS NOT SHOWN TO SCALE FOR PLAN CLARITY. DO NOT SCALE LOCATIONS FROM PLAN SHEET. EXISTING UTILITIES & STRUCTURES ON PLAN SHEET MAY DIFFER FROM FIELD CONDITIONS & SHALL BE VERIFIED PRIOR TO ANY EXCAVATION OR CONSTRUCTION ACTIVITIES.

FOR FIBER SCHEMATIC & SPLICING DETAILS, SEE SHEETS 52-64

ITS HUB CABINET 1 SHALL BE PAINTED BLACK.

AN EMPTY 6" CONDUIT SHALL BE PLACED BETWEEN HUB CABINET AND ADJACENT SPLICE VAULTS. CONDUIT MAY BE EITHER PVC OR HDPE, BUT SHALL BE PLUGGED AT EITHER END & EQUIPPED WITH PULL STRING. CONDUIT IS SUBSIDIARY TO THE HUB CABINET.

KANSAS DEPARTMENT OF TRANSPORTATION  
 FIBER OPTIC CONDUIT  
 ROUTE A