

BENCHMARKS:
 Benchmark Disk in top of curb north end of east curb return, adj. to the northwest cor., Lot 1, Block C, Sandcrest 4th Addn.
 Elev. = 1338.02 NAVD88

"□" cut in top of curb adj. to the southwest corner of Lot 42, Block B, Sandcrest 4th Addn.
 Elev. = 1327.78 NAVD88

"□" cut in face of curb inlet, east side of Anna St, between Lot 3 & Lot 4, Block C, Sandcrest 4th Addn.
 Elev. = 1327.09 NAVD88

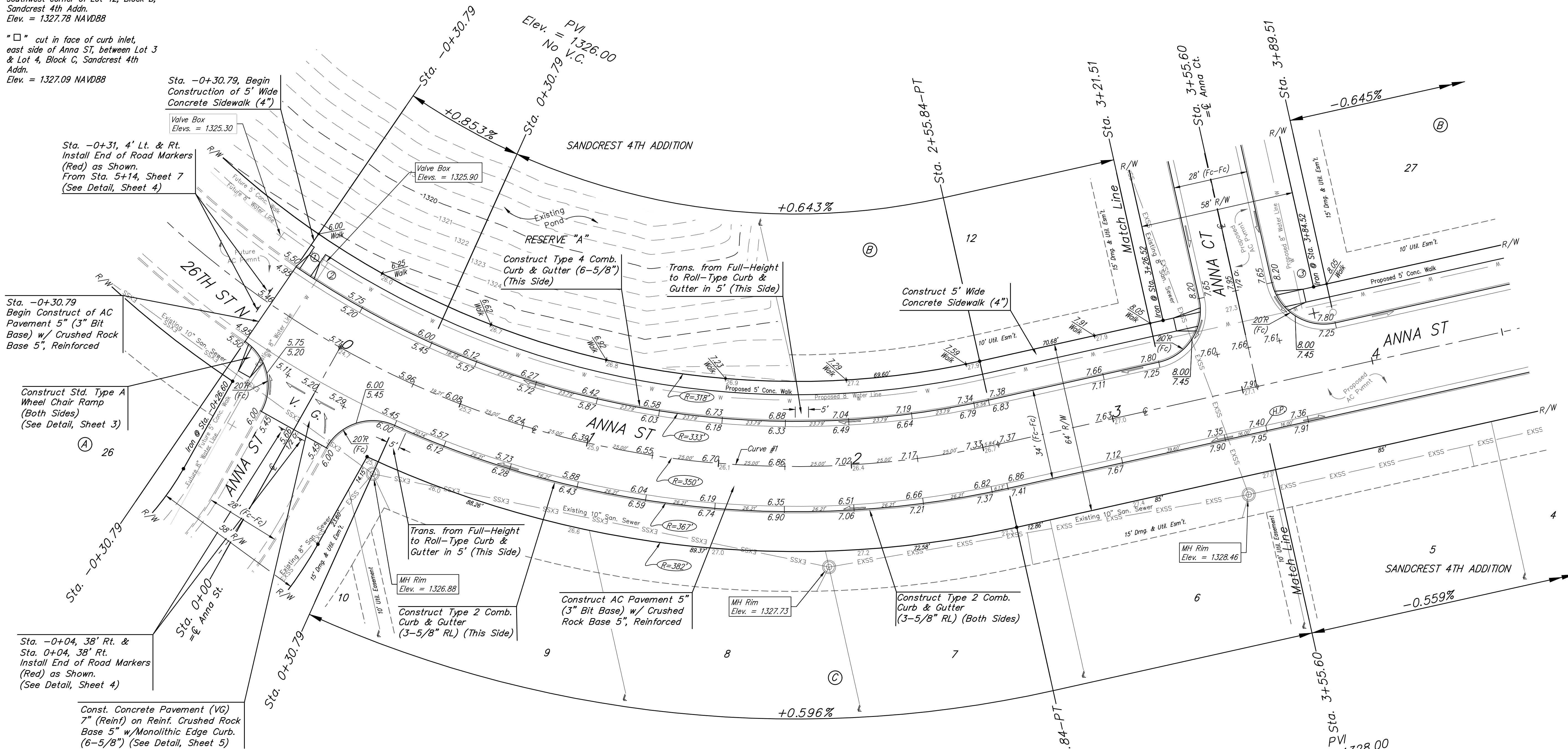
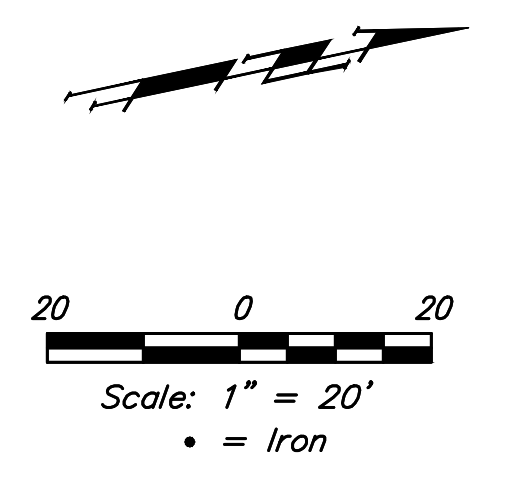

Sta. -0+30.79, Begin Construction of 5' Wide Concrete Sidewalk (4")

Valve Box Elev. = 1325.30

Sta. -0+31, 4' Lt. & Rt. Install End of Road Markers (Red) as Shown. From Sta. 5+14, Sheet 7 (See Detail, Sheet 4)

Sta. -0+30.79 Begin Construct of AC Pavement 5" (3" Bit Base) w/ Crushed Rock Base 5", Reinforced

Construct Std. Type A Wheel Chair Ramp (Both Sides) (See Detail, Sheet 3)

Sta. -0+04, 38' Rt. & Sta. 0+04, 38' Rt. Install End of Road Markers (Red) as Shown. (See Detail, Sheet 4)

Const. Concrete Pavement (VG) 7" (Reinf) on Reinf. Crushed Rock Base 5" w/Monolithic Edge Curb. (6-5/8") (See Detail, Sheet 5)

26

27

28

29

30

31

32

33

34

35

36

37

38

39

40

41

42

43

44

VALVE LOCATION TABLE

VALVE NUMBER	STREET	BASILINE STATION	OFFSET DISTANCE	OFFSET DIRECTION
1	Anna	-0+23.26	25'	Lt.
2	Anna	-0+21.14	23'	Lt.
3	Anna	3+78.51	36'	Lt.
4	Anna	5+16.05	26.4'	Lt.

Curve #1
 Curve Data Based on Centerline
 Rad. = 350' Delta = 46°55'20" Tangent = 151.90'
 Arc = 286.63' L.C. = 278.69' Def./Ft. = 4.91109 Min.

Station	Face Chord Lengths			Defl.	Total Defl.
	8' Left	8' Right	8' Right		
-0+30.79	-	-	-	0°00'00"	0°00'00"
-0+25.00	5.79'	5.38'	6.20'	0°28'26"	0°28'26"
0+00.00	25.00'	23.21'	26.78'	2°02'47"	2°31'13"
0+25.00	25.00'	23.21'	26.78'	2°02'46"	4°33'59"
0+30.79	5.79'	5.38'	6.20'	0°28'27"	5°02'26"
0+50.00	19.21'	17.84'	20.58'	1°34'20"	6°36'46"
0+75.00	25.00'	23.21'	26.78'	2°02'47"	8°39'33"
1+00.00	25.00'	23.21'	26.78'	2°02'46"	10°42'19"
1+25.00	25.00'	23.21'	26.78'	2°02'47"	12°45'06"
1+50.00	25.00'	23.21'	26.78'	2°02'47"	14°47'53"
1+75.00	25.00'	23.21'	26.78'	2°02'46"	16°50'39"
2+00.00	25.00'	23.21'	26.78'	2°02'47"	18°53'26"
2+25.00	25.00'	23.21'	26.78'	2°02'47"	20°56'13"
2+50.00	25.00'	23.21'	26.78'	2°02'46"	22°58'59"
2+55.84	5.84'	5.42'	6.26'	0°28'41"	23°27'40"

Sta. 3+55.60
 PVI Elev. = 1328.00
 32.00' V.C.

Roll type curb & gutter to be constructed on the pavement on this sheet. Top of curb elevation are given for full height curb.

	Sandcrest 4th Addition - Phase III	
	ANNA ST	
Sta. -0+30.79 to Sta. 3+55.60		
Baughman Company, P.A. 315 Ellis St. Wichita, KS 67211 P 316-262-7271 F 316-262-0149		
ENGINEERING SURVEYING PLANNING LANDSCAPE ARCHITECTURE		
PROJECT NUMBER 472-85458	DESIGN AEG	DRAWN JAK
REVISIONS:	APPROVED	DATE 11/08/19
	SCALE Noted	SHEET 6 OF 20