

* PRIOR TO BEGINNING CONSTRUCTION, THE CONTRACTOR SHALL EXCAVATE THE EXISTING 8" WATERLINE AT STATION 0+00.00 TO VERIFY PIPE SIZE, TYPE, FITTINGS, AND HORIZONTAL AND VERTICAL LOCATION. THE CONTRACTOR SHALL REPORT HIS FINDINGS TO THE ENGINEER SO THAT ANY NECESSARY PLAN MODIFICATIONS CAN BE MADE. ANY ADDITIONAL LABOR OR MATERIALS NECESSARY TO COMPLETE THE CONNECTION SHALL BE CONSIDERED SUBSIDIARY TO THE PROJECT.

N: 26919.8577, E: 15249.8790
 WL 1, Sta. 0+00.00=
 Judith, Sta. 112+80.98, 23' L
 Existing 8" Plug *
 Remove 8" Plug from existing 8"
 Pipe and begin new water main
 installation.

N: 26591.6333, E: 15246.8996
 WL 1, Sta. 3+28.24=
 Judith, Sta. 109+52.74, 23' L
 1- Fire Hydrant Assembly
 L= 4'
 Top Valve Box El.= 1363.70
 FH Bury Line El.= 1363.65
 Match Point

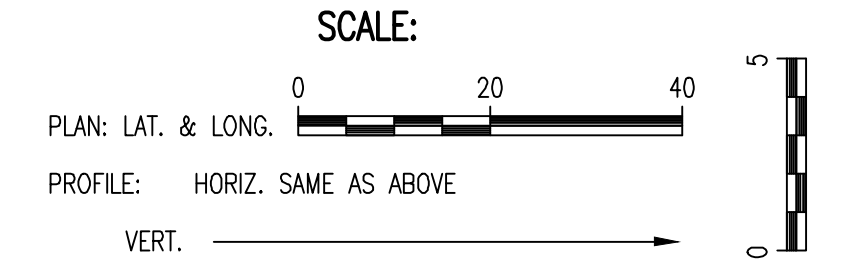

WATERLINE IMPROVEMENTS
 TO SERVE

FONTANA 5TH - PHASE 2

GARY LANZEN, P.E., CITY ENGINEER
 CITY OF WICHITA, PROJECT NO. 448-90429
 OCA NO. 735657

Issue:			
JOB NO.	35-190592-003-042		
DATE	FEBRUARY 2020		
PM	TBK		
DESIGNED BY	TBK		
DRAWN BY	KTD		
CHECKED BY	RWG		

WATERLINE NO. 1

CU106

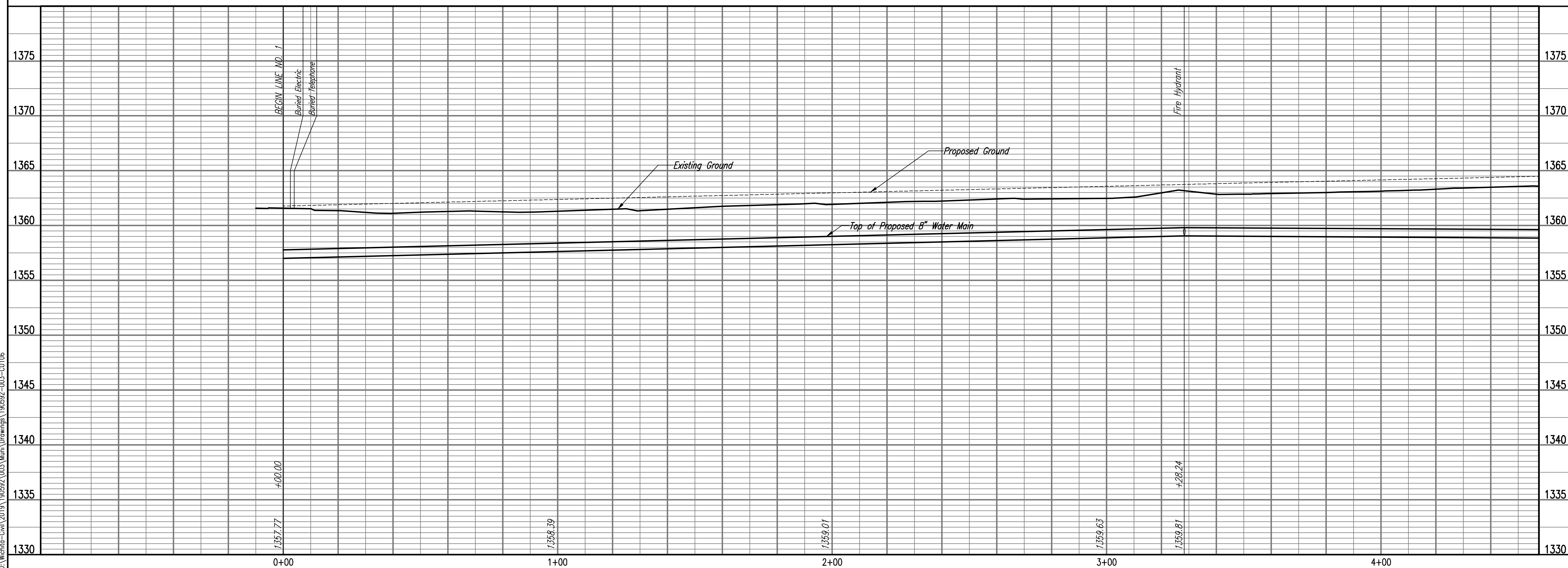

WATERLINE NO. 1

Saved: 02-17-2020 7:58:43 PM by: KURTIS DEWAT
 P:\11-2019-2020\190592-003-042\CLIENTS\DEWAT
 U:\Wichita-Civil\2019\190592-003\Main Drawings\190592-003-CU106