

# STORM WATER DRAIN NO. 358

TO SERVE

## FONTANA 5TH - PHASE 2

OCA NO. 751602

CITY OF WICHITA PROJECT NO. 468-84589

## CITY OF WICHITA, KANSAS

GARY JANZEN, P.E. - CITY ENGINEER



### DEVELOPER CONTACT

MS. LINDA GRAHAM  
SOCORA HOMES, INC.  
727 N. WACO, SUITE 400  
WICHITA, KANSAS 67203  
(316) 263-3201

PROJECT SITE  
FONTANA 5TH-SWD NO. 358

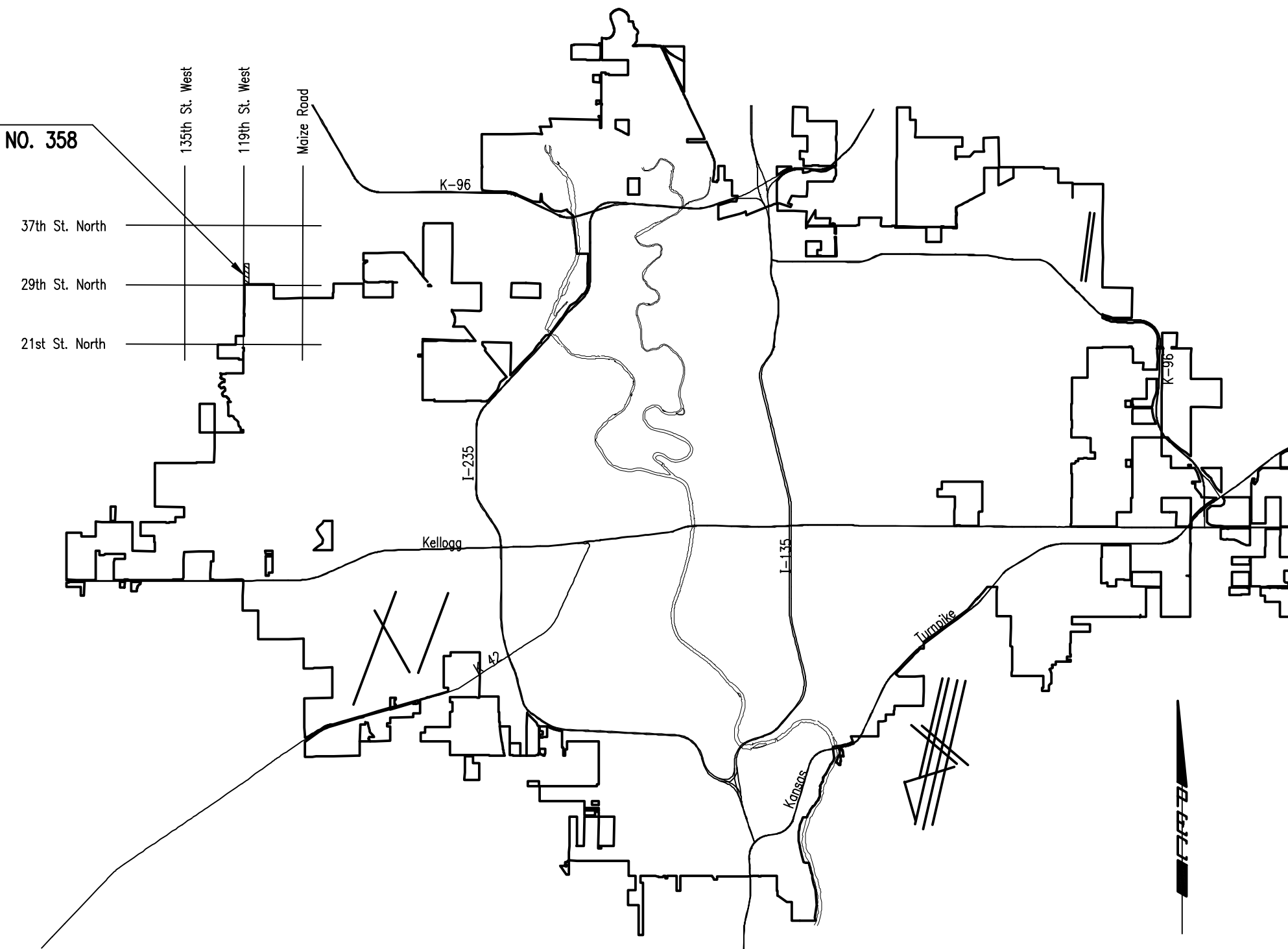

LOCATION MAP

### INDEX OF SHEETS

SHEET NO. CU101	TITLE SHEET
SHEET NO. CU102	KEY MAP AND GENERAL NOTES
SHEET NO. CU103	PLAT BUBBLE MAP (FONTANA 5TH)
SHEET NO. CU104	PLAT COORDINATES (FONTANA 5TH)
SHEET NO. CU105-CU107	SWD GRADING PLAN - AREA 1
SHEET NO. CU108	SWD GRADING PLAN - AREA 2
SHEET NO. CU109-CU110	SWD GRADING PLAN - AREA 3
SHEET NO. CU111	SITE GRADING PLAN
SHEET NO. CU112	FOUR CORNER GRADING PLAN
SHEET NO. CU113	HEADWALL DETAILS
SHEET NO. CU114	DOUBLE DROP INLET DETAIL
SHEET NO. CU115	STORM SEWER MANHOLE DETAIL
SHEET NO. CU501	EROSION CONTROL PLAN
SHEET NO. CU502-CU506	SOIL EROSION BMP DETAILS

STORM WATER DRAIN IMPROVEMENTS

TO SERVE

## FONTANA 5TH - PHASE 2

GARY JANZEN, P.E. - CITY ENGINEER  
CITY OF WICHITA PROJECT NO. 468-84589  
OCA NO. 751602

Issue:	
JOB NO.	35-190592-001-042
DATE	FEBRUARY 2020
PM	JAG
DESIGNED BY	JAG
DRAWN BY	KTD
CHECKED BY	CSB

SWD TITLE SHEET

CU101

# FEBRUARY 2020