

Area Inlet Protection (Typ. of 1)
To be Bid with Storm Water Drain Project.
See Sheet No. CP511.

119TH STREET WEST

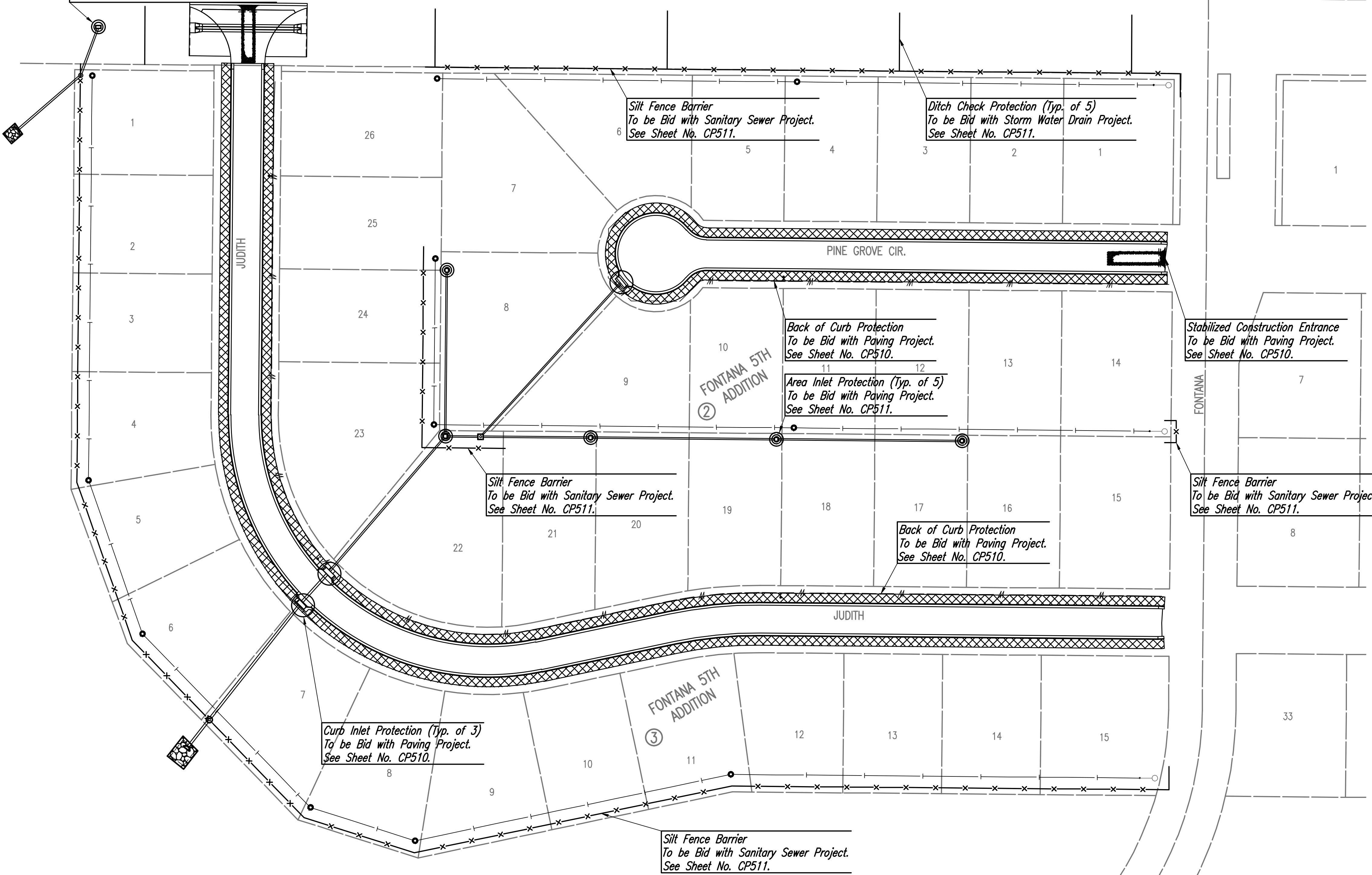
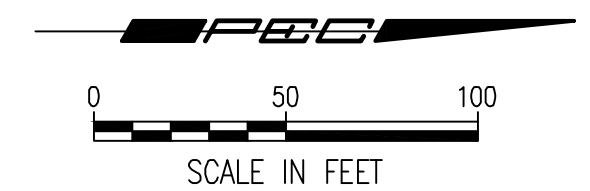

Silt Fence Barrier
To be Bid with Sanitary Sewer Project.
See Sheet No. CP511.

Ditch Check Protection (Typ. of 5)
To be Bid with Storm Water Drain Project.
See Sheet No. CP511.

Back of Curb Protection
To be Bid with Paving Project.
See Sheet No. CP510.

Stabilized Construction Entrance
To be Bid with Paving Project.
See Sheet No. CP510.

Area Inlet Protection (Typ. of 5)
To be Bid with Paving Project.
See Sheet No. CP511.

Silt Fence Barrier
To be Bid with Sanitary Sewer Project.
See Sheet No. CP511.

Back of Curb Protection
To be Bid with Paving Project.
See Sheet No. CP510.

Silt Fence Barrier
To be Bid with Sanitary Sewer Project.
See Sheet No. CP511.

Curb Inlet Protection (Typ. of 3)
To be Bid with Paving Project.
See Sheet No. CP510.

Silt Fence Barrier
To be Bid with Sanitary Sewer Project.
See Sheet No. CP511.

GENERAL NOTES

- CONTRACTOR SHALL INSTALL AND MAINTAIN EROSION PROTECTION THROUGHOUT THE ENTIRE PROJECT. THE FOLLOWING QUANTITIES ARE PROVIDED PER PROJECT. THE FOLLOWING QUANTITIES SHALL BE INCLUDED IN BID ITEMS FOR EACH RESPECTIVE PART. EROSION PROTECTION SHALL BE INCLUDED IN THE BID AS FOLLOWS:

PAVING AND DRAINAGE (472-84802)	
CURB INLET PROTECTION	3 EACH
AREA INLET PROTECTION	5 EACH
BACK OF CURB PROTECTION	3,458 L.F.
TEMPORARY SEEDING	1.2 ACRE
STABILIZED CONSTRUCTION ENTRANCE	2 EACH
SANITARY SEWER (468-84586)	
SILT FENCE BARRIER	2,447 L.F.
STORM WATER DRAIN (468-84589)	
AREA INLET PROTECTION	1 EACH
DITCH CHECK	5 EACH
TEMPORARY SEEDING	1 L.S.
PERMANENT SEEDING	1 L.S.
- THE EROSION CONTROL DEVICES SHOWN ON THIS SHEET ARE CONSIDERED MINIMUM STANDARDS. WHENEVER SEDIMENT ENTERS THE STREETS, STORM SEWERS, DITCHES, OR PONDS, CONTRACTOR WILL INSTALL ADDITIONAL DEVICES, AS NEEDED, TO CORRECT THE PROBLEM.
- THE EROSION CONTROL DEVICES SHOWN HEREON MUST BE IN PLACE AT ALL TIMES DURING CONSTRUCTION UNTIL SUCH TIME AS THE SITE IS REESTABLISHED WITH PAVING OR GRASS. TEMPORARY OR PERMANENT SEEDING AND MULCH WILL BE INSTALLED WHEN EARTHWORK ACTIVITIES CEASE IN AN AREA FOR 14 DAYS OR MORE.
- ANY MUD INADVERTENTLY TRACKED ONTO ANY STREET SHALL BE CLEANED UP BY THE CONTRACTOR, AT THE END OF EACH DAY'S WORK, OR AS DIRECTED BY THE FIELD ENGINEER.
- CONTRACTOR TO FURNISH A TRUCK WASH-OUT PIT TO BE PLACED AT A CONVENIENT LOCATION THAT DOES NOT CONFLICT WITH CONSTRUCTION. CONTRACTOR SHALL CLEAN OUT AND BACKFILL PIT PRIOR TO FINAL INSPECTION. LOCATION SHALL BE APPROVED BY THE FIELD ENGINEER.

SEEDING NOTES

THE CONTRACTOR SHALL APPLY TEMPORARY SEED AND MULCH TO ALL UNPAVED AREAS DISTURBED BY CONSTRUCTION. TEMPORARY SEED (ANNUAL RYEGRASS) AND MULCH PER SPECIFICATIONS. TEMPORARY SEEDING AND MULCHING SHALL BE PAID FOR AT THE LUMP SUM PRICE FOR "SEEDING, TEMPORARY".

LEGEND

- STABILIZED CONSTRUCTION ENTRANCE
- BACK OF CURB PROTECTION
- PROPOSED CURB INLET PROTECTION
- PROPOSED AREA INLET PROTECTION
- SILT FENCE DITCH CHECKS (DRAINAGE)
- SILT FENCE BARRIER (DRAINAGE)
- SILT FENCE BARRIER (SANITARY SEWER)
- PROPOSED WATER MAIN
- PROPOSED SANITARY SEWER LINE
- PROPOSED STORM WATER SEWER

Saved: 02-20-2020 9:59:34 AM by: HARRIS, DEJAY
 Plot: 2/20/20 1:03:34 PM by: HARRIS, DEJAY
 U:\Wichita-Civil\2019\190592\001\Main\Drawings\190592-001-CU501



STORM WATER DRAIN IMPROVEMENTS

TO SERVE
FONTANA 5TH - PHASE 2

GARY LANZEN, P.E., CITY ENGINEER
 CITY OF WICHITA, PROJECT NO. 468-84589
 OCA NO. 751602

Issue:	
JOB NO.	35-190592-001-042
DATE	FEBRUARY 2020
PM	JAG
DESIGNED BY	JAG
DRAWN BY	KTD
CHECKED BY	CSB

EROSION CONTROL PLAN

CU501