

HANDRAIL TO WRAP AROUND AND TERMINATE INTO VERTICAL POST (TYPICAL AT 4 LOCATIONS)

GENERAL CONSTRUCTION NOTES:

- ALL DIMENSIONS ARE FROM THE FACE OF STUD FRAMING, FACE OF MASONRY, FACE OF CONCRETE, OR CENTERLINE OF STRUCTURAL STEEL, UNLESS NOTED OTHERWISE.
- ALL NEW DOORS TO BE LOCATED 6" FROM THE ADJACENT PERPENDICULAR STUD WALL FRAMING. PROVIDE 12" CLEAR ON PUSH SIDE OF DOOR (IF BOTH LATCH AND CLOSER) AND 18" CLEAR ON PULL SIDE OF ALL DOORS PER ADA.
- THE GENERAL CONTRACTOR IS RESPONSIBLE FOR COMPLIANCE WITH ALL CODES AND REGULATIONS APPLICABLE BY BUILDING AUTHORITIES HAVING JURISDICTION OVER THE LOCATION OF THE PROJECT, WHICH ARE ADAPTED AT THE TIME OF ISSUANCE OF THE BUILDING PERMITS.

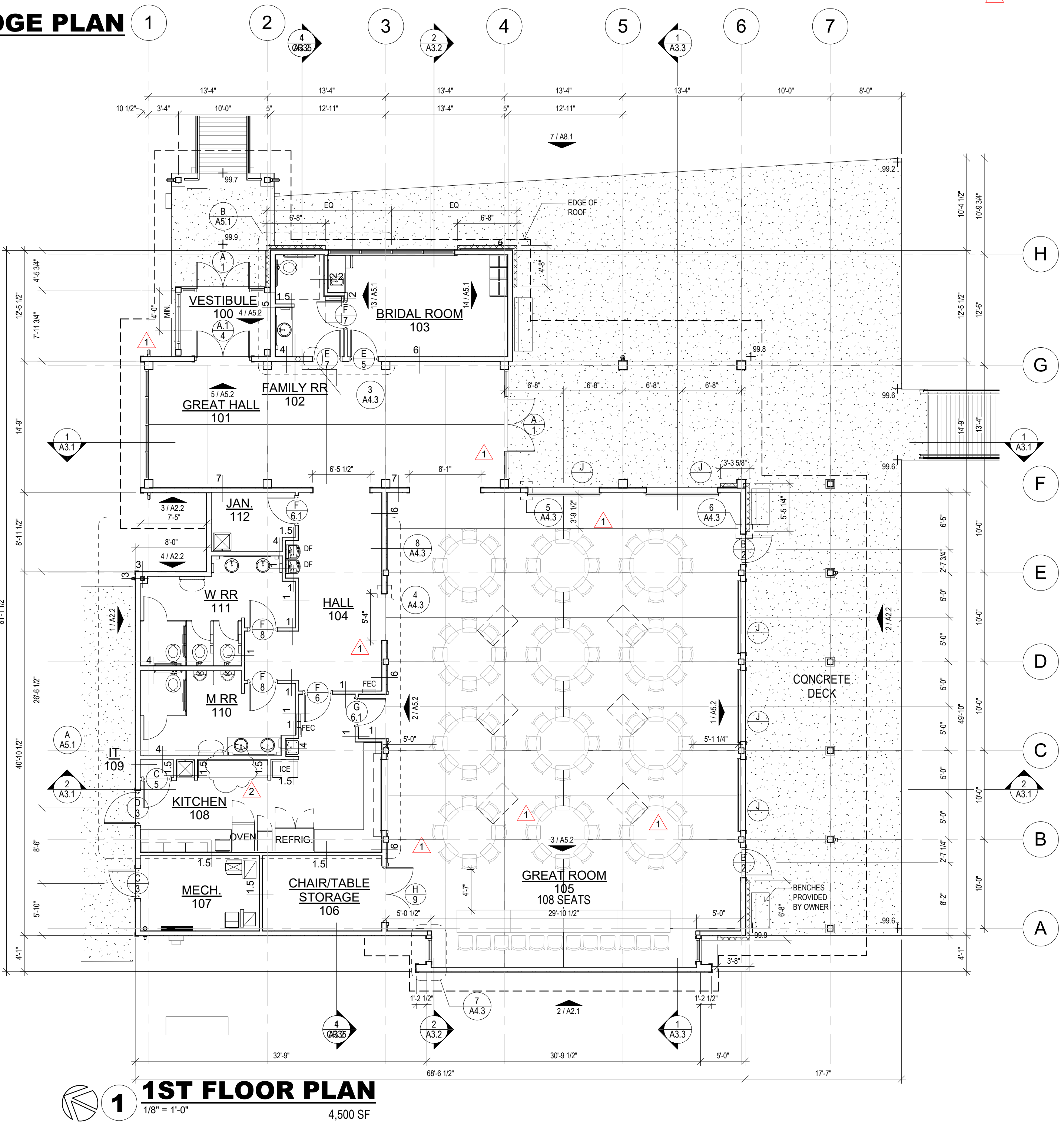
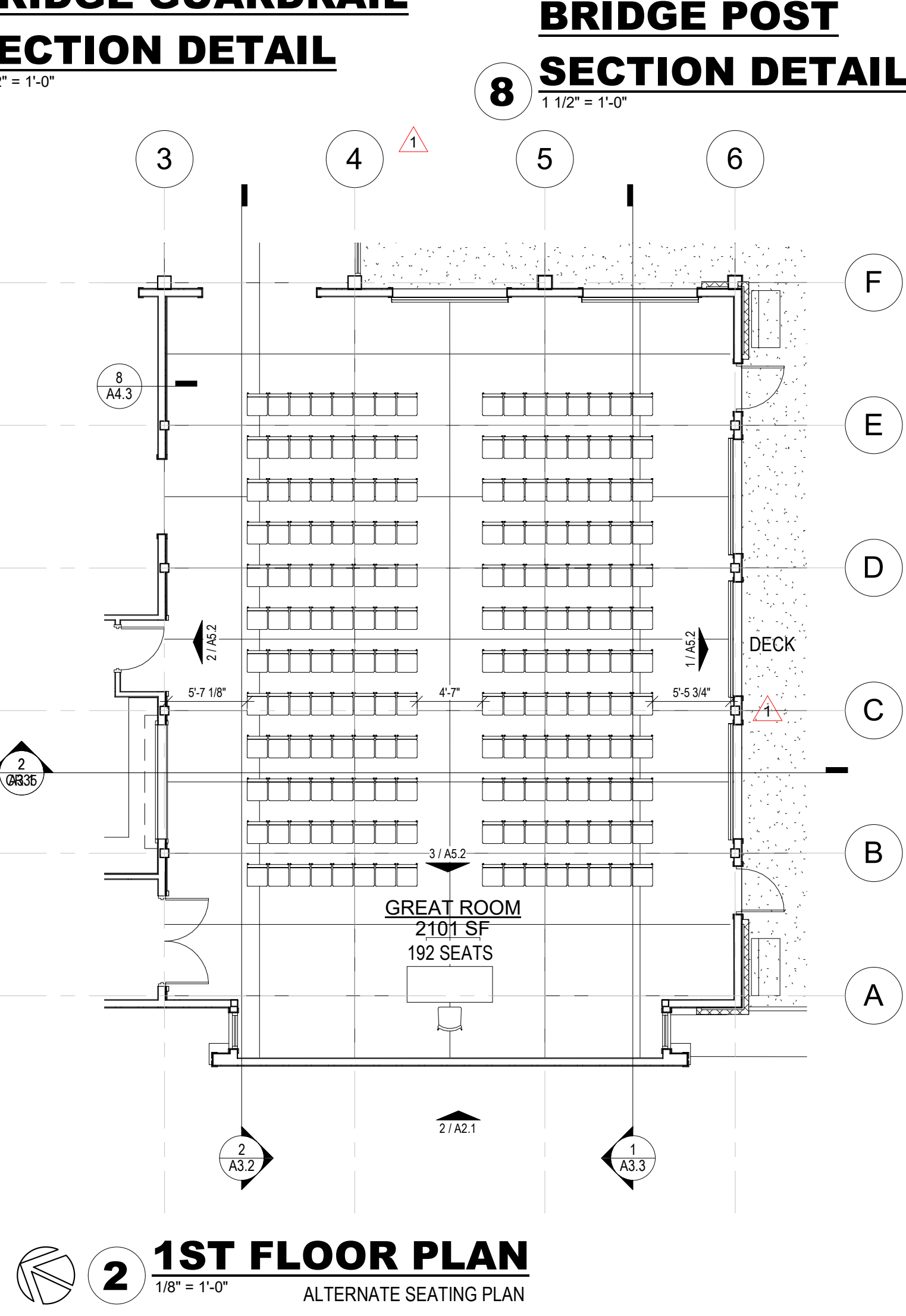
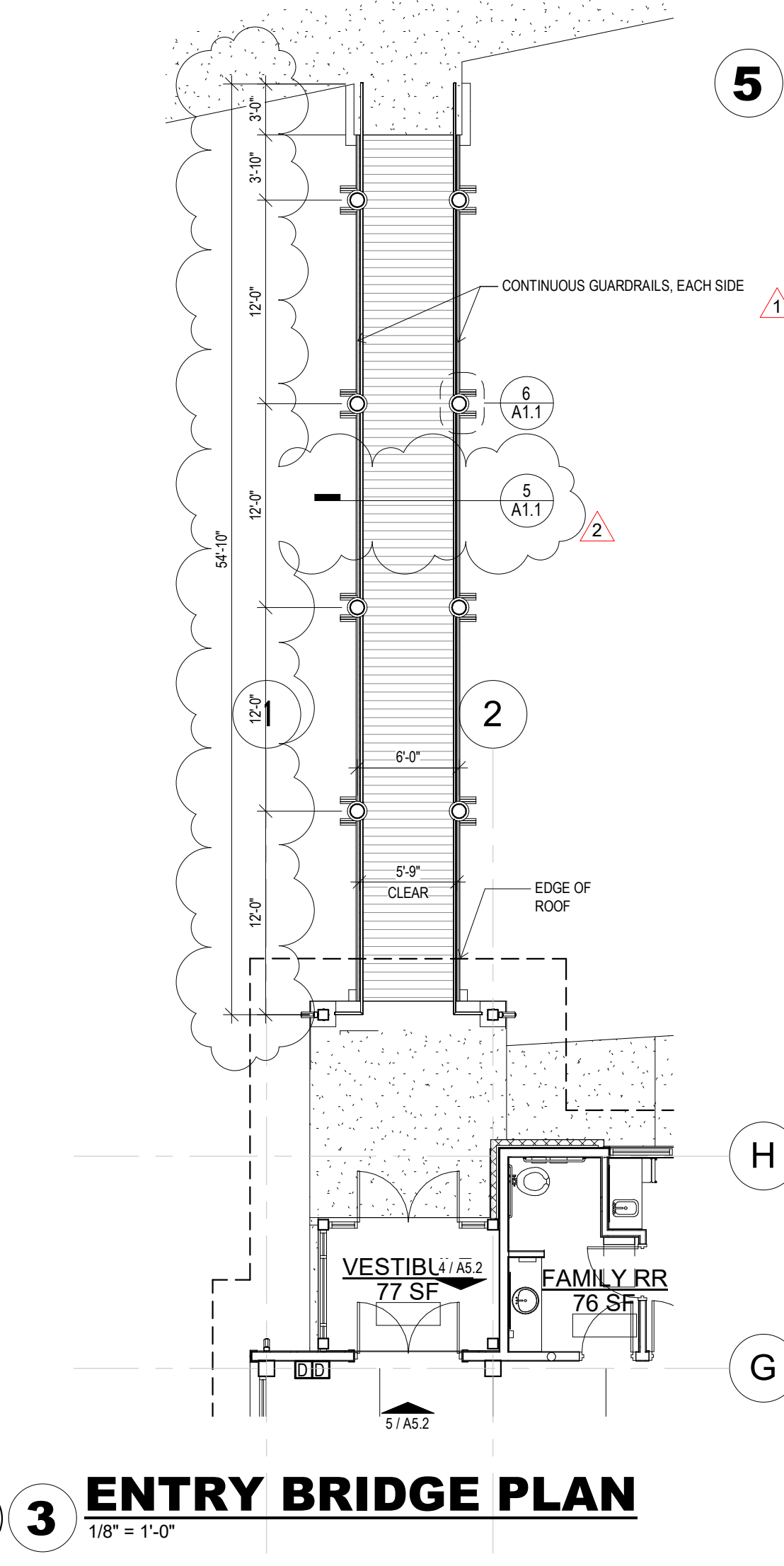

O.J. WATSON PARK  
EVENT CENTER  
3022 S MCLEAN BLVD., WICHITA, KS 67217

CITY REVISIONS 2 13 APR 20  
CITY REVISIONS 30 MAR 20  
PERMIT SET 13 FEB 20  
FLOOR PLAN

A1.1