

NOTES:

1. PROVIDE OTHER GROUNDING CONNECTIONS AS SPECIFIED IN NEC SECTION 250.50.
2. LABEL EACH GROUNDING ELECTRODE CONDUCTOR AND BONDING JUMPER.
3. WHERE CONDUCTORS ARE ROUTED IN FERROUS CONDUIT, BOND BOTH ENDS OF THE CONDUIT TO THE CONDUCTOR.

DESIGNER NOTE: SIZE GROUNDING ELECTRODE CONDUCTORS AND BONDING JUMPERS TO BUILDING STEEL AND WATER SERVICE PER NEC SECTION 250.66

1 SYSTEM GROUNDING DETAIL
NO SCALE

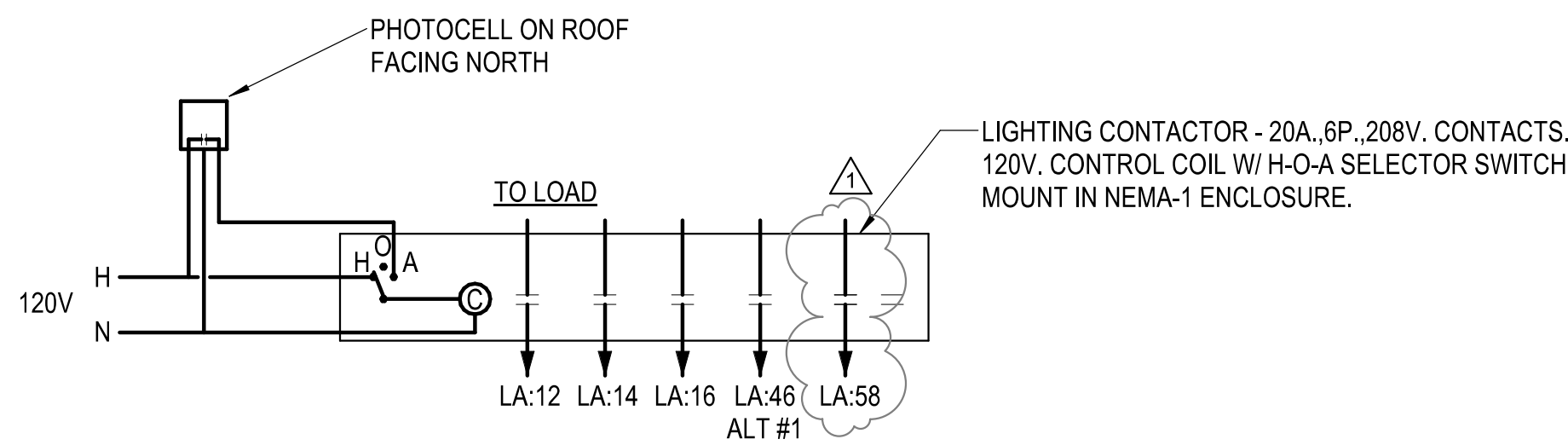

2 CONTACTOR 'A'
NO SCALE

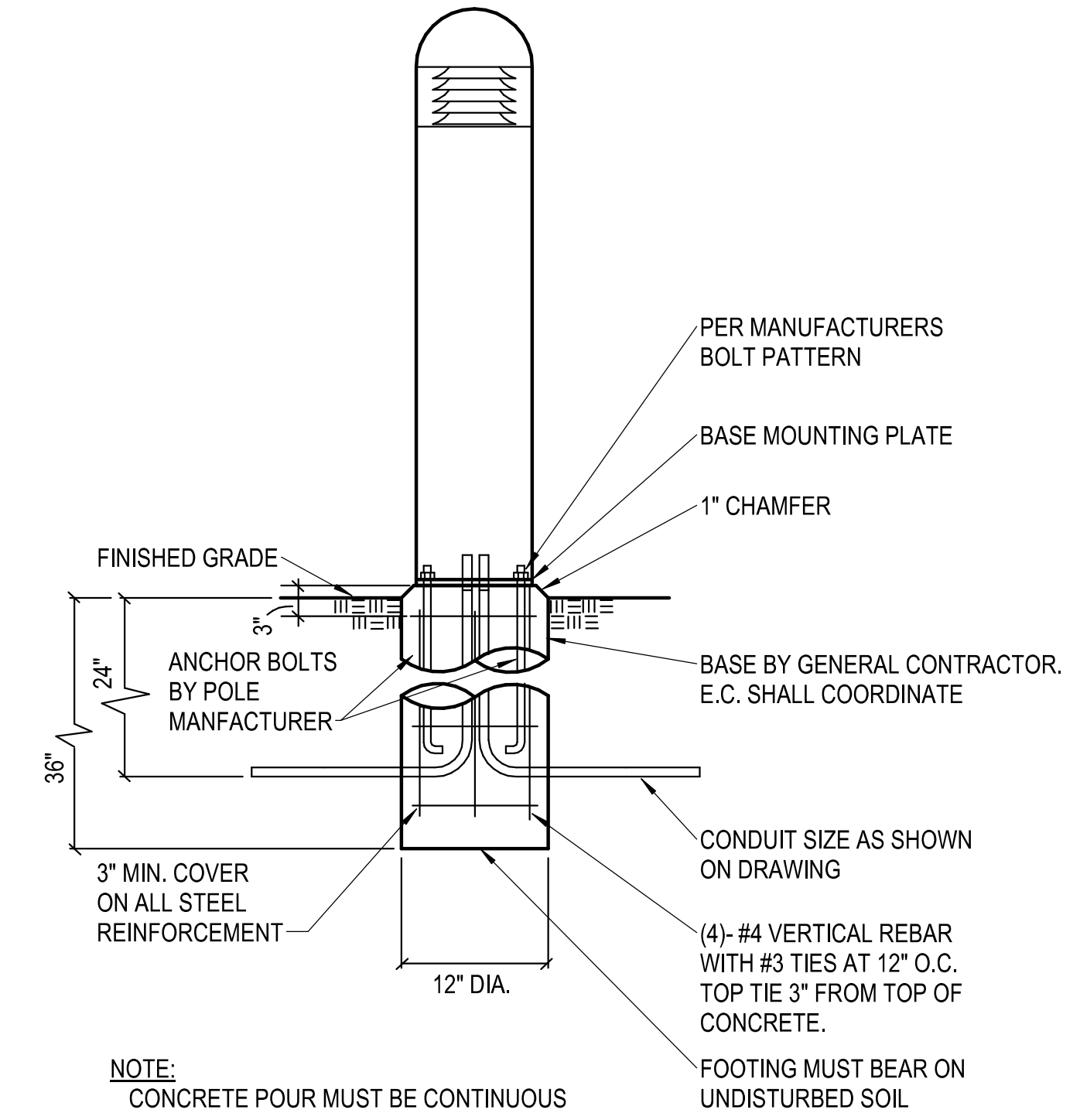

3 PIPE BOLLARD DETAIL
NO SCALE

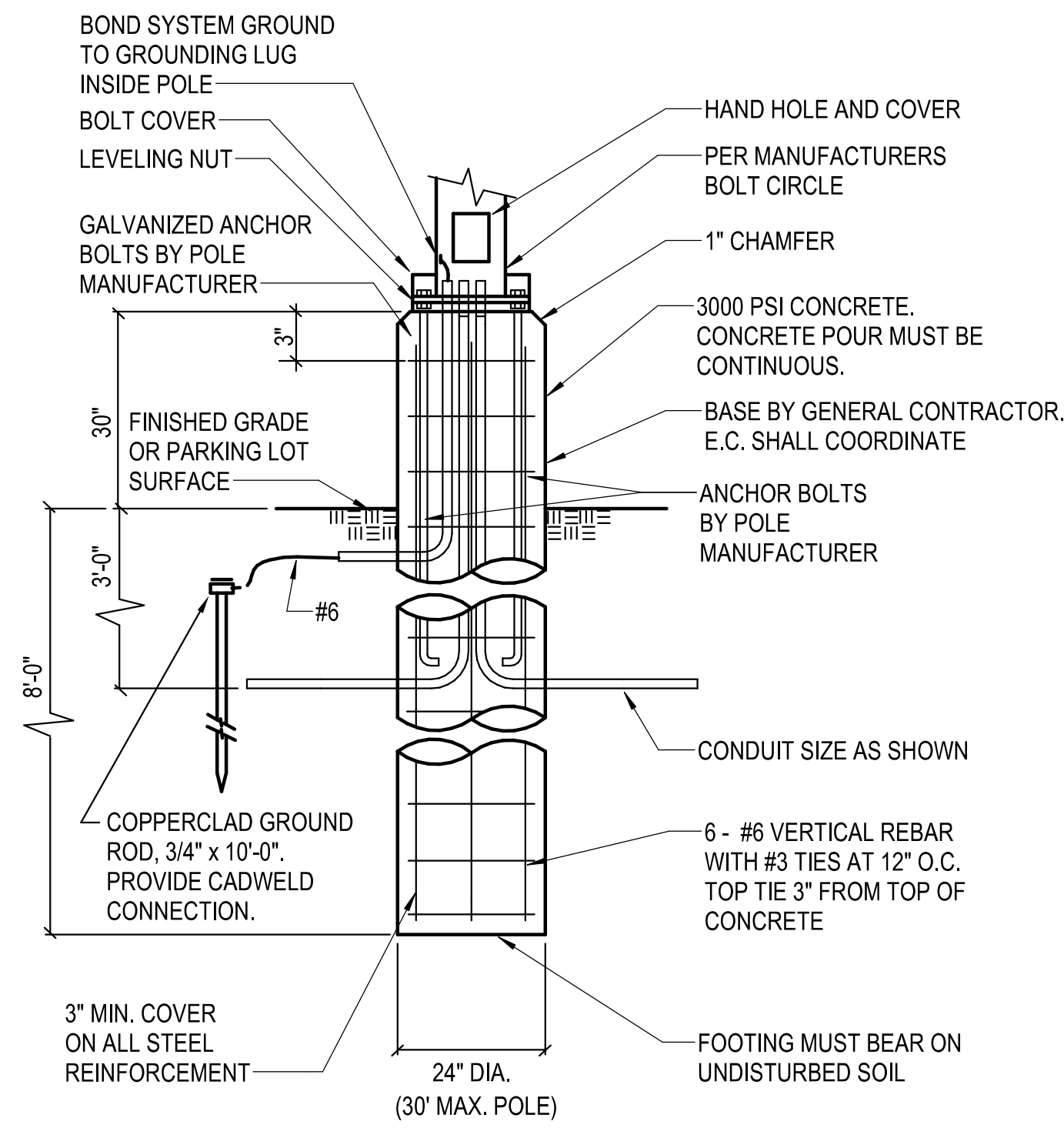

4 POLE BASE DETAIL
NO SCALE

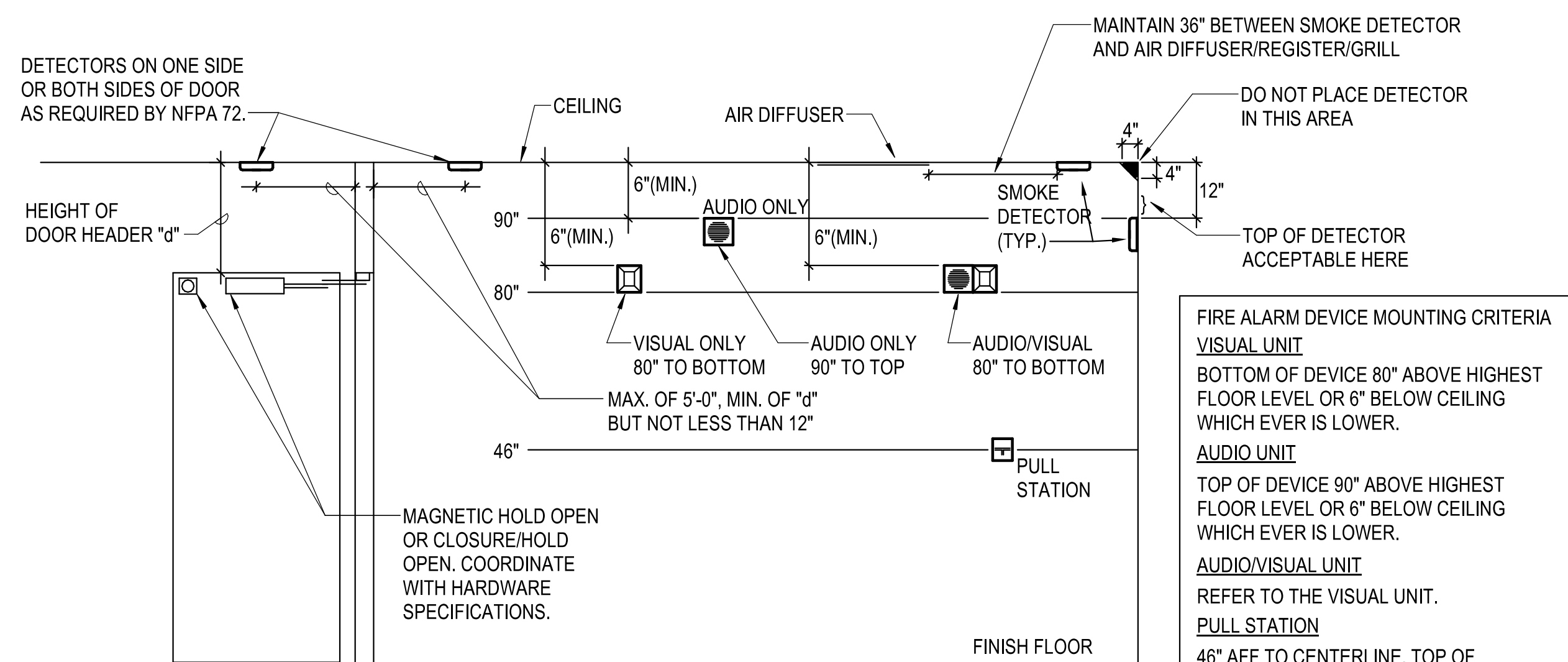

5 F.A. MOUNTING DETAIL
NO SCALE

FIRE ALARM DEVICE MOUNTING CRITERIA

VISUAL UNIT
BOTTOM OF DEVICE 80" ABOVE HIGHEST FLOOR LEVEL OR 6" BELOW CEILING WHICH EVER IS LOWER.

AUDIO UNIT
TOP OF DEVICE 90" ABOVE HIGHEST FLOOR LEVEL OR 6" BELOW CEILING WHICH EVER IS LOWER.

AUDIO/VISUAL UNIT
REFER TO THE VISUAL UNIT.

PULL STATION
46" AFF TO CENTERLINE, TOP OF DEVICE SHALL NOT BE MORE THAN 48" AFF

GENERAL NOTE
THESE GUIDELINES SHALL BE USED UNLESS MOUNTING HEIGHTS HAVE BEEN SPECIFIED OTHERWISE ON THE DRAWINGS.

4/1/2020 8:06:53 AM
BIM 360://198014-003 - Watson Park Events Center New
Building/198014-003-MASTER ELEC-R18.rvt

