

RISER/MANHOLE COORDINATES			RISER/MANHOLE COORDINATES		
POINT NAME	NORTHING	EASTING	POINT NAME	NORTHING	EASTING
MH-31	1639746	1659520	R-62	1639304	1660110
MH-32	1639522	1659819	R-63	1639056	1660424
MH-33	1639022	1660460	R-64	1638760	1660692
MH-34	1638407	1660931	R-65	1638487	1660880
MH-35	1638163	1661055	R-66	1638135	1661068
MH-36	1637241	1661440	R-67	1637767	1661223
MH-37	1636395	1661957	R-68	1637397	1661375
R-59	1639989	1659186	R-69	1637028	1661531
R-60	1639754	1659510	R-70	1636675	1661718
R-61	1639514	1659830	R-71	1636376	1661981

RISER/MANHOLE COORDINATES AND TOE-DRAIN PIPE INVERT ELEVATIONS ARE BASED LIDAR TOPOGRAPHIC DATA AND MAY REQUIRE MINOR HORIZONTAL AND VERTICAL ADJUSTMENTS TO BE MADE IN THE FIELD. ANY FIELD CHANGES TO THE TOE-DRAIN ALIGNMENT OR PIPE INVERTS SHALL BE APPROVED BY THE CITY OF WICHITA'S STORMWATER ENGINEER.

PROFILE SCALE (40:1 EXAGGERATION):
HORIZONTAL: 1"=200'
VERTICAL: 1"=5'

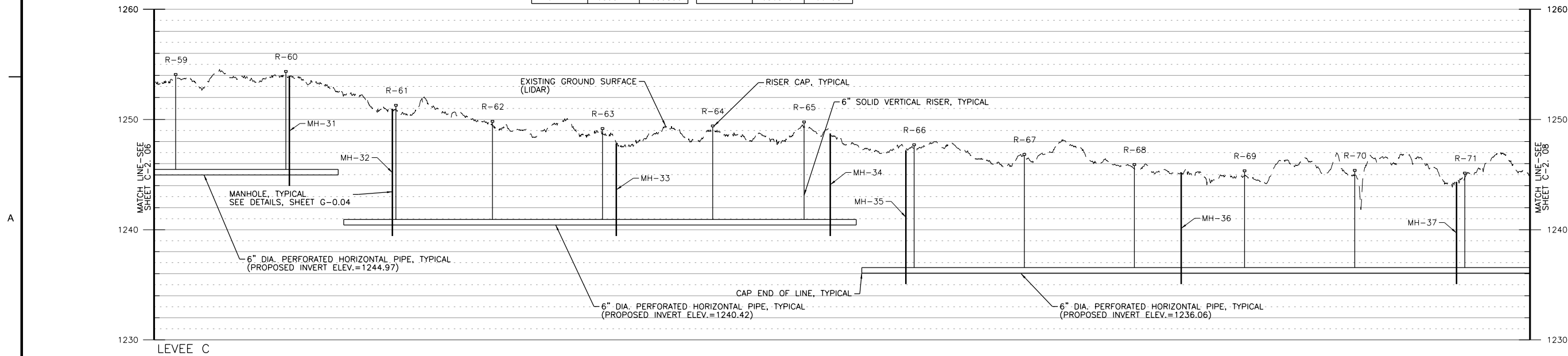

DATE	APPR
DESCRIPTION	MARK

amec
AMEC Earth & Environmental, Inc.
1129 SW Wensaker
Topeka, Kansas 66604
Phone: (785) 272-6830
Fax: (785) 272-6878



LOWER LEVEE "C" TOE DRAIN REPLACEMENT
WICHITA-VALLEY CENTER LOCAL
FLOOD PROTECTION PROJECT
WICHITA, KANSAS

PREPARED FOR
THE CITY OF WICHITA, KANSAS
455 N. Main
Wichita, KS 67202



DESIGNED BY: Larry Sample, PE	DATE: 08-13-2012
DWN BY: RES	CKD BY: LBK
APP BY: L. SAMPLE	
FILE NAME: 13_C-2.07.dgn	
AMEC PROJ. NO. 5-6150-0001	

LEVEE TOE DRAIN PLAN
AND PROFILE
C-2.07
SHEET 13 OF 19