

Street Paving for Thunder

to serve

FALCON FALLS 2ND ADDITION - PHASE 4B

THUNDER AND 48th ST. N.: From the East Line of Lot 7, Block B, East, South, and East to the East Line of Lot 5, Block E

THUNDER CIR.: From the East Line of Thunder East to and Including the Cul-de-sac.

CITY OF WICHITA, KANSAS

Gary Janzen, P.E. City Engineer

Project Number: 472 - 85468

OCA Number: 810020

GENERAL NOTES:

- Contractor will be required to provide notice to utility companies a minimum of seventy-two (72) hours prior to any excavation, as follows:

Kansas One-Call	687-2470
-----------------	----------

The Contractor must notify the following in case of an emergency:

Cox Communications	262-4270
Kansas Gas Service	1-888-482-4950
Westar Energy	383-8650
Aquila Energy	1-800-303-0357
ATT	268-2245
City of Wichita Water Dept.	268-4563
City of Wichita Sewer Maint.	268-4024
City of Wichita Storm Sewer Maint.	268-4090
City of Wichita Traffic Maint.	268-4034
Conoco Phillips Pipeline Co.	1-877-267-2290
Southern Star Pipeline Co.	529-6600
Kinder-Morgan Pipeline Co.	1-888-844-5658
- Utility service lines, poles, valve boxes, meters, and etcetera are to be adjusted as necessary by others prior to construction unless the plans specifically call for their adjustment by the Contractor or unless the plans specifically identify a utility to be adjusted by its owner during construction. Existing utilities and their location, as shown on the plans, represent the best information obtainable for design. The Contractor will be required to work around existing utilities within the right-of-way which do not conflict with proposed construction.
- Rubble from the removal of miscellaneous structures and excess excavation which is to be wasted shall be disposed of on sites to be provided by the Contractor. These sites shall be approved by the Engineer as to suitability, appearance and site location. Locations, in the opinion of the Engineer, that will leave an unsightly appearance will not be approved. All disposal sites must be approved by the Kansas Department of Health and Environment. Material either stockpiled or disposed of in a flood plain would require a Kansas State Board of Agriculture permit. Any material dumped in waters of the United States or wetlands is subject to U.S. Corps of Engineers permitting regulations. Any material buried or stockpiled beyond approved construction limits would require additional archaeological investigations unless buried in a previously approved borrow location.
- Trees and shrubs in public right-of-way which are in direct conflict with proposed new construction shall be removed by the Contractor ONLY with the Developer or Baughman Company approval. Trees and shrubs which are not in direct conflict with proposed new construction shall be saved and protected from damage.
- The Contractor shall give all property owners and/or tenants of developed property abutting the construction of this project a minimum of ten (10) days notice prior to start of construction.
- The Contractor shall be responsible for preserving property irons. The Contractor will be required to re-establish any property irons which are damaged or destroyed by his construction operations. Such irons shall be re-established by a licensed Land Surveyor in accordance with state laws.
- All existing and proposed erosion control measures including silt fencing, erosion control mat, straw bales, inlet barriers, and const. entrance shall be maintained throughout construction by the Contractor and until project is accepted by the City of Wichita. The on-site Engineer shall complete weekly reports on the status of erosion control measures. The Contractor shall be required to comply with maintenance and/or replacement of erosion control measures as determined by the on-site Engineer until project is accepted by City of Wichita.
- A saw cut of at least one-half the depth of existing surface courses or one-fourth the depth of the existing total pavement thickness shall be provided at locations where proposed construction abuts the existing surface course or pavement for which partial removal of that surface or pavement is required. Sawed joint to facilitate removal within three (3) feet of existing joints will not be permitted and for such instances the limits of removal shall extend to the existing joint. Such saw cuts will not be paid for directly and this cost shall be considered as subsidiary to the removal of the surface or pavement.
- Unless otherwise noted on the plans, all disturbed areas areas to be seeded as follows:
 Seed -- Rye grass; 5 lbs./1000 Sq. Ft.
 All costs associated with seeding including mobilization, preparation of ground, seeding, fertilizing, mulching, etc. shall be included in the L.S. bid item "Seeding".
- Limits of earthwork shall match existing ground elevations at the right-of-way line unless otherwise noted on the plans with a new finished grade elevation. When a new finished grade elevation is shown, the earthwork shall extend one foot beyond the right-of-way line and then slope up or down using permissible slopes to match the existing ground surface.
- The Developer of this project is Jay Russell
 P.O. Box 75337, Wichita, KS 67272
 (316) 722-2417 jay.russell@jussellco.com
- Excess excavation shall be stockpiled or spread on-site at a location determined by the Developer or Design Engineer.
- The cross section and earthwork quantities do not account for earthwork construction to build the sidewalk. The contractor shall include all costs for excavation, backfilling, forming, concrete material, etc. to construct the sidewalk in the "Sidewalk, S.F." bid item.

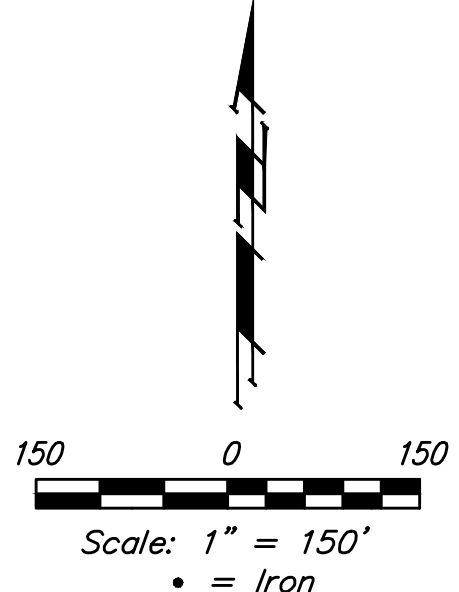
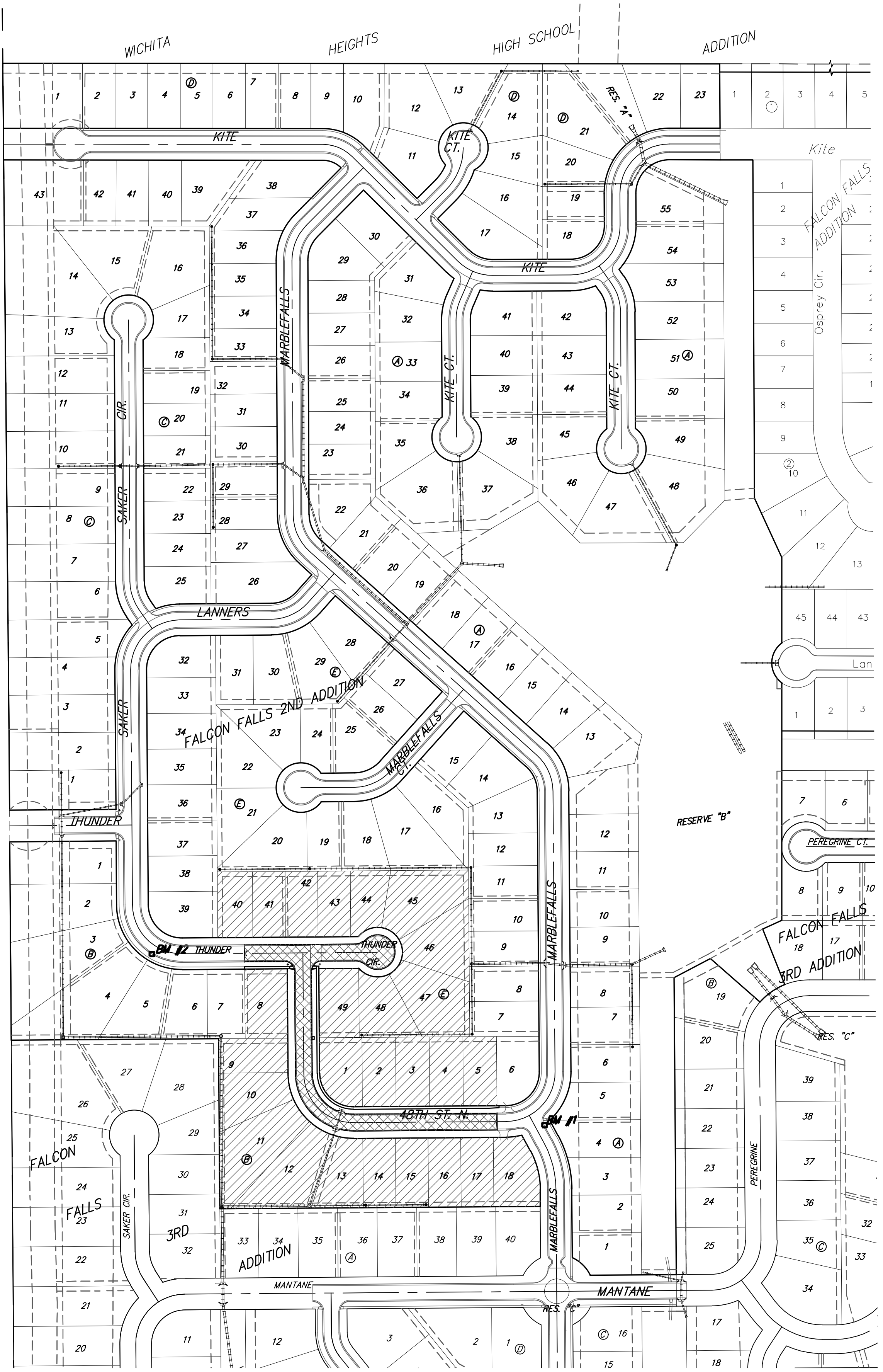

BENCHMARKS

BM #1: City of Wichita BM Disk South end of East return Marblefalls & 48th ST N SW of the NW corner of Lot 4, Block A, Falcon Falls 2nd Addition Elev. = 1354.34 (NGVD29)

BM #2: "□" Top of Curb NE of the NW corner of Lot 5, Block B, Falcon Falls 2nd Addition Elev. = 1359.13 (NGVD29)

SHEET INDEX

Title Sheet	1
Asphalt Paving Detail	2
Curb & Gutter Details	3
Sign Details	4
Valley Gutter Details	5
Wheel Chair Ramp Detail	6
Thunder/Thunder Cir.	7
48th St North	8-9
Erosion Control Plan	10
Erosion Control BMP Details	11-15
Cross Sections	16-19
Coordinate Sheet	20
Copy of Plat	21-22

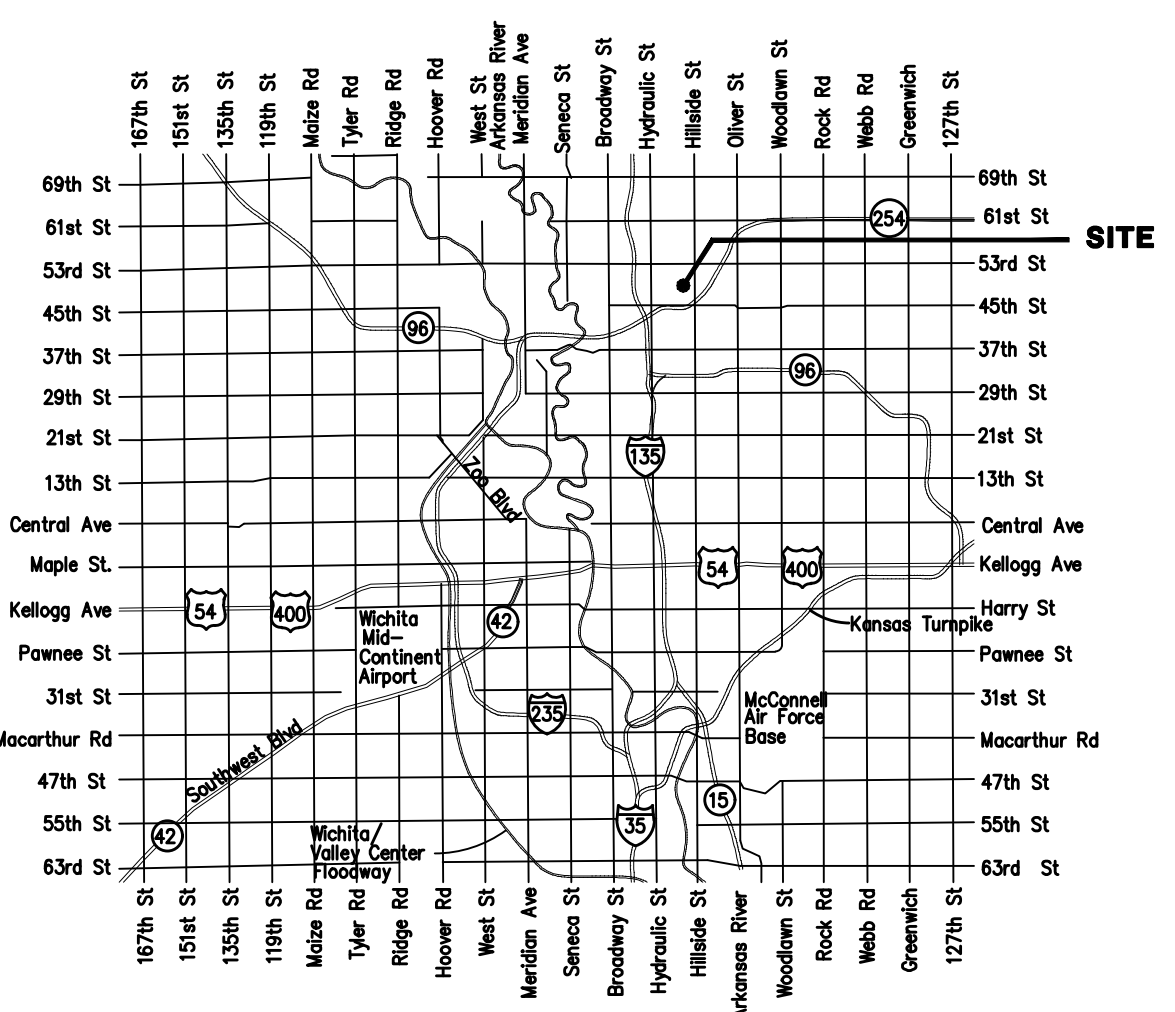

VICINITY MAP

Street R/W	953	162	308
Project Earthwork Totals (CY unadjusted for shrink & swell)			
	Excavation	Compacted Fill	Loose Fill
Total Project Length	623 L.F. = 0.12 Miles		