

BENCHMARKS:

#1: "□" CUT CHISELED ON CURB,
15.2' S. OF SW COR., LOT 14,
BLOCK C, ROCKY FORD 2ND
ADDITION.
ELEV. = 1385.10 NAVD88

#2: "□" CUT CHISELED ON CURB,
8.6' N. & 11.7' W. OF SW COR.,
LOT 14, BLOCK C, ROCKY FORD
2ND ADDITION.
ELEV. = 1380.11 NAVD88

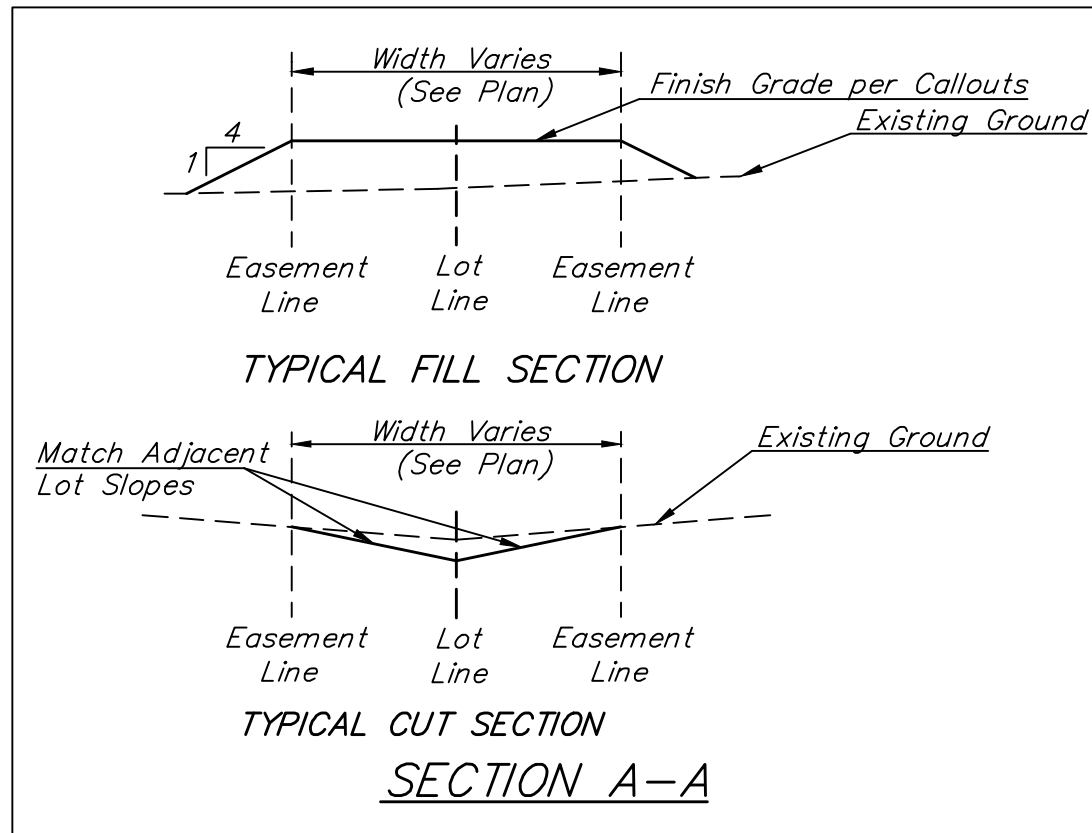
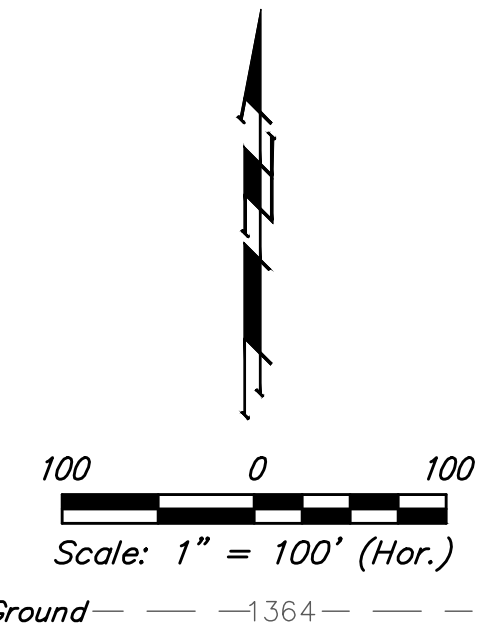

= Easements To Be Graded

Approximate Easement Grading Quantities:
(For Information Only)
Excavation: 2.0 C.Y.
Fill: 22.0 C.Y.

The Contractor shall grade the easements as shown to the elevations given on the easement grading plan.

The Contractor shall 'straight' grade the easements between the elevations given. Where a callout designates 'Match', the Contractor will grade to the existing ground elevation.

Excess excavation from easement grading and from sanitary sewer construction shall be placed on the lots as indicated to the elevations shown.

All cost to be included in the Lump Sum bid item "Easement Grading"

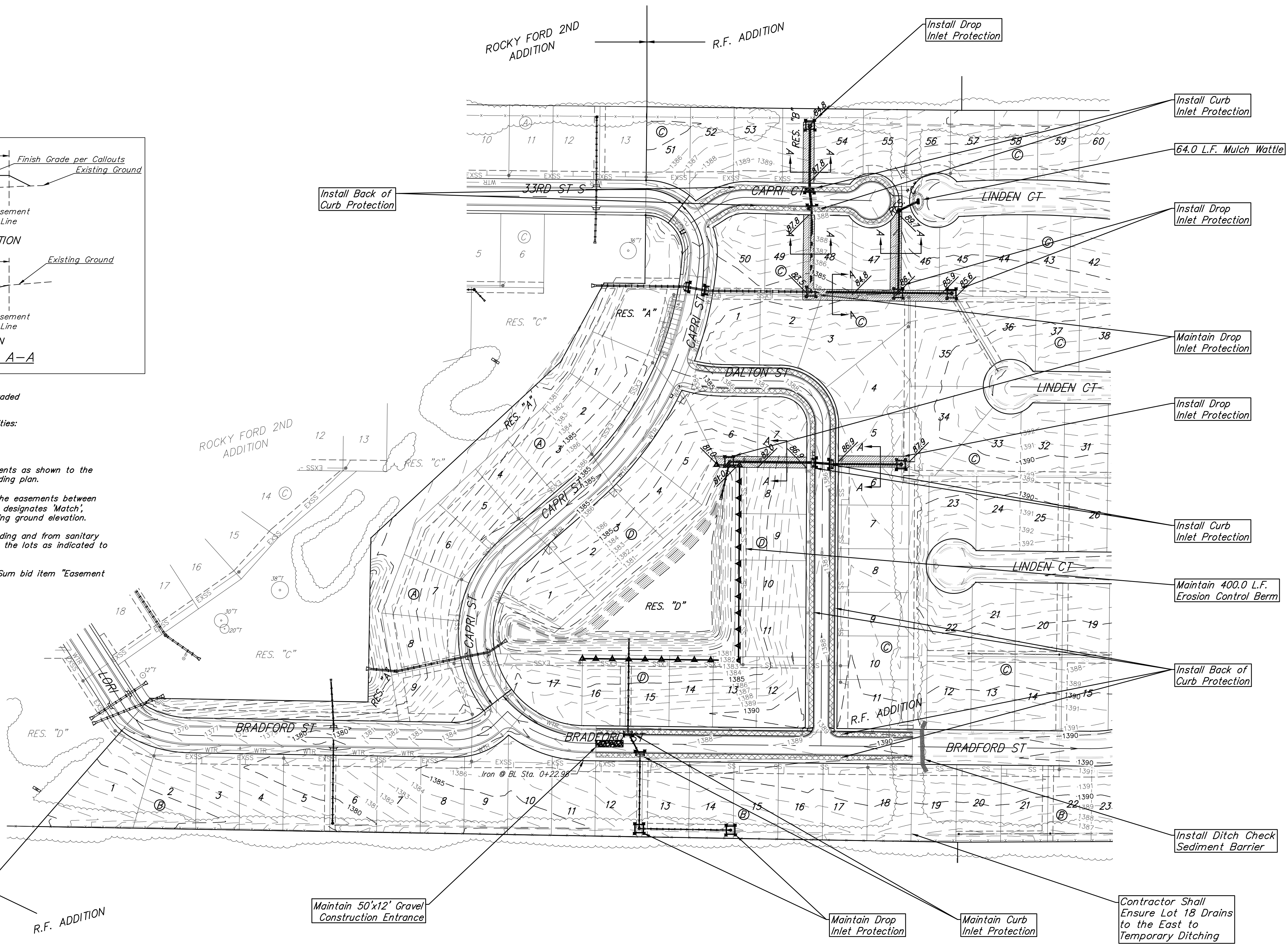

EROSION CONTROL LEGEND

- DROP INLET PROTECTION
- CURB INLET PROTECTION
- DITCH CHECKS
- SILT FENCING
- EROSION CONTROL BERM
- BACK OF CURB PROTECTION

NOTES:
1. Contractor shall make sure all erosion control is in place before project is accepted. This plan represents the minimum standard. Any additional erosion control measures shall be installed by the Contractor as needed.
2. Removal of Gravel Construction Entrance for pavement construction shall be included in bid item "Site Clearing"
3. This Plan Is Not To Be Used As A Comprehensive Grading Plan. All Spot Elevations Are Proposed & Subject To Change.

All areas disturbed during construction shall be seeded, mulched, and fertilized as per Cover Sheet General Notes.

EROSION CONTROL MEASURE	INSTALL	MAINTAIN
CONSTRUCTION ENTRANCE (EA)	0	1
BACK OF CURB PROTECTION (LF)	3,568	0
SILT FENCE (LF)	0	0
DITCH CHECKS (EA)	1	0
CURB INLET PROTECTION (EA)	6	2
DROP INLET PROTECTION (EA)	4	4
EROSION CONTROL MAT (SY)	0	0
MULCH WATTLE SED. BARRIER (LF)	0	0
EROSION CONTROL BERM (LF)	0	400

* ALL EXISTING BMPs INCLUDING CONSTRUCTION ENTRANCE, SEDIMENT BARRIERS, SILT FENCE, CUT-OFF TRENCH, AND EROSION CONTROL MAT SHALL BE MAINTAINED AND REPAIRED IF NECESSARY.

Baughman R.F. Addition - Phase II
EROSION CONTROL
Street Improvements

Baughman Company, P.A. 315 Ellis St. Wichita, KS 67211 P 316-262-7271 F 316-262-0149
ENGINEERING | SURVEYING | PLANNING | LANDSCAPE ARCHITECTURE

PROJECT NUMBER 472-2019-085534	DESIGN AEG	DRAWN HW
REVISIONS:	APPROVED	DATE 08/17/20
	SCALE Noted	SHEET 17 OF 36

C:\Projects\R.F.Addition_1802\3137\Engineering\Phase 2\STRSWS\STR PLANS.dwg