

Saved: 08-14-2020 2:40:01 PM by ROY THOMAS
 Plot Scale: 1:1 08-14-2020 3:58:08 PM by ROY THOMAS
 U:\Wichita-Civil\2018\180189\001\Main\Drawings\Minisa\180189-01-CG-01-Overall Grading Plan

JEANETTE AVENUE

JEANETTE AVENUE

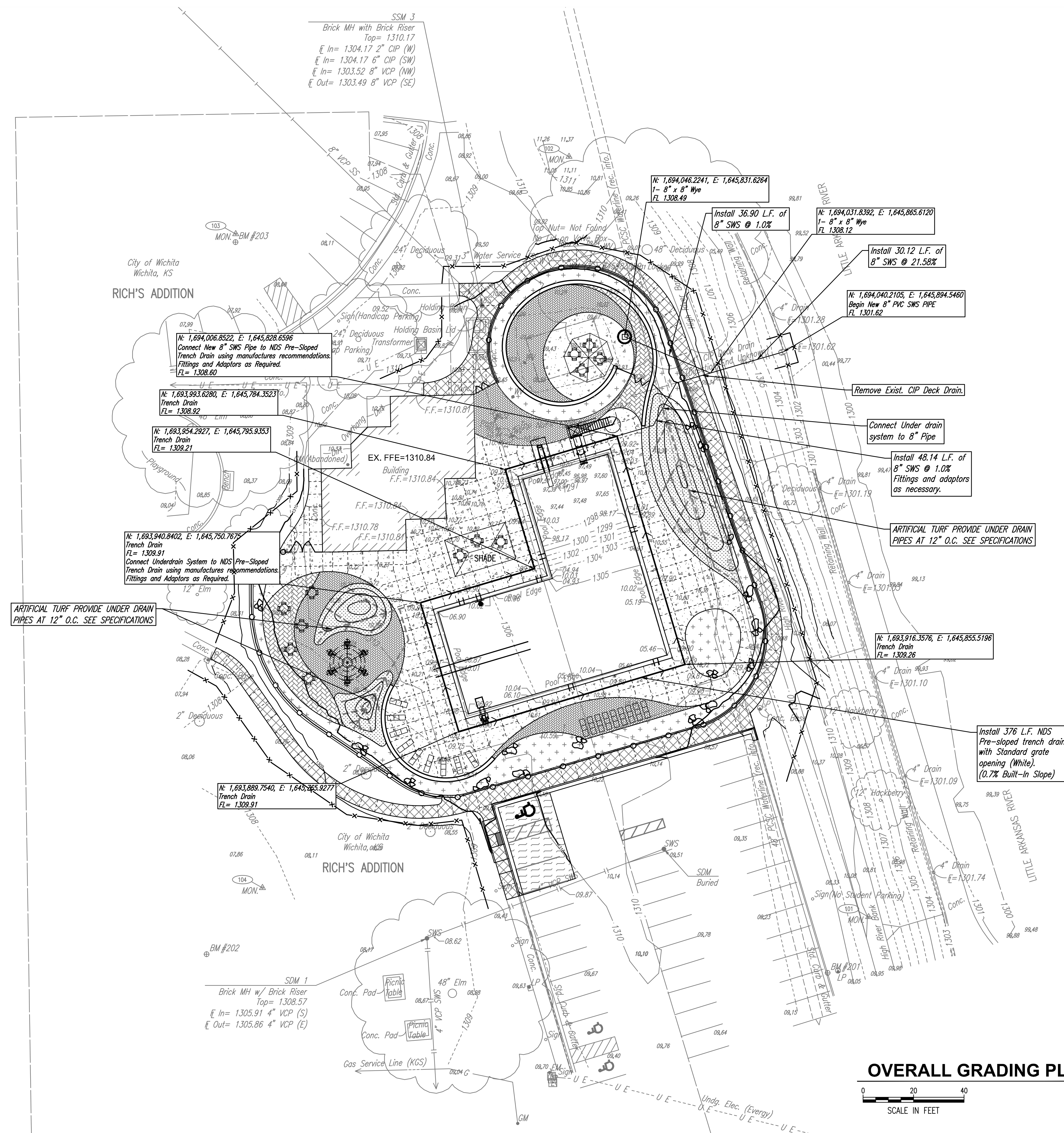

LEGEND

- 1290— EXISTING MAJOR CONTOUR
- 1291— EXISTING MINOR CONTOUR
- 1290— PROPOSED MAJOR CONTOUR
- 1291— PROPOSED MINOR CONTOUR
- - - - - BREAK LINE
- FLOW DIRECTION
- INLET PROTECTION (TEMPORARY)
- ××××× SILT FENCE (TEMPORARY)
- ▨ STONE CONSTRUCTION ENTRANCE (TEMPORARY)

STORM SEWER FIXTURES AND PIPING SHALL BE MANUFACTURED BY ADVANCED DRAINAGE SYSTEMS, 4640 TRUEMAN BOULEVARD, HILLIARD OH, 43026, PH: 800.821.6710, WWW.ADS-PIPE.COM. CONTRACTOR SHALL COORDINATE INSTALLATION WITH MANUFACTURERS RECOMMENDATION FOR TYPE AND INSTALLATION METHODS. CONTRACTOR SHALL PROVIDE PRODUCT CUT SHEETS AND SHOP DRAWINGS FOR REVIEW BY CIVIL ENGINEER.

NOTE:
SEE SPECIFICATION SECTION 13 11 70 TRENCH DRAIN GRATING SYSTEM FOR INSTALLATION AND SIZING OF DECK SLOTTED DRAINAGE SYSTEM

OVERALL GRADING PLAN

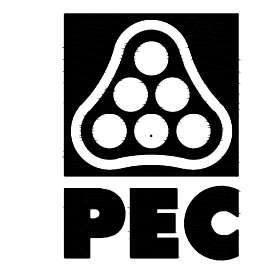
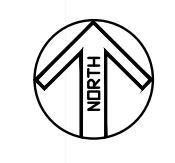
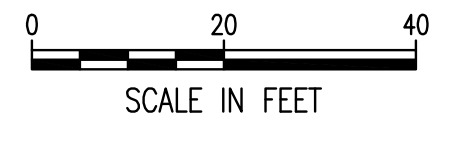

WICHITA, KANSAS
City of
Pool Improvements
MINISA PARK

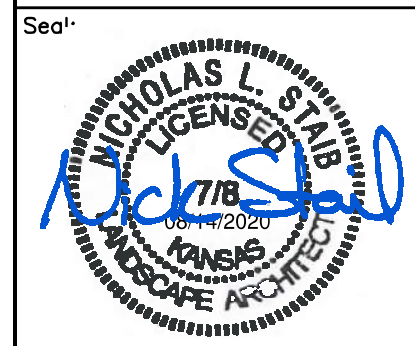

Nick Steib—Landscape Architect
LICENSE #0718
Date: 08-14-20 Job #: 18-512
Drawn: RFT Checked: NLS
Issue: FOR BID

OVERALL GRADING PLAN