

GRADING AND STORM WATER POLLUTION PREVENTION NOTES

- Contractor shall be responsible for utilizing best management practices for retaining all debris and silt on site, and to take measures to minimize erosion and keep from migrating off site.
- Suggested location for sediment fence and/or erosion control fabric for disturbed areas. Fence shall be located at all down hill slopes of disturbed areas.
 - Fence shall be cleaned when its effectiveness has been diminished to one-third of its capacity.
 - Provide erosion control measures on all slopes of excavations and stock piles throughout construction.
 - Maintain maximum slope of 3:1 except for below grade excavations.
- Disturbed area: 0.50 acres
 - Qualified personnel shall inspect disturbed areas of the construction site that have not been finally stabilized at least once every 7 calendar days and within 24 hours of the end of a storm event that is 1/2" or greater.
 - All building material wastes shall be removed from the site.
 - Off site vehicle tracking of sediment wastes shall be minimized and cleaned up within a 24-hr period.

POOL DEMO NOTES

Pool Floor Removal. It is acceptable to remove the existing and/or wall as required for new piping, provided that the subsequent subgrade is prepared as required. Saw cutting will not be required for the drainage holes in the pool floors.

Pool Walls. It is acceptable to remove the entire pool wall as required for new piping, provided that the subsequent subgrade is prepared as required.

POOL AREA KEY NOTES – EXISTING DEMOLITION

Contractor shall verify all existing dimensions and report any discrepancies

- EXISTING ITEMS**
- E1 Existing utilities shall be protected
 - E2 Existing parking lot shall be protected
 - E3 Existing sidewalk shall be protected
 - E4 Existing trees shall be protected
 - E5 Existing bathhouse shall be protected
 - E6 Existing light pole shall be protected ~ Contractor shall verify location of existing conduit and conductors and protect to maintain a working system
 - E7 Existing 6'-0" tall chain link fence and 12" wide concrete strip of pool deck shall be protected
 - E8 Existing deck drain shall be protected
 - E9 Existing pool piping may remain if it does not interfere with new construction ~ Exposed open ends shall be capped
 - E10 Existing pool floor & walls shall be protected ~ See Detail A-SP-PM2
 - E11 Existing underdrain pipe shall be protected
 - E12 Existing approximate pool water depths (4" freeboard)
 - E13 Existing approximate wading pool water depths (7" freeboard)
 - E14 Existing Filter Area ~ See Sheet SP-F1

DEMOLITION ITEMS

- D1 Remove existing 1 meter diving stand, protect and deliver to Owner
- D2 Remove existing 3 meter diving stand, protect and deliver to Owner
- D3 Remove existing lifeguard chair, protect and deliver to Owner
- D4 Remove existing bench, protect and deliver to Owner
- D5 Remove existing table, protect and deliver to Owner
- D6 Remove existing sunshade, protect and deliver to Owner
- D7 Remove existing 4'-0" tall chain link fence, protect and deliver to Owner
- D8 Remove existing pool deck ~ See Detail A-SP-PM2
- D9 Remove existing portions of pool wall ~ See Detail A-SP-PM2
- D10 Remove existing portions of pool floor to allow for drainage ~ See Detail A-SP-PM2
- D11 Remove existing wading pool
- D12 Remove existing piping as required for new construction ~ Exposed open ends shall be capped
- D13 Remove existing sidewalk
- D14 Remove existing grab rails, protect and deliver to Owner
- D15a Remove existing fence fabric, hardware, posts, and footings ~ Protect for reinstallation
- D15b Remove existing fence gate fabric, hardware, posts, and footings ~ Protect for reinstallation
- D15c Remove existing fence fabric, hardware, posts, footings, and concrete ~ Allow for new gate
- D16 Construction limits
- D17 Construction access
- D18 Construction staging
- D19 Suggested silt fence location
- D20 Maintain public access to existing sidewalk
- D21 Provide (2) HC parking signs/painted HC stalls for use during construction

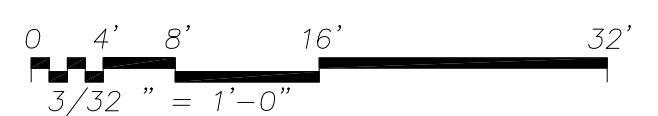
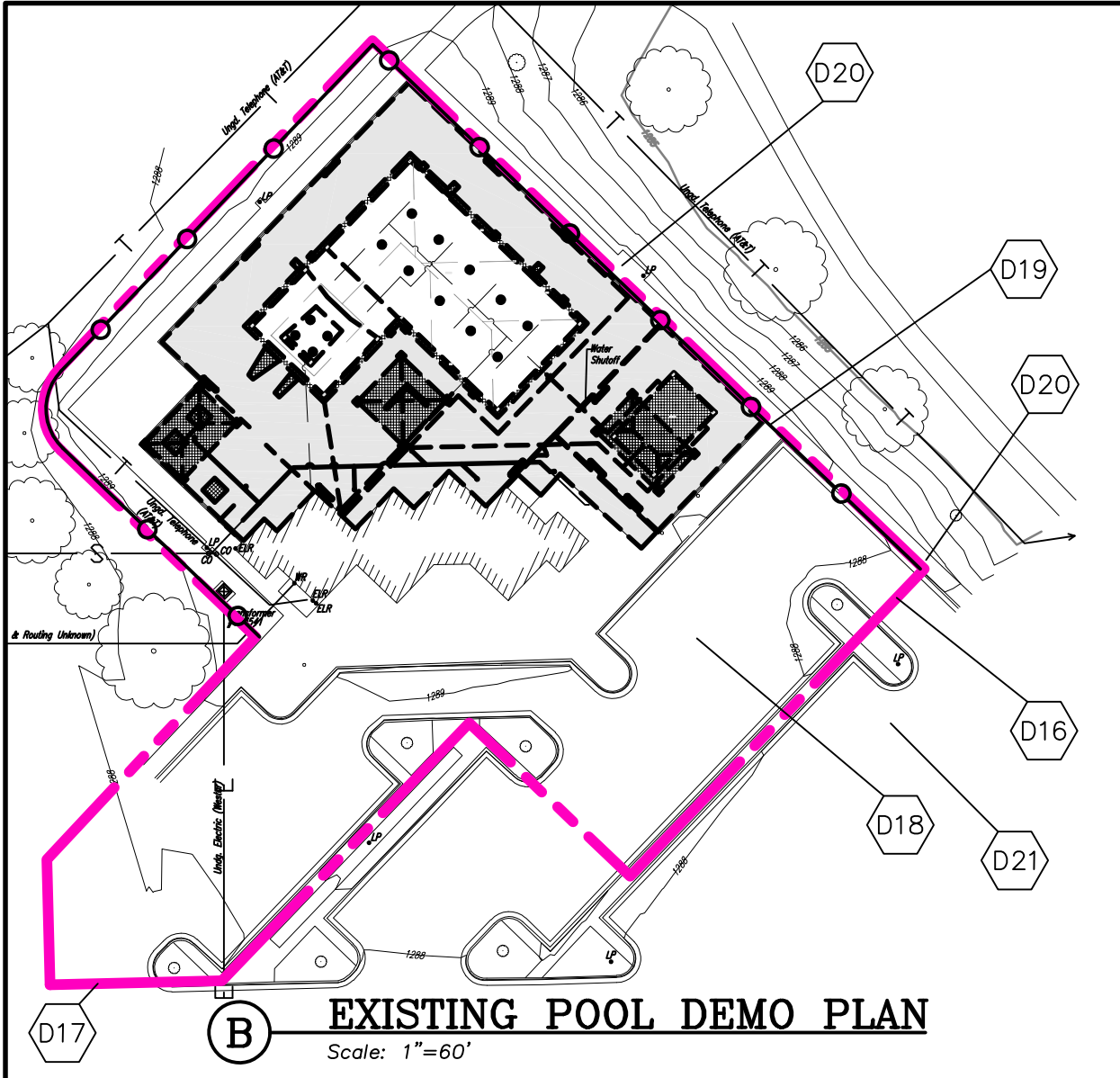

EXISTING POOL DEMO PLAN
Scale: 3/32" = 1'-0"

EXISTING POOL DEMO PLAN
Scale: 1" = 60'

waters edge AQUATIC DESIGN
11205 W. 79th St. Lenexa, KS 66214
L 913.438.4338 www.WeDesignPools.com
Kansas STATE CERTIFICATE OF AUTHORITY #E-990

PEC

landworks STUDIO

ARCHITECTURAL URBAN PRAIRIE COLLABORATIVE, P.C.

H&B HOSS & BROWN ENGINEERS

WICHITA, KANSAS
Spray Ground
LINWOOD PARK

JEFF A. BARTLEY
LICENSED PROFESSIONAL ENGINEER
15116
8/14/00
KANSAS

Jeff Bartley - ENGINEER
LICENSE #15116
Date: 08-14-20 Job #: 18-512
Drawn: SRS Checked: JAB
Issue: CONSTRUCTION DOCUMENTS

EXISTING POOL DEMO PLAN

SP-D1
Water's Edge Aquatic Design © 2020