

BENCHMARKS:
 BM #1 - Chiseled "X" in Square Cut on the Top of the First Inlet North of the South Drive to the Cornejo Plant
 BL Sta. 19+86.34, 24.20' Lt.
 Elev = 1367.13 (NAVD 88)
 BM #2 - Chiseled "X" in Square Cut on the Top of the First Inlet North of the North Drive to the Cornejo Plant
 BL Sta. 23+30.74, 21.74' Lt.
 Elev = 1369.29 (NAVD 88)

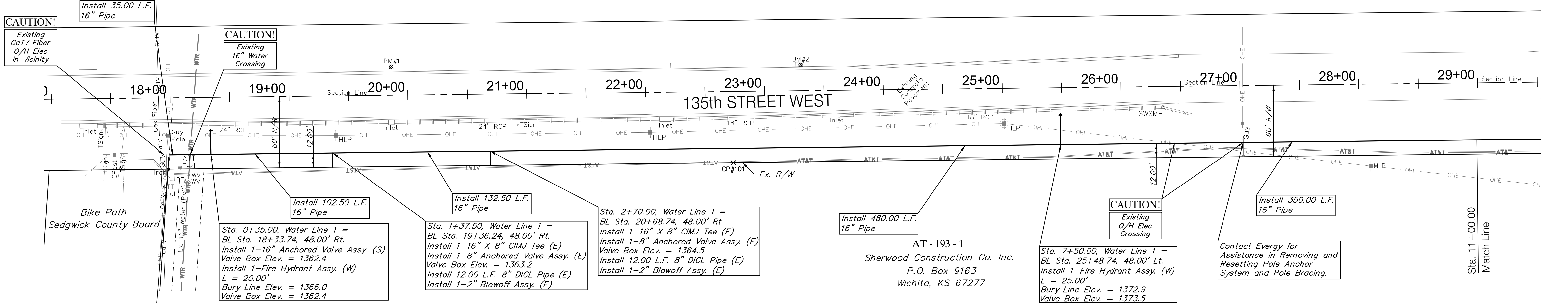
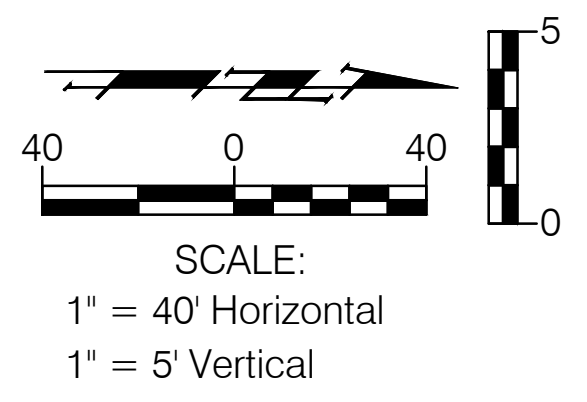

Sta. 0+00.00, Begin Water Line 1 =
 BL Sta. 17+98.74, 48.00' Rt.
 Install 1-2" Blowoff Assy.

Sta. 0+35.00, Water Line 1 =
 BL Sta. 18+33.74, 48.00' Rt.
 Install 1-16" Anchored Valve Assy. (S)
 Valve Box Elev. = 1362.4
 Install 1-Fire Hydrant Assy. (W)
 L = 20.00'
 Bury Line Elev. = 1366.0
 Valve Box Elev. = 1362.4

Sta. 1+37.50, Water Line 1 =
 BL Sta. 19+36.24, 48.00' Rt.
 Install 1-16" X 8" CIMJ Tee (E)
 Install 1-8" Anchored Valve Assy. (E)
 Valve Box Elev. = 1364.5
 Install 12.00 L.F. 8" DI CL Pipe (E)
 Install 1-2" Blowoff Assy. (E)

Sta. 2+70.00, Water Line 1 =
 BL Sta. 20+68.74, 48.00' Rt.
 Install 1-16" X 8" CIMJ Tee (E)
 Install 1-8" Anchored Valve Assy. (E)
 Valve Box Elev. = 1364.5
 Install 12.00 L.F. 8" DI CL Pipe (E)
 Install 1-2" Blowoff Assy. (E)

AT-193-1
 Sherwood Construction Co. Inc.
 P.O. Box 9163
 Wichita, KS 67277

Sta. 7+50.00, Water Line 1 =
 BL Sta. 25+48.74, 48.00' Lt.
 Install 1-Fire Hydrant Assy. (W)
 L = 25.00'
 Bury Line Elev. = 1372.9
 Valve Box Elev. = 1373.5

Contact Eergy for
 Assistance in Removing and
 Resetting Pole Anchor
 System and Pole Bracing.

